

Lot 1101

Stage 11

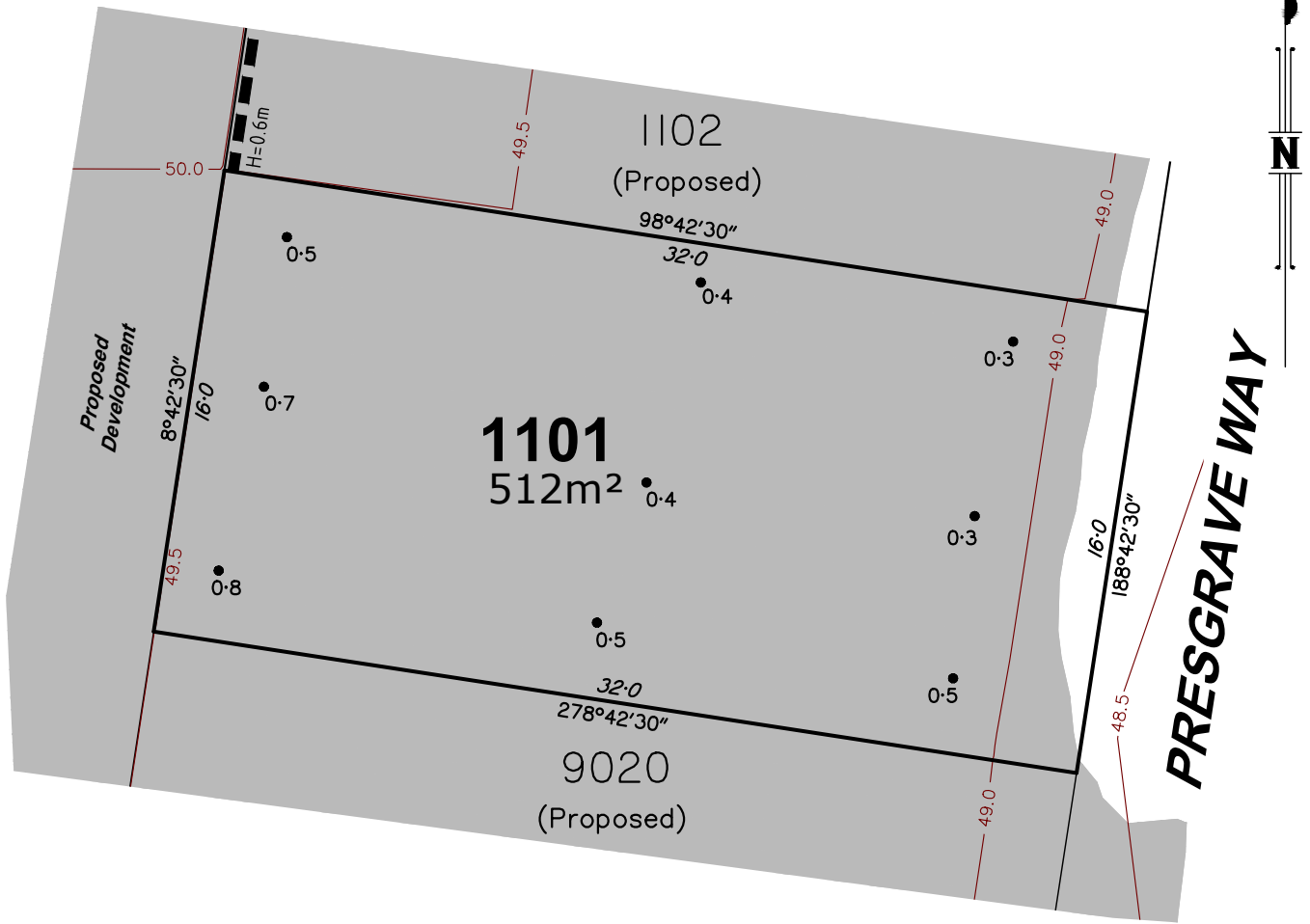

Notes:

1. Drawn to Scale on A4 sheet.
2. All levels are in metres on Australian Height Datum as determined by PSM193875, RL 46.405m AHD.
3. Contour Interval : 0.5m Design.
4. Retaining wall heights are shown at the base of the wall.
5. All dimensions and areas are subject to final survey and approval by ICC.
6. This plan has been prepared for disclosure under the Land Sales Act 1984.
7. This plan was prepared for ID WALLOON DEVELOPMENTS PTY LTD for the purposes of accompanying a sales contract and must not be used for any other purpose.
8. This plan shows details of Proposed Lot 1101 on proposal plan 0714-0279-60-U-01-RP02 Rev 05 which accompanied the Subdivision Application and was approved by Ipswich City Council (DA Ref: 7069/2024/MAMC/A) on 17th June, 2025 subject to conditions.
9. The compaction of earth fill will be undertaken as advised by EGIS and in accordance with the requirements of the Australian Standard AS3798-2007-Level 1.

LEGEND

- Approximate Fill Area
- 24 — Design Contours
- Contours (interval 0.5m) based on the Australian Height Datum (AHD) as shown on engineering plan 24-000435 provided by Egis.
- H=0.7m Denotes retaining wall height (H)
- AH=0.7m Denotes retaining wall average height (AH)
- I-0 ● Denotes depth of fill

Scale 1:250

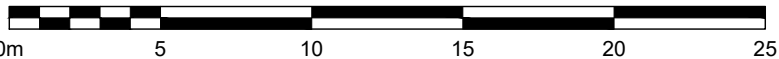

Issue	Revision	Int	Date
A	Original Issue	GJF	18/06/2025

Title:

Disclosure Plan for Proposed Lot 1101

7001 Taylors Road, Walloon,

Being Part of Lot 4 on SP351419 & Lot 1 on SP331698

Client:

ID WALLOON DEVELOPMENTS PTY LTD

Locality: WALLOON

Local Gov: ICC Prepared By: GJF

Surveyed By: Approved: MJT

Date Created: 18/06/2025 Scale: 1:250

Comp File: 220149.project

Plan No: **220149_011_DIS**



PO Box 5021, GCMC QLD 9726
Ph: (07) 5631 8000
mail@bennettandbennett.com.au

Surveying, Town Planning & Spatial Services

GOLD COAST | BRISBANE | SUNSHINE COAST | NORTHERN RIVERS

www.bennettandbennett.com.au

This is a disclosure plan, the final plan may be subject to change. The proposed lots have not been defined on site, and B.B.H. Pty Ltd Cadastral Surveyor accepts no responsibility for any amendments to location, areas, or shape that may occur during the development process. This plan has been prepared for the purpose of identifying the approximate location and size of registrable interests, and has been derived from information supplied by others. Lot dimensions may vary up to 1% and lot areas may vary by up to 2.0%. Contours, depths and retaining wall heights may vary by up to 0.5m. Lengths and shapes of retaining walls may vary during construction. This note is an integral part of this plan and no part of the plan may be reproduced without this note.

Lot 1102

Stage 11

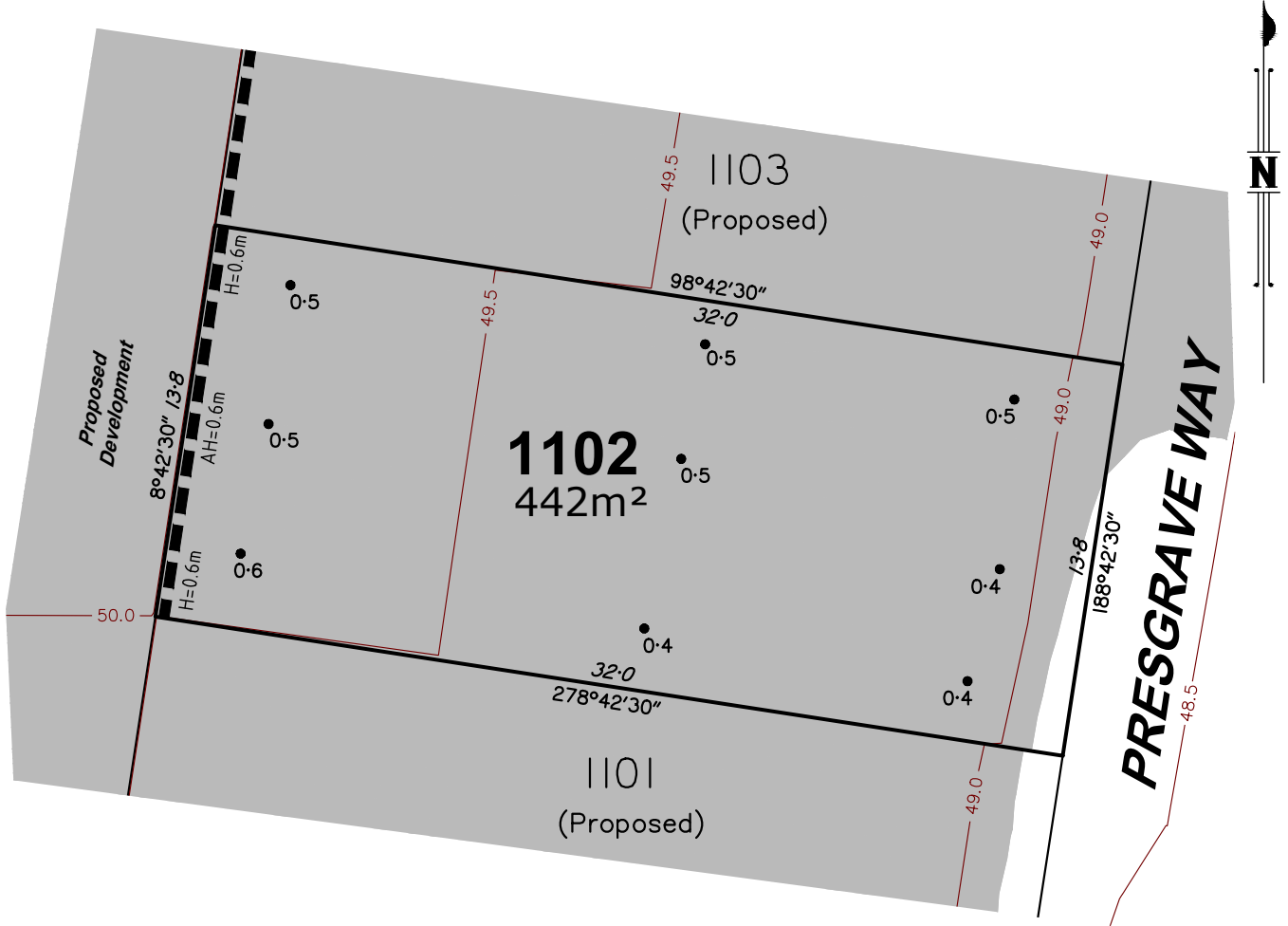

Notes:

1. Drawn to Scale on A4 sheet.
2. All levels are in metres on Australian Height Datum as determined by PSM193875, RL 46.405m AHD.
3. Contour Interval : 0.5m Design.
4. Retaining wall heights are shown at the base of the wall.
5. All dimensions and areas are subject to final survey and approval by ICC.
6. This plan has been prepared for disclosure under the Land Sales Act 1984.
7. This plan was prepared for ID WALLOON DEVELOPMENTS PTY LTD for the purposes of accompanying a sales contract and must not be used for any other purpose.
8. This plan shows details of Proposed Lot 1102 on proposal plan 0714-0279-60-U-01-RP02 Rev 05 which accompanied the Subdivision Application and was approved by Ipswich City Council (DA Ref: 7069/2024/MAMC/A) on 17th June, 2025 subject to conditions.
9. The compaction of earth fill will be undertaken as advised by EGIS and in accordance with the requirements of the Australian Standard AS3798-2007-Level 1.

LEGEND

- Approximate Fill Area
- 24 — Design Contours
- Contours (interval 0.5m) based on the Australian Height Datum (AHD) as shown on engineering plan 24-000435 provided by Egis.
- Denotes retaining wall height (H)
- Denotes retaining wall average height (AH)
- I-0 ● Denotes depth of fill

Scale 1:250

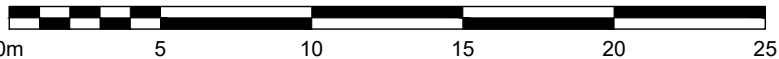

A	Original Issue	GJF	18/06/2025
Issue	Revision	Int	Date



PO Box 5021, GCMC QLD 9726
Ph: (07) 5631 8000
mail@bennettandbennett.com.au

Surveying, Town Planning & Spatial Services
GOLD COAST | BRISBANE | SUNSHINE COAST | NORTHERN RIVERS
www.bennettandbennett.com.au

Title:

Disclosure Plan for Proposed Lot 1102

7001 Taylors Road, Walloon,

Being Part of Lot 4 on SP351419 & Lot 1 on SP331698

This is a disclosure plan, the final plan may be subject to change. The proposed lots have not been defined on site, and B.B.H. Pty Ltd Cadastral Surveyor accepts no responsibility for any amendments to location, areas, or shape that may occur during the development process. This plan has been prepared for the purpose of identifying the approximate location and size of registrable interests, and has been derived from information supplied by others. Lot dimensions may vary up to 1% and lot areas may vary by up to 2.0%. Contours, depths and retaining wall heights may vary by up to 0.5m. Lengths and shapes of retaining walls may vary during construction. This note is an integral part of this plan and no part of the plan may be reproduced without this note.

Client:

ID WALLOON DEVELOPMENTS PTY LTD

Locality:	WALLOON		
Local Gov:	ICC	Prepared By:	GJF
Surveyed By:		Approved:	MJT
Date Created:	18/06/2025	Scale:	1:250
Comp File:	220149.project		
Plan No:	220149_011_DIS		

Lot 1103

Stage 11

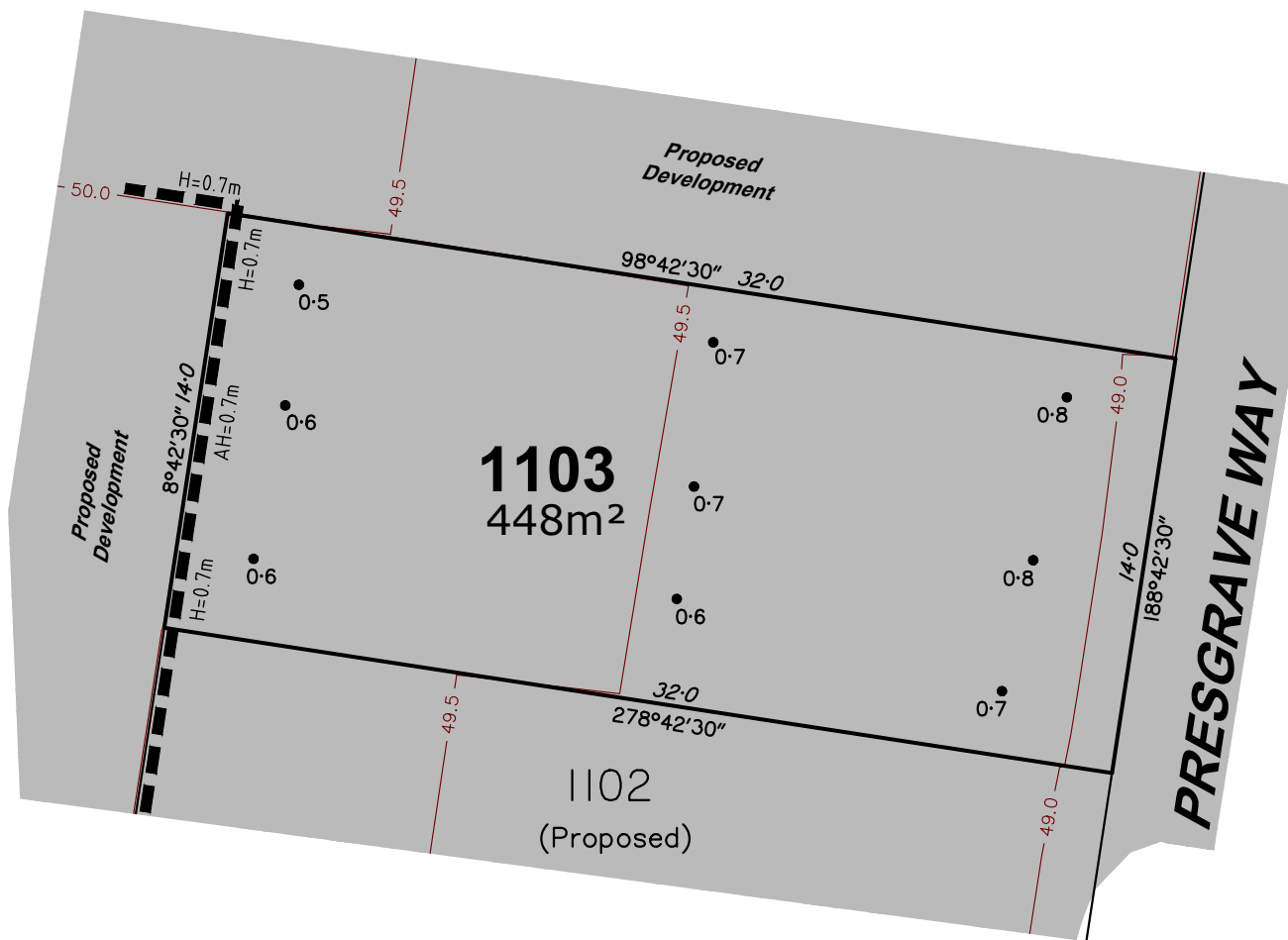

Notes:

1. Drawn to Scale on A4 sheet.
2. All levels are in metres on Australian Height Datum as determined by PSM193875, RL 46.405m AHD.
3. Contour Interval : 0.5m Design.
4. Retaining wall heights are shown at the base of the wall.
5. All dimensions and areas are subject to final survey and approval by ICC.
6. This plan has been prepared for disclosure under the Land Sales Act 1984.
7. This plan was prepared for ID WALLOON DEVELOPMENTS PTY LTD for the purposes of accompanying a sales contract and must not be used for any other purpose.
8. This plan shows details of Proposed Lot 1103 on proposal plan 0714-0279-60-U-01-RP02 Rev 05 which accompanied the Subdivision Application and was approved by Ipswich City Council (DA Ref: 7069/2024/MAMC/A) on 17th June, 2025 subject to conditions.
9. The compaction of earth fill will be undertaken as advised by EGIS and in accordance with the requirements of the Australian Standard AS3798-2007-Level 1.

LEGEND

- Approximate Fill Area
- 24 — Design Contours
- Contours (interval 0.5m) based on the Australian Height Datum (AHD) as shown on engineering plan 24-000435 provided by Egis.
- H=0.7m
 AH=0.7m
 Denotes retaining wall height (H)
- Denotes retaining wall average height (AH)
- I-0 ● Denotes depth of fill

Scale 1:250



A	Original Issue	GJF	18/06/2025
Issue	Revision	Int	Date

Title:

Disclosure Plan for Proposed Lot 1103

7001 Taylors Road, Walloon,

Being Part of Lot 4 on SP351419 & Lot 1 on SP331698

This is a disclosure plan, the final plan may be subject to change. The proposed lots have not been defined on site, and B.B.H. Pty Ltd Cadastral Surveyor accepts no responsibility for any amendments to location, areas, or shape that may occur during the development process. This plan has been prepared for the purpose of identifying the approximate location and size of registrable interests, and has been derived from information supplied by others. Lot dimensions may vary up to 1% and lot areas may vary by up to 2.0%. Contours, depths and retaining wall heights may vary by up to 0.5m. Lengths and shapes of retaining walls may vary during construction. This note is an integral part of this plan and no part of the plan may be reproduced without this note.

Client:

ID WALLOON DEVELOPMENTS PTY LTD

Locality: WALLOON

Local Gov: ICC Prepared By: GJF

Surveyed By: Approved: MJT

Date Created: 18/06/2025 Scale: 1:250

Comp File: 220149.project

Plan No: **220149_011_DIS**



PO Box 5021, GCMC QLD 9726
Ph: (07) 5631 8000
mail@bennettandbennett.com.au

Surveying, Town Planning & Spatial Services

GOLD COAST | BRISBANE | SUNSHINE COAST | NORTHERN RIVERS

www.bennettandbennett.com.au

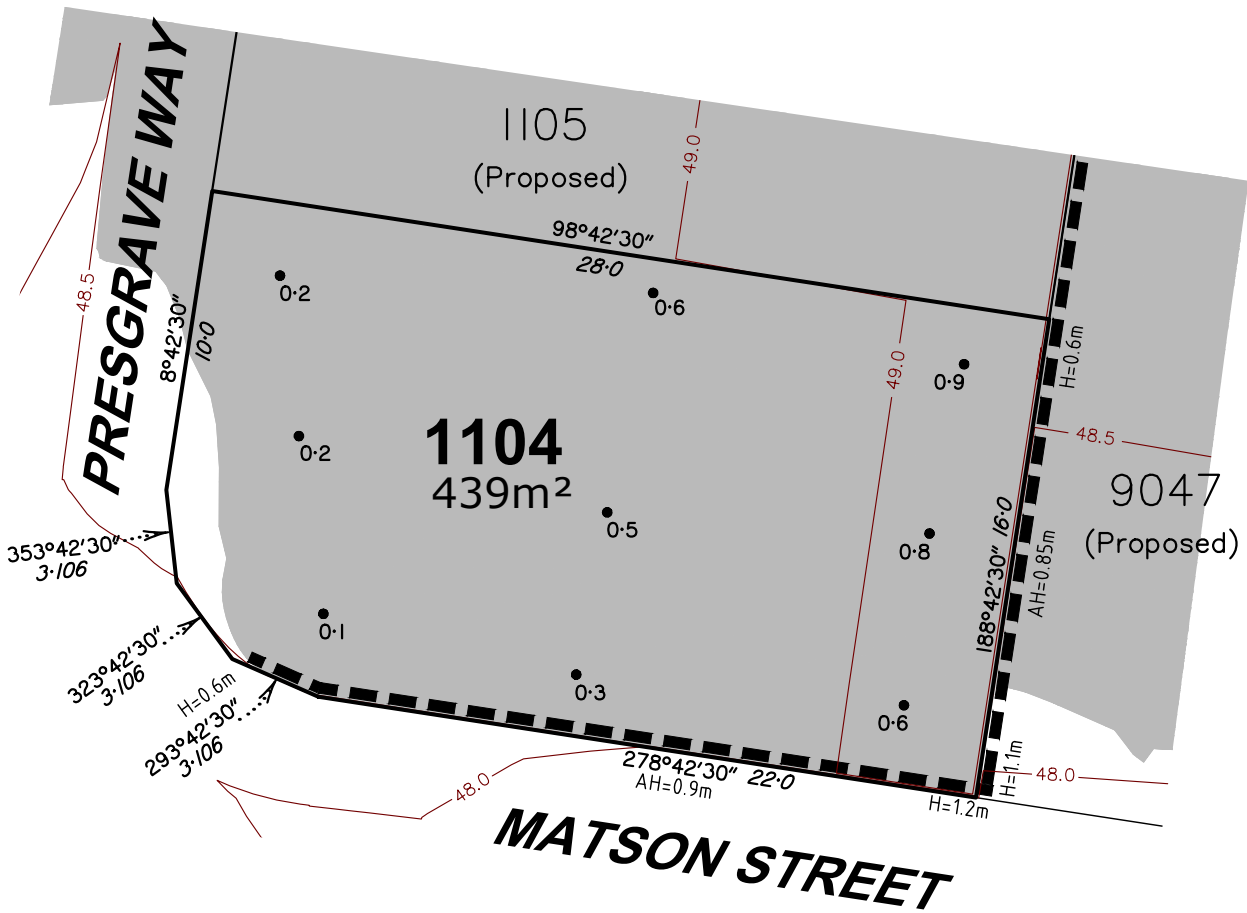

Notes:

1. Drawn to Scale on A4 sheet.
2. All levels are in metres on Australian Height Datum as determined by PSM193875, RL 46.405m AHD.
3. Contour Interval : 0.5m Design.
4. Retaining wall heights are shown at the base of the wall.
5. All dimensions and areas are subject to final survey and approval by ICC.
6. This plan has been prepared for disclosure under the Land Sales Act 1984.
7. This plan was prepared for ID WALLOON DEVELOPMENTS PTY LTD for the purposes of accompanying a sales contract and must not be used for any other purpose.
8. This plan shows details of Proposed Lot 1104 on proposal plan 0714-0279-60-U-01-RP02 Rev 05 which accompanied the Subdivision Application and was approved by Ipswich City Council (DA Ref: 7069/2024/MAMC/A) on 17th June, 2025 subject to conditions.
9. The compaction of earth fill will be undertaken as advised by EGIS and in accordance with the requirements of the Australian Standard AS3798-2007-Level 1.

LEGEND

Approximate Fill Area

24 — Design Contours

Contours (interval 0.5m) based on the Australian Height Datum (AHD) as shown on engineering plan 24-000435 provided by Egis.

H=0.7m
Denotes retaining wall height (H)

AH=0.7m
Denotes retaining wall average height (AH)

I-0 ● Denotes depth of fill

Scale 1:250

B	Update Retaining Wall	DJL	25/08/2025
A	Original Issue	GJF	18/06/2025
Issue	Revision	Int	Date



PO Box 5021, GCMC QLD 9726
Ph: (07) 5631 8000
mail@bennettandbennett.com.au

Surveying, Town Planning & Spatial Services

GOLD COAST | BRISBANE | SUNSHINE COAST | NORTHERN RIVERS

www.bennettandbennett.com.au

Title:

Disclosure Plan for Proposed Lot 1104

7001 Taylors Road, Walloon,

Being Part of Lot 4 on SP351419 & Lot 1 on SP331698

This is a disclosure plan, the final plan may be subject to change. The proposed lots have not been defined on site, and B.B.H. Pty Ltd Cadastral Surveyor accepts no responsibility for any amendments to location, areas, or shape that may occur during the development process. This plan has been prepared for the purpose of identifying the approximate location and size of registrable interests, and has been derived from information supplied by others. Lot dimensions may vary up to 1% and lot areas may vary by up to 2.0%. Contours, depths and retaining wall heights may vary by up to 0.5m. Lengths and shapes of retaining walls may vary during construction. This note is an integral part of this plan and no part of the plan may be reproduced without this note.

Client:

ID WALLOON DEVELOPMENTS PTY LTD

Locality: WALLOON

Local Gov: ICC Prepared By: GJF

Surveyed By: Approved: MJT

Date Created: 18/06/2025 Scale: 1:250

Comp File: 220149.project

Plan No: **220149_011_DIS**

Lot 1105

Stage 11

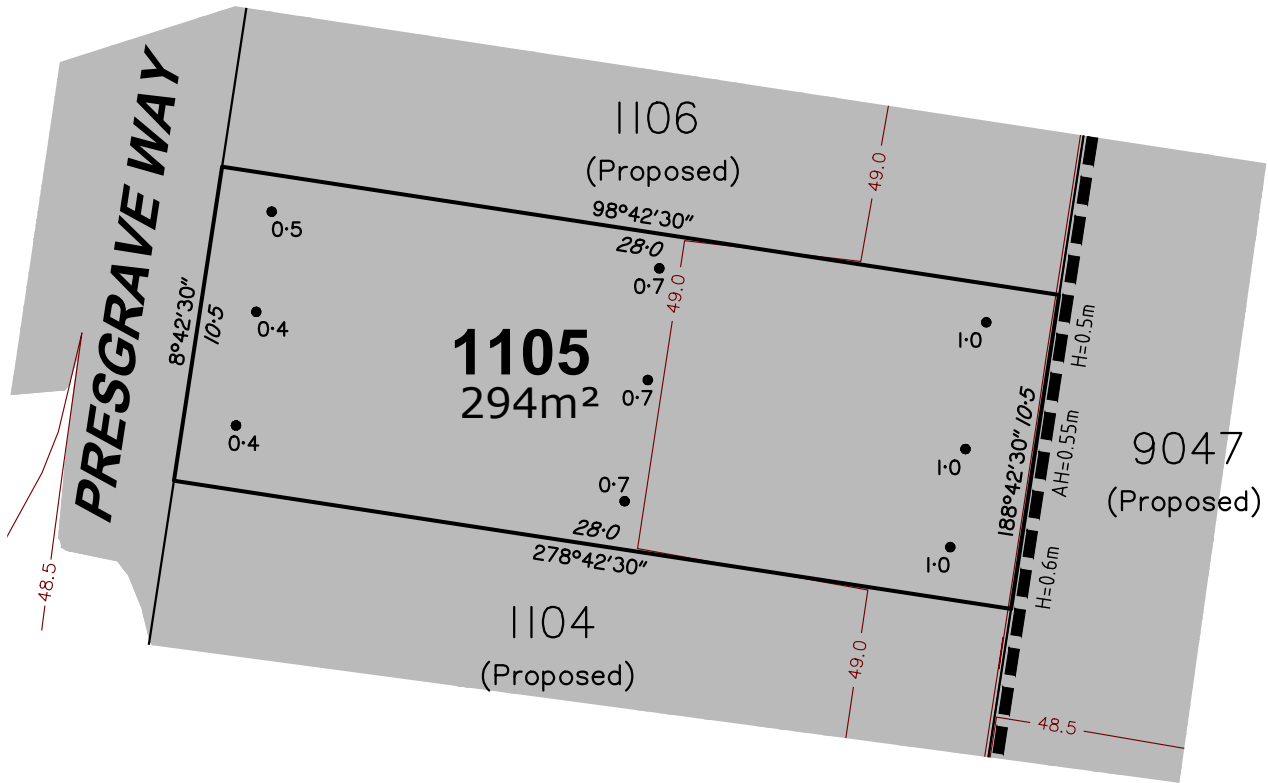

Notes:

1. Drawn to Scale on A4 sheet.
2. All levels are in metres on Australian Height Datum as determined by PSM193875, RL 46.405m AHD.
3. Contour Interval : 0.5m Design.
4. Retaining wall heights are shown at the base of the wall.
5. All dimensions and areas are subject to final survey and approval by ICC.
6. This plan has been prepared for disclosure under the Land Sales Act 1984.
7. This plan was prepared for ID WALLOON DEVELOPMENTS PTY LTD for the purposes of accompanying a sales contract and must not be used for any other purpose.
8. This plan shows details of Proposed Lot 1105 on proposal plan 0714-0279-60-U-01-RP02 Rev 05 which accompanied the Subdivision Application and was approved by Ipswich City Council (DA Ref: 7069/2024/MAMC/A) on 17th June, 2025 subject to conditions.
9. The compaction of earth fill will be undertaken as advised by EGIS and in accordance with the requirements of the Australian Standard AS3798-2007-Level 1.

LEGEND

- Approximate Fill Area
- 24 — Design Contours
- Contours (interval 0.5m) based on the Australian Height Datum (AHD) as shown on engineering plan 24-000435 provided by Egis.
- H=0.7m
 AH=0.7m
- Denotes retaining wall height (H)
- Denotes retaining wall average height (AH)
- I-0 ● Denotes depth of fill

Scale 1:250

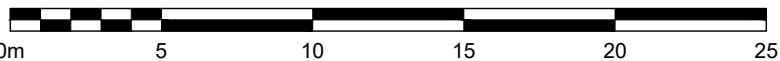

A	Original Issue	GJF	18/06/2025
Issue	Revision	Int	Date

Title:

Disclosure Plan for Proposed Lot 1105

7001 Taylors Road, Walloon,

Being Part of Lot 4 on SP351419 & Lot 1 on SP331698

Client:

ID WALLOON DEVELOPMENTS PTY LTD

Locality: WALLOON

Local Gov: ICC Prepared By: GJF

Surveyed By: Approved: MJT

Date Created: 18/06/2025 Scale: 1:250

Comp File: 220149.project

Plan No: **220149_011_DIS**



PO Box 5021, GCMC QLD 9726
Ph: (07) 5631 8000
mail@bennettandbennett.com.au

Surveying, Town Planning & Spatial Services

GOLD COAST | BRISBANE | SUNSHINE COAST | NORTHERN RIVERS

www.bennettandbennett.com.au

This is a disclosure plan, the final plan may be subject to change. The proposed lots have not been defined on site, and B.B.H. Pty Ltd Cadastral Surveyor accepts no responsibility for any amendments to location, areas, or shape that may occur during the development process. This plan has been prepared for the purpose of identifying the approximate location and size of registrable interests, and has been derived from information supplied by others. Lot dimensions may vary up to 1% and lot areas may vary by up to 2.0%. Contours, depths and retaining wall heights may vary by up to 0.5m. Lengths and shapes of retaining walls may vary during construction. This note is an integral part of this plan and no part of the plan may be reproduced without this note.

Lot 1106

Stage 11

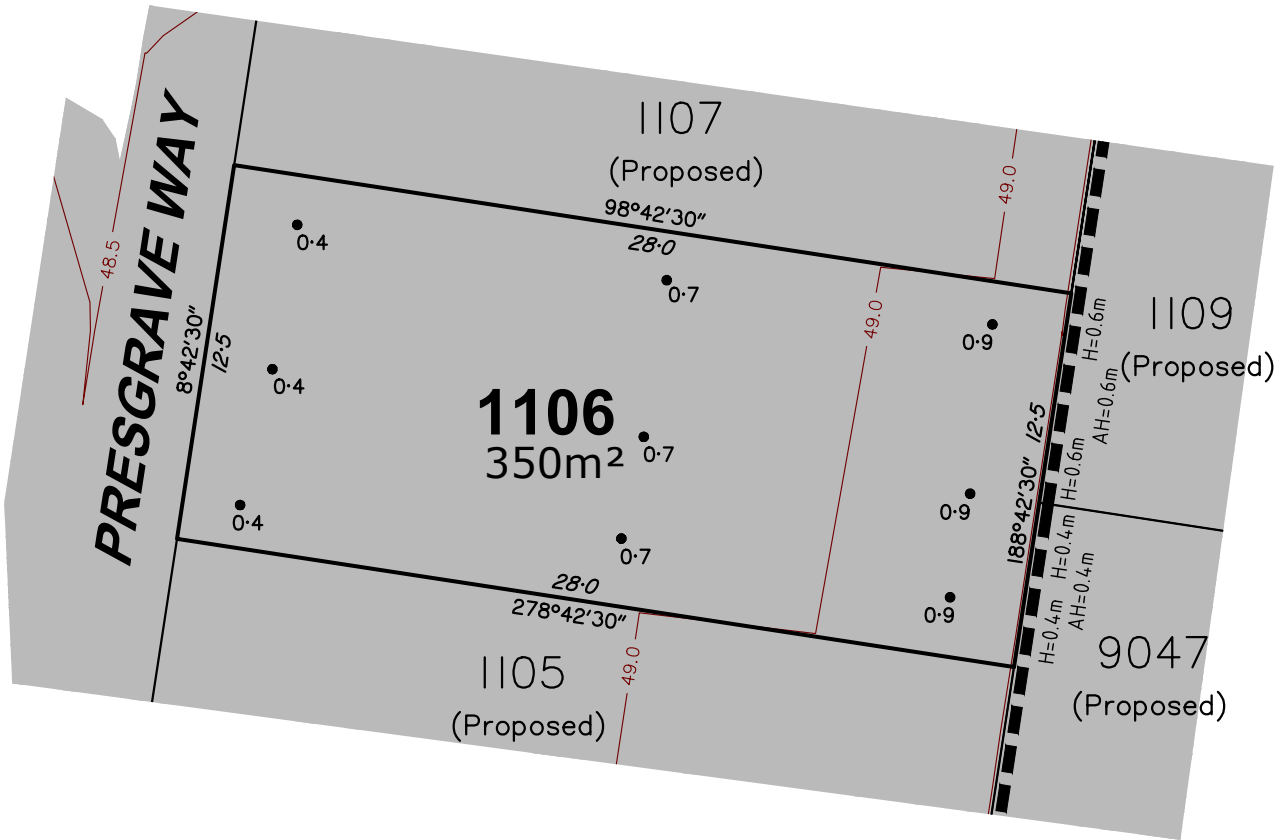

Notes:

1. Drawn to Scale on A4 sheet.
2. All levels are in metres on Australian Height Datum as determined by PSM193875, RL 46.405m AHD.
3. Contour Interval : 0.5m Design.
4. Retaining wall heights are shown at the base of the wall.
5. All dimensions and areas are subject to final survey and approval by ICC.
6. This plan has been prepared for disclosure under the Land Sales Act 1984.
7. This plan was prepared for ID WALLOON DEVELOPMENTS PTY LTD for the purposes of accompanying a sales contract and must not be used for any other purpose.
8. This plan shows details of Proposed Lot 1106 on proposal plan 0714-0279-60-U-01-RP02 Rev 05 which accompanied the Subdivision Application and was approved by Ipswich City Council (DA Ref: 7069/2024/MAMC/A) on 17th June, 2025 subject to conditions.
9. The compaction of earth fill will be undertaken as advised by EGIS and in accordance with the requirements of the Australian Standard AS3798-2007-Level 1.

LEGEND

Approximate Fill Area

24 — Design Contours

Contours (interval 0.5m) based on the Australian Height Datum (AHD) as shown on engineering plan 24-000435 provided by Egis.

H=0.7m
Denotes retaining wall height (H)

AH=0.7m
Denotes retaining wall average height (AH)

I-0 ● Denotes depth of fill

Scale 1:250

Issue	Revision	Int	Date
A	Original Issue	GJF	18/06/2025

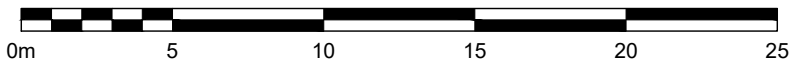

PO Box 5021, GCMC QLD 9726
Ph: (07) 5631 8000
mail@bennettandbennett.com.au

Surveying, Town Planning & Spatial Services
GOLD COAST | BRISBANE | SUNSHINE COAST | NORTHERN RIVERS
www.bennettandbennett.com.au

Title:

Disclosure Plan for Proposed Lot 1106

7001 Taylors Road, Walloon,

Being Part of Lot 4 on SP351419 & Lot 1 on SP331698

This is a disclosure plan, the final plan may be subject to change. The proposed lots have not been defined on site, and B.B.H. Pty Ltd Cadastral Surveyor accepts no responsibility for any amendments to location, areas, or shape that may occur during the development process. This plan has been prepared for the purpose of identifying the approximate location and size of registrable interests, and has been derived from information supplied by others. Lot dimensions may vary up to 1% and lot areas may vary by up to 2.0%. Contours, depths and retaining wall heights may vary by up to 0.5m. Lengths and shapes of retaining walls may vary during construction. This note is an integral part of this plan and no part of the plan may be reproduced without this note.

Client:

ID WALLOON DEVELOPMENTS PTY LTD

Locality: WALLOON

Local Gov: ICC Prepared By: GJF

Surveyed By: Approved: MJT

Date Created: 18/06/2025 Scale: 1:250

Comp File: 220149.project

Plan No: **220149_011_DIS**

Lot 1107

Stage 11

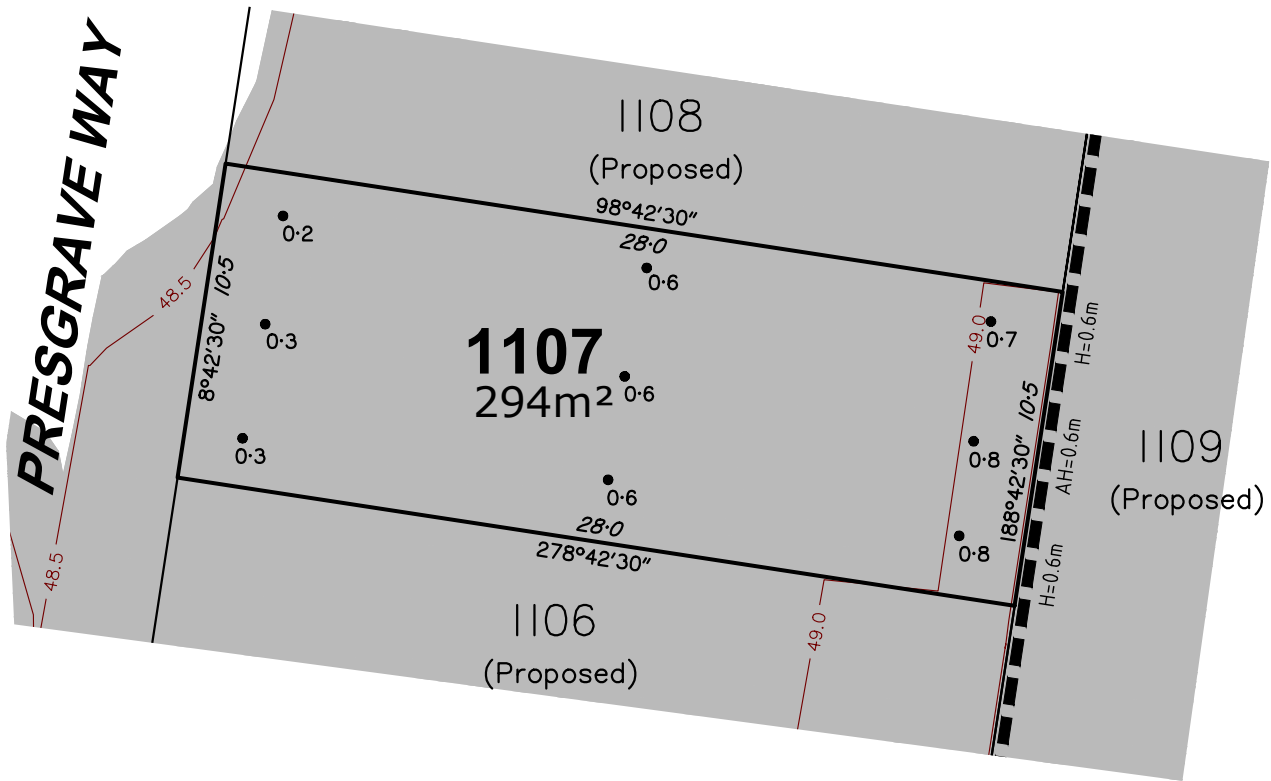

Notes:

1. Drawn to Scale on A4 sheet.
2. All levels are in metres on Australian Height Datum as determined by PSM193875, RL 46.405m AHD.
3. Contour Interval : 0.5m Design.
4. Retaining wall heights are shown at the base of the wall.
5. All dimensions and areas are subject to final survey and approval by ICC.
6. This plan has been prepared for disclosure under the Land Sales Act 1984.
7. This plan was prepared for ID WALLOON DEVELOPMENTS PTY LTD for the purposes of accompanying a sales contract and must not be used for any other purpose.
8. This plan shows details of Proposed Lot 1107 on proposal plan 0714-0279-60-U-01-RP02 Rev 05 which accompanied the Subdivision Application and was approved by Ipswich City Council (DA Ref: 7069/2024/MAMC/A) on 17th June, 2025 subject to conditions.
9. The compaction of earth fill will be undertaken as advised by EGIS and in accordance with the requirements of the Australian Standard AS3798-2007-Level 1.

LEGEND

Approximate Fill Area

24 — Design Contours

Contours (interval 0.5m) based on the Australian Height Datum (AHD) as shown on engineering plan 24-000435 provided by Egis.

Denotes retaining wall height (H)

Denotes retaining wall average height (AH)

Denotes depth of fill

Scale 1:250

Issue	Revision	Int	Date
A	Original Issue	GJF	18/06/2025



BENNETT + BENNETT

PO Box 5021, GCMC QLD 9726
Ph: (07) 5631 8000
mail@bennettandbennett.com.au

Surveying, Town Planning & Spatial Services
GOLD COAST | BRISBANE | SUNSHINE COAST | NORTHERN RIVERS
www.bennettandbennett.com.au

Title: **Disclosure Plan for Proposed Lot 1107**
7001 Taylors Road, Walloon,
Being Part of Lot 4 on SP351419 & Lot 1 on SP331698

This is a disclosure plan, the final plan may be subject to change. The proposed lots have not been defined on site, and B.B.H. Pty Ltd Cadastral Surveyor accepts no responsibility for any amendments to location, areas, or shape that may occur during the development process. This plan has been prepared for the purpose of identifying the approximate location and size of registrable interests, and has been derived from information supplied by others. Lot dimensions may vary up to 1% and lot areas may vary by up to 2.0%. Contours, depths and retaining wall heights may vary by up to 0.5m. Lengths and shapes of retaining walls may vary during construction. This note is an integral part of this plan and no part of the plan may be reproduced without this note.

Client:	ID WALLOON DEVELOPMENTS PTY LTD		
Locality:	WALLOON		
Local Gov:	ICC	Prepared By:	GJF
Surveyed By:		Approved:	MJT
Date Created:	18/06/2025	Scale:	1:250
Comp File:	220149.project		
Plan No:	220149_011_DIS		

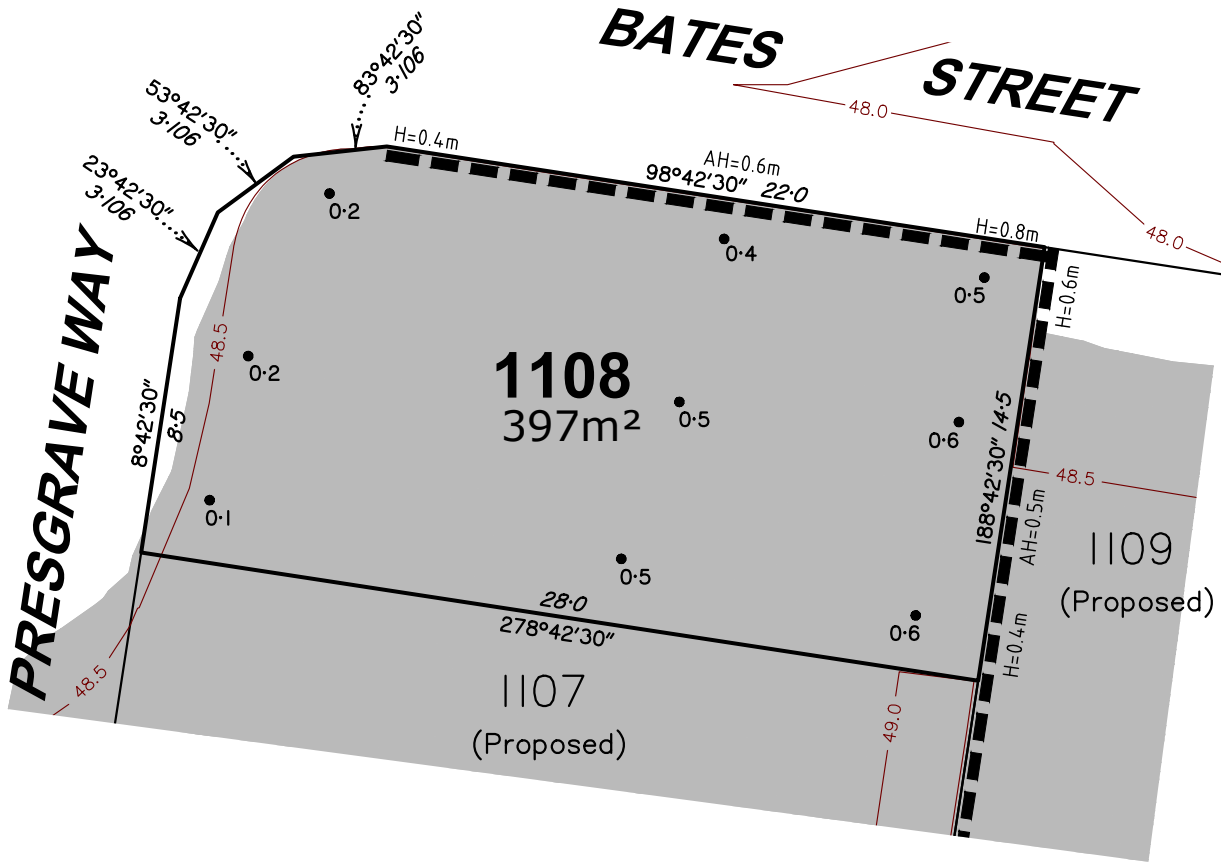

Notes:

1. Drawn to Scale on A4 sheet.
2. All levels are in metres on Australian Height Datum as determined by PSM193875, RL 46.405m AHD.
3. Contour Interval : 0.5m Design.
4. Retaining wall heights are shown at the base of the wall.
5. All dimensions and areas are subject to final survey and approval by ICC.
6. This plan has been prepared for disclosure under the Land Sales Act 1984.
7. This plan was prepared for ID WALLOON DEVELOPMENTS PTY LTD for the purposes of accompanying a sales contract and must not be used for any other purpose.
8. This plan shows details of Proposed Lot 1108 on proposal plan 0714-0279-60-U-01-RP02 Rev 05 which accompanied the Subdivision Application and was approved by Ipswich City Council (DA Ref: 7069/2024/MAMC/A) on 17th June, 2025 subject to conditions.
9. The compaction of earth fill will be undertaken as advised by EGIS and in accordance with the requirements of the Australian Standard AS3798-2007-Level 1.

LEGEND

Approximate Fill Area

24 — Design Contours

Contours (interval 0.5m) based on the Australian Height Datum (AHD) as shown on engineering plan 24-000435 provided by Egis.

H=0.7m
Denotes retaining wall height (H)

AH=0.7m
Denotes retaining wall average height (AH)

I-0 ● Denotes depth of fill

Scale 1:250

B	Update Retaining Wall	DJL	25/08/2025
A	Original Issue	GJF	18/06/2025
Issue	Revision	Int	Date



PO Box 5021, GCMC QLD 9726
Ph: (07) 5631 8000
mail@bennettandbennett.com.au

Surveying, Town Planning & Spatial Services
GOLD COAST | BRISBANE | SUNSHINE COAST | NORTHERN RIVERS
www.bennettandbennett.com.au

Title:

Disclosure Plan for Proposed Lot 1108

7001 Taylors Road, Walloon,

Being Part of Lot 4 on SP351419 & Lot 1 on SP331698

This is a disclosure plan, the final plan may be subject to change. The proposed lots have not been defined on site, and B.B.H. Pty Ltd Cadastral Surveyor accepts no responsibility for any amendments to location, areas, or shape that may occur during the development process. This plan has been prepared for the purpose of identifying the approximate location and size of registrable interests, and has been derived from information supplied by others. Lot dimensions may vary up to 1% and lot areas may vary by up to 2.0%. Contours, depths and retaining wall heights may vary by up to 0.5m. Lengths and shapes of retaining walls may vary during construction. This note is an integral part of this plan and no part of the plan may be reproduced without this note.

Client:

ID WALLOON DEVELOPMENTS PTY LTD

Locality: WALLOON

Local Gov: ICC Prepared By: GJF

Surveyed By: Approved: MJT

Date Created: 18/06/2025 Scale: 1:250

Comp File: 220149.project

Plan No: **220149_011_DIS**

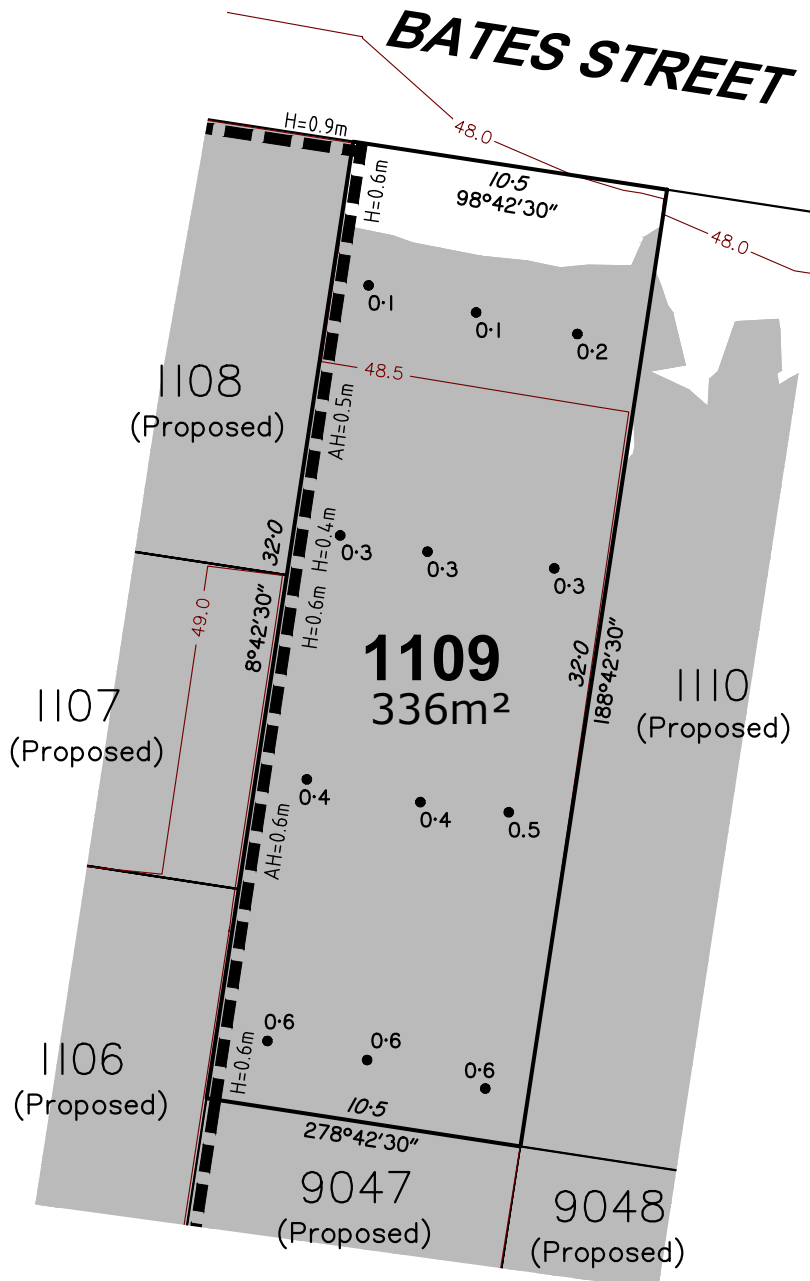

Notes:

1. Drawn to Scale on A4 sheet.
2. All levels are in metres on Australian Height Datum as determined by PSM193875, RL 46.405m AHD.
3. Contour Interval : 0.5m Design.
4. Retaining wall heights are shown at the base of the wall.
5. All dimensions and areas are subject to final survey and approval by ICC.
6. This plan has been prepared for disclosure under the Land Sales Act 1984.
7. This plan was prepared for ID WALLOON DEVELOPMENTS PTY LTD for the purposes of accompanying a sales contract and must not be used for any other purpose.
8. This plan shows details of Proposed Lot 1109 on proposal plan 0714-0279-60-U-01-RP02 Rev 05 which accompanied the Subdivision Application and was approved by Ipswich City Council (DA Ref: 7069/2024/MAMC/A) on 17th June, 2025 subject to conditions.
9. The compaction of earth fill will be undertaken as advised by EGIS and in accordance with the requirements of the Australian Standard AS3798-2007-Level 1.

LEGEND

Approximate Fill Area

24 — Design Contours

Contours (interval 0.5m) based on the Australian Height Datum (AHD) as shown on engineering plan 24-000435 provided by Egis.

H=0.7m
Denotes retaining wall height (H)

AH=0.7m
Denotes retaining wall average height (AH)

I-0 ● Denotes depth of fill

Scale 1:250

A	Original Issue	GJF	18/06/2025
Issue	Revision	Int	Date



PO Box 5021, GCMC QLD 9726
Ph: (07) 5631 8000
mail@bennettandbennett.com.au

Surveying, Town Planning & Spatial Services
GOLD COAST | BRISBANE | SUNSHINE COAST | NORTHERN RIVERS
www.bennettandbennett.com.au

Title:

Disclosure Plan for Proposed Lot 1109

7001 Taylors Road, Walloon,

Being Part of Lot 4 on SP351419 & Lot 1 on SP331698

This is a disclosure plan, the final plan may be subject to change. The proposed lots have not been defined on site, and B.B.H. Pty Ltd Cadastral Surveyor accepts no responsibility for any amendments to location, areas, or shape that may occur during the development process. This plan has been prepared for the purpose of identifying the approximate location and size of registrable interests, and has been derived from information supplied by others. Lot dimensions may vary up to 1% and lot areas may vary by up to 2.0%. Contours, depths and retaining wall heights may vary by up to 0.5m. Lengths and shapes of retaining walls may vary during construction. This note is an integral part of this plan and no part of the plan may be reproduced without this note.

Client:

ID WALLOON DEVELOPMENTS PTY LTD

Locality: WALLOON

Local Gov: ICC Prepared By: GJF

Surveyed By: Approved: MJT

Date Created: 18/06/2025 Scale: 1:250

Comp File: 220149.project

Plan No: **220149_011_DIS**

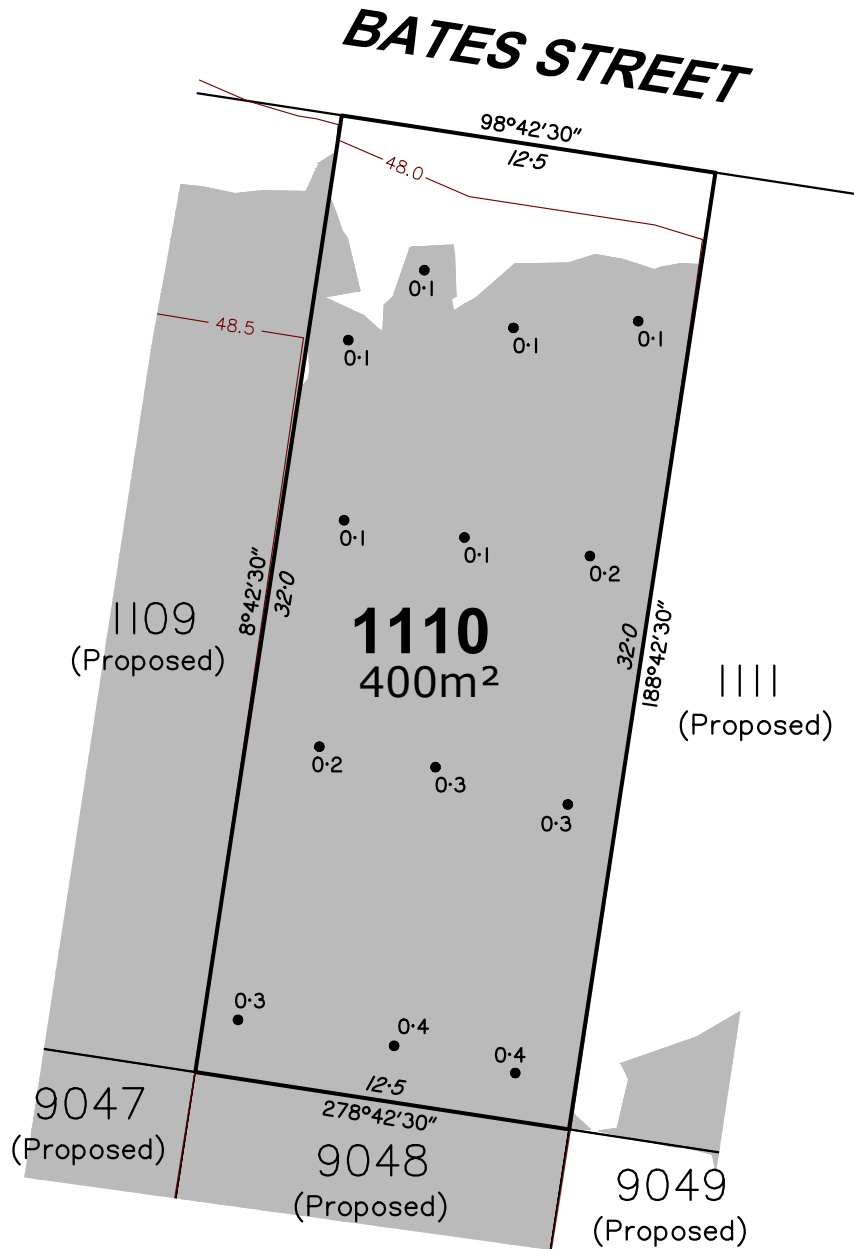

Notes:

1. Drawn to Scale on A4 sheet.
2. All levels are in metres on Australian Height Datum as determined by PSM193875, RL 46.405m AHD.
3. Contour Interval : 0.5m Design.
4. Retaining wall heights are shown at the base of the wall.
5. All dimensions and areas are subject to final survey and approval by ICC.
6. This plan has been prepared for disclosure under the Land Sales Act 1984.
7. This plan was prepared for ID WALLOON DEVELOPMENTS PTY LTD for the purposes of accompanying a sales contract and must not be used for any other purpose.
8. This plan shows details of Proposed Lot 1110 on proposal plan 0714-0279-60-U-01-RP02 Rev 05 which accompanied the Subdivision Application and was approved by Ipswich City Council (DA Ref: 7069/2024/MAMC/A) on 17th June, 2025 subject to conditions.
9. The compaction of earth fill will be undertaken as advised by EGIS and in accordance with the requirements of the Australian Standard AS3798-2007-Level 1.

LEGEND

Approximate Fill Area

24 — Design Contours

Contours (interval 0.5m) based on the Australian Height Datum (AHD) as shown on engineering plan 24-000435 provided by Egis.

H=0.7m
Denotes retaining wall height (H)

AH=0.7m
Denotes retaining wall average height (AH)

I-0 ● Denotes depth of fill

Scale 1:250

Issue	Revision	Int	Date
A	Original Issue	GJF	18/06/2025

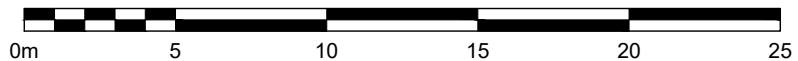

PO Box 5021, GCMC QLD 9726
Ph: (07) 5631 8000
mail@bennettandbennett.com.au

Surveying, Town Planning & Spatial Services
GOLD COAST | BRISBANE | SUNSHINE COAST | NORTHERN RIVERS
www.bennettandbennett.com.au

Title:

Disclosure Plan for Proposed Lot 1110

7001 Taylors Road, Walloon,

Being Part of Lot 4 on SP351419 & Lot 1 on SP331698

This is a disclosure plan, the final plan may be subject to change. The proposed lots have not been defined on site, and B.B.H. Pty Ltd Cadastral Surveyor accepts no responsibility for any amendments to location, areas, or shape that may occur during the development process. This plan has been prepared for the purpose of identifying the approximate location and size of registrable interests, and has been derived from information supplied by others. Lot dimensions may vary up to 1% and lot areas may vary by up to 2.0%. Contours, depths and retaining wall heights may vary by up to 0.5m. Lengths and shapes of retaining walls may vary during construction. This note is an integral part of this plan and no part of the plan may be reproduced without this note.

Client:

ID WALLOON DEVELOPMENTS PTY LTD

Locality: WALLOON

Local Gov: ICC Prepared By: GJF

Surveyed By: Approved: MJT

Date Created: 18/06/2025 Scale: 1:250

Comp File: 220149.project

Plan No: **220149_011_DIS**

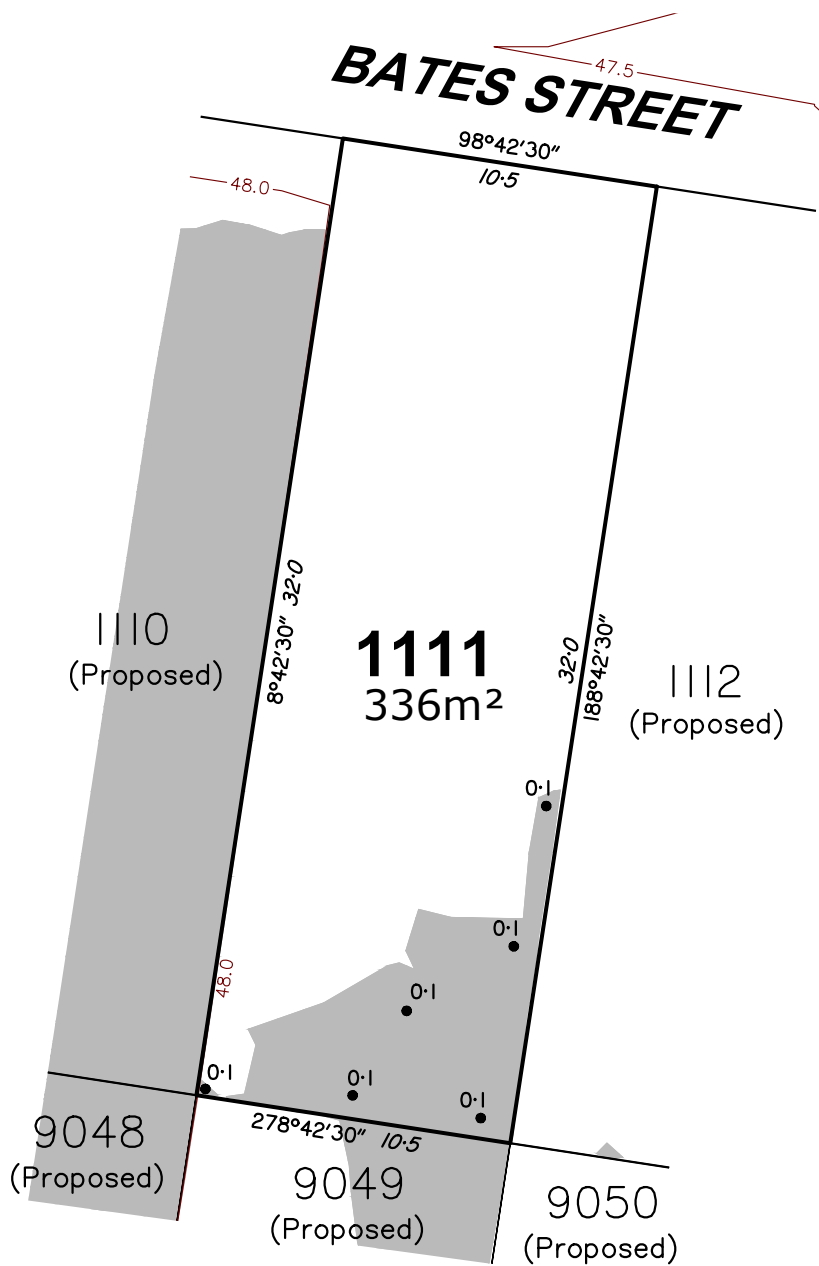

Notes:

1. Drawn to Scale on A4 sheet.
2. All levels are in metres on Australian Height Datum as determined by PSM193875, RL 46.405m AHD.
3. Contour Interval : 0.5m Design.
4. Retaining wall heights are shown at the base of the wall.
5. All dimensions and areas are subject to final survey and approval by ICC.
6. This plan has been prepared for disclosure under the Land Sales Act 1984.
7. This plan was prepared for ID WALLOON DEVELOPMENTS PTY LTD for the purposes of accompanying a sales contract and must not be used for any other purpose.
8. This plan shows details of Proposed Lot 1111 on proposal plan 0714-0279-60-U-01-RP02 Rev 05 which accompanied the Subdivision Application and was approved by Ipswich City Council (DA Ref: 7069/2024/MAMC/A) on 17th June, 2025 subject to conditions.
9. The compaction of earth fill will be undertaken as advised by EGIS and in accordance with the requirements of the Australian Standard AS3798-2007-Level 1.

LEGEND

- Approximate Fill Area
- 24 — Design Contours
- Contours (interval 0.5m) based on the Australian Height Datum (AHD) as shown on engineering plan 24-000435 provided by Egis.
- Denotes retaining wall height (H)
- Denotes retaining wall average height (AH)
- 1-0 ● Denotes depth of fill

H=0.7m
AH=0.7m

Scale 1:250

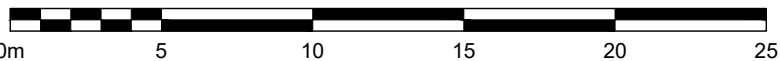

A	Original Issue	GJF	18/06/2025
Issue	Revision	Int	Date

Title:

Disclosure Plan for Proposed Lot 1111

7001 Taylors Road, Walloon,

Being Part of Lot 4 on SP351419 & Lot 1 on SP331698

Client:

ID WALLOON DEVELOPMENTS PTY LTD

Locality: WALLOON

Local Gov: ICC Prepared By: GJF

Surveyed By: Approved: MJT

Date Created: 18/06/2025 Scale: 1:250

Comp File: 220149.project

Plan No: **220149_011_DIS**



PO Box 5021, GCMC QLD 9726
Ph: (07) 5631 8000
mail@bennettandbennett.com.au

Surveying, Town Planning & Spatial Services

GOLD COAST | BRISBANE | SUNSHINE COAST | NORTHERN RIVERS

www.bennettandbennett.com.au

This is a disclosure plan, the final plan may be subject to change. The proposed lots have not been defined on site, and B.B.H. Pty Ltd Cadastral Surveyor accepts no responsibility for any amendments to location, areas, or shape that may occur during the development process. This plan has been prepared for the purpose of identifying the approximate location and size of registrable interests, and has been derived from information supplied by others. Lot dimensions may vary up to 1% and lot areas may vary by up to 2.0%. Contours, depths and retaining wall heights may vary by up to 0.5m. Lengths and shapes of retaining walls may vary during construction. This note is an integral part of this plan and no part of the plan may be reproduced without this note.

Lot 1112

Stage 11

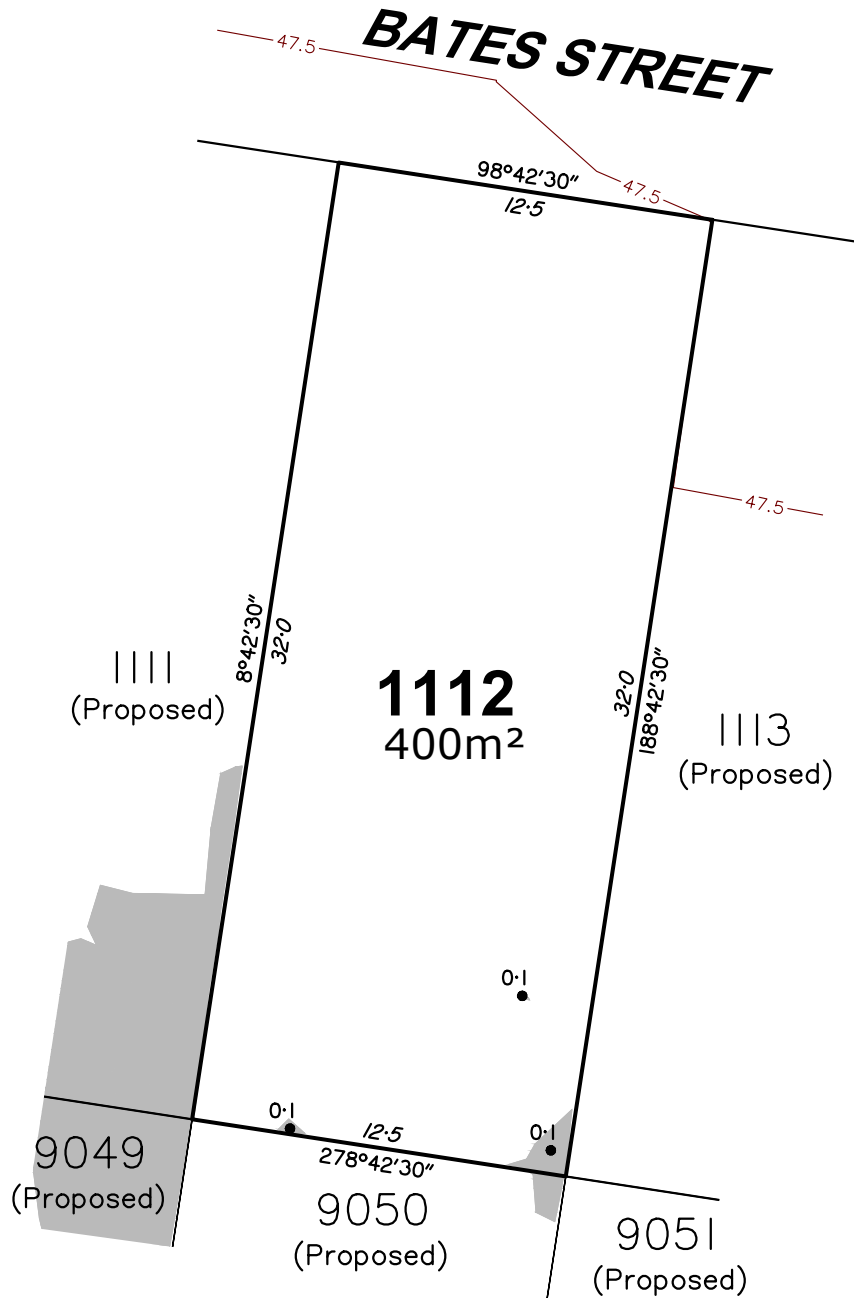

Notes:

1. Drawn to Scale on A4 sheet.
2. All levels are in metres on Australian Height Datum as determined by PSM193875, RL 46.405m AHD.
3. Contour Interval : 0.5m Design.
4. Retaining wall heights are shown at the base of the wall.
5. All dimensions and areas are subject to final survey and approval by ICC.
6. This plan has been prepared for disclosure under the Land Sales Act 1984.
7. This plan was prepared for ID WALLOON DEVELOPMENTS PTY LTD for the purposes of accompanying a sales contract and must not be used for any other purpose.
8. This plan shows details of Proposed Lot 1112 on proposal plan 0714-0279-60-U-01-RP02 Rev 05 which accompanied the Subdivision Application and was approved by Ipswich City Council (DA Ref: 7069/2024/MAMC/A) on 17th June, 2025 subject to conditions.
9. The compaction of earth fill will be undertaken as advised by EGIS and in accordance with the requirements of the Australian Standard AS3798-2007-Level 1.

LEGEND

- Approximate Fill Area
- 24 — Design Contours
- Contours (interval 0.5m) based on the Australian Height Datum (AHD) as shown on engineering plan 24-000435 provided by Egis.
- Denotes retaining wall height (H)
- Denotes retaining wall average height (AH)
- I-0 ● Denotes depth of fill

Scale 1:250

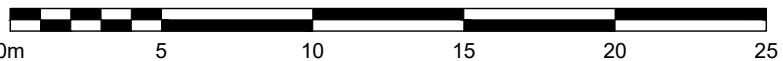

A	Original Issue	GJF	18/06/2025
Issue	Revision	Int	Date

Title:

Disclosure Plan for Proposed Lot 1112

7001 Taylors Road, Walloon,

Being Part of Lot 4 on SP351419 & Lot 1 on SP331698

Client:

ID WALLOON DEVELOPMENTS PTY LTD

Locality: WALLOON

Local Gov: ICC Prepared By: GJF

Surveyed By: Approved: MJT

Date Created: 18/06/2025 Scale: 1:250

Comp File: 220149.project

Plan No: **220149_011_DIS**

BENNETT + BENNETT

PO Box 5021, GCMC QLD 9726
Ph: (07) 5631 8000
mail@bennettandbennett.com.au

Surveying, Town Planning & Spatial Services
GOLD COAST | BRISBANE | SUNSHINE COAST | NORTHERN RIVERS
www.bennettandbennett.com.au

This is a disclosure plan, the final plan may be subject to change. The proposed lots have not been defined on site, and B.B.H. Pty Ltd Cadastral Surveyor accepts no responsibility for any amendments to location, areas, or shape that may occur during the development process. This plan has been prepared for the purpose of identifying the approximate location and size of registrable interests, and has been derived from information supplied by others. Lot dimensions may vary up to 1% and lot areas may vary by up to 2.0%. Contours, depths and retaining wall heights may vary by up to 0.5m. Lengths and shapes of retaining walls may vary during construction. This note is an integral part of this plan and no part of the plan may be reproduced without this note.

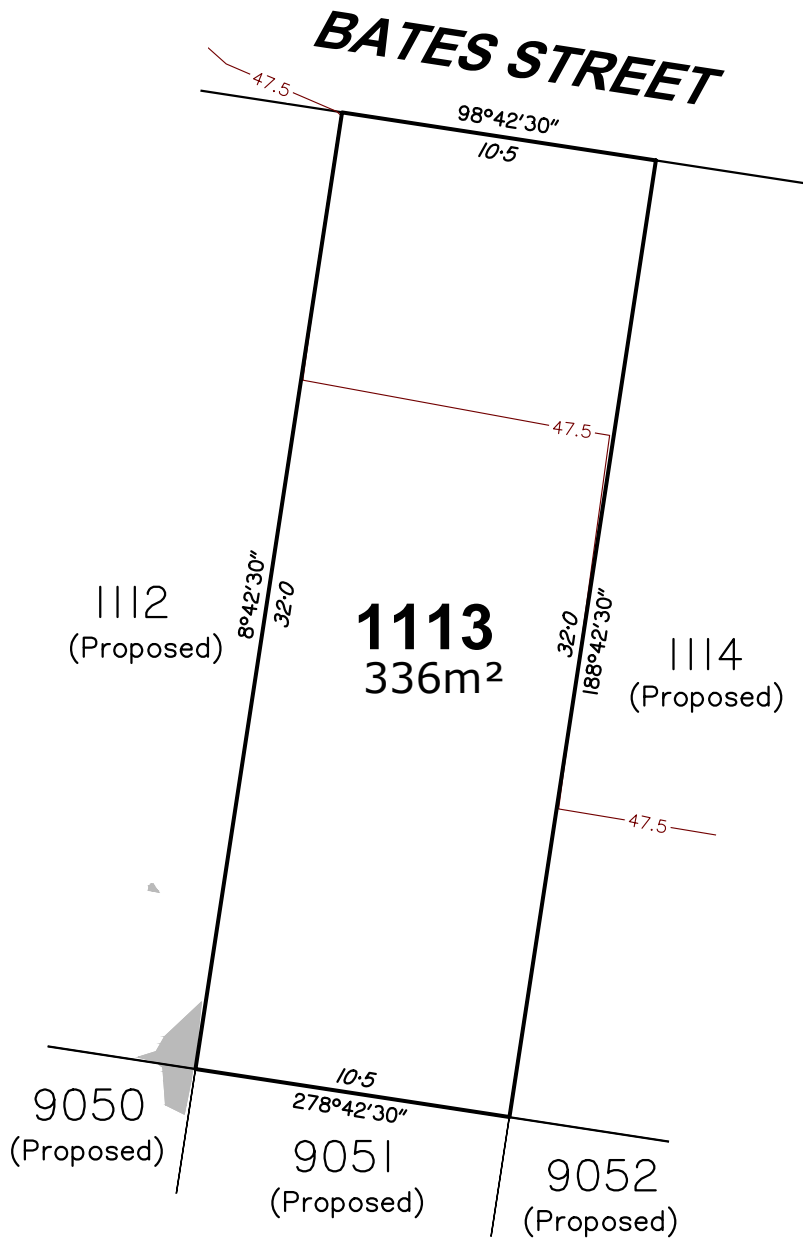

Notes:

1. Drawn to Scale on A4 sheet.
2. All levels are in metres on Australian Height Datum as determined by PSM193875, RL 46.405m AHD.
3. Contour Interval : 0.5m Design.
4. Retaining wall heights are shown at the base of the wall.
5. All dimensions and areas are subject to final survey and approval by ICC.
6. This plan has been prepared for disclosure under the Land Sales Act 1984.
7. This plan was prepared for ID WALLOON DEVELOPMENTS PTY LTD for the purposes of accompanying a sales contract and must not be used for any other purpose.
8. This plan shows details of Proposed Lot 1113 on proposal plan 0714-0279-60-U-01-RP02 Rev 05 which accompanied the Subdivision Application and was approved by Ipswich City Council (DA Ref: 7069/2024/MAMC/A) on 17th June, 2025 subject to conditions.
9. The compaction of earth fill will be undertaken as advised by EGIS and in accordance with the requirements of the Australian Standard AS3798-2007-Level 1.

LEGEND

- Approximate Fill Area
- 24 — Design Contours
- Contours (interval 0.5m) based on the Australian Height Datum (AHD) as shown on engineering plan 24-000435 provided by Egis.
- H=0.7m Denotes retaining wall height (H)
- AH=0.7m Denotes retaining wall average height (AH)
- I-0 ● Denotes depth of fill

Scale 1:250



A	Original Issue	GJF	18/06/2025
Issue	Revision	Int	Date



PO Box 5021, GCMC QLD 9726
Ph: (07) 5631 8000
mail@bennettandbennett.com.au

Surveying, Town Planning & Spatial Services

GOLD COAST | BRISBANE | SUNSHINE COAST | NORTHERN RIVERS

www.bennettandbennett.com.au

Title:

Disclosure Plan for Proposed Lot 1113

7001 Taylors Road, Walloon,

Being Part of Lot 4 on SP351419 & Lot 1 on SP331698

This is a disclosure plan, the final plan may be subject to change. The proposed lots have not been defined on site, and B.B.H. Pty Ltd Cadastral Surveyor accepts no responsibility for any amendments to location, areas, or shape that may occur during the development process. This plan has been prepared for the purpose of identifying the approximate location and size of registrable interests, and has been derived from information supplied by others. Lot dimensions may vary up to 1% and lot areas may vary by up to 2.0%. Contours, depths and retaining wall heights may vary by up to 0.5m. Lengths and shapes of retaining walls may vary during construction. This note is an integral part of this plan and no part of the plan may be reproduced without this note.

Client:

ID WALLOON DEVELOPMENTS PTY LTD

Locality: WALLOON

Local Gov: ICC Prepared By: GJF

Surveyed By: Approved: MJT

Date Created: 18/06/2025 Scale: 1:250

Comp File: 220149.project

Plan No: **220149_011_DIS**

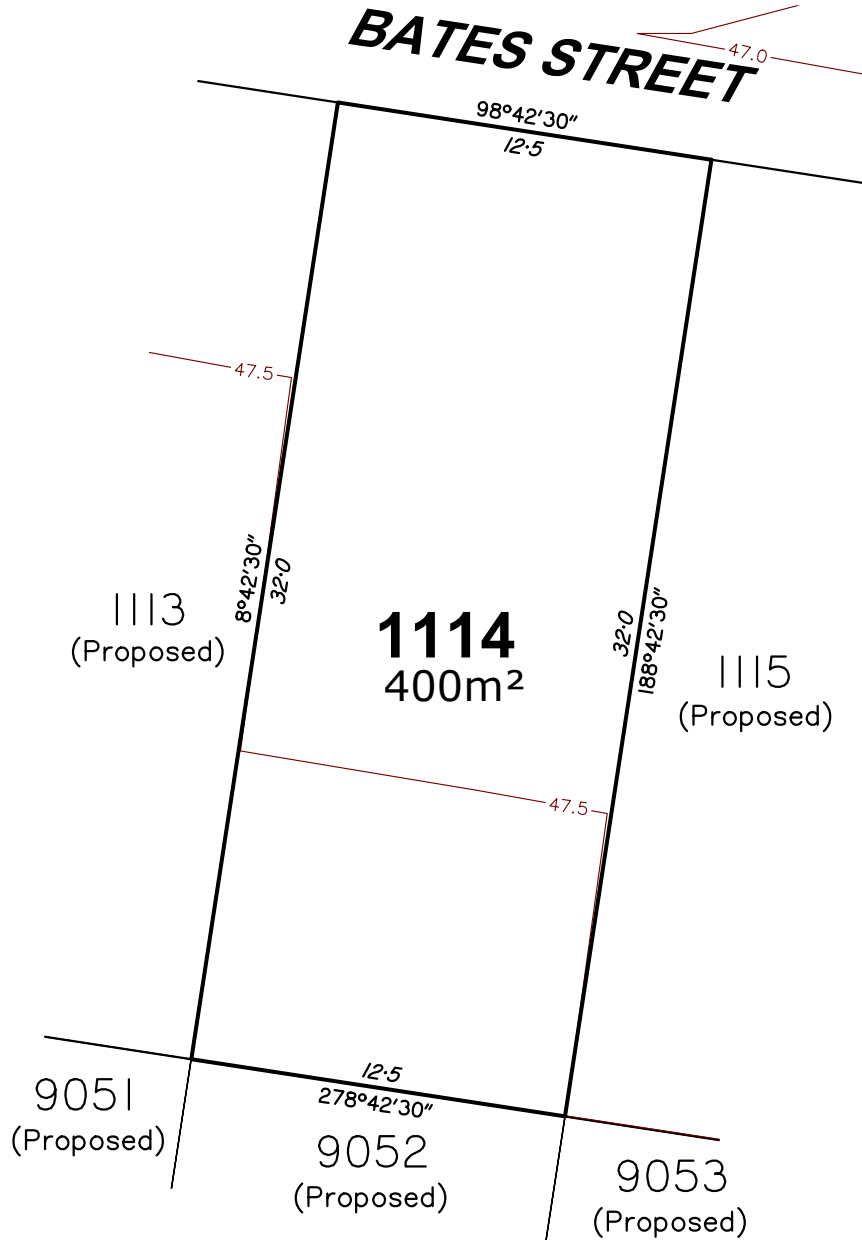

Notes:

1. Drawn to Scale on A4 sheet.
2. All levels are in metres on Australian Height Datum as determined by PSM193875, RL 46.405m AHD.
3. Contour Interval : 0.5m Design.
4. Retaining wall heights are shown at the base of the wall.
5. All dimensions and areas are subject to final survey and approval by ICC.
6. This plan has been prepared for disclosure under the Land Sales Act 1984.
7. This plan was prepared for ID WALLOON DEVELOPMENTS PTY LTD for the purposes of accompanying a sales contract and must not be used for any other purpose.
8. This plan shows details of Proposed Lot 1114 on proposal plan 0714-0279-60-U-01-RP02 Rev 05 which accompanied the Subdivision Application and was approved by Ipswich City Council (DA Ref: 7069/2024/MAMC/A) on 17th June, 2025 subject to conditions.
9. The compaction of earth fill will be undertaken as advised by EGIS and in accordance with the requirements of the Australian Standard AS3798-2007-Level 1.

LEGEND

Approximate Fill Area

24 Design Contours

Contours (interval 0.5m) based on the Australian Height Datum (AHD) as shown on engineering plan 24-000435 provided by Egis.

Denotes retaining wall height (H)

Denotes retaining wall average height (AH)

Denotes depth of fill

Scale 1:250

Issue	Revision	Int	Date
A	Original Issue	GJF	18/06/2025



PO Box 5021, GCMC QLD 9726
Ph: (07) 5631 8000
mail@bennettandbennett.com.au

Surveying, Town Planning & Spatial Services

GOLD COAST | BRISBANE | SUNSHINE COAST | NORTHERN RIVERS

www.bennettandbennett.com.au

Title:

Disclosure Plan for Proposed Lot 1114

7001 Taylors Road, Walloon,

Being Part of Lot 4 on SP351419 & Lot 1 on SP331698

This is a disclosure plan, the final plan may be subject to change. The proposed lots have not been defined on site, and B.B.H. Pty Ltd Cadastral Surveyor accepts no responsibility for any amendments to location, areas, or shape that may occur during the development process. This plan has been prepared for the purpose of identifying the approximate location and size of registrable interests, and has been derived from information supplied by others. Lot dimensions may vary up to 1% and lot areas may vary by up to 2.0%. Contours, depths and retaining wall heights may vary by up to 0.5m. Lengths and shapes of retaining walls may vary during construction. This note is an integral part of this plan and no part of the plan may be reproduced without this note.

Client:

ID WALLOON DEVELOPMENTS PTY LTD

Locality: WALLOON

Local Gov: ICC Prepared By: GJF

Surveyed By: Approved: MJT

Date Created: 18/06/2025 Scale: 1:250

Comp File: 220149.project

Plan No: **220149_011_DIS**

Lot 1115

Stage 11

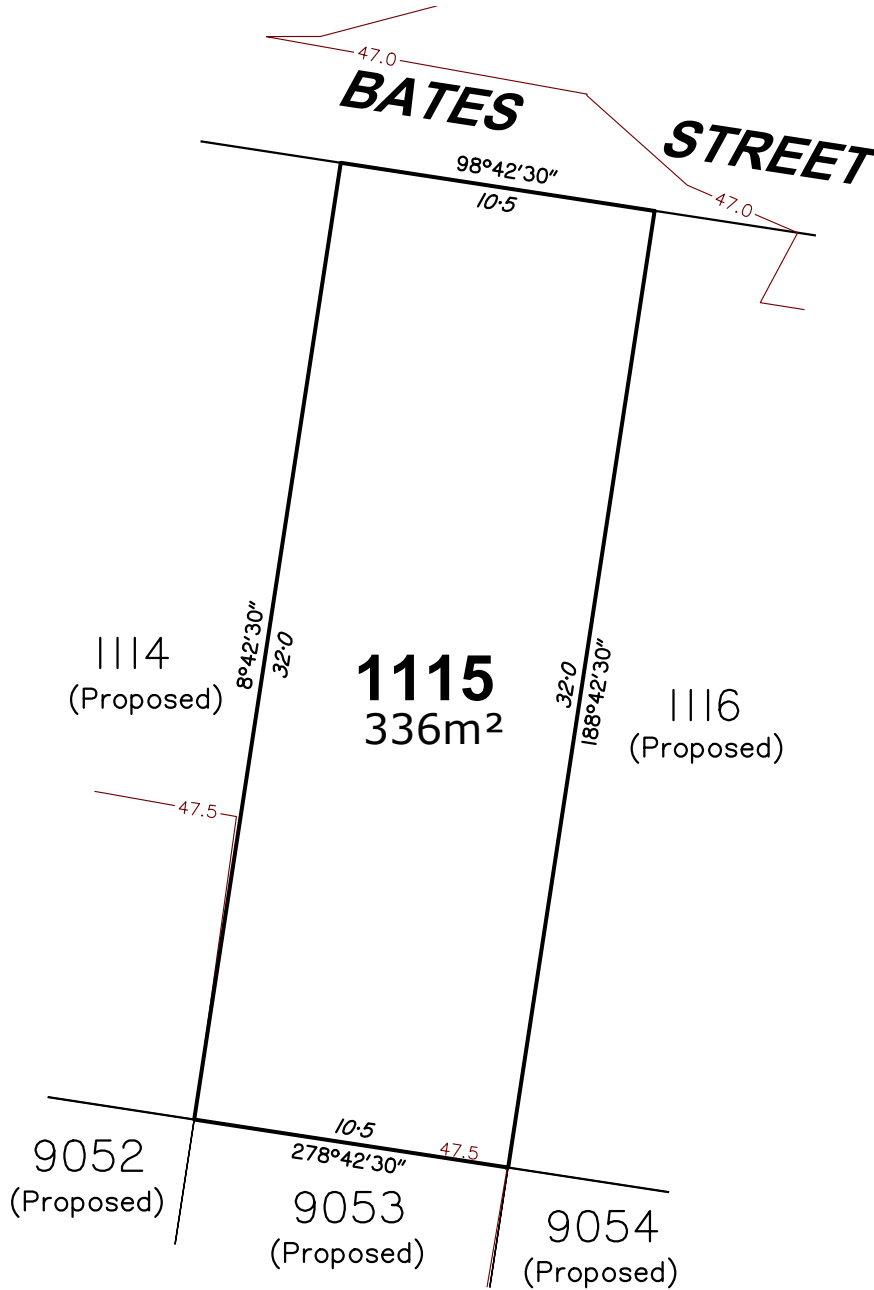

Notes:

1. Drawn to Scale on A4 sheet.
2. All levels are in metres on Australian Height Datum as determined by PSM193875, RL 46.405m AHD.
3. Contour Interval : 0.5m Design.
4. Retaining wall heights are shown at the base of the wall.
5. All dimensions and areas are subject to final survey and approval by ICC.
6. This plan has been prepared for disclosure under the Land Sales Act 1984.
7. This plan was prepared for ID WALLOON DEVELOPMENTS PTY LTD for the purposes of accompanying a sales contract and must not be used for any other purpose.
8. This plan shows details of Proposed Lot 1115 on proposal plan 0714-0279-60-U-01-RP02 Rev 05 which accompanied the Subdivision Application and was approved by Ipswich City Council (DA Ref: 7069/2024/MAMC/A) on 17th June, 2025 subject to conditions.
9. The compaction of earth fill will be undertaken as advised by EGIS and in accordance with the requirements of the Australian Standard AS3798-2007-Level 1.

LEGEND

- Approximate Fill Area
- 24 — Design Contours
- Contours (interval 0.5m) based on the Australian Height Datum (AHD) as shown on engineering plan 24-000435 provided by Egis.
- H=0.7m Denotes retaining wall height (H)
- AH=0.7m Denotes retaining wall average height (AH)
- I-0 ● Denotes depth of fill

Scale 1:250

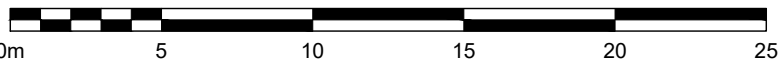

A	Original Issue	GJF	18/06/2025
Issue	Revision	Int	Date

BENNETT + BENNETT

PO Box 5021, GCMC QLD 9726
Ph: (07) 5631 8000
mail@bennettandbennett.com.au

Surveying, Town Planning & Spatial Services
GOLD COAST | BRISBANE | SUNSHINE COAST | NORTHERN RIVERS
www.bennettandbennett.com.au

Title: **Disclosure Plan for Proposed Lot 1115**
7001 Taylors Road, Walloon,
Being Part of Lot 4 on SP351419 & Lot 1 on SP331698

This is a disclosure plan, the final plan may be subject to change. The proposed lots have not been defined on site, and B.B.H. Pty Ltd Cadastral Surveyor accepts no responsibility for any amendments to location, areas, or shape that may occur during the development process. This plan has been prepared for the purpose of identifying the approximate location and size of registrable interests, and has been derived from information supplied by others. Lot dimensions may vary up to 1% and lot areas may vary by up to 2.0%. Contours, depths and retaining wall heights may vary by up to 0.5m. Lengths and shapes of retaining walls may vary during construction. This note is an integral part of this plan and no part of the plan may be reproduced without this note.

Client: **ID WALLOON DEVELOPMENTS PTY LTD**

Locality:	WALLOON
Local Gov:	ICC
Prepared By:	GJF
Surveyed By:	MJT
Approved:	MJT
Date Created:	18/06/2025
Scale:	1:250
Comp File:	220149.project
Plan No:	220149_011_DIS

Lot 1116

Stage 11

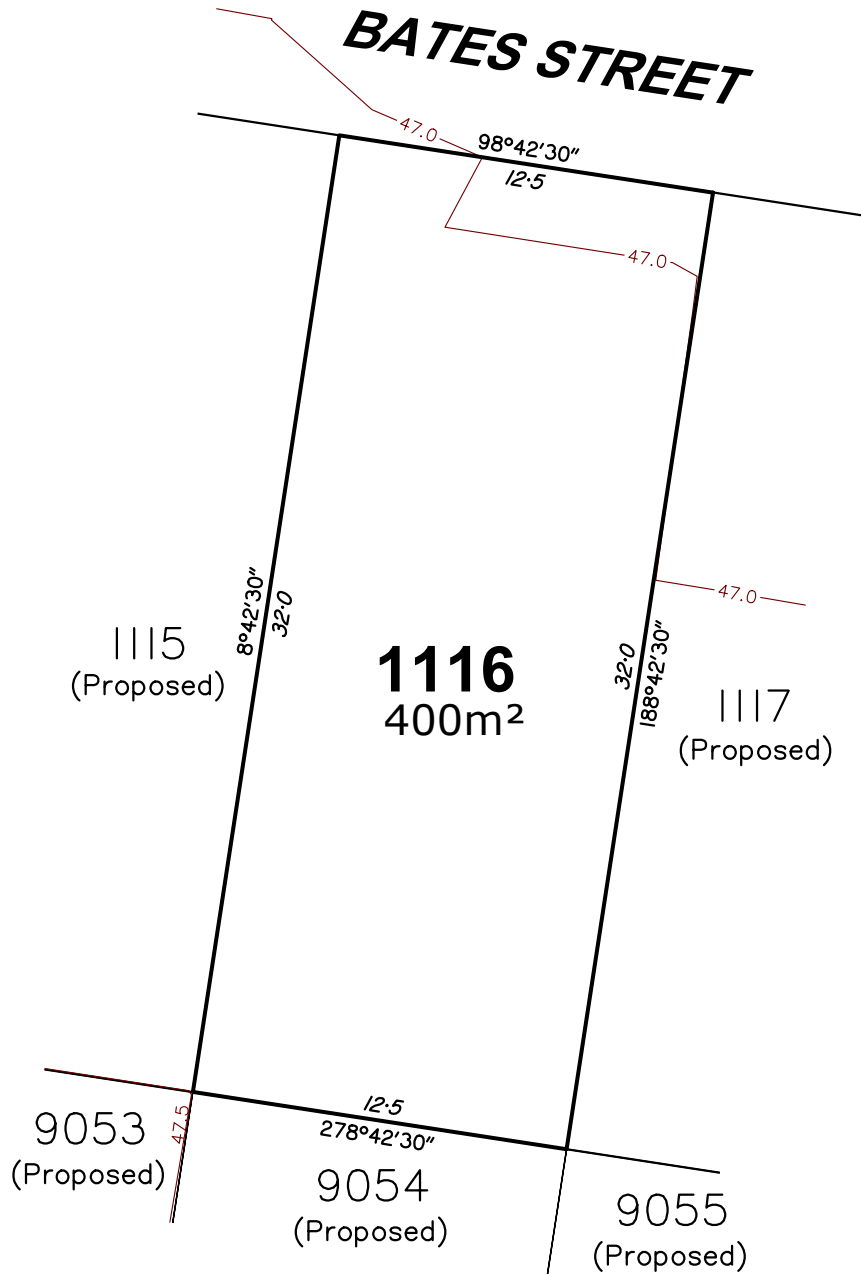

Notes:

1. Drawn to Scale on A4 sheet.
2. All levels are in metres on Australian Height Datum as determined by PSM193875, RL 46.405m AHD.
3. Contour Interval : 0.5m Design.
4. Retaining wall heights are shown at the base of the wall.
5. All dimensions and areas are subject to final survey and approval by ICC.
6. This plan has been prepared for disclosure under the Land Sales Act 1984.
7. This plan was prepared for ID WALLOON DEVELOPMENTS PTY LTD for the purposes of accompanying a sales contract and must not be used for any other purpose.
8. This plan shows details of Proposed Lot 1116 on proposal plan 0714-0279-60-U-01-RP02 Rev 05 which accompanied the Subdivision Application and was approved by Ipswich City Council (DA Ref: 7069/2024/MAMC/A) on 17th June, 2025 subject to conditions.
9. The compaction of earth fill will be undertaken as advised by EGIS and in accordance with the requirements of the Australian Standard AS3798-2007-Level 1.

LEGEND

Approximate Fill Area

24 — Design Contours

Contours (interval 0.5m) based on the Australian Height Datum (AHD) as shown on engineering plan 24-000435 provided by Egis.

Denotes retaining wall height (H)

Denotes retaining wall average height (AH)

Denotes depth of fill

Scale 1:250

A	Original Issue	GJF	18/06/2025
Issue	Revision	Int	Date

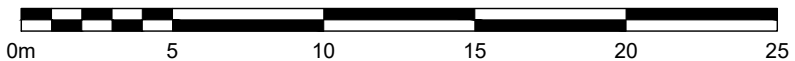

PO Box 5021, GCMC QLD 9726
Ph: (07) 5631 8000
mail@bennettandbennett.com.au

Surveying, Town Planning & Spatial Services

GOLD COAST | BRISBANE | SUNSHINE COAST | NORTHERN RIVERS

www.bennettandbennett.com.au

Title:

Disclosure Plan for Proposed Lot 1116

7001 Taylors Road, Walloon,

Being Part of Lot 4 on SP351419 & Lot 1 on SP331698

This is a disclosure plan, the final plan may be subject to change. The proposed lots have not been defined on site, and B.B.H. Pty Ltd Cadastral Surveyor accepts no responsibility for any amendments to location, areas, or shape that may occur during the development process. This plan has been prepared for the purpose of identifying the approximate location and size of registrable interests, and has been derived from information supplied by others. Lot dimensions may vary up to 1% and lot areas may vary by up to 2.0%. Contours, depths and retaining wall heights may vary by up to 0.5m. Lengths and shapes of retaining walls may vary during construction. This note is an integral part of this plan and no part of the plan may be reproduced without this note.

Client:

ID WALLOON DEVELOPMENTS PTY LTD

Locality: WALLOON

Local Gov: ICC Prepared By: GJF

Surveyed By: Approved: MJT

Date Created: 18/06/2025 Scale: 1:250

Comp File: 220149.project

Plan No: **220149_011_DIS**

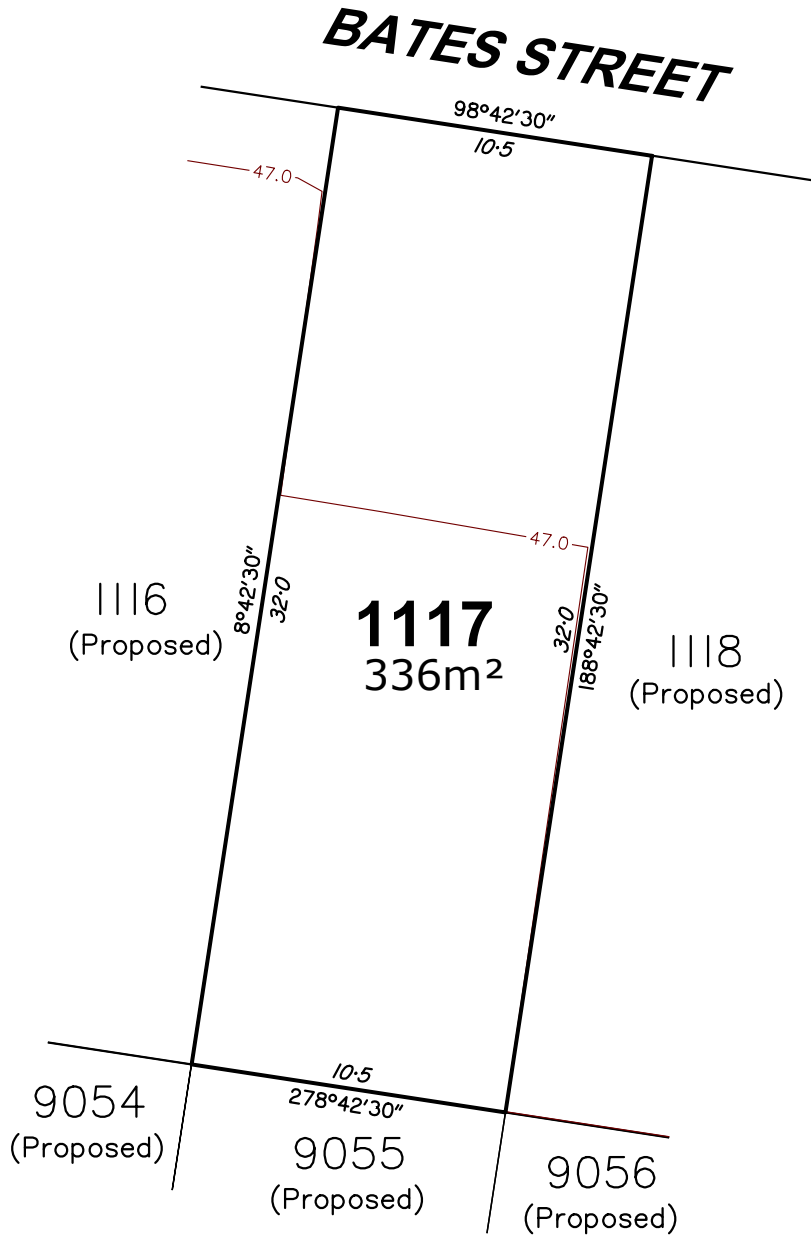

Notes:

1. Drawn to Scale on A4 sheet.
2. All levels are in metres on Australian Height Datum as determined by PSM193875, RL 46.405m AHD.
3. Contour Interval : 0.5m Design.
4. Retaining wall heights are shown at the base of the wall.
5. All dimensions and areas are subject to final survey and approval by ICC.
6. This plan has been prepared for disclosure under the Land Sales Act 1984.
7. This plan was prepared for ID WALLOON DEVELOPMENTS PTY LTD for the purposes of accompanying a sales contract and must not be used for any other purpose.
8. This plan shows details of Proposed Lot 1117 on proposal plan 0714-0279-60-U-01-RP02 Rev 05 which accompanied the Subdivision Application and was approved by Ipswich City Council (DA Ref: 7069/2024/MAMC/A) on 17th June, 2025 subject to conditions.
9. The compaction of earth fill will be undertaken as advised by EGIS and in accordance with the requirements of the Australian Standard AS3798-2007-Level 1.

LEGEND

Approximate Fill Area

24 — Design Contours

Contours (interval 0.5m) based on the Australian Height Datum (AHD) as shown on engineering plan 24-000435 provided by Egis.

H=0.7m
Denotes retaining wall height (H)

AH=0.7m
Denotes retaining wall average height (AH)

I-0 ● Denotes depth of fill

Scale 1:250

Issue	Revision	Int	Date
A	Original Issue	GJF	18/06/2025

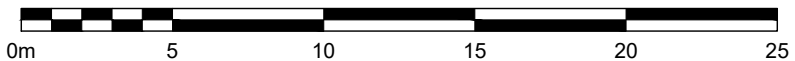

PO Box 5021, GCMC QLD 9726
Ph: (07) 5631 8000
mail@bennettandbennett.com.au

Surveying, Town Planning & Spatial Services
GOLD COAST | BRISBANE | SUNSHINE COAST | NORTHERN RIVERS
www.bennettandbennett.com.au

Title:

Disclosure Plan for Proposed Lot 1117

7001 Taylors Road, Walloon,

Being Part of Lot 4 on SP351419 & Lot 1 on SP331698

This is a disclosure plan, the final plan may be subject to change. The proposed lots have not been defined on site, and B.B.H. Pty Ltd Cadastral Surveyor accepts no responsibility for any amendments to location, areas, or shape that may occur during the development process. This plan has been prepared for the purpose of identifying the approximate location and size of registrable interests, and has been derived from information supplied by others. Lot dimensions may vary up to 1% and lot areas may vary by up to 2.0%. Contours, depths and retaining wall heights may vary by up to 0.5m. Lengths and shapes of retaining walls may vary during construction. This note is an integral part of this plan and no part of the plan may be reproduced without this note.

Client:

ID WALLOON DEVELOPMENTS PTY LTD

Locality: WALLOON

Local Gov: ICC Prepared By: GJF

Surveyed By: Approved: MJT

Date Created: 18/06/2025 Scale: 1:250

Comp File: 220149.project

Plan No: **220149_011_DIS**

Lot 1118

Stage 11

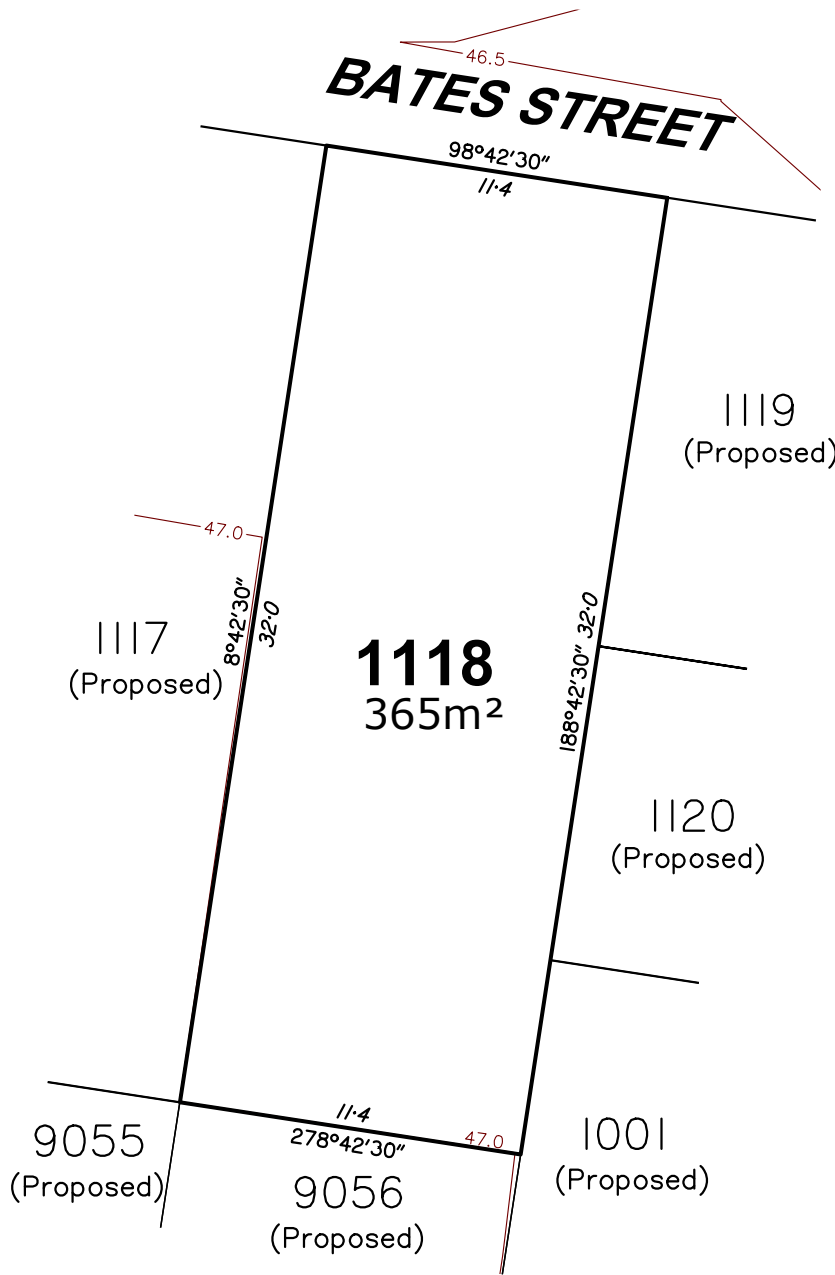

Notes:

1. Drawn to Scale on A4 sheet.
2. All levels are in metres on Australian Height Datum as determined by PSM193875, RL 46.405m AHD.
3. Contour Interval : 0.5m Design.
4. Retaining wall heights are shown at the base of the wall.
5. All dimensions and areas are subject to final survey and approval by ICC.
6. This plan has been prepared for disclosure under the Land Sales Act 1984.
7. This plan was prepared for ID WALLOON DEVELOPMENTS PTY LTD for the purposes of accompanying a sales contract and must not be used for any other purpose.
8. This plan shows details of Proposed Lot 1118 on proposal plan 0714-0279-60-U-01-RP02 Rev 05 which accompanied the Subdivision Application and was approved by Ipswich City Council (DA Ref: 7069/2024/MAMC/A) on 17th June, 2025 subject to conditions.
9. The compaction of earth fill will be undertaken as advised by EGIS and in accordance with the requirements of the Australian Standard AS3798-2007-Level 1.

LEGEND

Approximate Fill Area

24 — Design Contours

Contours (interval 0.5m) based on the Australian Height Datum (AHD) as shown on engineering plan 24-000435 provided by Egis.

H=0.7m
Denotes retaining wall height (H)

AH=0.7m
Denotes retaining wall average height (AH)

I-0 ● Denotes depth of fill

Scale 1:250

Issue	Revision	Int	Date
A	Original Issue	GJF	18/06/2025

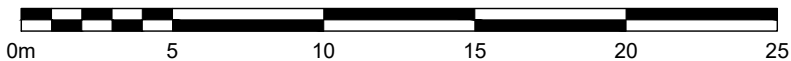

PO Box 5021, GCMC QLD 9726
Ph: (07) 5631 8000
mail@bennettandbennett.com.au

Surveying, Town Planning & Spatial Services
GOLD COAST | BRISBANE | SUNSHINE COAST | NORTHERN RIVERS
www.bennettandbennett.com.au

Title:

Disclosure Plan for Proposed Lot 1118

7001 Taylors Road, Walloon,

Being Part of Lot 4 on SP351419 & Lot 1 on SP331698

This is a disclosure plan, the final plan may be subject to change. The proposed lots have not been defined on site, and B.B.H. Pty Ltd Cadastral Surveyor accepts no responsibility for any amendments to location, areas, or shape that may occur during the development process. This plan has been prepared for the purpose of identifying the approximate location and size of registrable interests, and has been derived from information supplied by others. Lot dimensions may vary up to 1% and lot areas may vary by up to 2.0%. Contours, depths and retaining wall heights may vary by up to 0.5m. Lengths and shapes of retaining walls may vary during construction. This note is an integral part of this plan and no part of the plan may be reproduced without this note.

Client:

ID WALLOON DEVELOPMENTS PTY LTD

Locality: WALLOON

Local Gov: ICC Prepared By: GJF

Surveyed By: Approved: MJT

Date Created: 18/06/2025 Scale: 1:250

Comp File: 220149.project

Plan No: **220149_011_DIS**

Lot 1119

Stage 11

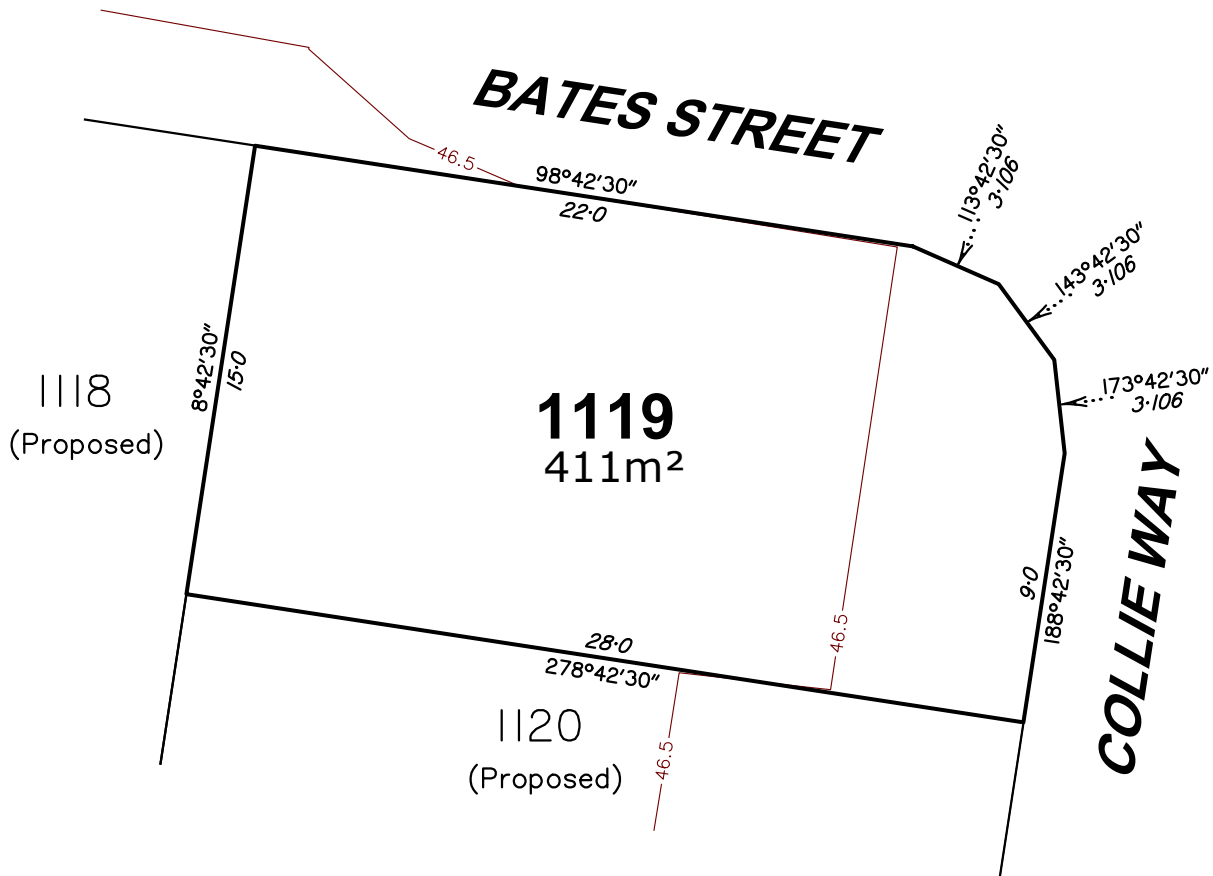

Notes:

1. Drawn to Scale on A4 sheet.
2. All levels are in metres on Australian Height Datum as determined by PSM193875, RL 46.405m AHD.
3. Contour Interval : 0.5m Design.
4. Retaining wall heights are shown at the base of the wall.
5. All dimensions and areas are subject to final survey and approval by ICC.
6. This plan has been prepared for disclosure under the Land Sales Act 1984.
7. This plan was prepared for ID WALLOON DEVELOPMENTS PTY LTD for the purposes of accompanying a sales contract and must not be used for any other purpose.
8. This plan shows details of Proposed Lot 1119 on proposal plan 0714-0279-60-U-01-RP02 Rev 05 which accompanied the Subdivision Application and was approved by Ipswich City Council (DA Ref: 7069/2024/MAMC/A) on 17th June, 2025 subject to conditions.
9. The compaction of earth fill will be undertaken as advised by EGIS and in accordance with the requirements of the Australian Standard AS3798-2007-Level 1.

LEGEND

Approximate Fill Area

24 — Design Contours

Contours (interval 0.5m) based on the Australian Height Datum (AHD) as shown on engineering plan 24-000435 provided by Egis.

H=0.7m Denotes retaining wall height (H)

AH=0.7m Denotes retaining wall average height (AH)

I-0 ● Denotes depth of fill

Scale 1:250

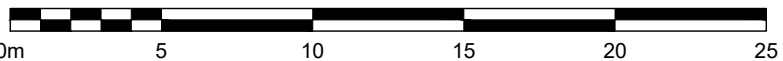

A	Original Issue	GJF	18/06/2025
Issue	Revision	Int	Date

Title:

Disclosure Plan for Proposed Lot 1119

7001 Taylors Road, Walloon,

Being Part of Lot 4 on SP351419 & Lot 1 on SP331698

Client:

ID WALLOON DEVELOPMENTS PTY LTD

Locality: WALLOON

Local Gov: ICC Prepared By: GJF

Surveyed By: Approved: MJT

Date Created: 18/06/2025 Scale: 1:250

Comp File: 220149.project

Plan No: **220149_011_DIS**



PO Box 5021, GCMC QLD 9726
Ph: (07) 5631 8000
mail@bennettandbennett.com.au

Surveying, Town Planning & Spatial Services

GOLD COAST | BRISBANE | SUNSHINE COAST | NORTHERN RIVERS

www.bennettandbennett.com.au

This is a disclosure plan, the final plan may be subject to change. The proposed lots have not been defined on site, and B.B.H. Pty Ltd Cadastral Surveyor accepts no responsibility for any amendments to location, areas, or shape that may occur during the development process. This plan has been prepared for the purpose of identifying the approximate location and size of registrable interests, and has been derived from information supplied by others. Lot dimensions may vary up to 1% and lot areas may vary by up to 2.0%. Contours, depths and retaining wall heights may vary by up to 0.5m. Lengths and shapes of retaining walls may vary during construction. This note is an integral part of this plan and no part of the plan may be reproduced without this note.

Lot 1120

Stage 11

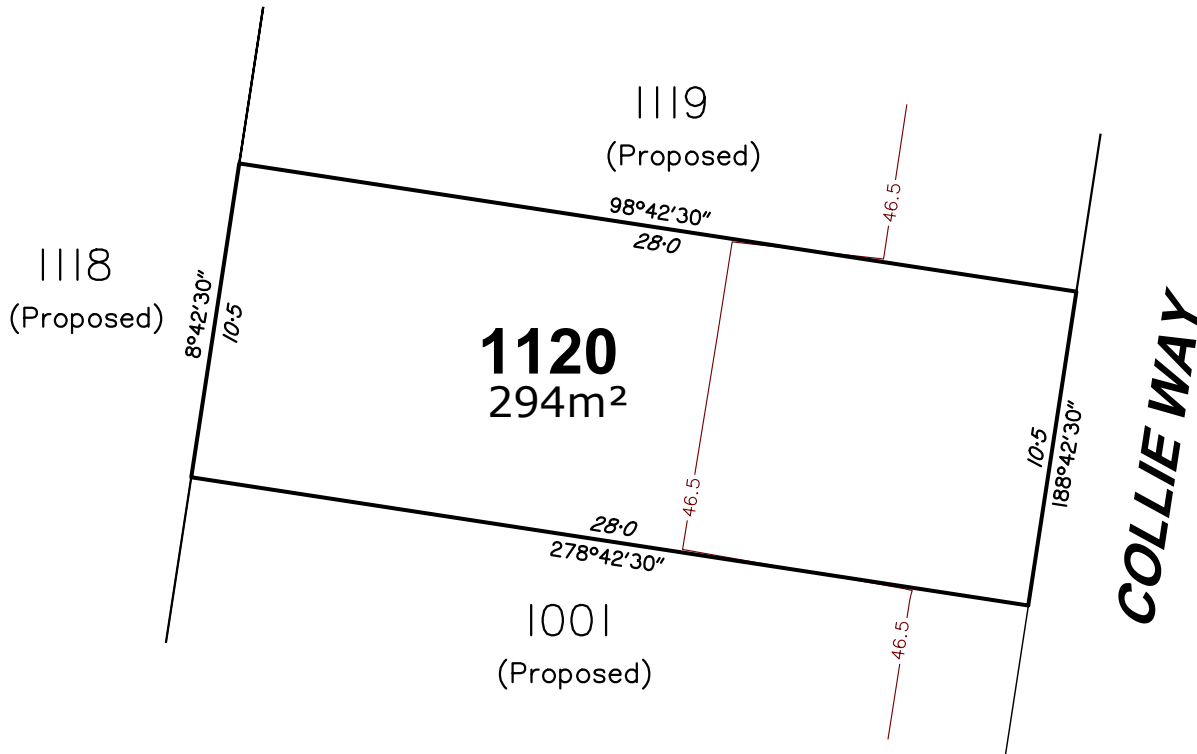

Notes:

1. Drawn to Scale on A4 sheet.
2. All levels are in metres on Australian Height Datum as determined by PSM193875, RL 46.405m AHD.
3. Contour Interval : 0.5m Design.
4. Retaining wall heights are shown at the base of the wall.
5. All dimensions and areas are subject to final survey and approval by ICC.
6. This plan has been prepared for disclosure under the Land Sales Act 1984.
7. This plan was prepared for ID WALLOON DEVELOPMENTS PTY LTD for the purposes of accompanying a sales contract and must not be used for any other purpose.
8. This plan shows details of Proposed Lot 1120 on proposal plan 0714-0279-60-U-01-RP02 Rev 05 which accompanied the Subdivision Application and was approved by Ipswich City Council (DA Ref: 7069/2024/MAMC/A) on 17th June, 2025 subject to conditions.
9. The compaction of earth fill will be undertaken as advised by EGIS and in accordance with the requirements of the Australian Standard AS3798-2007-Level 1.

LEGEND

Approximate Fill Area

24 — Design Contours

Contours (interval 0.5m) based on the Australian Height Datum (AHD) as shown on engineering plan 24-000435 provided by Egis.

H=0.7m Denotes retaining wall height (H)

AH=0.7m Denotes retaining wall average height (AH)

I-0 ● Denotes depth of fill

Scale 1:250

Issue	Revision	Int	Date
A	Original Issue	GJF	18/06/2025

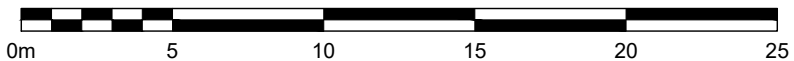

PO Box 5021, GCMC QLD 9726
Ph: (07) 5631 8000
mail@bennettandbennett.com.au

Surveying, Town Planning & Spatial Services
GOLD COAST | BRISBANE | SUNSHINE COAST | NORTHERN RIVERS
www.bennettandbennett.com.au

Title:

Disclosure Plan for Proposed Lot 1120

7001 Taylors Road, Walloon,

Being Part of Lot 4 on SP351419 & Lot 1 on SP331698

This is a disclosure plan, the final plan may be subject to change. The proposed lots have not been defined on site, and B.B.H. Pty Ltd Cadastral Surveyor accepts no responsibility for any amendments to location, areas, or shape that may occur during the development process. This plan has been prepared for the purpose of identifying the approximate location and size of registrable interests, and has been derived from information supplied by others. Lot dimensions may vary up to 1% and lot areas may vary by up to 2.0%. Contours, depths and retaining wall heights may vary by up to 0.5m. Lengths and shapes of retaining walls may vary during construction. This note is an integral part of this plan and no part of the plan may be reproduced without this note.

Client:

ID WALLOON DEVELOPMENTS PTY LTD

Locality: WALLOON

Local Gov: ICC Prepared By: GJF

Surveyed By: Approved: MJT

Date Created: 18/06/2025 Scale: 1:250

Comp File: 220149.project

Plan No: **220149_011_DIS**

Lot 1121

Stage 11

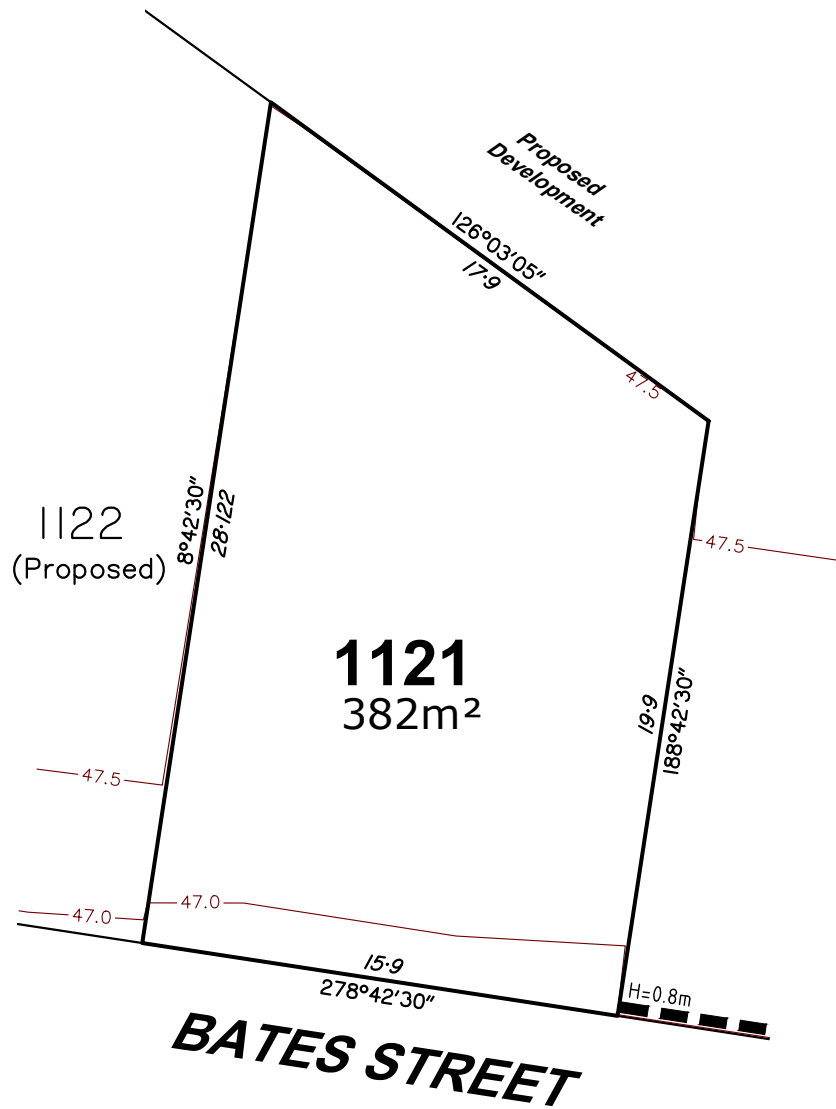

Notes:

1. Drawn to Scale on A4 sheet.
2. All levels are in metres on Australian Height Datum as determined by PSM193875, RL 46.405m AHD.
3. Contour Interval : 0.5m Design.
4. Retaining wall heights are shown at the base of the wall.
5. All dimensions and areas are subject to final survey and approval by ICC.
6. This plan has been prepared for disclosure under the Land Sales Act 1984.
7. This plan was prepared for ID WALLOON DEVELOPMENTS PTY LTD for the purposes of accompanying a sales contract and must not be used for any other purpose.
8. This plan shows details of Proposed Lot 1121 on proposal plan 0714-0279-60-U-01-RP02 Rev 05 which accompanied the Subdivision Application and was approved by Ipswich City Council (DA Ref: 7069/2024/MAMC/A) on 17th June, 2025 subject to conditions.
9. The compaction of earth fill will be undertaken as advised by EGIS and in accordance with the requirements of the Australian Standard AS3798-2007-Level 1.

LEGEND

Approximate Fill Area

24 — Design Contours

Contours (interval 0.5m) based on the Australian Height Datum (AHD) as shown on engineering plan 24-000435 provided by Egis.

H=0.7m
Denotes retaining wall height (H)

AH=0.7m
Denotes retaining wall average height (AH)

I=0 ● Denotes depth of fill

Scale 1:250

Issue	Revision	Int	Date
A	Original Issue	GJF	18/06/2025



PO Box 5021, GCMC QLD 9726
Ph: (07) 5631 8000
mail@bennettandbennett.com.au

Surveying, Town Planning & Spatial Services

GOLD COAST | BRISBANE | SUNSHINE COAST | NORTHERN RIVERS

www.bennettandbennett.com.au

Title:

Disclosure Plan for Proposed Lot 1121

7001 Taylors Road, Walloon,

Being Part of Lot 4 on SP351419 & Lot 1 on SP331698

This is a disclosure plan, the final plan may be subject to change. The proposed lots have not been defined on site, and B.B.H. Pty Ltd Cadastral Surveyor accepts no responsibility for any amendments to location, areas, or shape that may occur during the development process. This plan has been prepared for the purpose of identifying the approximate location and size of registrable interests, and has been derived from information supplied by others. Lot dimensions may vary up to 1% and lot areas may vary by up to 2.0%. Contours, depths and retaining wall heights may vary by up to 0.5m. Lengths and shapes of retaining walls may vary during construction. This note is an integral part of this plan and no part of the plan may be reproduced without this note.

Client:

ID WALLOON DEVELOPMENTS PTY LTD

Locality: WALLOON

Local Gov: ICC Prepared By: GJF

Surveyed By: Approved: MJT

Date Created: 18/06/2025 Scale: 1:250

Comp File: 220149.project

Plan No: **220149_011_DIS**

Lot 1122

Stage 11



Notes:

1. Drawn to Scale on A4 sheet.
2. All levels are in metres on Australian Height Datum as determined by PSM193875, RL 46.405m AHD.
3. Contour Interval : 0.5m Design.
4. Retaining wall heights are shown at the base of the wall.
5. All dimensions and areas are subject to final survey and approval by ICC.
6. This plan has been prepared for disclosure under the Land Sales Act 1984.
7. This plan was prepared for ID WALLOON DEVELOPMENTS PTY LTD for the purposes of accompanying a sales contract and must not be used for any other purpose.
8. This plan shows details of Proposed Lot 1122 on proposal plan 0714-0279-60-U-01-RP02 Rev 05 which accompanied the Subdivision Application and was approved by Ipswich City Council (DA Ref: 7069/2024/MAMC/A) on 17th June, 2025 subject to conditions.
9. The compaction of earth fill will be undertaken as advised by EGIS and in accordance with the requirements of the Australian Standard AS3798-2007-Level 1.

LEGEND

Approximate Fill Area

24 — Design Contours

Contours (interval 0.5m) based on the Australian Height Datum (AHD) as shown on engineering plan 24-000435 provided by Egis.

H=0.7m
Denotes retaining wall height (H)

AH=0.7m
Denotes retaining wall average height (AH)

1.0 ● Denotes depth of fill

Scale 1:250

Issue	Revision	Int	Date
A	Original Issue	GJF	18/06/2025



PO Box 5021, GCMC QLD 9726
Ph: (07) 5631 8000
mail@bennettandbennett.com.au

Surveying, Town Planning & Spatial Services

GOLD COAST | BRISBANE | SUNSHINE COAST | NORTHERN RIVERS

www.bennettandbennett.com.au

Title:

Disclosure Plan for Proposed Lot 1122

7001 Taylors Road, Walloon,

Being Part of Lot 4 on SP351419 & Lot 1 on SP331698

This is a disclosure plan, the final plan may be subject to change. The proposed lots have not been defined on site, and B.B.H. Pty Ltd Cadastral Surveyor accepts no responsibility for any amendments to location, areas, or shape that may occur during the development process. This plan has been prepared for the purpose of identifying the approximate location and size of registrable interests, and has been derived from information supplied by others. Lot dimensions may vary up to 1% and lot areas may vary by up to 2.0%. Contours, depths and retaining wall heights may vary by up to 0.5m. Lengths and shapes of retaining walls may vary during construction. This note is an integral part of this plan and no part of the plan may be reproduced without this note.

Client:

ID WALLOON DEVELOPMENTS PTY LTD

Locality: WALLOON

Local Gov: ICC Prepared By: GJF

Surveyed By: Approved: MJT

Date Created: 18/06/2025 Scale: 1:250

Comp File: 220149.project

Plan No: **220149_011_DIS**

Lot 1123

Stage 11

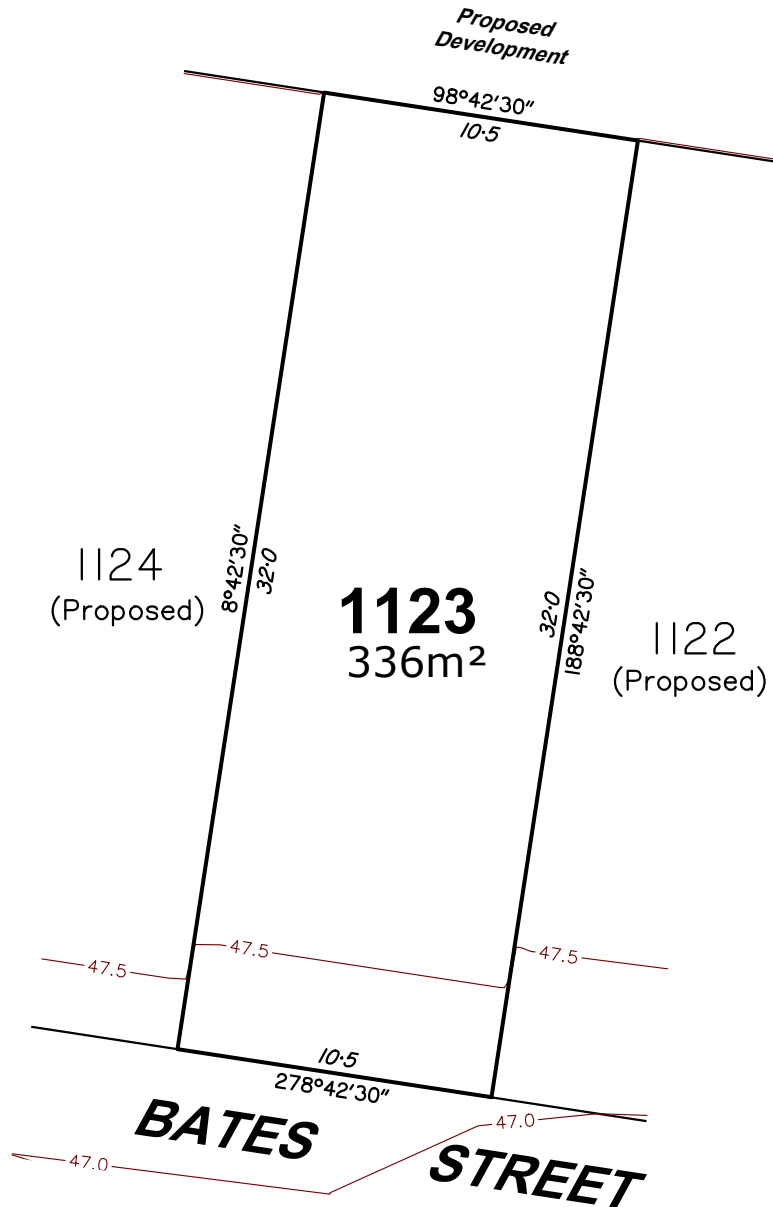

Notes:

1. Drawn to Scale on A4 sheet.
2. All levels are in metres on Australian Height Datum as determined by PSM193875, RL 46.405m AHD.
3. Contour Interval : 0.5m Design.
4. Retaining wall heights are shown at the base of the wall.
5. All dimensions and areas are subject to final survey and approval by ICC.
6. This plan has been prepared for disclosure under the Land Sales Act 1984.
7. This plan was prepared for ID WALLOON DEVELOPMENTS PTY LTD for the purposes of accompanying a sales contract and must not be used for any other purpose.
8. This plan shows details of Proposed Lot 1123 on proposal plan 0714-0279-60-U-01-RP02 Rev 05 which accompanied the Subdivision Application and was approved by Ipswich City Council (DA Ref: 7069/2024/MAMC/A) on 17th June, 2025 subject to conditions.
9. The compaction of earth fill will be undertaken as advised by EGIS and in accordance with the requirements of the Australian Standard AS3798-2007-Level 1.

LEGEND

- Approximate Fill Area
- 24 — Design Contours
- Contours (interval 0.5m) based on the Australian Height Datum (AHD) as shown on engineering plan 24-000435 provided by Egis.
- H=0.7m Denotes retaining wall height (H)
- AH=0.7m Denotes retaining wall average height (AH)
- I-0 ● Denotes depth of fill

Scale 1:250

A	Original Issue	GJF	18/06/2025
Issue	Revision	Int	Date



BENNETT + BENNETT

PO Box 5021, GCMC QLD 9726
Ph: (07) 5631 8000
mail@bennettandbennett.com.au

Surveying, Town Planning & Spatial Services
GOLD COAST | BRISBANE | SUNSHINE COAST | NORTHERN RIVERS
www.bennettandbennett.com.au

Title: **Disclosure Plan for Proposed Lot 1123**
7001 Taylors Road, Walloon,
Being Part of Lot 4 on SP351419 & Lot 1 on SP331698

This is a disclosure plan, the final plan may be subject to change. The proposed lots have not been defined on site, and B.B.H. Pty Ltd Cadastral Surveyor accepts no responsibility for any amendments to location, areas, or shape that may occur during the development process. This plan has been prepared for the purpose of identifying the approximate location and size of registrable interests, and has been derived from information supplied by others. Lot dimensions may vary up to 1% and lot areas may vary by up to 2.0%. Contours, depths and retaining wall heights may vary by up to 0.5m. Lengths and shapes of retaining walls may vary during construction. This note is an integral part of this plan and no part of the plan may be reproduced without this note.

Client:	ID WALLOON DEVELOPMENTS PTY LTD
Local Gov:	WALLOON
Local Gov:	ICC
Prepared By:	GJF
Surveyed By:	MJT
Approved:	MJT
Date Created:	18/06/2025
Scale:	1:250
Comp File:	220149.project
Plan No:	220149_011_DIS

Lot 1124

Stage 11

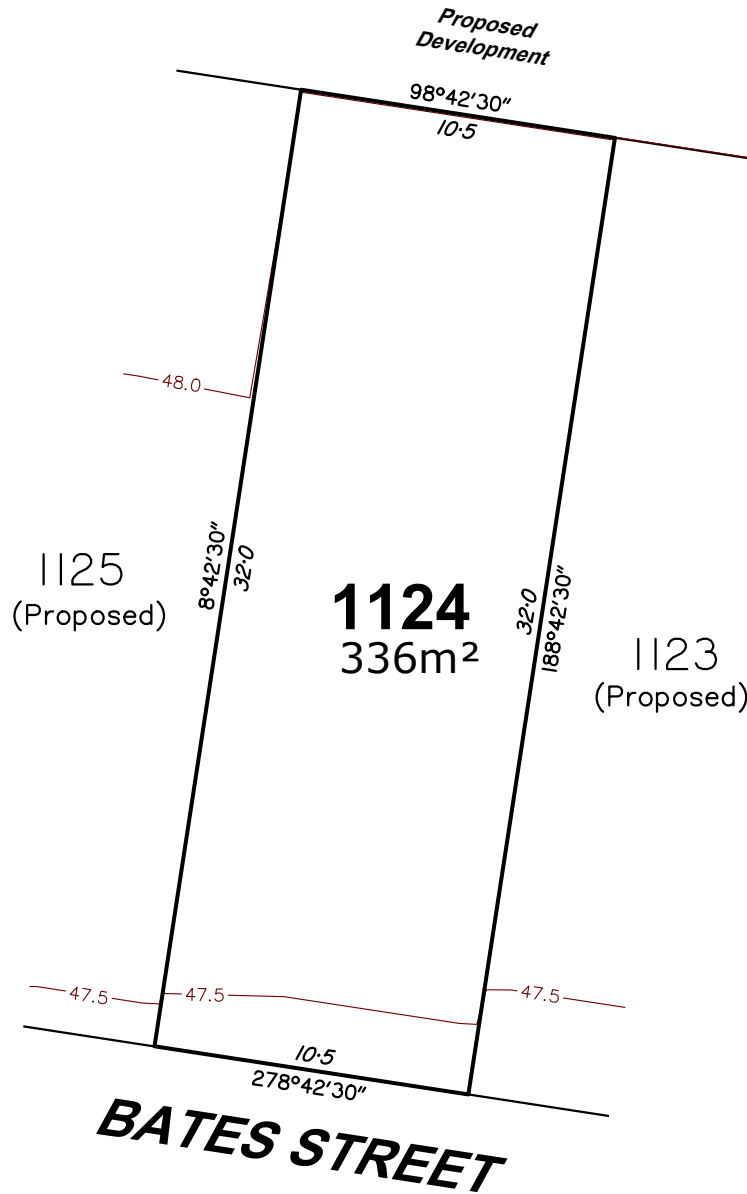

Notes:

1. Drawn to Scale on A4 sheet.
2. All levels are in metres on Australian Height Datum as determined by PSM193875, RL 46.405m AHD.
3. Contour Interval : 0.5m Design.
4. Retaining wall heights are shown at the base of the wall.
5. All dimensions and areas are subject to final survey and approval by ICC.
6. This plan has been prepared for disclosure under the Land Sales Act 1984.
7. This plan was prepared for ID WALLOON DEVELOPMENTS PTY LTD for the purposes of accompanying a sales contract and must not be used for any other purpose.
8. This plan shows details of Proposed Lot 1124 on proposal plan 0714-0279-60-U-01-RP02 Rev 05 which accompanied the Subdivision Application and was approved by Ipswich City Council (DA Ref: 7069/2024/MAMC/A) on 17th June, 2025 subject to conditions.
9. The compaction of earth fill will be undertaken as advised by EGIS and in accordance with the requirements of the Australian Standard AS3798-2007-Level 1.

LEGEND

Approximate Fill Area

24 — Design Contours

Contours (interval 0.5m) based on the Australian Height Datum (AHD) as shown on engineering plan 24-000435 provided by Egis.

H=0.7m
Denotes retaining wall height (H)

AH=0.7m
Denotes retaining wall average height (AH)

I-0 ● Denotes depth of fill

Scale 1:250

Issue	Revision	Int	Date
A	Original Issue	GJF	18/06/2025

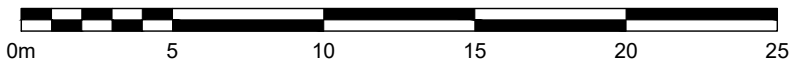

PO Box 5021, GCMC QLD 9726
Ph: (07) 5631 8000
mail@bennettandbennett.com.au

Surveying, Town Planning & Spatial Services
GOLD COAST | BRISBANE | SUNSHINE COAST | NORTHERN RIVERS
www.bennettandbennett.com.au

Title:

Disclosure Plan for Proposed Lot 1124

7001 Taylors Road, Walloon,

Being Part of Lot 4 on SP351419 & Lot 1 on SP331698

This is a disclosure plan, the final plan may be subject to change. The proposed lots have not been defined on site, and B.B.H. Pty Ltd Cadastral Surveyor accepts no responsibility for any amendments to location, areas, or shape that may occur during the development process. This plan has been prepared for the purpose of identifying the approximate location and size of registrable interests, and has been derived from information supplied by others. Lot dimensions may vary up to 1% and lot areas may vary by up to 2.0%. Contours, depths and retaining wall heights may vary by up to 0.5m. Lengths and shapes of retaining walls may vary during construction. This note is an integral part of this plan and no part of the plan may be reproduced without this note.

Client:

ID WALLOON DEVELOPMENTS PTY LTD

Locality: WALLOON

Local Gov: ICC Prepared By: GJF

Surveyed By: Approved: MJT

Date Created: 18/06/2025 Scale: 1:250

Comp File: 220149.project

Plan No: **220149_011_DIS**

Lot 1125

Stage 11

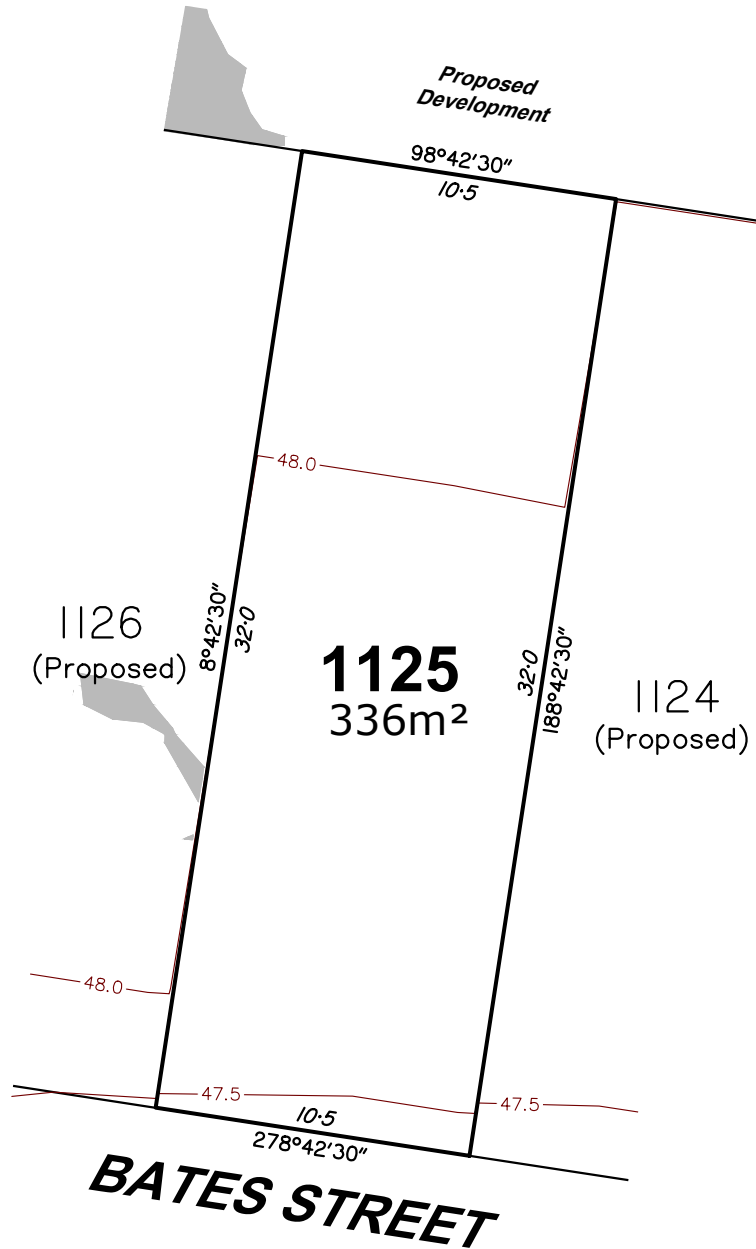

Notes:

1. Drawn to Scale on A4 sheet.
2. All levels are in metres on Australian Height Datum as determined by PSM193875, RL 46.405m AHD.
3. Contour Interval : 0.5m Design.
4. Retaining wall heights are shown at the base of the wall.
5. All dimensions and areas are subject to final survey and approval by ICC.
6. This plan has been prepared for disclosure under the Land Sales Act 1984.
7. This plan was prepared for ID WALLOON DEVELOPMENTS PTY LTD for the purposes of accompanying a sales contract and must not be used for any other purpose.
8. This plan shows details of Proposed Lot 1125 on proposal plan 0714-0279-60-U-01-RP02 Rev 05 which accompanied the Subdivision Application and was approved by Ipswich City Council (DA Ref: 7069/2024/MAMC/A) on 17th June, 2025 subject to conditions.
9. The compaction of earth fill will be undertaken as advised by EGIS and in accordance with the requirements of the Australian Standard AS3798-2007-Level 1.

LEGEND

Approximate Fill Area

24 — Design Contours

Contours (interval 0.5m) based on the Australian Height Datum (AHD) as shown on engineering plan 24-000435 provided by Egis.

H=0.7m Denotes retaining wall height (H)

AH=0.7m Denotes retaining wall average height (AH)

I-0 ● Denotes depth of fill

Scale 1:250

Issue	Revision	Int	Date
A	Original Issue	GJF	18/06/2025

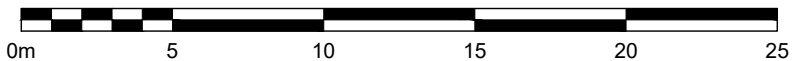

PO Box 5021, GCMC QLD 9726
Ph: (07) 5631 8000
mail@bennettandbennett.com.au

Surveying, Town Planning & Spatial Services

GOLD COAST | BRISBANE | SUNSHINE COAST | NORTHERN RIVERS

www.bennettandbennett.com.au

Title:

Disclosure Plan for Proposed Lot 1125

7001 Taylors Road, Walloon,

Being Part of Lot 4 on SP351419 & Lot 1 on SP331698

This is a disclosure plan, the final plan may be subject to change. The proposed lots have not been defined on site, and B.B.H. Pty Ltd Cadastral Surveyor accepts no responsibility for any amendments to location, areas, or shape that may occur during the development process. This plan has been prepared for the purpose of identifying the approximate location and size of registrable interests, and has been derived from information supplied by others. Lot dimensions may vary up to 1% and lot areas may vary by up to 2.0%. Contours, depths and retaining wall heights may vary by up to 0.5m. Lengths and shapes of retaining walls may vary during construction. This note is an integral part of this plan and no part of the plan may be reproduced without this note.

Client:

ID WALLOON DEVELOPMENTS PTY LTD

Locality: WALLOON

Local Gov: ICC Prepared By: GJF

Surveyed By: Approved: MJT

Date Created: 18/06/2025 Scale: 1:250

Comp File: 220149.project

Plan No: **220149_011_DIS**

Lot 1126

Stage 11

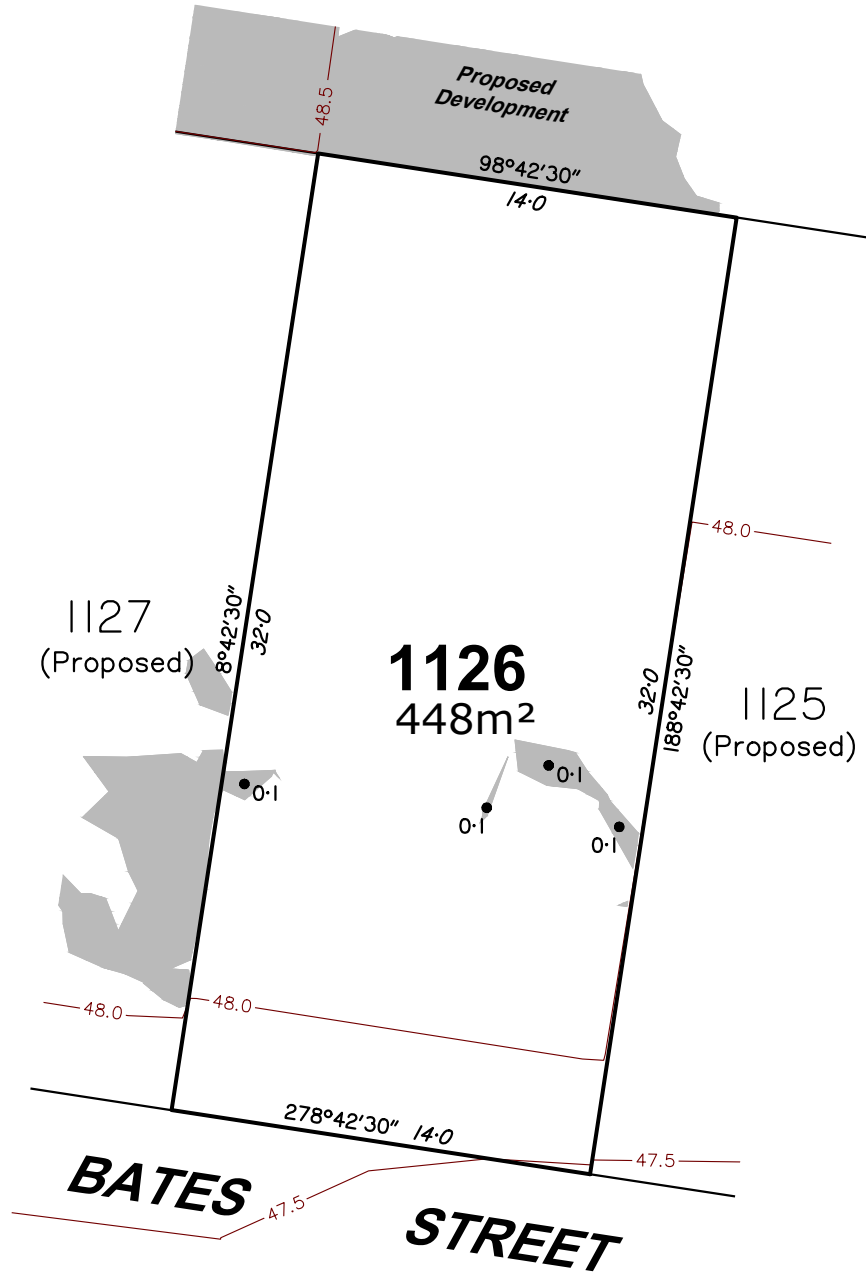

Notes:

1. Drawn to Scale on A4 sheet.
2. All levels are in metres on Australian Height Datum as determined by PSM193875, RL 46.405m AHD.
3. Contour Interval : 0.5m Design.
4. Retaining wall heights are shown at the base of the wall.
5. All dimensions and areas are subject to final survey and approval by ICC.
6. This plan has been prepared for disclosure under the Land Sales Act 1984.
7. This plan was prepared for ID WALLOON DEVELOPMENTS PTY LTD for the purposes of accompanying a sales contract and must not be used for any other purpose.
8. This plan shows details of Proposed Lot 1126 on proposal plan 0714-0279-60-U-01-RP02 Rev 05 which accompanied the Subdivision Application and was approved by Ipswich City Council (DA Ref: 7069/2024/MAMC/A) on 17th June, 2025 subject to conditions.
9. The compaction of earth fill will be undertaken as advised by EGIS and in accordance with the requirements of the Australian Standard AS3798-2007-Level 1.

LEGEND

- Approximate Fill Area
- 24 — Design Contours
- Contours (interval 0.5m) based on the Australian Height Datum (AHD) as shown on engineering plan 24-000435 provided by Egis.
- Denotes retaining wall height (H)
- Denotes retaining wall average height (AH)
- Denotes depth of fill

H=0.7m
AH=0.7m

Scale 1:250

Issue	Revision	Int	Date
A	Original Issue	GJF	18/06/2025



PO Box 5021, GCMC QLD 9726
Ph: (07) 5631 8000
mail@bennettandbennett.com.au

Surveying, Town Planning & Spatial Services
GOLD COAST | BRISBANE | SUNSHINE COAST | NORTHERN RIVERS
www.bennettandbennett.com.au

Title:

Disclosure Plan for Proposed Lot 1126

7001 Taylors Road, Walloon,

Being Part of Lot 4 on SP351419 & Lot 1 on SP331698

This is a disclosure plan, the final plan may be subject to change. The proposed lots have not been defined on site, and B.B.H. Pty Ltd Cadastral Surveyor accepts no responsibility for any amendments to location, areas, or shape that may occur during the development process. This plan has been prepared for the purpose of identifying the approximate location and size of registrable interests, and has been derived from information supplied by others. Lot dimensions may vary up to 1% and lot areas may vary by up to 2.0%. Contours, depths and retaining wall heights may vary by up to 0.5m. Lengths and shapes of retaining walls may vary during construction. This note is an integral part of this plan and no part of the plan may be reproduced without this note.

Client:

ID WALLOON DEVELOPMENTS PTY LTD

Locality:

WALLOON

Local Gov:

ICC

Prepared By: GJF

Surveyed By:

Approved: MJT

Date Created:

18/06/2025

Scale: 1:250

Comp File:

220149.project

Plan No:

220149_011_DIS

Lot 1127

Stage 11

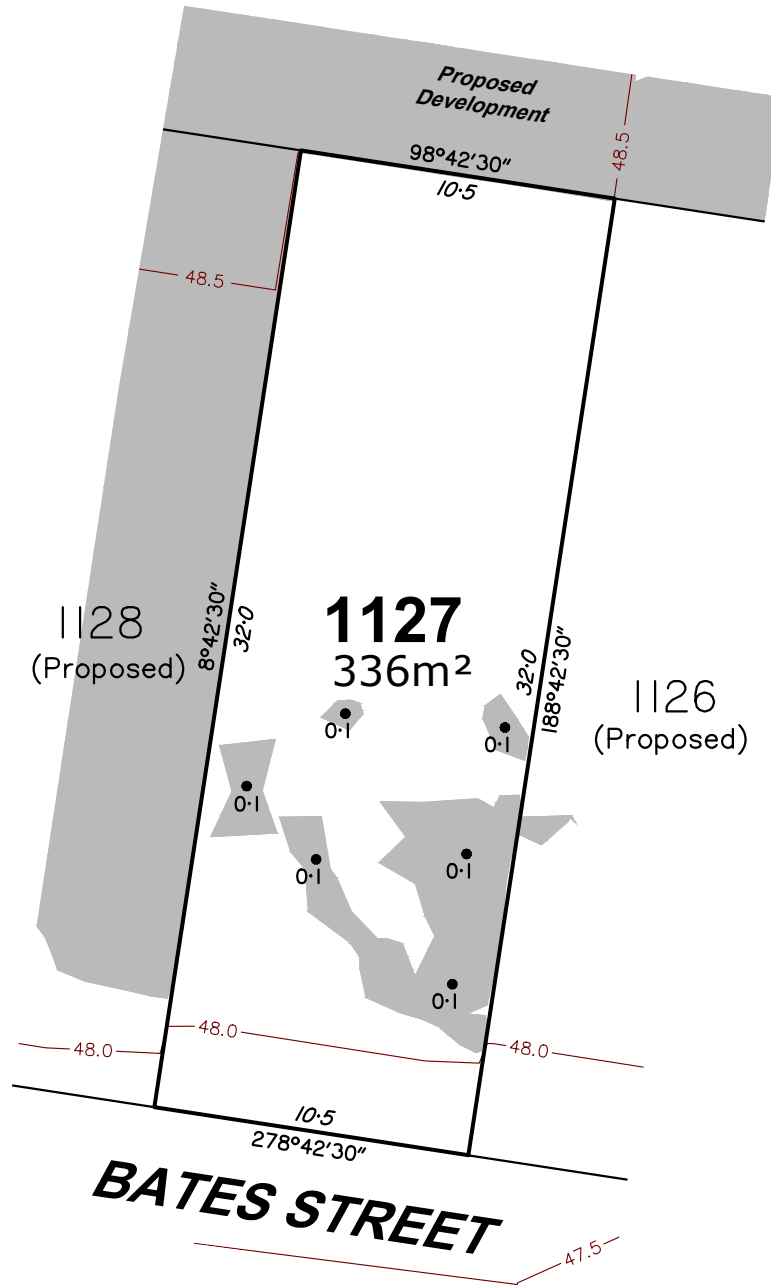

Notes:

1. Drawn to Scale on A4 sheet.
2. All levels are in metres on Australian Height Datum as determined by PSM193875, RL 46.405m AHD.
3. Contour Interval : 0.5m Design.
4. Retaining wall heights are shown at the base of the wall.
5. All dimensions and areas are subject to final survey and approval by ICC.
6. This plan has been prepared for disclosure under the Land Sales Act 1984.
7. This plan was prepared for ID WALLOON DEVELOPMENTS PTY LTD for the purposes of accompanying a sales contract and must not be used for any other purpose.
8. This plan shows details of Proposed Lot 1127 on proposal plan 0714-0279-60-U-01-RP02 Rev 05 which accompanied the Subdivision Application and was approved by Ipswich City Council (DA Ref: 7069/2024/MAMC/A) on 17th June, 2025 subject to conditions.
9. The compaction of earth fill will be undertaken as advised by EGIS and in accordance with the requirements of the Australian Standard AS3798-2007-Level 1.

LEGEND

- Approximate Fill Area
- 24 — Design Contours
- Contours (interval 0.5m) based on the Australian Height Datum (AHD) as shown on engineering plan 24-000435 provided by Egis.
- H=0.7m
 AH=0.7m
Denotes retaining wall height (H)
- Denotes retaining wall average height (AH)
- I-0 ● Denotes depth of fill

Scale 1:250

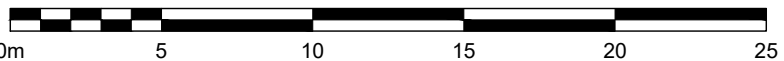

A	Original Issue	GJF	18/06/2025
Issue	Revision	Int	Date



PO Box 5021, GCMC QLD 9726
Ph: (07) 5631 8000
mail@bennettandbennett.com.au

Surveying, Town Planning & Spatial Services

GOLD COAST | BRISBANE | SUNSHINE COAST | NORTHERN RIVERS

www.bennettandbennett.com.au

Title:

Disclosure Plan for Proposed Lot 1127

7001 Taylors Road, Walloon,

Being Part of Lot 4 on SP351419 & Lot 1 on SP331698

This is a disclosure plan, the final plan may be subject to change. The proposed lots have not been defined on site, and B.B.H. Pty Ltd Cadastral Surveyor accepts no responsibility for any amendments to location, areas, or shape that may occur during the development process. This plan has been prepared for the purpose of identifying the approximate location and size of registrable interests, and has been derived from information supplied by others. Lot dimensions may vary up to 1% and lot areas may vary by up to 2.0%. Contours, depths and retaining wall heights may vary by up to 0.5m. Lengths and shapes of retaining walls may vary during construction. This note is an integral part of this plan and no part of the plan may be reproduced without this note.

Client:

ID WALLOON DEVELOPMENTS PTY LTD

Locality: WALLOON

Local Gov: ICC Prepared By: GJF

Surveyed By: Approved: MJT

Date Created: 18/06/2025 Scale: 1:250

Comp File: 220149.project

Plan No: **220149_011_DIS**

Lot 1128

Stage 11

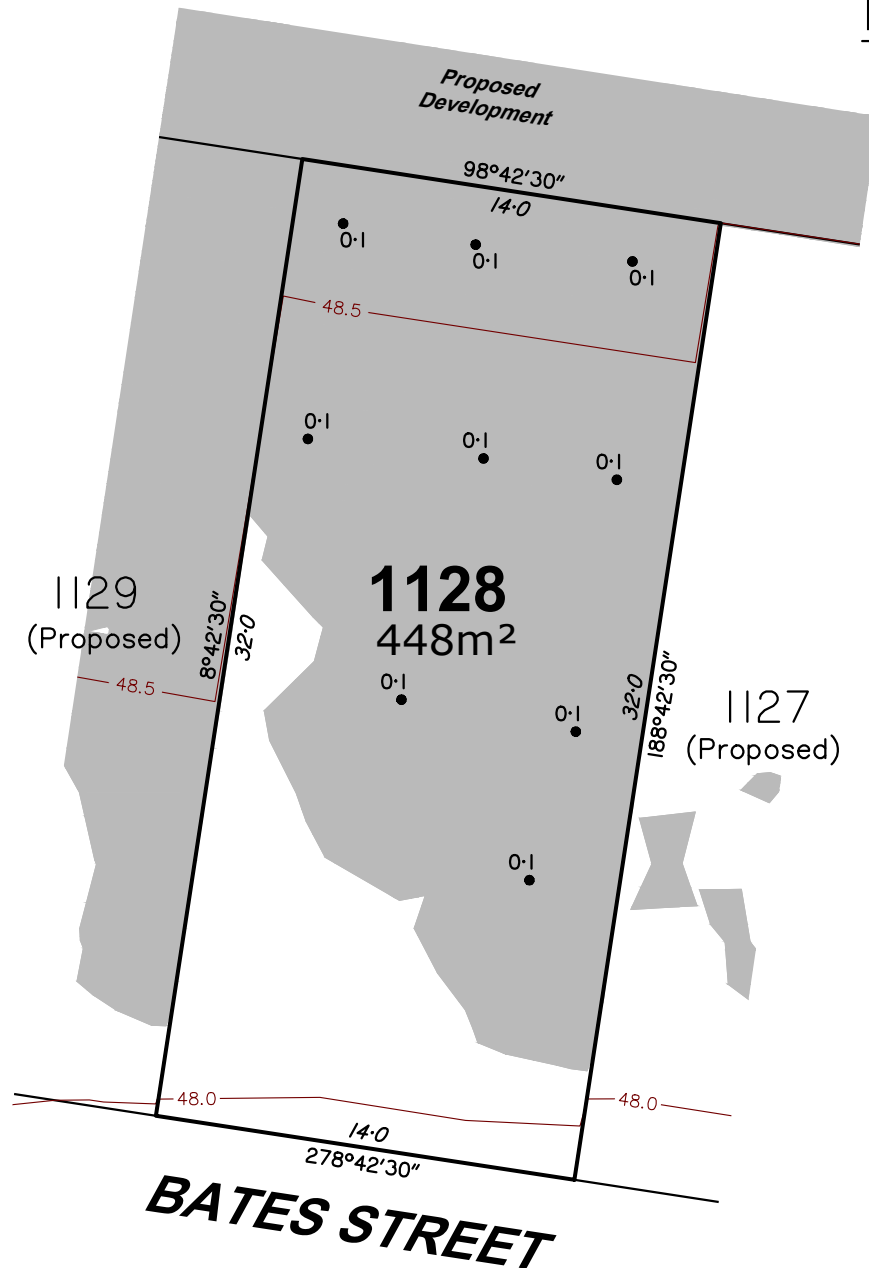

Notes:

1. Drawn to Scale on A4 sheet.
2. All levels are in metres on Australian Height Datum as determined by PSM193875, RL 46.405m AHD.
3. Contour Interval : 0.5m Design.
4. Retaining wall heights are shown at the base of the wall.
5. All dimensions and areas are subject to final survey and approval by ICC.
6. This plan has been prepared for disclosure under the Land Sales Act 1984.
7. This plan was prepared for ID WALLOON DEVELOPMENTS PTY LTD for the purposes of accompanying a sales contract and must not be used for any other purpose.
8. This plan shows details of Proposed Lot 1128 on proposal plan 0714-0279-60-U-01-RP02 Rev 05 which accompanied the Subdivision Application and was approved by Ipswich City Council (DA Ref: 7069/2024/MAMC/A) on 17th June, 2025 subject to conditions.
9. The compaction of earth fill will be undertaken as advised by EGIS and in accordance with the requirements of the Australian Standard AS3798-2007-Level 1.

LEGEND

- Approximate Fill Area
- 24 Design Contours
- Contours (interval 0.5m) based on the Australian Height Datum (AHD) as shown on engineering plan 24-000435 provided by Egis.
- Denotes retaining wall height (H)
- Denotes retaining wall average height (AH)
- Denotes depth of fill

H=0.7m
AH=0.7m

Scale 1:250

Issue	Revision	Int	Date
A	Original Issue	GJF	18/06/2025



PO Box 5021, GCMC QLD 9726
Ph: (07) 5631 8000
mail@bennettandbennett.com.au

Surveying, Town Planning & Spatial Services
GOLD COAST | BRISBANE | SUNSHINE COAST | NORTHERN RIVERS
www.bennettandbennett.com.au

Title:

Disclosure Plan for Proposed Lot 1128

7001 Taylors Road, Walloon,

Being Part of Lot 4 on SP351419 & Lot 1 on SP331698

This is a disclosure plan, the final plan may be subject to change. The proposed lots have not been defined on site, and B.B.H. Pty Ltd Cadastral Surveyor accepts no responsibility for any amendments to location, areas, or shape that may occur during the development process. This plan has been prepared for the purpose of identifying the approximate location and size of registrable interests, and has been derived from information supplied by others. Lot dimensions may vary up to 1% and lot areas may vary by up to 2.0%. Contours, depths and retaining wall heights may vary by up to 0.5m. Lengths and shapes of retaining walls may vary during construction. This note is an integral part of this plan and no part of the plan may be reproduced without this note.

Client:

ID WALLOON DEVELOPMENTS PTY LTD

Locality: WALLOON

Local Gov: ICC Prepared By: GJF

Surveyed By: Approved: MJT

Date Created: 18/06/2025 Scale: 1:250

Comp File: 220149.project

Plan No: **220149_011_DIS**

Lot 1129

Stage 11

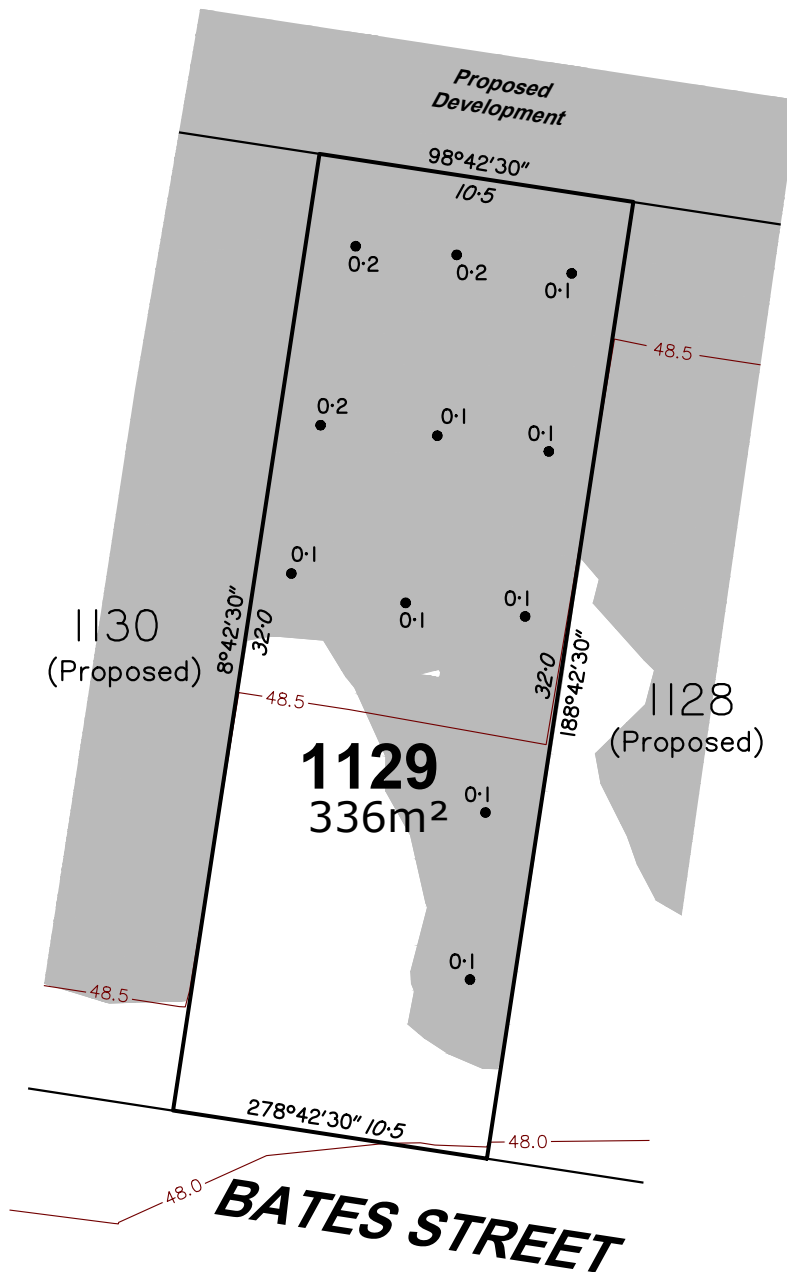

Notes:

1. Drawn to Scale on A4 sheet.
2. All levels are in metres on Australian Height Datum as determined by PSM193875, RL 46.405m AHD.
3. Contour Interval : 0.5m Design.
4. Retaining wall heights are shown at the base of the wall.
5. All dimensions and areas are subject to final survey and approval by ICC.
6. This plan has been prepared for disclosure under the Land Sales Act 1984.
7. This plan was prepared for ID WALLOON DEVELOPMENTS PTY LTD for the purposes of accompanying a sales contract and must not be used for any other purpose.
8. This plan shows details of Proposed Lot 1129 on proposal plan 0714-0279-60-U-01-RP02 Rev 05 which accompanied the Subdivision Application and was approved by Ipswich City Council (DA Ref: 7069/2024/MAMC/A) on 17th June, 2025 subject to conditions.
9. The compaction of earth fill will be undertaken as advised by EGIS and in accordance with the requirements of the Australian Standard AS3798-2007-Level 1.

LEGEND

Approximate Fill Area

24 Design Contours

Contours (interval 0.5m) based on the Australian Height Datum (AHD) as shown on engineering plan 24-000435 provided by Egis.

H=0.7m Denotes retaining wall height (H)

AH=0.7m Denotes retaining wall average height (AH)

I-0 Denotes depth of fill

Scale 1:250

Issue	Revision	Int	Date
A	Original Issue	GJF	18/06/2025



PO Box 5021, GCMC QLD 9726
Ph: (07) 5631 8000
mail@bennettandbennett.com.au

Surveying, Town Planning & Spatial Services

GOLD COAST | BRISBANE | SUNSHINE COAST | NORTHERN RIVERS

www.bennettandbennett.com.au

Title:

Disclosure Plan for Proposed Lot 1129

7001 Taylors Road, Walloon,

Being Part of Lot 4 on SP351419 & Lot 1 on SP331698

This is a disclosure plan, the final plan may be subject to change. The proposed lots have not been defined on site, and B.B.H. Pty Ltd Cadastral Surveyor accepts no responsibility for any amendments to location, areas, or shape that may occur during the development process. This plan has been prepared for the purpose of identifying the approximate location and size of registrable interests, and has been derived from information supplied by others. Lot dimensions may vary up to 1% and lot areas may vary by up to 2.0%. Contours, depths and retaining wall heights may vary by up to 0.5m. Lengths and shapes of retaining walls may vary during construction. This note is an integral part of this plan and no part of the plan may be reproduced without this note.

Client:

ID WALLOON DEVELOPMENTS PTY LTD

Locality: WALLOON

Local Gov: ICC Prepared By: GJF

Surveyed By: Approved: MJT

Date Created: 18/06/2025 Scale: 1:250

Comp File: 220149.project

Plan No: **220149_011_DIS**

Lot 1130

Stage 11

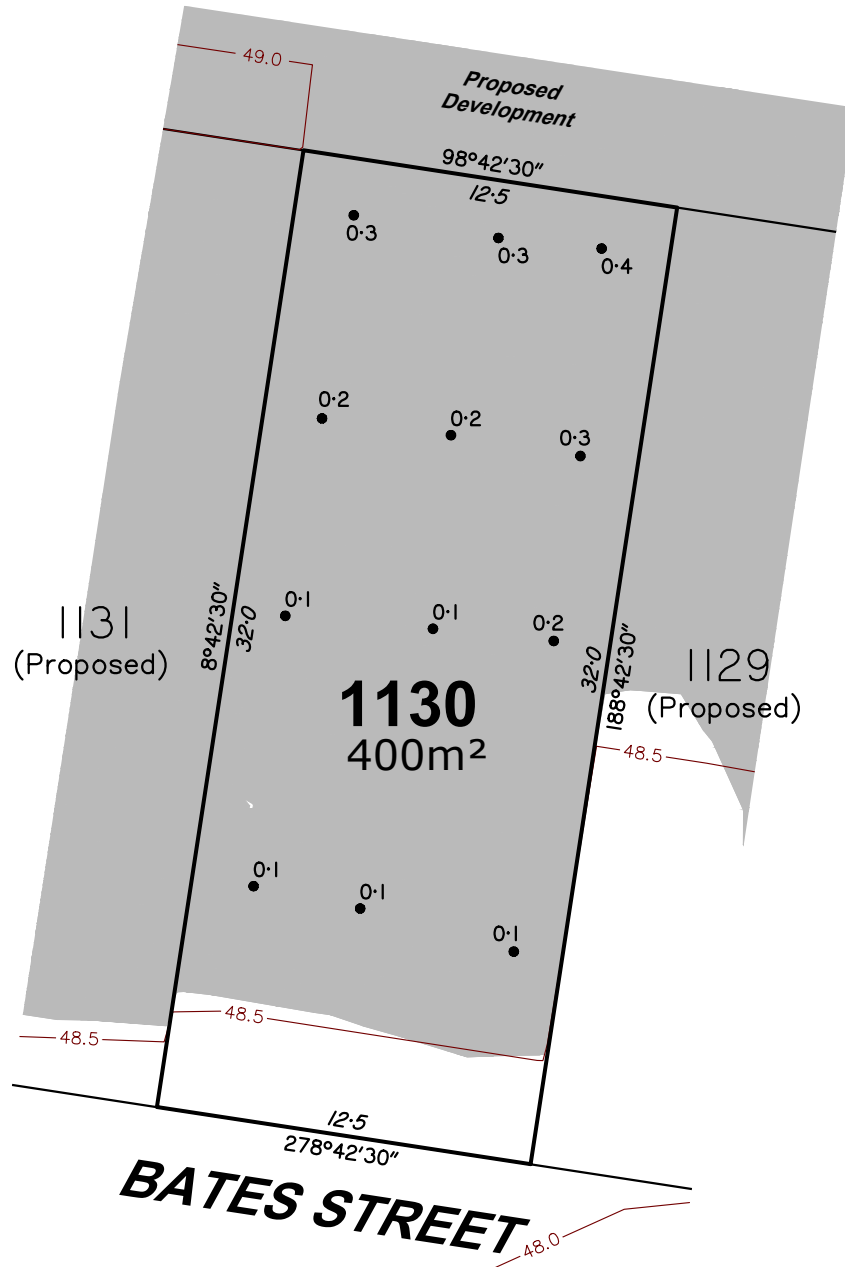

Notes:

1. Drawn to Scale on A4 sheet.
2. All levels are in metres on Australian Height Datum as determined by PSM193875, RL 46.405m AHD.
3. Contour Interval : 0.5m Design.
4. Retaining wall heights are shown at the base of the wall.
5. All dimensions and areas are subject to final survey and approval by ICC.
6. This plan has been prepared for disclosure under the Land Sales Act 1984.
7. This plan was prepared for ID WALLOON DEVELOPMENTS PTY LTD for the purposes of accompanying a sales contract and must not be used for any other purpose.
8. This plan shows details of Proposed Lot 1130 on proposal plan 0714-0279-60-U-01-RP02 Rev 05 which accompanied the Subdivision Application and was approved by Ipswich City Council (DA Ref: 7069/2024/MAMC/A) on 17th June, 2025 subject to conditions.
9. The compaction of earth fill will be undertaken as advised by EGIS and in accordance with the requirements of the Australian Standard AS3798-2007-Level 1.

LEGEND

- Approximate Fill Area
- 24 — Design Contours
- Contours (interval 0.5m) based on the Australian Height Datum (AHD) as shown on engineering plan 24-000435 provided by Egis.
- H=0.7m
 AH=0.7m
 Denotes retaining wall height (H)
- Denotes retaining wall average height (AH)
- I-0 ● Denotes depth of fill

Scale 1:250

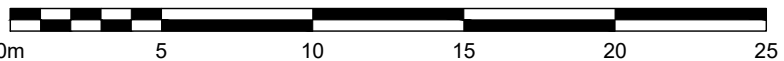

Issue	Revision	Int	Date
A	Original Issue	GJF	18/06/2025

Title:

Disclosure Plan for Proposed Lot 1130

7001 Taylors Road, Walloon,

Being Part of Lot 4 on SP351419 & Lot 1 on SP331698

Client:

ID WALLOON DEVELOPMENTS PTY LTD

Locality: WALLOON

Local Gov: ICC Prepared By: GJF

Surveyed By: Approved: MJT

Date Created: 18/06/2025 Scale: 1:250

Comp File: 220149.project

Plan No: **220149_011_DIS**



PO Box 5021, GCMC QLD 9726
Ph: (07) 5631 8000
mail@bennettandbennett.com.au

Surveying, Town Planning & Spatial Services

GOLD COAST | BRISBANE | SUNSHINE COAST | NORTHERN RIVERS

www.bennettandbennett.com.au

This is a disclosure plan, the final plan may be subject to change. The proposed lots have not been defined on site, and B.B.H. Pty Ltd Cadastral Surveyor accepts no responsibility for any amendments to location, areas, or shape that may occur during the development process. This plan has been prepared for the purpose of identifying the approximate location and size of registrable interests, and has been derived from information supplied by others. Lot dimensions may vary up to 1% and lot areas may vary by up to 2.0%. Contours, depths and retaining wall heights may vary by up to 0.5m. Lengths and shapes of retaining walls may vary during construction. This note is an integral part of this plan and no part of the plan may be reproduced without this note.

Lot 1131

Stage 11

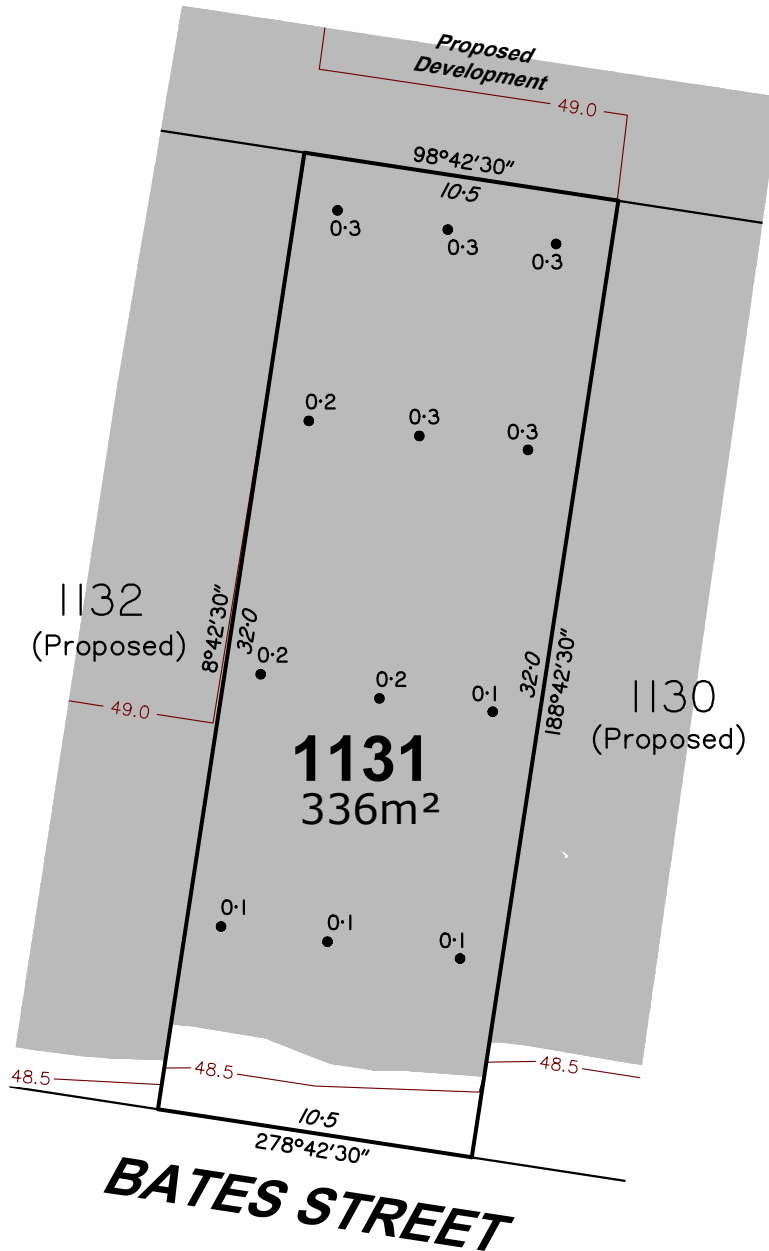

Notes:

1. Drawn to Scale on A4 sheet.
2. All levels are in metres on Australian Height Datum as determined by PSM193875, RL 46.405m AHD.
3. Contour Interval : 0.5m Design.
4. Retaining wall heights are shown at the base of the wall.
5. All dimensions and areas are subject to final survey and approval by ICC.
6. This plan has been prepared for disclosure under the Land Sales Act 1984.
7. This plan was prepared for ID WALLOON DEVELOPMENTS PTY LTD for the purposes of accompanying a sales contract and must not be used for any other purpose.
8. This plan shows details of Proposed Lot 1131 on proposal plan 0714-0279-60-U-01-RP02 Rev 05 which accompanied the Subdivision Application and was approved by Ipswich City Council (DA Ref: 7069/2024/MAMC/A) on 17th June, 2025 subject to conditions.
9. The compaction of earth fill will be undertaken as advised by EGIS and in accordance with the requirements of the Australian Standard AS3798-2007-Level 1.

LEGEND

- Approximate Fill Area
- 24 — Design Contours
- Contours (interval 0.5m) based on the Australian Height Datum (AHD) as shown on engineering plan 24-000435 provided by Egis.
- Denotes retaining wall height (H)
- Denotes retaining wall average height (AH)
- I-0 ● Denotes depth of fill



Scale 1:250

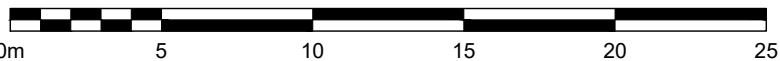

Issue	Revision	Int	Date
A	Original Issue	GJF	18/06/2025

Title:

Disclosure Plan for Proposed Lot 1131

7001 Taylors Road, Walloon,

Being Part of Lot 4 on SP351419 & Lot 1 on SP331698

Client:

ID WALLOON DEVELOPMENTS PTY LTD

Locality: WALLOON

Local Gov: ICC Prepared By: GJF

Surveyed By: Approved: MJT

Date Created: 18/06/2025 Scale: 1:250

Comp File: 220149.project

Plan No: **220149_011_DIS**



PO Box 5021, GCMC QLD 9726
Ph: (07) 5631 8000
mail@bennettandbennett.com.au

Surveying, Town Planning & Spatial Services

GOLD COAST | BRISBANE | SUNSHINE COAST | NORTHERN RIVERS

www.bennettandbennett.com.au

This is a disclosure plan, the final plan may be subject to change. The proposed lots have not been defined on site, and B.B.H. Pty Ltd Cadastral Surveyor accepts no responsibility for any amendments to location, areas, or shape that may occur during the development process. This plan has been prepared for the purpose of identifying the approximate location and size of registrable interests, and has been derived from information supplied by others. Lot dimensions may vary up to 1% and lot areas may vary by up to 2.0%. Contours, depths and retaining wall heights may vary by up to 0.5m. Lengths and shapes of retaining walls may vary during construction. This note is an integral part of this plan and no part of the plan may be reproduced without this note.

Lot 1132

Stage 11

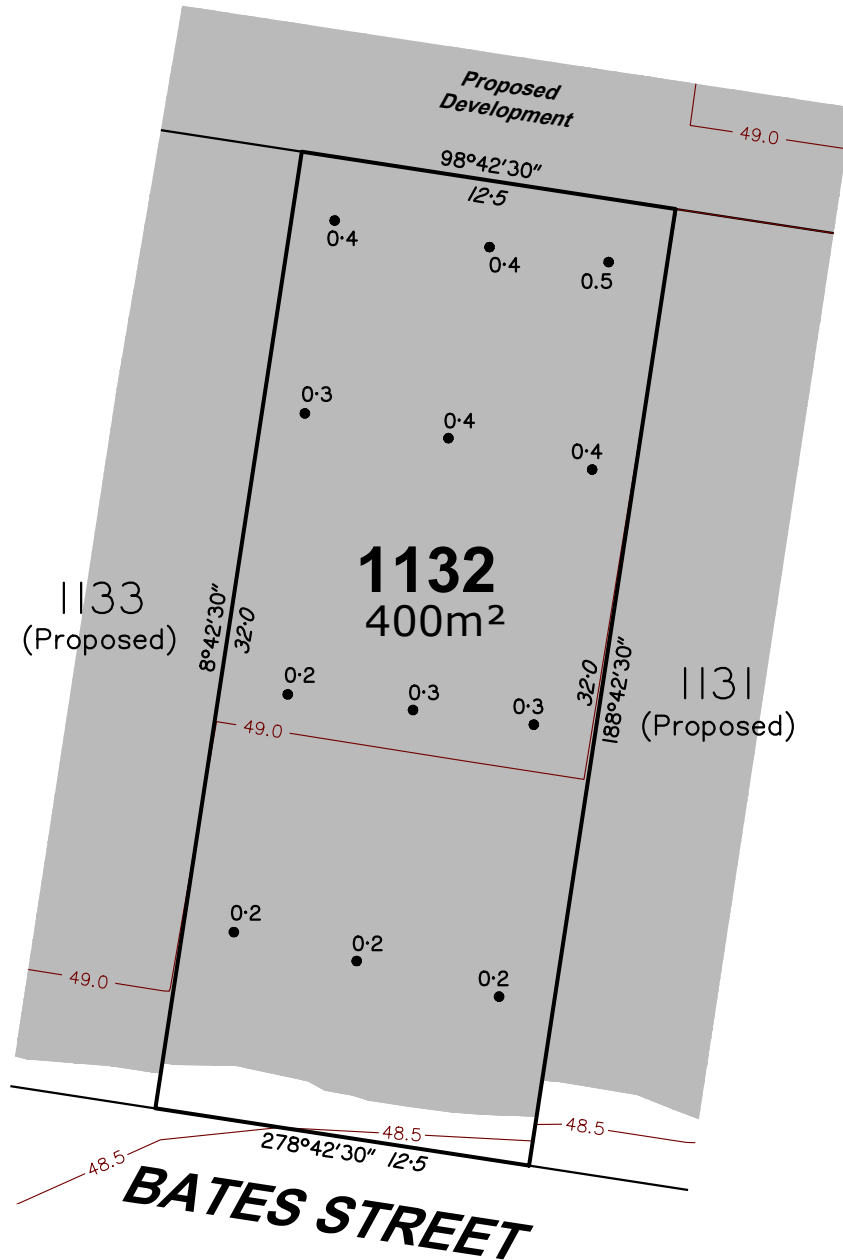

Notes:

1. Drawn to Scale on A4 sheet.
2. All levels are in metres on Australian Height Datum as determined by PSM193875, RL 46.405m AHD.
3. Contour Interval : 0.5m Design.
4. Retaining wall heights are shown at the base of the wall.
5. All dimensions and areas are subject to final survey and approval by ICC.
6. This plan has been prepared for disclosure under the Land Sales Act 1984.
7. This plan was prepared for ID WALLOON DEVELOPMENTS PTY LTD for the purposes of accompanying a sales contract and must not be used for any other purpose.
8. This plan shows details of Proposed Lot 1132 on proposal plan 0714-0279-60-U-01-RP02 Rev 05 which accompanied the Subdivision Application and was approved by Ipswich City Council (DA Ref: 7069/2024/MAMC/A) on 17th June, 2025 subject to conditions.
9. The compaction of earth fill will be undertaken as advised by EGIS and in accordance with the requirements of the Australian Standard AS3798-2007-Level 1.

LEGEND

- Approximate Fill Area
- 24 — Design Contours
- Contours (interval 0.5m) based on the Australian Height Datum (AHD) as shown on engineering plan 24-000435 provided by Egis.
- Denotes retaining wall height (H)
- Denotes retaining wall average height (AH)
- |-0 ● Denotes depth of fill

Scale 1:250

Issue	Revision	Int	Date
A	Original Issue	GJF	18/06/2025



BENNETT + BENNETT

PO Box 5021, GCMC QLD 9726
Ph: (07) 5631 8000
mail@bennettandbennett.com.au

Surveying, Town Planning & Spatial Services
GOLD COAST | BRISBANE | SUNSHINE COAST | NORTHERN RIVERS
www.bennettandbennett.com.au

Title: **Disclosure Plan for Proposed Lot 1132**
7001 Taylors Road, Walloon,
Being Part of Lot 4 on SP351419 & Lot 1 on SP331698

This is a disclosure plan, the final plan may be subject to change. The proposed lots have not been defined on site, and B.B.H. Pty Ltd Cadastral Surveyor accepts no responsibility for any amendments to location, areas, or shape that may occur during the development process. This plan has been prepared for the purpose of identifying the approximate location and size of registrable interests, and has been derived from information supplied by others. Lot dimensions may vary up to 1% and lot areas may vary by up to 2.0%. Contours, depths and retaining wall heights may vary by up to 0.5m. Lengths and shapes of retaining walls may vary during construction. This note is an integral part of this plan and no part of the plan may be reproduced without this note.

Client:	ID WALLOON DEVELOPMENTS PTY LTD		
Locality:	WALLOON		
Local Gov:	ICC	Prepared By:	GJF
Surveyed By:		Approved:	MJT
Date Created:	18/06/2025	Scale:	1:250
Comp File:	220149.project		
Plan No:	220149_011_DIS		

Lot 1133

Stage 11

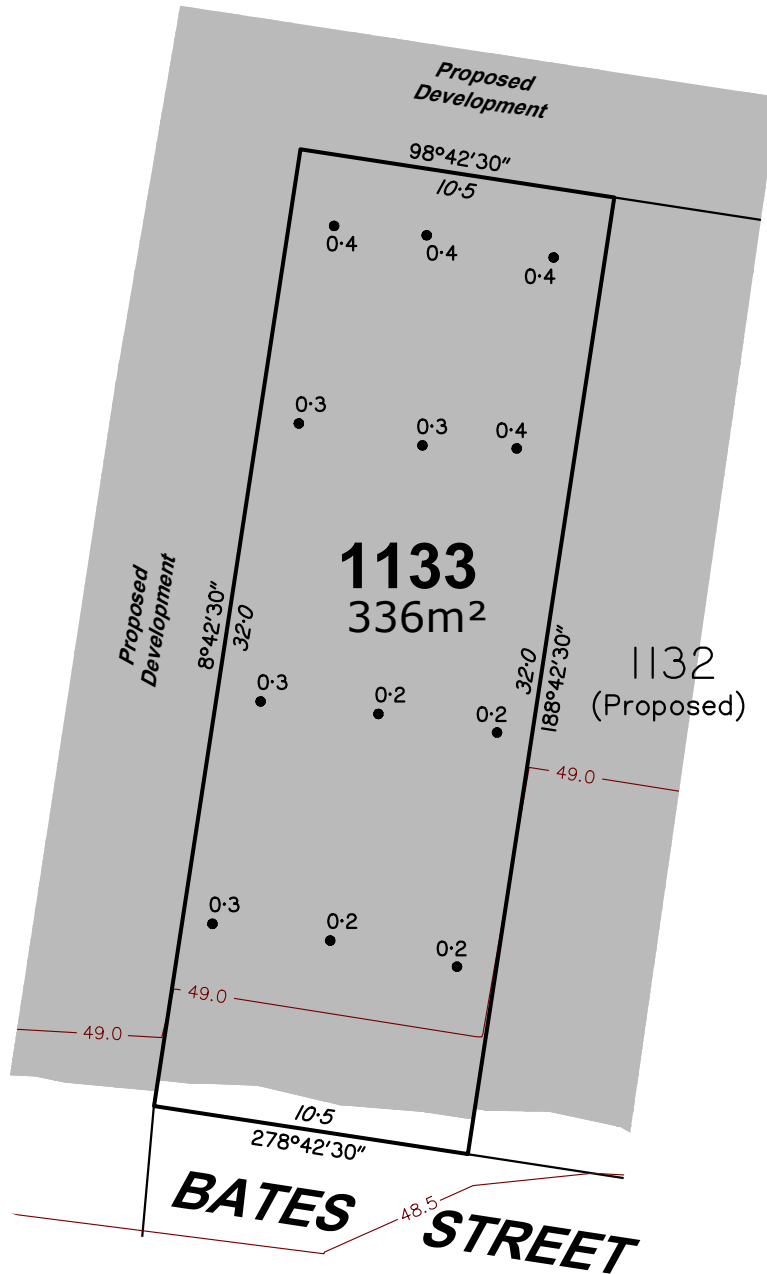

Notes:

1. Drawn to Scale on A4 sheet.
2. All levels are in metres on Australian Height Datum as determined by PSM193875, RL 46.405m AHD.
3. Contour Interval : 0.5m Design.
4. Retaining wall heights are shown at the base of the wall.
5. All dimensions and areas are subject to final survey and approval by ICC.
6. This plan has been prepared for disclosure under the Land Sales Act 1984.
7. This plan was prepared for ID WALLOON DEVELOPMENTS PTY LTD for the purposes of accompanying a sales contract and must not be used for any other purpose.
8. This plan shows details of Proposed Lot 1133 on proposal plan 0714-0279-60-U-01-RP02 Rev 05 which accompanied the Subdivision Application and was approved by Ipswich City Council (DA Ref: 7069/2024/MAMC/A) on 17th June, 2025 subject to conditions.
9. The compaction of earth fill will be undertaken as advised by EGIS and in accordance with the requirements of the Australian Standard AS3798-2007-Level 1.

LEGEND

Approximate Fill Area

24 — Design Contours

Contours (interval 0.5m) based on the Australian Height Datum (AHD) as shown on engineering plan 24-000435 provided by Egis.

H=0.7m
Denotes retaining wall height (H)

AH=0.7m
Denotes retaining wall average height (AH)

0 ● Denotes depth of fill

Scale 1:250

Issue	Revision	Int	Date
A	Original Issue	GJF	18/06/2025

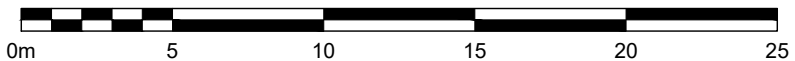

PO Box 5021, GCMC QLD 9726
Ph: (07) 5631 8000
mail@bennettandbennett.com.au

Surveying, Town Planning & Spatial Services

GOLD COAST | BRISBANE | SUNSHINE COAST | NORTHERN RIVERS

www.bennettandbennett.com.au

Title:

Disclosure Plan for Proposed Lot 1133

7001 Taylors Road, Walloon,

Being Part of Lot 4 on SP351419 & Lot 1 on SP331698

This is a disclosure plan, the final plan may be subject to change. The proposed lots have not been defined on site, and B.B.H. Pty Ltd Cadastral Surveyor accepts no responsibility for any amendments to location, areas, or shape that may occur during the development process. This plan has been prepared for the purpose of identifying the approximate location and size of registrable interests, and has been derived from information supplied by others. Lot dimensions may vary up to 1% and lot areas may vary by up to 2.0%. Contours, depths and retaining wall heights may vary by up to 0.5m. Lengths and shapes of retaining walls may vary during construction. This note is an integral part of this plan and no part of the plan may be reproduced without this note.

Client:

ID WALLOON DEVELOPMENTS PTY LTD

Locality: WALLOON

Local Gov: ICC Prepared By: GJF

Surveyed By: Approved: MJT

Date Created: 18/06/2025 Scale: 1:250

Comp File: 220149.project

Plan No: **220149_011_DIS**