

REGISTERED SURVEYOR'S CERTIFICATION

I, Veris Australia Pty Ltd, hereby certify that the vertical and horizontal locations and dimensions shown on this plan are a true and correct record and were located by survey.

6448 17/01/2025
 Qld Registered Surveyor (sig.) Qld Reg. Surveyor No. Date

ENGINEER'S CERTIFICATION

I, hereby certify that:

- The information contained in this drawing / document is in compliance with approved drawings and design.
- The new water and sewerage works defined by this drawing have been designed and constructed in accordance with the SEQ Code.
- This represents an accurate record of as-constructed works.
- I accept responsibility for the information contained in this drawing / document.

RPEQ (signature) RPEQ No. Date:

LEGEND

- NEW HYDRANT
 - NEW SLUICE VALVE
 - NEW TEE
 - NEW END CAP
 - NEW TAPER
 - NEW WATER SERVICE CONDUIT (Ø100 PVC-O PN16)
 - NEW WATER SERVICE (Ø25 PE PN16)
 - NEW WATER METER
 - NEW WATER HOUSE CONNECTION (TAPPING BAND)
 - NEW WATER MAIN (Ø180 PE-100 PN16)
 - WATER MARKER
- | | |
|---------------------|---------------------|
| ① Ø180 STOP VALVE | ⑨ Ø180 x Ø315 TEE |
| ② Ø180 FIRE HYDRANT | ⑩ Ø315 STOP VALVE |
| ③ Ø180 x Ø180 TEE | ⑪ Ø315 FIRE HYDRANT |
| ④ Ø180 DEAD END CAP | ⑫ Ø315 DEAD END CAP |
| ⑤ Ø180 11-25° BEND | ⑬ Ø315 11-25° BEND |
| ⑥ Ø180 22-5° BEND | ⑭ Ø315 SCOUR VALVE |
| ⑦ Ø180 45° BEND | |
| ⑧ Ø180 90° BEND | |

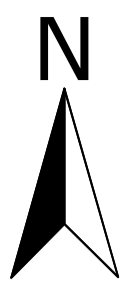
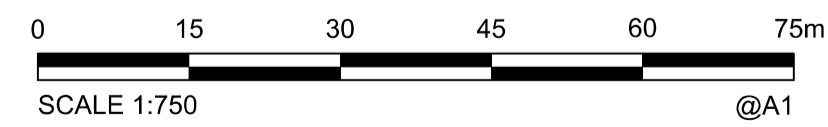

A1	C	23/10/2024	PROGRESS PLOT AS CON WATER	JMc			DRAWN	JMc	07/06/2024
	B	03/10/2024	PROGRESS PLOT AS CON WATER	JMc			CHECKED		
	A	22/08/2024	PROGRESS PLOT AS CON WATER	JMc			APPROVED		
	REV NO	DATE	REVISION PURPOSE / DESCRIPTION	DRAWN	RPEQ	RPEQ No		INITIALS	DATE

veris

BRISBANE (07) 3666 4700 WHITSUNDAYS (07) 4945 6600
 MACKAY (07) 4957 9700 CAIRNS (07) 4052 9400

veris.com.au
 ACN 615 735 727
 Veris Australia Pty Ltd



DAWN WALLOON
 Banjo Drive Walloon

STAGE 6E
 AS CONSTRUCTED WATER

DRAWING STATUS AS CONSTRUCTED	
SHEET 1 OF 4 SHEETS	
DRAWING NO. 401905-6E-AW01	REV. C



REGISTERED SURVEYOR'S CERTIFICATION
 I, Veris Australia Pty Ltd, hereby certify that the vertical and horizontal locations and dimensions shown on this plan are a true and correct record and were located by survey.
 Old Registered Surveyor (sig.) [Signature] Old Reg. Surveyor No. 6448 Date 17/01/2025

ENGINEER'S CERTIFICATION
 I, _____, hereby certify that:
 1. The information contained in this drawing / document is in compliance with approved drawings and design.
 2. The new water and sewerage works defined by this drawing have been designed and constructed in accordance with the SEQ Code.
 3. This represents an accurate record of as-constructed works.
 4. I accept responsibility for the information contained in this drawing / document.
 RPEQ (signature) _____ RPEQ No. _____ Date: _____



- LEGEND**
- NEW HYDRANT
 - NEW SLUICE VALVE
 - NEW TEE
 - NEW END CAP
 - NEW TAPER
 - NEW WATER SERVICE CONDUIT (Ø100 PVC-O PN16)
 - NEW WATER SERVICE (Ø25 PE PN16)
 - NEW WATER METER
 - NEW WATER HOUSE CONNECTION (TAPPING BAND)
 - NEW WATER MAIN (Ø180 PE-100 PN16)
 - WATER MARKER
- ① Ø180 STOP VALVE
 - ② Ø180 FIRE HYDRANT
 - ③ Ø180 x Ø180 TEE
 - ④ Ø180 DEAD END CAP
 - ⑤ Ø180 11-25° BEND
 - ⑥ Ø180 22-5° BEND
 - ⑦ Ø180 45° BEND
 - ⑧ Ø180 90° BEND
 - ⑨ Ø180 x Ø315 TEE
 - ⑩ Ø315 STOP VALVE
 - ⑪ Ø315 FIRE HYDRANT
 - ⑫ Ø315 DEAD END CAP
 - ⑬ Ø315 11-25° BEND
 - ⑭ Ø315 SCOUR VALVE

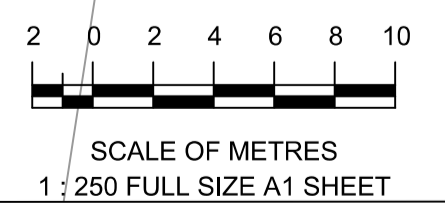

A1	C	23/10/2024	PROGRESS PLOT AS CON WATER	JMc						
	B	03/10/2024	PROGRESS PLOT AS CON WATER	JMc						
	A	22/08/2024	PROGRESS PLOT AS CON WATER	JMc						
	REV NO	DATE	REVISION PURPOSE / DESCRIPTION	DRAWN	RPEQ	RPEQ No	INITIALS	DATE		

veris
 BRISBANE (07) 3666 4700
 MACKAY (07) 4957 9700
 WHITSUNDAYS (07) 4945 6600
 CAIRNS (07) 4052 9400
 veris.com.au
 ACN 615 735 727
 Veris Australia Pty Ltd



DAWN WALLOON
 Banjo Drive Walloon
STAGE 6E
 AS CONSTRUCTED WATER

DRAWING STATUS AS CONSTRUCTED	
SHEET 2 OF 4 SHEETS	
DRAWING NO. 401905-6E-AW01	REV. C

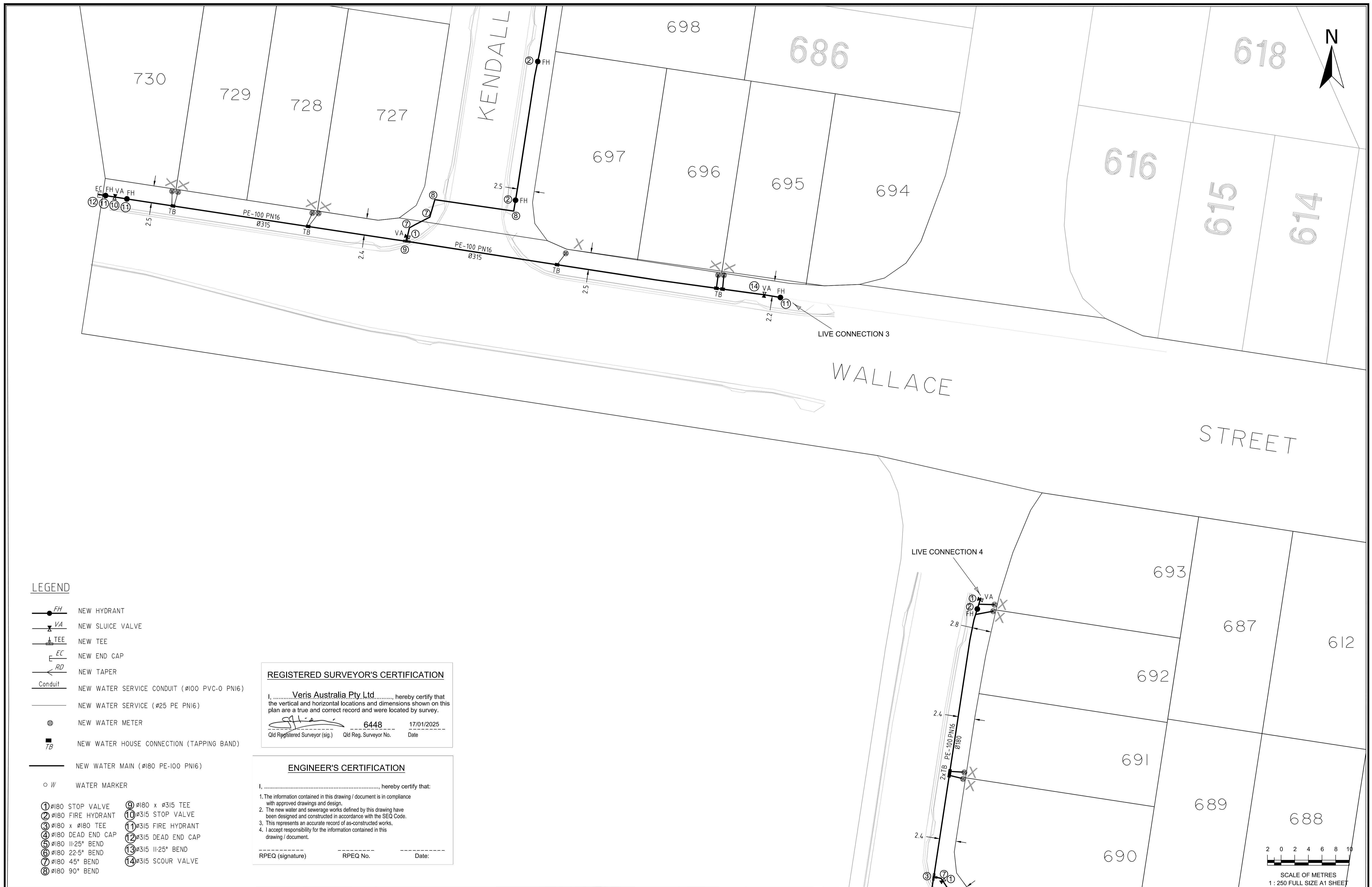

LEGEND

- NEW HYDRANT
- NEW SLUICE VALVE
- NEW TEE
- NEW END CAP
- NEW TAPER
- NEW WATER SERVICE CONDUIT (Ø100 PVC-O PN16)
- NEW WATER SERVICE (Ø25 PE PN16)
- NEW WATER METER
- NEW WATER HOUSE CONNECTION (TAPPING BAND)
- NEW WATER MAIN (Ø180 PE-100 PN16)
- WATER MARKER

- ① Ø180 STOP VALVE
- ② Ø180 FIRE HYDRANT
- ③ Ø180 x Ø180 TEE
- ④ Ø180 DEAD END CAP
- ⑤ Ø180 11-25° BEND
- ⑥ Ø180 22-5° BEND
- ⑦ Ø180 45° BEND
- ⑧ Ø180 90° BEND
- ⑨ Ø180 x Ø315 TEE
- ⑩ Ø315 STOP VALVE
- ⑪ Ø315 FIRE HYDRANT
- ⑫ Ø315 DEAD END CAP
- ⑬ Ø315 11-25° BEND
- ⑭ Ø315 SCOUR VALVE

REGISTERED SURVEYOR'S CERTIFICATION

I, Veris Australia Pty Ltd, hereby certify that the vertical and horizontal locations and dimensions shown on this plan are a true and correct record and were located by survey.

6448 17/01/2025
 Qld Registered Surveyor (sig.) Qld Reg. Surveyor No. Date

ENGINEER'S CERTIFICATION

I, _____, hereby certify that:

- The information contained in this drawing / document is in compliance with approved drawings and design.
- The new water and sewerage works defined by this drawing have been designed and constructed in accordance with the SEQ Code.
- This represents an accurate record of as-constructed works.
- I accept responsibility for the information contained in this drawing / document.

 RPEQ (signature) RPEQ No. Date:

A1

REV NO	DATE	REVISION PURPOSE / DESCRIPTION	DRAWN	RPEQ	RPEQ No	INITIALS	DATE
C	23/10/2024	PROGRESS PLOT AS CON WATER	JMc				07/06/2024
B	03/10/2024	PROGRESS PLOT AS CON WATER	JMc				
A	22/08/2024	PROGRESS PLOT AS CON WATER	JMc				

veris

BRISBANE (07) 3666 4700
 WHITSUNDAYS (07) 4945 6600
 MACKAY (07) 4957 9700
 CAIRNS (07) 4052 9400

veris.com.au
 ACN 615 735 727
 Veris Australia Pty Ltd

QUEENSLAND UrbanUtilities

DAWN WALLOON
 Banjo Drive Walloon

STAGE 6E
 AS CONSTRUCTED WATER

DRAWING STATUS
AS CONSTRUCTED

SHEET 3 OF 4 SHEETS

DRAWING NO. **401905-6E-AW01** REV. **C**

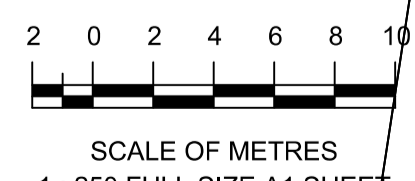

LEGEND

- NEW HYDRANT
- NEW SLUICE VALVE
- NEW TEE
- NEW END CAP
- NEW TAPER
- NEW WATER SERVICE CONDUIT (Ø100 PVC-0 PN16)
- NEW WATER SERVICE (Ø25 PE PN16)
- NEW WATER METER
- NEW WATER HOUSE CONNECTION (TAPPING BAND)
- NEW WATER MAIN (Ø180 PE-100 PN16)
- WATER MARKER

- ① Ø180 STOP VALVE
- ② Ø180 FIRE HYDRANT
- ③ Ø180 x Ø180 TEE
- ④ Ø180 DEAD END CAP
- ⑤ Ø180 11-25° BEND
- ⑥ Ø180 22-5° BEND
- ⑦ Ø180 45° BEND
- ⑧ Ø180 90° BEND
- ⑨ Ø180 x Ø315 TEE
- ⑩ Ø315 STOP VALVE
- ⑪ Ø315 FIRE HYDRANT
- ⑫ Ø315 DEAD END CAP
- ⑬ Ø315 11-25° BEND
- ⑭ Ø315 SCOUR VALVE

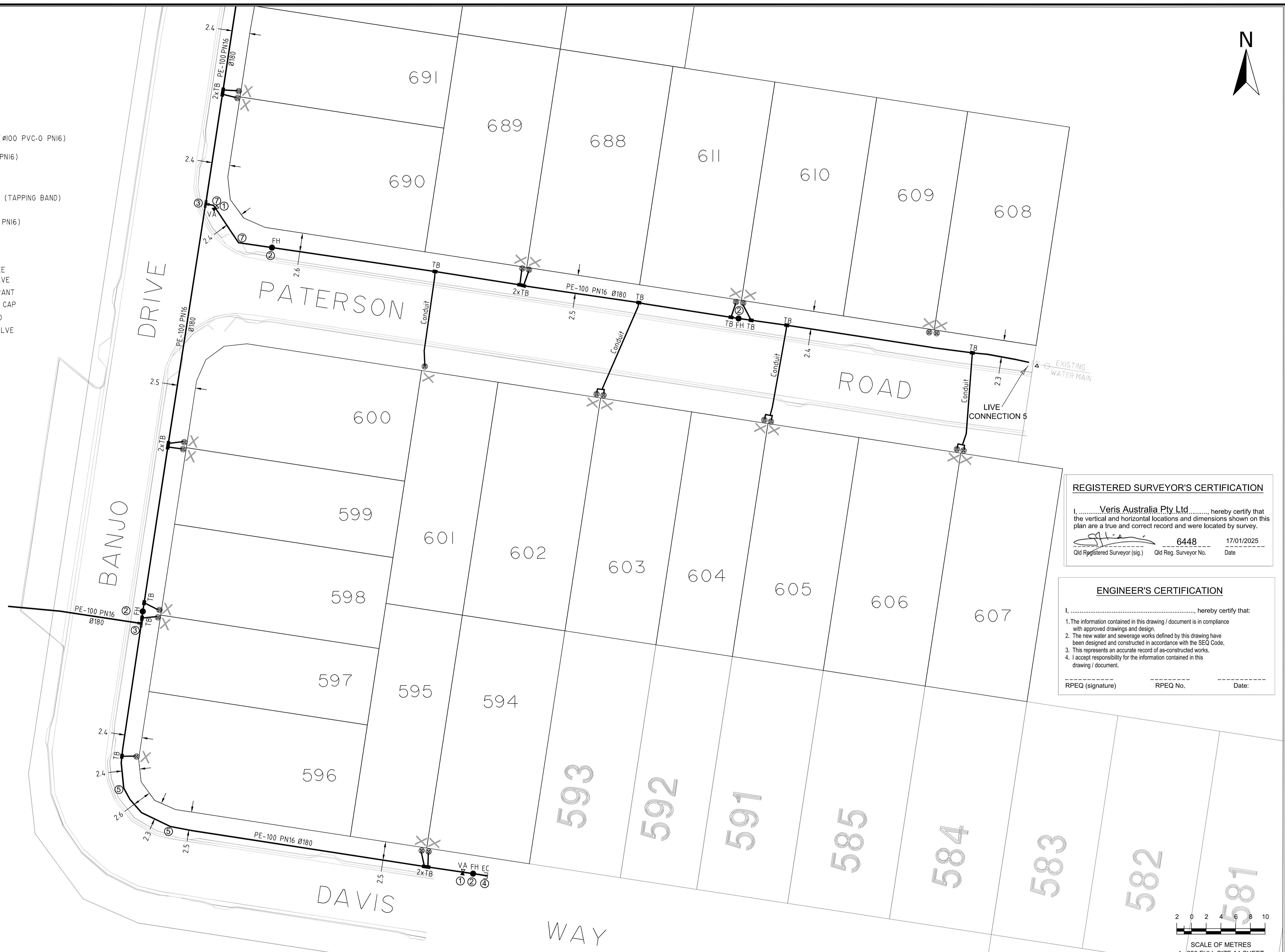

REGISTERED SURVEYOR'S CERTIFICATION

I, Veris Australia Pty Ltd hereby certify that the vertical and horizontal locations and dimensions shown on this plan are a true and correct record and were located by survey.

6448 17/01/2025
Old Registered Surveyor (sig.) Old Reg. Surveyor No. Date

ENGINEER'S CERTIFICATION

I, hereby certify that:

- The information contained in this drawing / document is in compliance with approved drawings and design.
- The new water and sewerage works defined by this drawing have been designed and constructed in accordance with the SEQ Code.
- This represents an accurate record of as-constructed works.
- I accept responsibility for the information contained in this drawing / document.

RPEQ (signature) RPEQ No. Date:

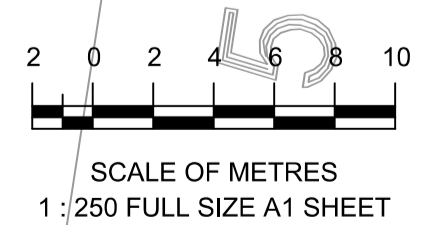

A1	C	23/10/2024	PROGRESS PLOT AS CON WATER	JMc						
	B	03/10/2024	PROGRESS PLOT AS CON WATER	JMc						
	A	22/08/2024	PROGRESS PLOT AS CON WATER	JMc						
	REV NO	DATE	REVISION PURPOSE / DESCRIPTION	DRAWN	RPEQ	RPEQ No	APPROVED	INITIALS	DATE	

BRISBANE (07) 3666 4700 WHITSUNDAYS (07) 4945 6600
 MACKAY (07) 4957 9700 CAIRNS (07) 4052 9400
 veris.com.au
 ACN 615 735 727
 Veris Australia Pty Ltd



DAWN WALLOON
 Banjo Drive Walloon
STAGE 6E
 AS CONSTRUCTED WATER

DRAWING STATUS AS CONSTRUCTED	
SHEET 4 OF 4 SHEETS	
DRAWING NO. 401905-6E-AW01	REV. C