

LEGEND

- NEW HYDRANT
- NEW SLUICE VALVE
- NEW TEE
- NEW END CAP
- NEW TAPER
- NEW WATER SERVICE CONDUIT (ø100 PVC-0 PN16)
- NEW WATER SERVICE (ø25 PE PN16)
- NEW WATER METER
- NEW WATER HOUSE CONNECTION (TAPPING BAND)
- NEW WATER MAIN (ø180 PE-100 PN16)
- WATER MARKER

Registered Surveyor's Certification.

We, **VERIS AUSTRALIA P/L** hereby certify that the horizontal and vertical locations, and dimensions shown on this plan are a true and correct record of the As Constructed information.



Signed..... Cadastral Surveyor & Delegate Reg. No. **6448**

Dated **5 June 2024**

ENGINEER'S CERTIFICATION

I,, hereby certify that:

1. The information contained in this drawing / document is in compliance with approved drawings and design.
2. The new water and sewerage works defined by this drawing have been designed and constructed in accordance with the SEQ Code.
3. This represents an accurate record of as-constructed works.
4. I accept responsibility for the information contained in this drawing / document.

RPEQ (signature) RPEQ No. Date:

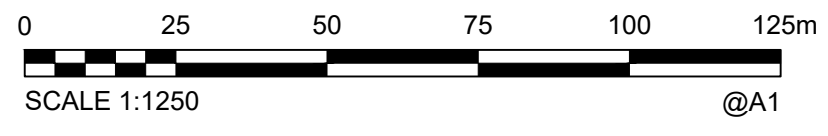

A1										  	DAWN WALLOON Banjo Drive Walloon GIBBS STAGE 1 AS CONSTRUCTED WATER	DRAWING STATUS AS CONSTRUCTED SHEET 1 OF 4 SHEETS	
	B	17/04/2024	FINAL	JM	JM	JM	JM	JM	JM		JM	DRAWING NO.	REV.
	A	06/02/2024	PROGRESS PLOT AS CON WATER	JM	JM	JM	JM	JM	JM		JM	401905-611-AW01	B
REV NO	DATE	REVISION PURPOSE / DESCRIPTION	DRAWN	RPEQ	RPEQ No	APPROVED	INITIALS	DATE	DATE				



LEGEND

- NEW HYDRANT
- NEW SLUICE VALVE
- NEW TEE
- NEW END CAP
- NEW TAPER
- NEW WATER SERVICE CONDUIT (Ø100 PVC-O PN16)
- NEW WATER SERVICE (Ø25 PE PN16)
- NEW WATER METER
- NEW WATER HOUSE CONNECTION (TAPPING BAND)
- NEW WATER MAIN (Ø180 PE-100 PN16)
- WATER MARKER

- ① Ø150 STOP VALVE
- ② Ø150 FIRE HYDRANT
- ③ Ø180 x Ø180 TEE
- ④ Ø180 DEAD END CAP
- ⑤ Ø180 11.25° BEND
- ⑥ Ø180 22.5° BEND
- ⑦ Ø180 45° BEND
- ⑧ Ø180 90° BEND



Registered Surveyor's Certification.

We, **VERIS AUSTRALIA P/L** hereby certify that the horizontal and vertical locations, and dimensions shown on this plan are a true and correct record of the As Constructed information.

Signed:  Cadastral Surveyor & Delegate Reg. No. 6448
 Dated: 5 June 2024

ENGINEER'S CERTIFICATION

- I,, hereby certify that:
- The information contained in this drawing / document is in compliance with approved drawings and design.
 - The new water and sewerage works defined by this drawing have been designed and constructed in accordance with the SEQ Code.
 - This represents an accurate record of as-constructed works.
 - I accept responsibility for the information contained in this drawing / document.

RPEQ (signature) _____ RPEQ No. _____ Date: _____

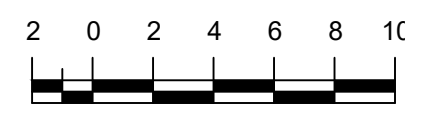

SCALE OF METRES
1 : 250 FULL SIZE A1 SHEET

A1

REV NO	DATE	REVISION PURPOSE / DESCRIPTION	DRAWN	RPEQ	RPEQ No	INITIALS	DATE
B	17/04/2024	FINAL	JMc				
A	06/02/2024	PROGRESS PLOT AS CON WATER	JMc				

veris

BRISBANE (07) 3666 4700
 WHITSUNDAYS (07) 4945 6600
 MACKAY (07) 4957 9700
 CAIRNS (07) 4052 9400

veris.com.au
 ACN 615 735 727
 Veris Australia Pty Ltd









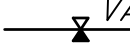

DAWN WALLOON
Banjo Drive Walloon

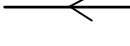
GIBBS STAGE 1
AS CONSTRUCTED WATER

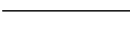
DRAWING STATUS AS CONSTRUCTED	
SHEET 2 OF 4 SHEETS	
DRAWING NO. 401905-611-AW01	REV. B

LEGEND

-  NEW HYDRANT
-  NEW SLUICE VALVE
-  NEW TEE
-  NEW END CAP
-  NEW TAPER
-  NEW WATER SERVICE CONDUIT (Ø100 PVC-0 PN16)
-  NEW WATER SERVICE (Ø25 PE PN16)
-  NEW WATER METER
-  NEW WATER HOUSE CONNECTION (TAPPING BAND)
-  NEW WATER MAIN (Ø180 PE-100 PN16)
-  WATER MARKER

- ① Ø150 STOP VALVE
- ② Ø150 FIRE HYDRANT
- ③ Ø180 x Ø180 TEE
- ④ Ø180 DEAD END CAP
- ⑤ Ø180 11.25° BEND
- ⑥ Ø180 22.5° BEND
- ⑦ Ø180 45° BEND
- ⑧ Ø180 90° BEND

Registered Surveyor's Certification.

We, **VERIS AUSTRALIA P/L**, hereby certify that the horizontal and vertical locations, and dimensions shown on this plan are a true and correct record of the As Constructed information.

Signed:  **Cadastral Surveyor & Delegate** Reg. No. **6448**
 Dated **5 June 2024**

ENGINEER'S CERTIFICATION

I, _____ hereby certify that:

1. The information contained in this drawing / document is in compliance with approved drawings and design.
2. The new water and sewerage works defined by this drawing have been designed and constructed in accordance with the SEQ Code.
3. This represents an accurate record of as-constructed works.
4. I accept responsibility for the information contained in this drawing / document.

 RPEQ (signature) RPEQ No. Date:

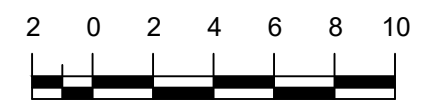
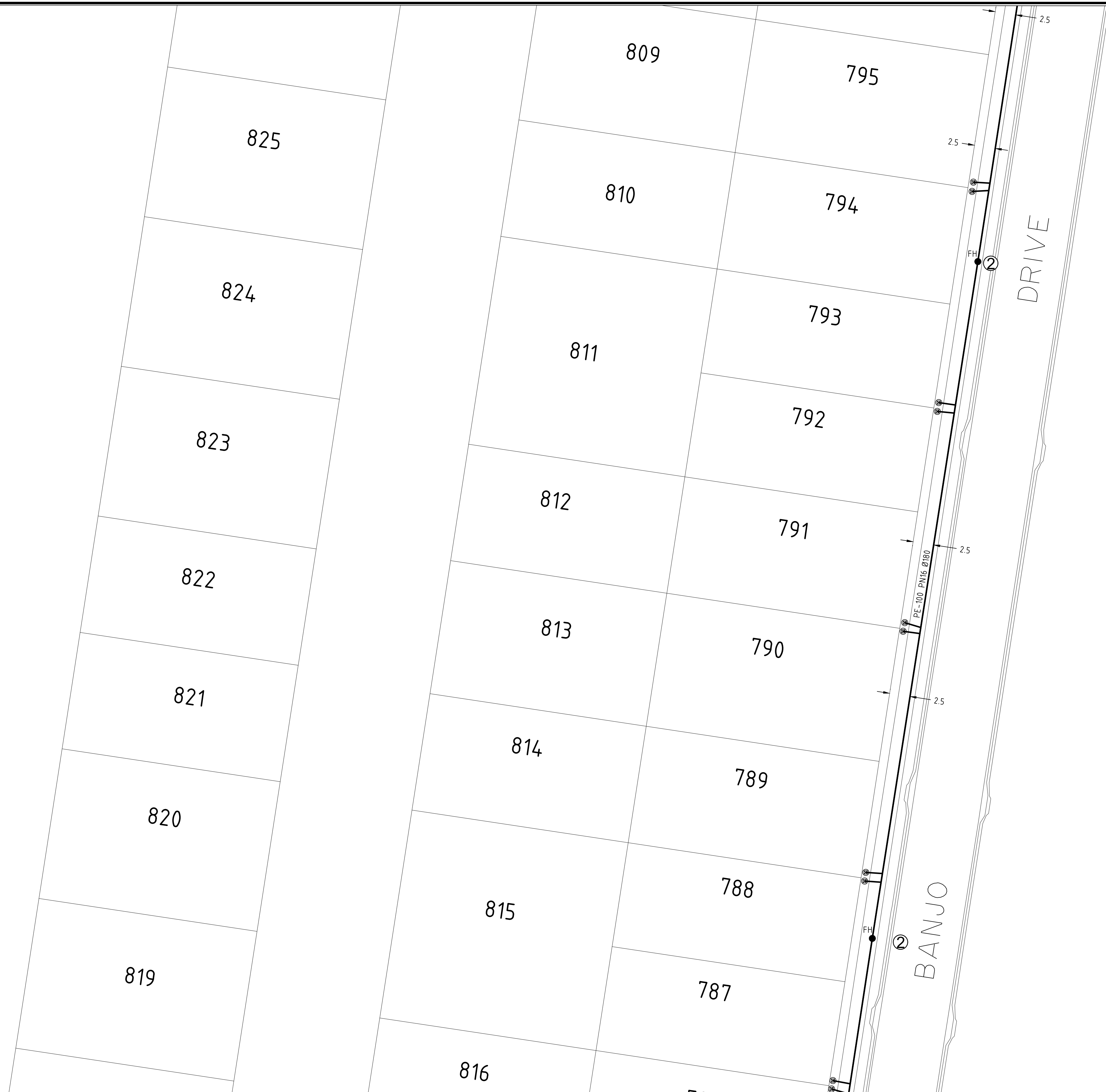

SCALE OF METRES
 1 : 250 FULL SIZE A1 SHEET

A1

REV NO	DATE	REVISION PURPOSE / DESCRIPTION	DRAWN	RPEQ	RPEQ No	INITIALS	DATE
B	17/04/2024	FINAL	JMc				
A	06/02/2024	PROGRESS PLOT AS CON WATER	JMc				
			DRAWN	RPEQ	RPEQ No	INITIALS	DATE

veris

BRISBANE (07) 3666 4700
 WHITSUNDAYS (07) 4945 6600
 MACKAY (07) 4957 9700
 CAIRNS (07) 4052 9400

veris.com.au
 ACN 615 735 727
 Veris Australia Pty Ltd



DAWN WALLOON
 Banjo Drive Walloon

GIBBS STAGE 1
 AS CONSTRUCTED WATER

DRAWING STATUS AS CONSTRUCTED	
SHEET 3 OF 4 SHEETS	
DRAWING NO. 401905-611-AW01	REV. B

LEGEND

- NEW HYDRANT
- NEW SLUICE VALVE
- NEW TEE
- NEW END CAP
- NEW TAPER
- NEW WATER SERVICE CONDUIT (Ø100 PVC-0 PN16)
- NEW WATER SERVICE (Ø25 PE PN16)
- NEW WATER METER
- NEW WATER HOUSE CONNECTION (TAPPING BAND)
- NEW WATER MAIN (Ø180 PE-100 PN16)
- WATER MARKER

- ① Ø180 STOP VALVE
- ② Ø180 FIRE HYDRANT
- ③ Ø180 x Ø180 TEE
- ④ Ø180 DEAD END CAP
- ⑤ Ø180 11.25° BEND
- ⑥ Ø180 22.5° BEND
- ⑦ Ø180 45° BEND
- ⑧ Ø180 90° BEND

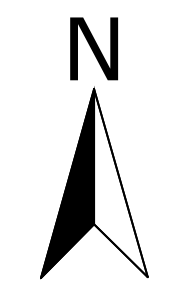

Registered Surveyor's Certification.

We, **VERIS AUSTRALIA P/L**, hereby certify that the horizontal and vertical locations, and dimensions shown on this plan are a true and correct record of the As Constructed information.

Signed: Cadastral Surveyor & Delegate Reg. No. 6448

Dated: **5 June 2024**

ENGINEER'S CERTIFICATION

I, _____, hereby certify that:

- The information contained in this drawing / document is in compliance with approved drawings and design.
- The new water and sewerage works defined by this drawing have been designed and constructed in accordance with the SEQ Code.
- This represents an accurate record of as-constructed works.
- I accept responsibility for the information contained in this drawing / document.

RPEQ (signature) RPEQ No. Date:

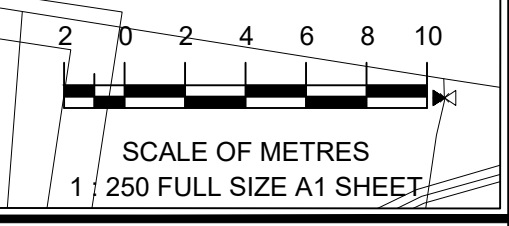

A1									
	B	17/04/2024	FINAL	JMc					
	A	06/02/2024	PROGRESS PLOT AS CON WATER	JMc					
	REV NO	DATE	REVISION PURPOSE / DESCRIPTION	DRAWN	RPEQ	RPEQ No	INITIALS	DATE	

BRISBANE (07) 3666 4700	WHITSUNDAYS (07) 4945 6600
MACKAY (07) 4957 9100	CAIRNS (07) 4052 9400
veris.com.au	
ACN 615 735 727 Veris Australia Pty Ltd	



DAWN WALLOON
Banjo Drive Walloon

GIBBS STAGE 1
AS CONSTRUCTED WATER

AS CONSTRUCTED	
SHEET 4 OF 4 SHEETS	
DRAWING NO. 401905-611-AW01	REV. B