



REGISTERED SURVEYOR'S CERTIFICATION

I, **Veris Australia Pty Ltd**, hereby certify that the vertical and horizontal locations and dimensions shown on this plan are a true and correct record and were located by survey.

Registered Surveyor (sig.) **6448** Reg. Surveyor No. **10/1/2024** Date

ENGINEER'S CERTIFICATION

I, _____, hereby certify that:

- The information contained in this drawing / document is in compliance with approved drawings and design.
- The new water and sewerage works defined by this drawing have been designed and constructed in accordance with the SEQ Code.
- This represents an accurate record of as-constructed works.
- I accept responsibility for the information contained in this drawing / document.

RPEQ (signature) _____ RPEQ No. _____ Date: _____

LEGEND

- SEWER MAIN
- SEWER HOUSE CONNECTION
- SEWER HOUSE CONNECTION
- SEWER MAINTENANCE HOLE (INSITU)
- SEWER MAINTENANCE SHAFT
- SEWER END OF LINE
- EXISTING SEWER MAINTENANCE SHAFT
- 58.19# DESIGN LEVEL



A1

REV NO	DATE	REVISION PURPOSE / DESCRIPTION	DRAWN	RPEQ	RPEQ No	INITIALS	DATE
E	10/11/2023	AMMENDMENTS APPLIED	JMc				
D	28/09/2023	AMMENDMENTS APPLIED	JMc				
C	19/09/2023	FINAL	JMc			DRAWN	JMc 08/05/2023
B	23/08/2023	PROGRESS PLOT AS CON SEWER	JMc			CHECKED	
F	20/12/2023	PROGRESS PLOT AS CON SEWER	JMc			APPROVED	

veris

BRISBANE (07) 3666 4700
WHITSUNDAYS (07) 4945 6600
MACKAY (07) 4957 9100
CAIRNS (07) 4052 9400

veris.com.au
ACN 615 735 727
Veris Australia Pty Ltd



DAWN WALLOON
Banjo Drive Walloon

STAGE 6B3
AS CONSTRUCTED SEWER

DRAWING STATUS	
AS CONSTRUCTED	
SHEET 1 OF 4 SHEETS	
DRAWING NO.	REV.
401905-6B3-AS01	F

REGISTERED SURVEYOR'S CERTIFICATION

I, Veris Australia Pty Ltd, hereby certify that the vertical and horizontal locations and dimensions shown on this plan are a true and correct record and were located by survey.

Registered Surveyor (sig.) 6448 Reg. Surveyor No. Date 10/1/2024

ENGINEER'S CERTIFICATION

I, _____, hereby certify that:

- The information contained in this drawing / document is in compliance with approved drawings and design.
- The new water and sewerage works defined by this drawing have been designed and constructed in accordance with the SEQ Code.
- This represents an accurate record of as-constructed works.
- I accept responsibility for the information contained in this drawing / document.

RPEQ (signature) _____ RPEQ No. _____ Date: _____

LEGEND

- SEWER MAIN
- SEWER HOUSE CONNECTION
- SEWER HOUSE CONNECTION
- SEWER MAINTENANCE HOLE (INSITU)
- SEWER MAINTENANCE SHAFT
- SEWER END OF LINE
- EXISTING SEWER MAINTENANCE SHAFT
- DESIGN LEVEL

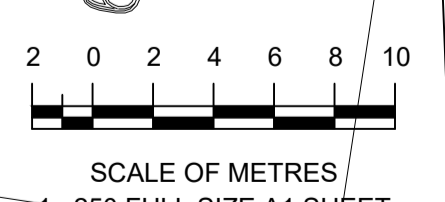
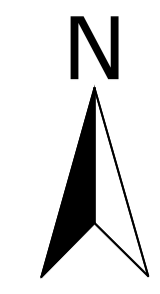

A1	E	10/11/2023	AMMENDMENTS APPLIED	JMc				
	D	28/09/2023	AMMENDMENTS APPLIED	JMc				
	C	19/09/2023	FINAL	JMc				
	B	23/08/2023	PROGRESS PLOT AS CON SEWER	JMc			08/05/2023	
	F	20/12/2023	PROGRESS PLOT AS CON SEWER	JMc				
	REV NO	DATE	REVISION PURPOSE / DESCRIPTION	DRAWN	RPEQ	RPEQ No	INITIALS	DATE

BRISBANE (07) 3666 4700
WHITSUNDAYS (07) 4945 6600
MACKAY (07) 4957 9100
CAIRNS (07) 4052 9400
veris.com.au
ACN 615 735 727
Veris Australia Pty Ltd



DAWN WALLOON
Banjo Drive Walloon
STAGE 6B3
AS CONSTRUCTED SEWER

DRAWING STATUS AS CONSTRUCTED	
SHEET 2 OF 4 SHEETS	
DRAWING NO. 401905-6B3-AS01	REV. F



REGISTERED SURVEYOR'S CERTIFICATION

I, Veris Australia Pty Ltd, hereby certify that the vertical and horizontal locations and dimensions shown on this plan are a true and correct record and were located by survey.

Registered Surveyor (sig.) 6448 Date 10/1/2024
 Reg. Surveyor No. _____

ENGINEER'S CERTIFICATION

I, _____, hereby certify that:

- The information contained in this drawing / document is in compliance with approved drawings and design.
- The new water and sewerage works defined by this drawing have been designed and constructed in accordance with the SEQ Code.
- This represents an accurate record of as-constructed works.
- I accept responsibility for the information contained in this drawing / document.

RPEQ (signature) _____ RPEQ No. _____ Date: _____

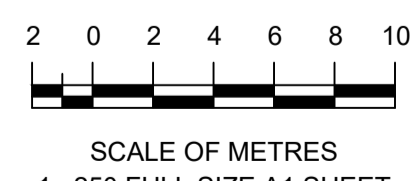
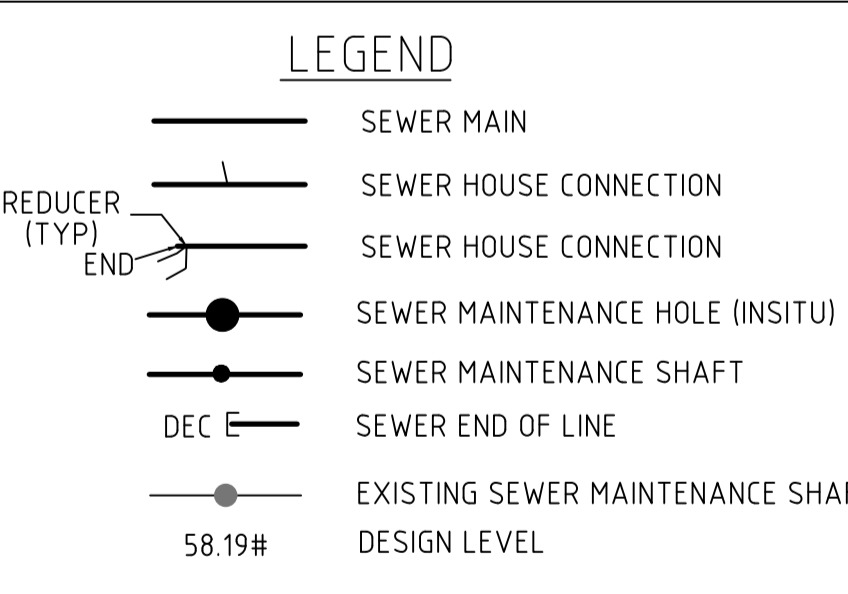

A1	E	10/11/2023	AMMENDMENTS APPLIED	JMc				
	D	28/09/2023	AMMENDMENTS APPLIED	JMc				
	C	19/09/2023	FINAL	JMc				
	B	23/08/2023	PROGRESS PLOT AS CON SEWER	JMc			08/05/2023	
	F	20/12/2023	PROGRESS PLOT AS CON SEWER	JMc				
	REV NO	DATE	REVISION PURPOSE / DESCRIPTION	DRAWN	RPEQ	RPEQ No	INITIALS	DATE

veris

BRISBANE (07) 3666 4700
 WHITSUNDAYS (07) 4945 6600
 MACKAY (07) 4957 9700
 CAIRNS (07) 4052 9400
 veris.com.au
 ACN 615 735 727
 Veris Australia Pty Ltd



DAWN WALLOON
 Banjo Drive Walloon

STAGE 6B3
 AS CONSTRUCTED SEWER

DRAWING STATUS
 AS CONSTRUCTED

SHEET 3 OF 4 SHEETS

DRAWING NO. **401905-6B3-AS01** REV. **F**

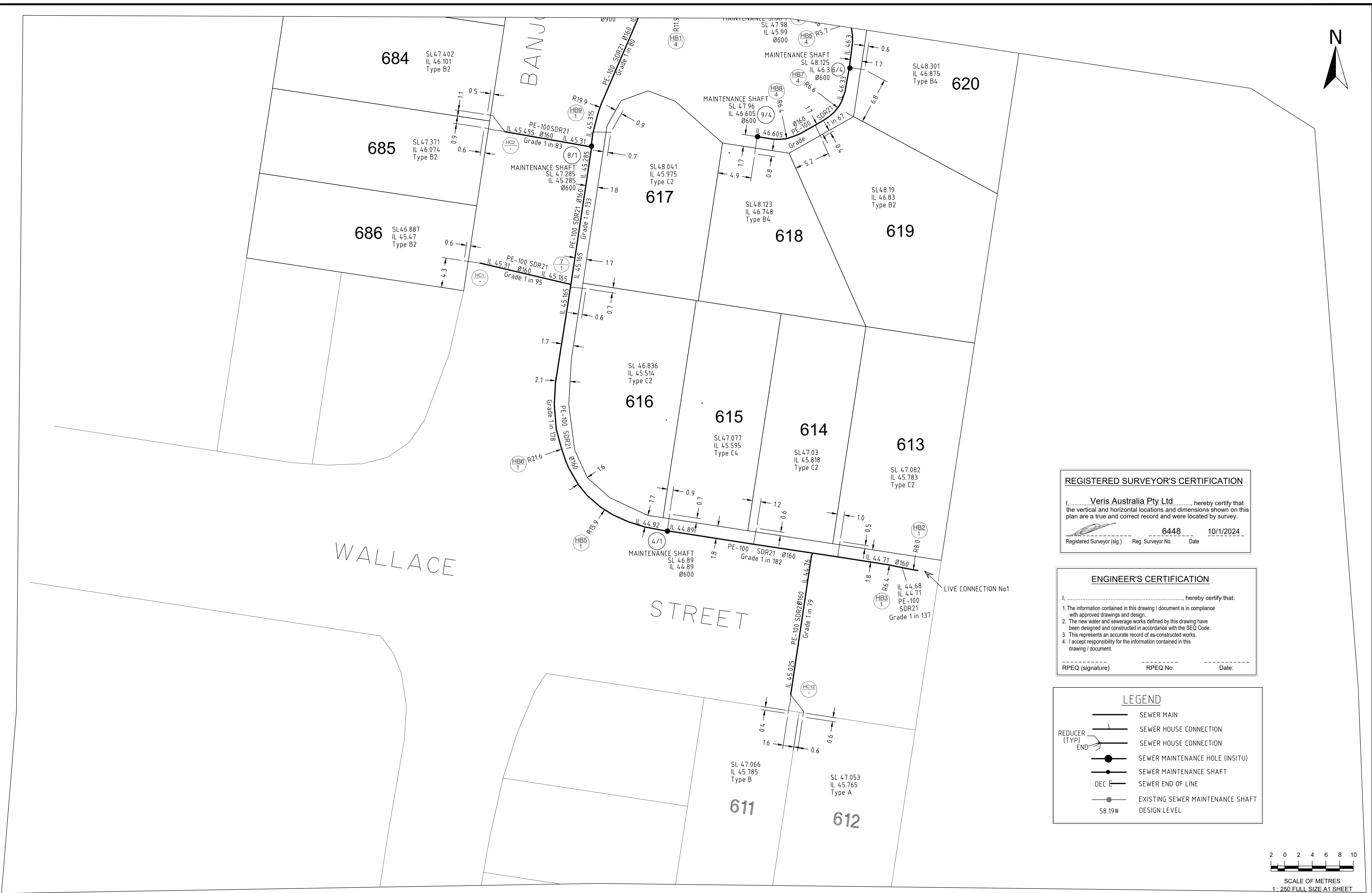

REGISTERED SURVEYOR'S CERTIFICATION

I, Veris Australia Pty Ltd, hereby certify that the vertical and horizontal locations and dimensions shown on this plan are a true and correct record and were located by survey.

Registered Surveyor (sig.) 6448 Reg. Surveyor No. Date 10/1/2024

ENGINEER'S CERTIFICATION

I, _____, hereby certify that:

- The information contained in this drawing / document is in compliance with approved drawings and design.
- The new water and sewerage works defined by this drawing have been designed and constructed in accordance with the SEQ Code.
- This represents an accurate record of as-constructed works.
- I accept responsibility for the information contained in this drawing / document.

RPEQ (signature) _____ RPEQ No. _____ Date: _____

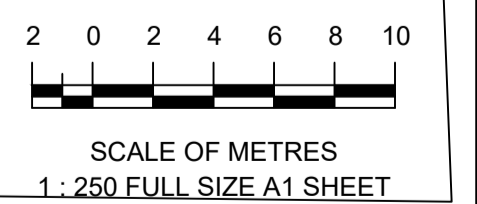
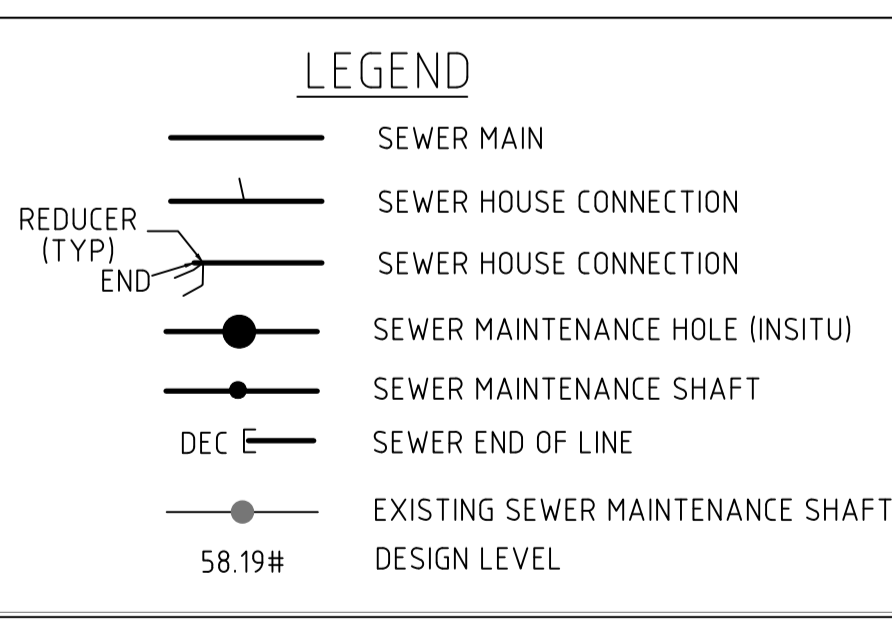

A1	E	10/11/2023	AMMENDMENTS APPLIED	JMc					
	D	28/09/2023	AMMENDMENTS APPLIED	JMc					
	C	19/09/2023	FINAL	JMc			DRAWN	JMc	08/05/2023
	B	23/08/2023	PROGRESS PLOT AS CON SEWER	JMc			CHECKED		
	F	20/12/2023	PROGRESS PLOT AS CON SEWER	JMc			APPROVED		
	REV NO	DATE	REVISION PURPOSE / DESCRIPTION	DRAWN	RPEQ	RPEQ No	INITIALS	DATE	

BRISBANE (07) 3666 4700 WHITSUNDAYS (07) 4945 6600
 MACKAY (07) 4957 9100 CAIRNS (07) 4052 9400
 veris.com.au
 ACN 615 735 727
 Veris Australia Pty Ltd



DAWN WALLOON
 Banjo Drive Walloon
STAGE 6B3
 AS CONSTRUCTED SEWER

DRAWING STATUS AS CONSTRUCTED	
SHEET 4 OF 4 SHEETS	
DRAWING NO. 401905-6B3-AS01	REV. F