





LEGEND

Final surface contours based on A.H.D. datum at an interval of 0.25m, shown as:  15.5

Where applicable, areas to be filled are shown as: 

Depth of fill, in metres, shown as:-  1.1

Retaining wall and retaining wall height, shown on the lower side of the wall, have been taken from plans supplied by Calibre Group and shown as:  (1.2)

ADDITIONAL NOTES:

The LOT dimensions and area shown hereon are subject to final field survey and also to the requirements of Council and any other authority which may have requirements under any relevant legislation

Final surface contours shown hereon have been supplied by Calibre Group.

Compaction of any fill material placed on this site shall be completed to level one inspection and testing services in accordance with AS3798-2007.

Copyright ©Veris Australia Pty Ltd 16/12/2022.

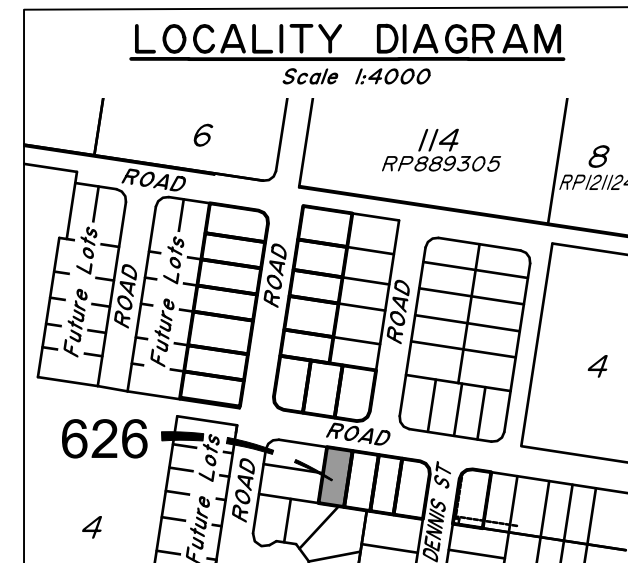

dawn.
WALLOON

WATERLEA STAGE 6B2
For

Waterlea Nominees Co.

IMPORTANT NOTES:

(These notes are an integral part of this plan)

This plan has been prepared for Waterlea Nominees Co. and ID Land for the purposes of A Disclosure Plan Under the Land Sales Act 1984 (as amended).

It is not to be used by any other person or corporation or for any other purposes and is subject to the following limitations:

Please refer to the approved Development Application for conditions relating to the LOT and to approved Operational Works drawings for services location and possible easements.

THESE DESIGNS AND DRAWINGS ARE COPYRIGHT AND ARE NOT TO BE USED OR REPRODUCED WITHOUT THE WRITTEN PERMISSION OF VERIS

Data Sources

Cadastral Boundaries
401364-L01(1-1).dwg
Engineering Design
21-000113.02-2230 Stage Retaining Wall
Setout.dwg
Final Surface Contours
20221201 Waterlea Stage 6B2 6B3 Design Conts.dwg
Depth of Fill
20221201 Waterlea Stage 6B2 6B3 Depth Conts.dwg

Issue	Revisions	Date	Drawn
C	Engineering updated	16.12.2022	BK
B	Add Lots 626-630, Amend Eng Name	21.03.2022	GJF
A	Original	10.03.2022	GJF

Locality:
Local Authority: Ipswich City Council
Horizontal Meridian: MGA Zone 56
Vertical Level Datum: AHD
Scale: 1:250 @ A4
Designed: **
Drawn: GJF 10/03/2022
Checked: KJJ 15/03/2022
Plot Date: 01 Feb, 2023
Comp File Ref: 401364-Stg6-B2-DP01(C).dwg

DISCLOSURE PLAN
of Proposed LOT 626
currently being part of
Lot 1 on SP331771.



veris

BRISBANE WHITSUNDAYS
(07) 3686 4700 (07) 4945 6600

MACKAY CAIRNS
(07) 4957 9700 (07) 4252 9400

veris.com.au
ACN 615 735 727
Veris Australia Pty Ltd

Drawing No Issue
401364-06-DP-626 C

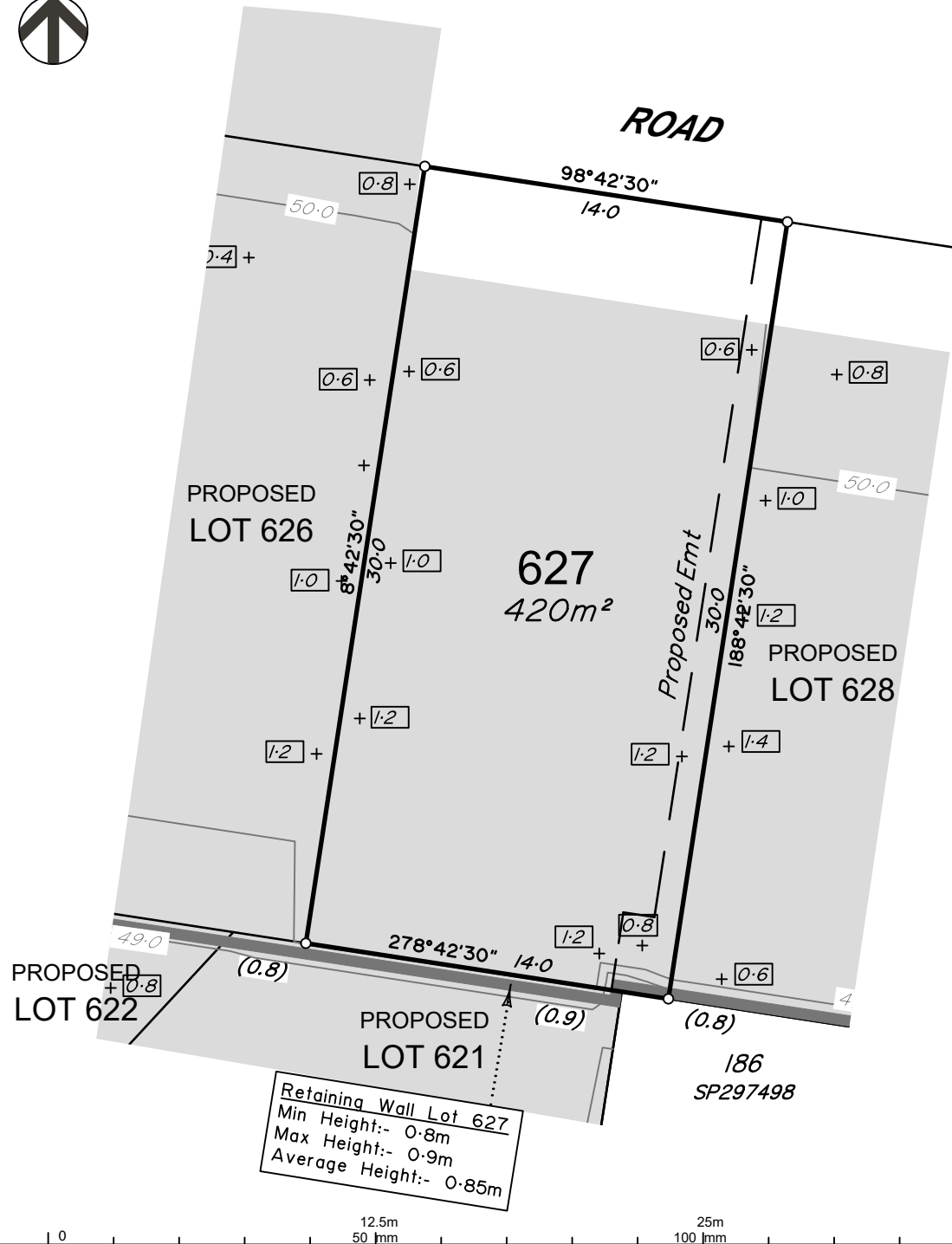

LEGEND

Final surface contours based on A.H.D. datum at an interval of 0.25m, shown as:  15.5

Where applicable, areas to be filled are shown as: 

Depth of fill, in metres, shown as:- +1.1

Retaining wall and retaining wall height, shown on the lower side of the wall, have been taken from plans supplied by Calibre Group and shown as:  (1.2)

ADDITIONAL NOTES:

The LOT dimensions and area shown hereon are subject to final field survey and also to the requirements of Council and any other authority which may have requirements under any relevant legislation

Final surface contours shown hereon have been supplied by Calibre Group.

Compaction of any fill material placed on this site shall be completed to level one inspection and testing services in accordance with AS3798-2007.

Copyright ©Veris Australia Pty Ltd 16/12/2022.

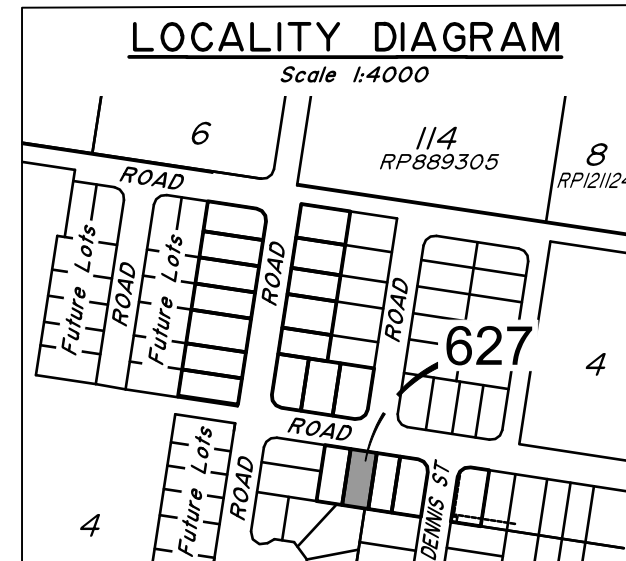

WATERLEA STAGE 6B2

For
Waterlea Nominees Co.

IMPORTANT NOTES:
(These notes are an integral part of this plan)
This plan has been prepared for Waterlea Nominees Co. and ID Land for the purposes of A Disclosure Plan Under the Land Sales Act 1984 (as amended).
It is not to be used by any other person or corporation or for any other purposes and is subject to the following limitations:

Please refer to the approved Development Application for conditions relating to the LOT and to approved Operational Works drawings for services location and possible easements.

THESE DESIGNS AND DRAWINGS ARE COPYRIGHT AND ARE NOT TO BE USED OR REPRODUCED WITHOUT THE WRITTEN PERMISSION OF VERIS

Data Sources
Cadastral Boundaries
401364-L001(T) .dwg
Engineering Design
21-000113.02-2230 Stage Retaining Wall Setout.dwg
Final Surface Contours
20221201 Waterlea Stage 6B2 6B3 Design Conts.dwg
Depth of Fill
20221201 Waterlea Stage 6B2 6B3 Depth Conts.dwg

D	Easement Added Lot 627	8.06.2023	DMC
C	Engineering updated	16.12.2022	BK
B	Add Lots 626-630, Amd Eng Name Widen Lot 678	21.03.2022	GJF
A	Original	10.03.2022	GJF
Issue	Revisions	Date	Drawn

Locality: WALLOON
Local Authority: Ipswich City Council
Horizontal Meridian: MGA Zone 56
Vertical Level Datum: AHD
Scale: 1:250 @ A4
Designed: **
Drawn: GJF 10/03/2022
Checked: KJJ 15/03/2022
Plot Date: 06 Jun, 2023
Comp File Ref: 401364-Stg6-B2-DP01(D).dwg

DISCLOSURE PLAN
of Proposed LOT 627
currently being part of
Lot 1 on SP331771.



veris

BRISBANE WHITSUNDAYS
(07) 3686 4700 (07) 4945 6600

MACKAY CAIRNS
(07) 4957 9700 (07) 4252 9400

veris.com.au
ACN 615 735 727
Veris Australia Pty Ltd

Drawing No Issue
401364-06-DP-627 D

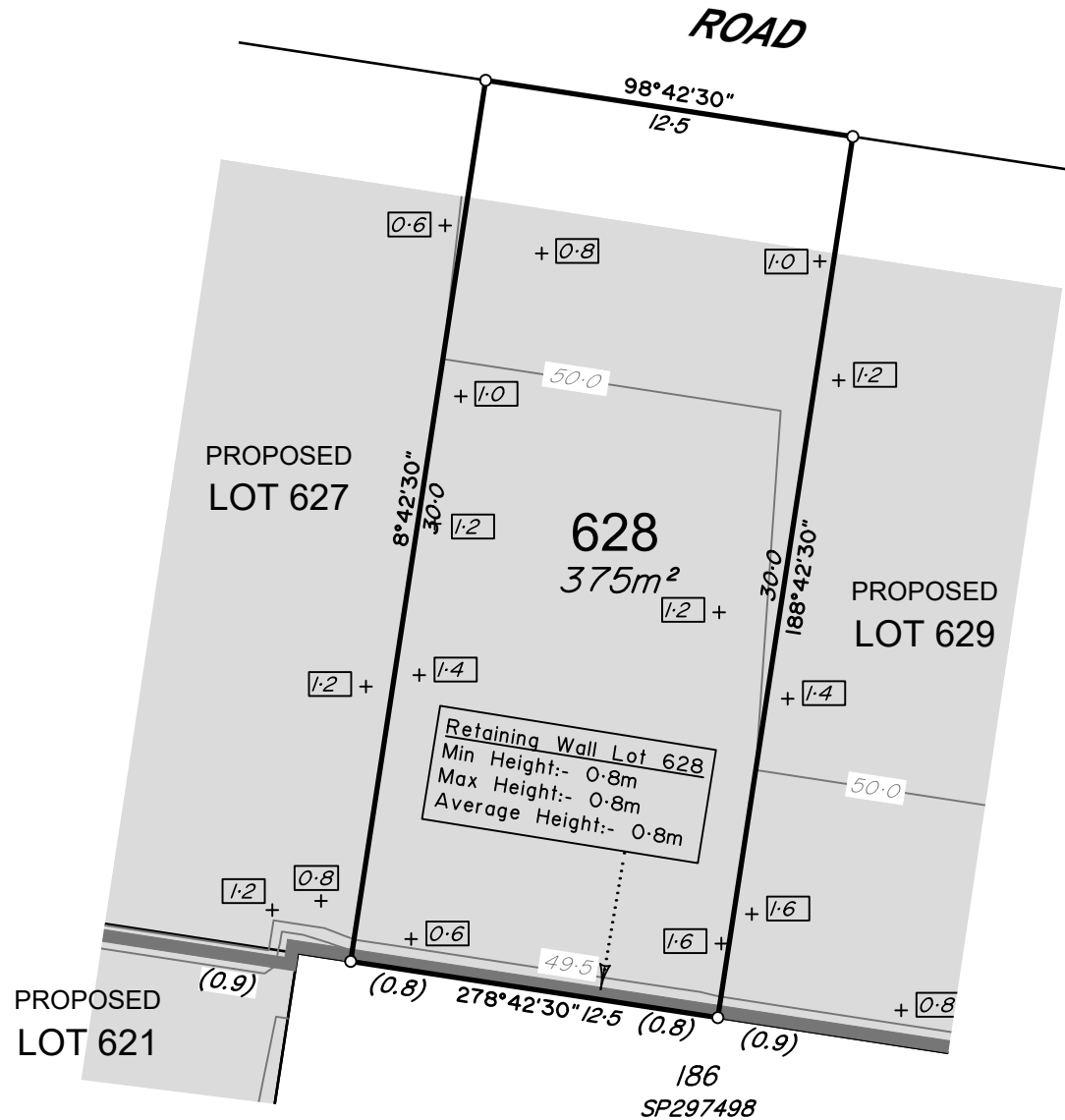

LEGEND

Final surface contours based on A.H.D. datum at an interval of 0.25m, shown as:  15.5

Where applicable, areas to be filled are shown as: 

Depth of fill, in metres, shown as:- +1.1

Retaining wall and retaining wall height, shown on the lower side of the wall, have been taken from plans supplied by Calibre Group and shown as:  (1.2)

ADDITIONAL NOTES:

The LOT dimensions and area shown hereon are subject to final field survey and also to the requirements of Council and any other authority which may have requirements under any relevant legislation

Final surface contours shown hereon have been supplied by Calibre Group.

Compaction of any fill material placed on this site shall be completed to level one inspection and testing services in accordance with AS3798-2007.

Copyright ©Veris Australia Pty Ltd 16/12/2022.

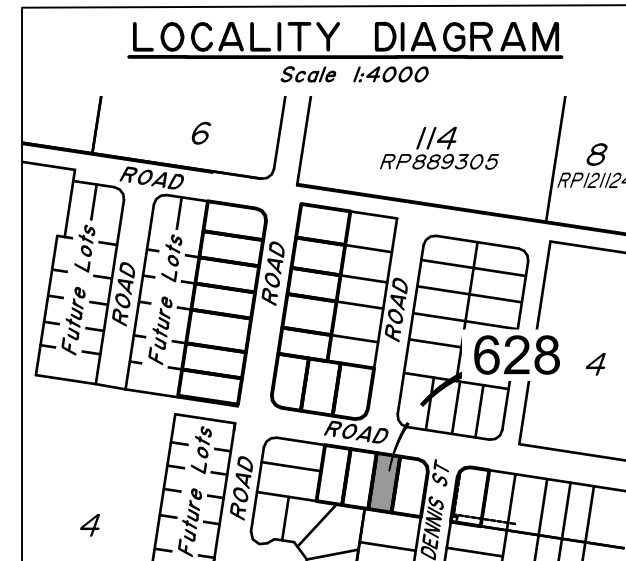

dawn.
WALLOON

WATERLEA STAGE 6B2
For

Waterlea Nominees Co.

IMPORTANT NOTES:

(These notes are an integral part of this plan)
This plan has been prepared for Waterlea Nominees Co. and ID Land for the purposes of A Disclosure Plan Under the Land Sales Act 1984 (as amended).
It is not to be used by any other person or corporation or for any other purposes and is subject to the following limitations:

Please refer to the approved Development Application for conditions relating to the LOT and to approved Operational Works drawings for services location and possible easements.

THESE DESIGNS AND DRAWINGS ARE COPYRIGHT AND ARE NOT TO BE USED OR REPRODUCED WITHOUT THE WRITTEN PERMISSION OF VERIS

Data Sources

Cadastral Boundaries
401364-L01(1-1).dwg
Engineering Design
21-000113.02-2230 Stage Retaining Wall Setout.dwg
Final Surface Contours
20221201 Waterlea Stage 6B2 6B3 Design Conts.dwg
Depth of Fill
20221201 Waterlea Stage 6B2 6B3 Depth Conts.dwg

Issue	Revisions	Date	Drawn
C	Engineering updated	16.12.2022	BK
B	Add Lots 628-630, Amd Eng Name Widen Lot 678	21.03.2022	GJF
A	Original	10.03.2022	GJF

Locality: WALLOON
Local Authority: Ipswich City Council
Horizontal Meridian: MGA Zone 56
Vertical Level Datum: AHD
Scale: 1:250 @ A4
Designed: **
Drawn: GJF 10/03/2022
Checked: KJJ 15/03/2022
Plot Date: 01 Feb, 2023
Comp File Ref: 401364-Stg6-B2-DP01(C).dwg

DISCLOSURE PLAN
of Proposed LOT 628
currently being part of
Lot 1 on SP331771.



veris

BRISBANE WHITSUNDAYS
(07) 3686 4700 (07) 4945 6600

MACKAY CAIRNS
(07) 4957 9700 (07) 4252 9400

veris.com.au
ACN 615 735 727
Veris Australia Pty Ltd

Drawing No Issue
401364-06-DP-628 C

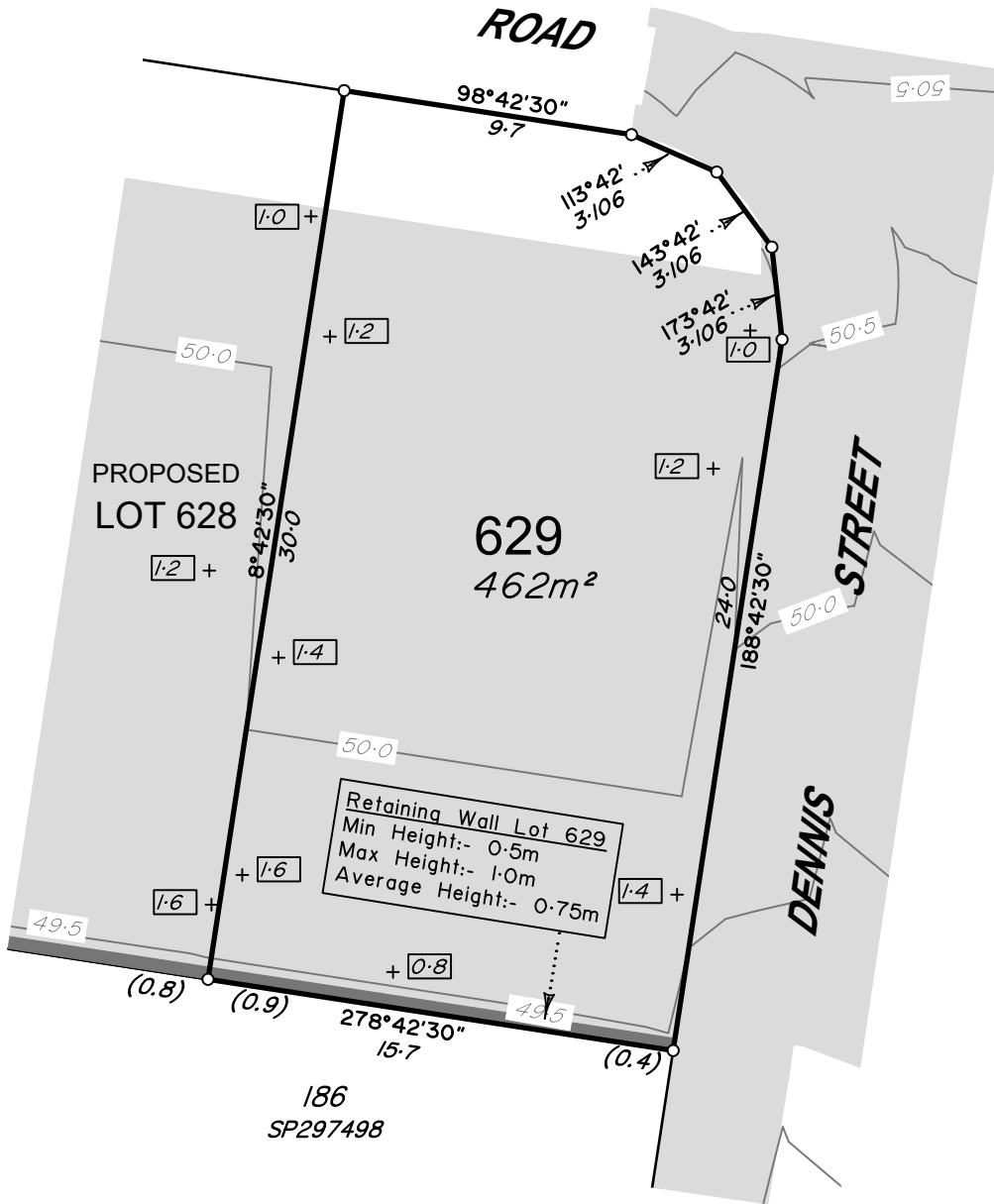

LEGEND

Final surface contours based on A.H.D. datum at an interval of 0.25m, shown as: $\text{---} 15.5 \text{---}$

Where applicable, areas to be filled are shown as:

Depth of fill, in metres, shown as: $+1.1$

Retaining wall and retaining wall height, shown on the lower side of the wall, have been taken from plans supplied by Calibre Group and shown as: (1.2)

ADDITIONAL NOTES:

The LOT dimensions and area shown hereon are subject to final field survey and also to the requirements of Council and any other authority which may have requirements under any relevant legislation

Final surface contours shown hereon have been supplied by Calibre Group.

Compaction of any fill material placed on this site shall be completed to level one inspection and testing services in accordance with AS3798-2007.

Copyright ©Veris Australia Pty Ltd 16/12/2022.

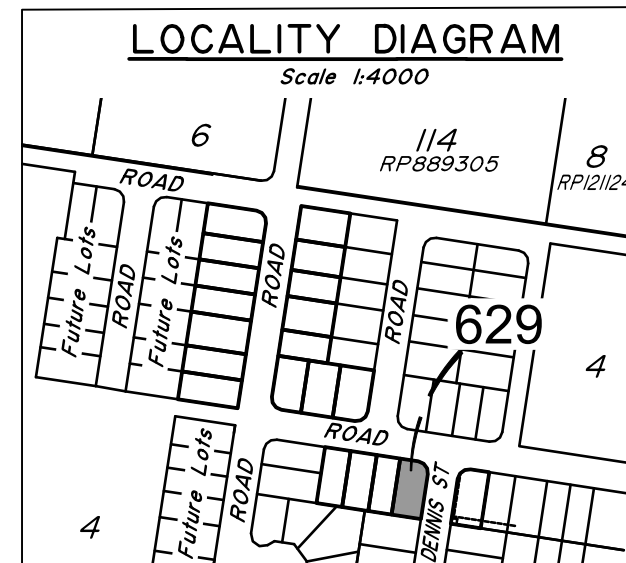

dawn.
WALLOON

WATERLEA STAGE 6B2
For

Waterlea Nominees Co.

IMPORTANT NOTES:

(These notes are an integral part of this plan)

This plan has been prepared for Waterlea Nominees Co. and ID Land for the purposes of A Disclosure Plan Under the Land Sales Act 1984 (as amended).

It is not to be used by any other person or corporation or for any other purposes and is subject to the following limitations:

Please refer to the approved Development Application for conditions relating to the LOT and to approved Operational Works drawings for services location and possible easements.

THESE DESIGNS AND DRAWINGS ARE COPYRIGHT AND ARE NOT TO BE USED OR REPRODUCED WITHOUT THE WRITTEN PERMISSION OF VERIS

Data Sources

Cadastral Boundaries
401364-L01(1)1.dwg
Engineering Design
21-000113.02-2230 Stage Retaining Wall Setout.dwg
Final Surface Contours
20221201 Waterlea Stage 6B2 6B3 Design Conts.dwg
Depth of Fill
20221201 Waterlea Stage 6B2 6B3 Depth Conts.dwg

Issue	Revisions	Date	Drawn
C	Engineering updated	16.12.2022	BK
B	Add Lots 626-630, Amend Eng Name Widen Lot 678	21.03.2022	GJF
A	Original	10.03.2022	GJF

Locality: WALLOON
Local Authority: Ipswich City Council
Horizontal Meridian: MGA Zone 56
Vertical Level Datum: AHD
Scale: 1:250 @ A4
Designed: **
Drawn: GJF 10/03/2022
Checked: KJJ 15/03/2022
Plot Date: 01 Feb, 2023
Comp File Ref: 401364-Stg6-B2-DP01(C).dwg

DISCLOSURE PLAN
of Proposed LOT 629
currently being part of
Lot 1 on SP331771.



veris

BRISBANE WHITSUNDAYS
(07) 3686 4700 (07) 4945 6600

MACKAY CAIRNS
(07) 4957 9700 (07) 4252 9400

veris.com.au
ACN 615 735 727
Veris Australia Pty Ltd

Drawing No Issue
401364-06-DP-629 C

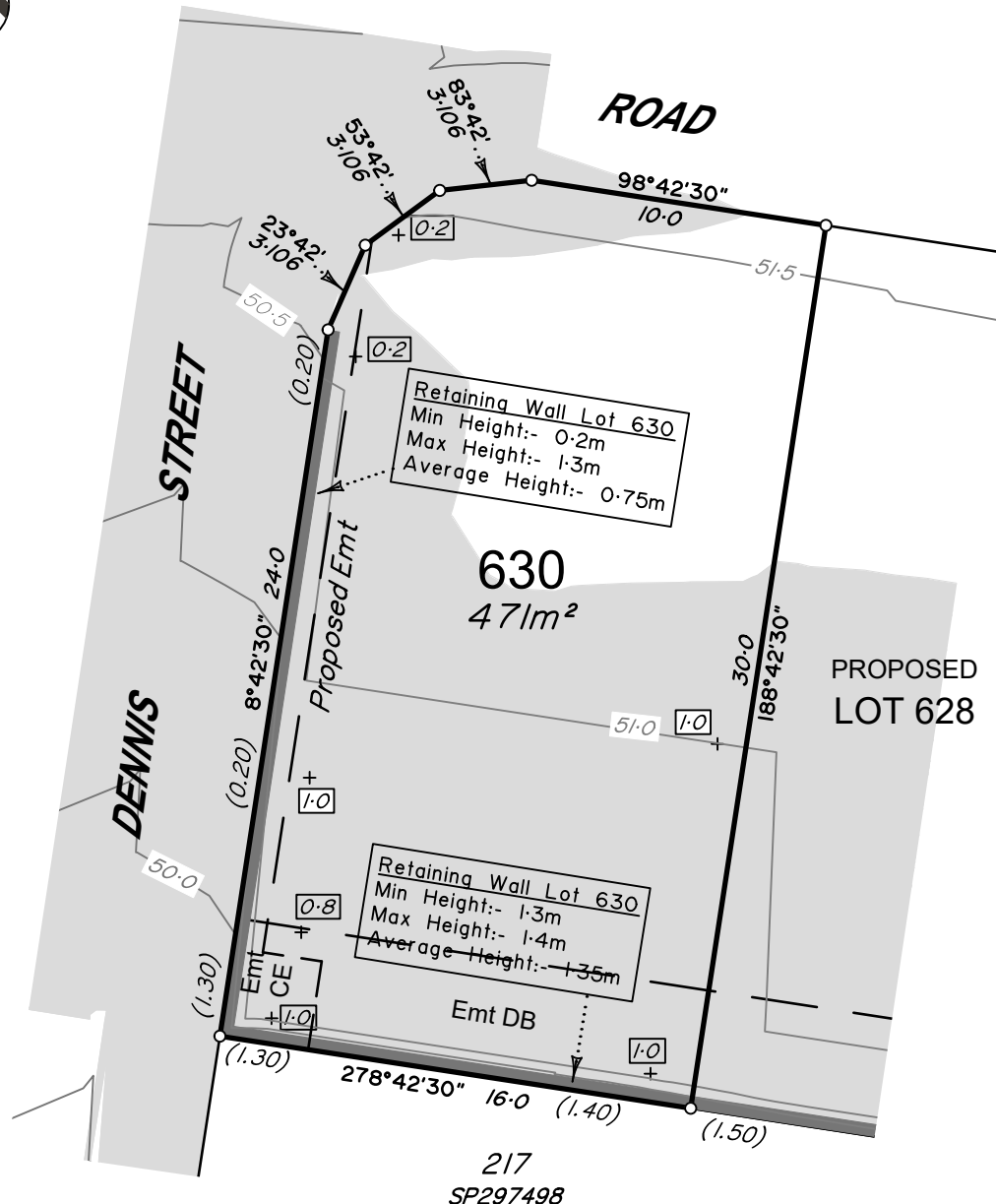

LEGEND

Final surface contours based on A.H.D. datum at an interval of 0.25m, shown as:  15.5

Where applicable, areas to be filled are shown as: 

Depth of fill, in metres, shown as:-  1.1

Retaining wall and retaining wall height, shown on the lower side of the wall, have been taken from plans supplied by Calibre Group and shown as:  (1.2)

ADDITIONAL NOTES:

The LOT dimensions and area shown hereon are subject to final field survey and also to the requirements of Council and any other authority which may have requirements under any relevant legislation

Final surface contours shown hereon have been supplied by Calibre Group.

Compaction of any fill material placed on this site shall be completed to level one inspection and testing services in accordance with AS3798-2007.

Copyright ©Veris Australia Pty Ltd 16/12/2022.

LOCALITY DIAGRAM

Scale 1:4000

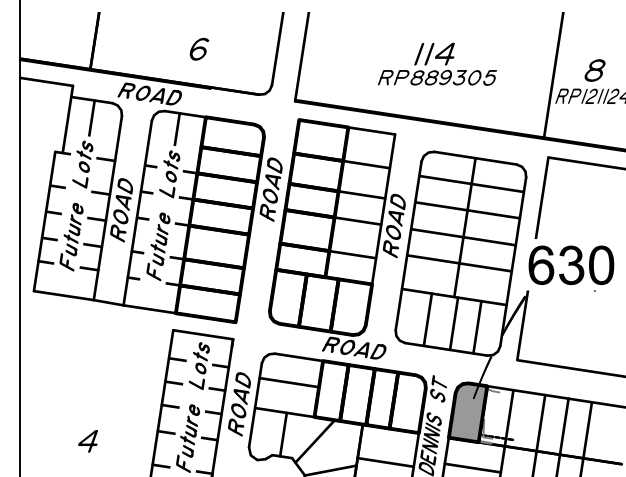

dawn.
WALLOON

WATERLEA STAGE 6B2

For

Waterlea Nominees Co.

IMPORTANT NOTES:

(These notes are an integral part of this plan)

This plan has been prepared for Waterlea Nominees Co. and ID Land for the purposes of a Disclosure Plan Under the Land Sales Act 1984 (as amended).

It is not to be used by any other person or corporation or for any other purposes and is subject to the following limitations:

Please refer to the approved Development Application for conditions relating to the LOT and to approved Operational Works drawings for services location and possible easements.

THESE DESIGNS AND DRAWINGS ARE COPYRIGHT AND ARE NOT TO BE USED OR REPRODUCED WITHOUT THE WRITTEN PERMISSION OF VERIS

Data Sources

Cadastral Boundaries
401364-L001-T1.dwg
Engineering Design
21-000113.02-2230 Stage Retaining Wall
Setout.dwg
Final Surface Contours
20221201 Waterlea Stage 6B2 6B3 Design Conts.dwg
Depth of Fill
20221201 Waterlea Stage 6B2 6B3 Depth Conts.dwg

Issue	Revisions	Date	Drawn
C	Engineering updated	16.12.2022	BK
B	Add Lots 628-630, Amd Eng Name Widen Lot 678	21.03.2022	GJF
A	Original	10.03.2022	GJF

Locality:
Local Authority: Ipswich City Council
Horizontal Meridian: MGA Zone 56
Vertical Level Datum: AHD
Scale: 1:250 @ A4
Designed:
Drawn: GJF 10/03/2022
Checked: KJJ 15/03/2022
Plot Date: 01 Feb, 2023
Comp File Ref: 401364-Stg6-B2-DP01(C).dwg

DISCLOSURE PLAN
of Proposed LOT 630
currently being part of
Lot 1 on SP331771.



veris

BRISBANE WHITSUNDAYS
(07) 3686 4700 (07) 4945 6600

MACKAY CAIRNS
(07) 4957 9700 (07) 4252 9400

veris.com.au
ACN 615 735 727
Veris Australia Pty Ltd

Drawing No Issue
401364-06-DP-630 C

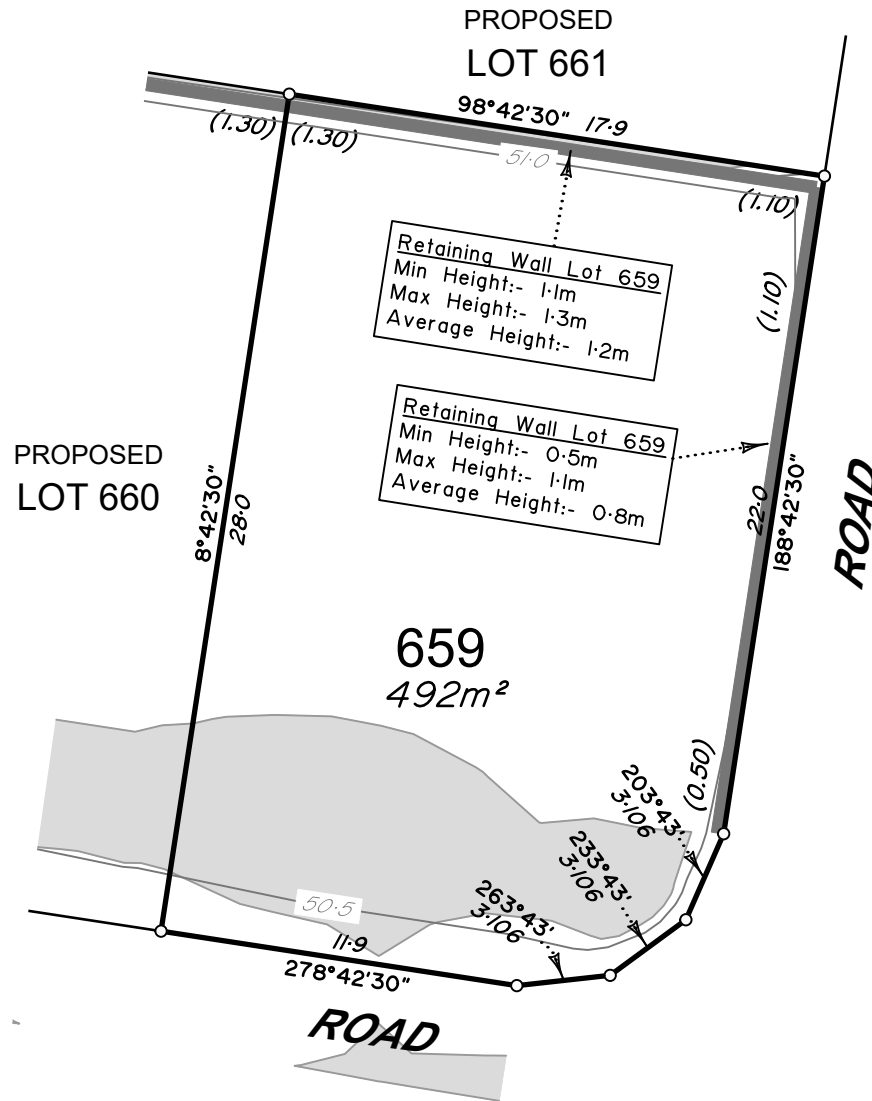

LEGEND

Final surface contours based on A.H.D. datum at an interval of 0.25m, shown as:  15.5

Where applicable, areas to be filled are shown as: 

Depth of fill, in metres, shown as:-  1.1

Retaining wall and retaining wall height, shown on the lower side of the wall, have been taken from plans supplied by Calibre Group and shown as:  (1.2)

ADDITIONAL NOTES:

The LOT dimensions and area shown hereon are subject to final field survey and also to the requirements of Council and any other authority which may have requirements under any relevant legislation

Final surface contours shown hereon have been supplied by Calibre Group.

Compaction of any fill material placed on this site shall be completed to level one inspection and testing services in accordance with AS3798-2007.

Copyright ©Veris Australia Pty Ltd 16/12/2022.

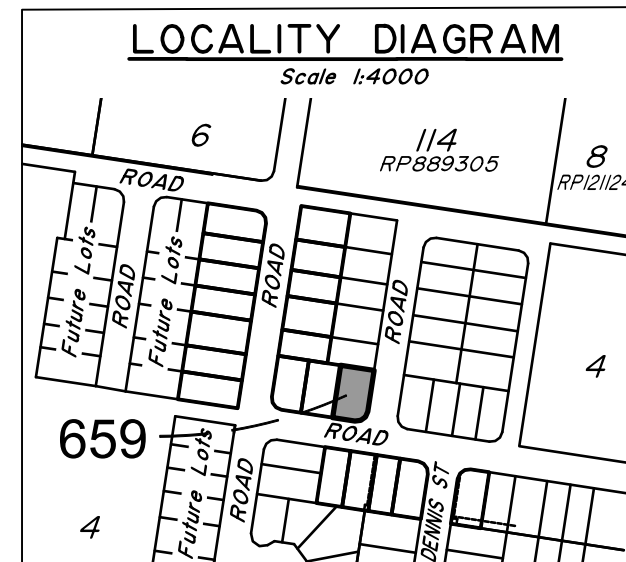

dawn.
WALLOON

WATERLEA STAGE 6B2
For

Waterlea Nominees Co.

IMPORTANT NOTES:

(These notes are an integral part of this plan)
This plan has been prepared for Waterlea Nominees Co. and ID Land for the purposes of A Disclosure Plan Under the Land Sales Act 1984 (as amended).
It is not to be used by any other person or corporation or for any other purposes and is subject to the following limitations:

Please refer to the approved Development Application for conditions relating to the LOT and to approved Operational Works drawings for services location and possible easements.

THESE DESIGNS AND DRAWINGS ARE COPYRIGHT AND ARE NOT TO BE USED OR REPRODUCED WITHOUT THE WRITTEN PERMISSION OF VERIS

Data Sources

Cadastral Boundaries
401364-L001(1) dwg
Engineering Design
21-000113.02-2230 Stage Retaining Wall Setout.dwg
Final Surface Contours
20221201 Waterlea Stage 6B2 6B3 Design Conts.dwg
Depth of Fill
20221201 Waterlea Stage 6B2 6B3 Depth Conts.dwg

D	Wall amended on Lot 659	31.07.2023	DMC
C	Engineering updated	16.12.2022	BK
B	Add Lots 626-630, Amend Eng Name	21.03.2022	GJF
A	Original	10.03.2022	GJF

Issue Revisions Date Drawn

Locality: WALLOON
Local Authority: Ipswich City Council
Horizontal Meridian: MGA Zone 56
Vertical Level Datum: AHD
Scale: 1:250 @ A4
Designed: **
Drawn: GJF 10/03/2022
Checked: KJJ 15/03/2022
Plot Date: 31 Jul, 2023
Comp File Ref: 401364-Stg6-B2-DP01(D).dwg

DISCLOSURE PLAN
of Proposed LOT 659
currently being part of
Lot 1 on SP331771.



veris

BRISBANE WHITSUNDAYS
(07) 3686 4700 (07) 4945 6600

MACKAY CAIRNS
(07) 4957 9700 (07) 4252 9400

veris.com.au
ACN 615 735 727
Veris Australia Pty Ltd

Drawing No Issue
401364-06-DP-659 D

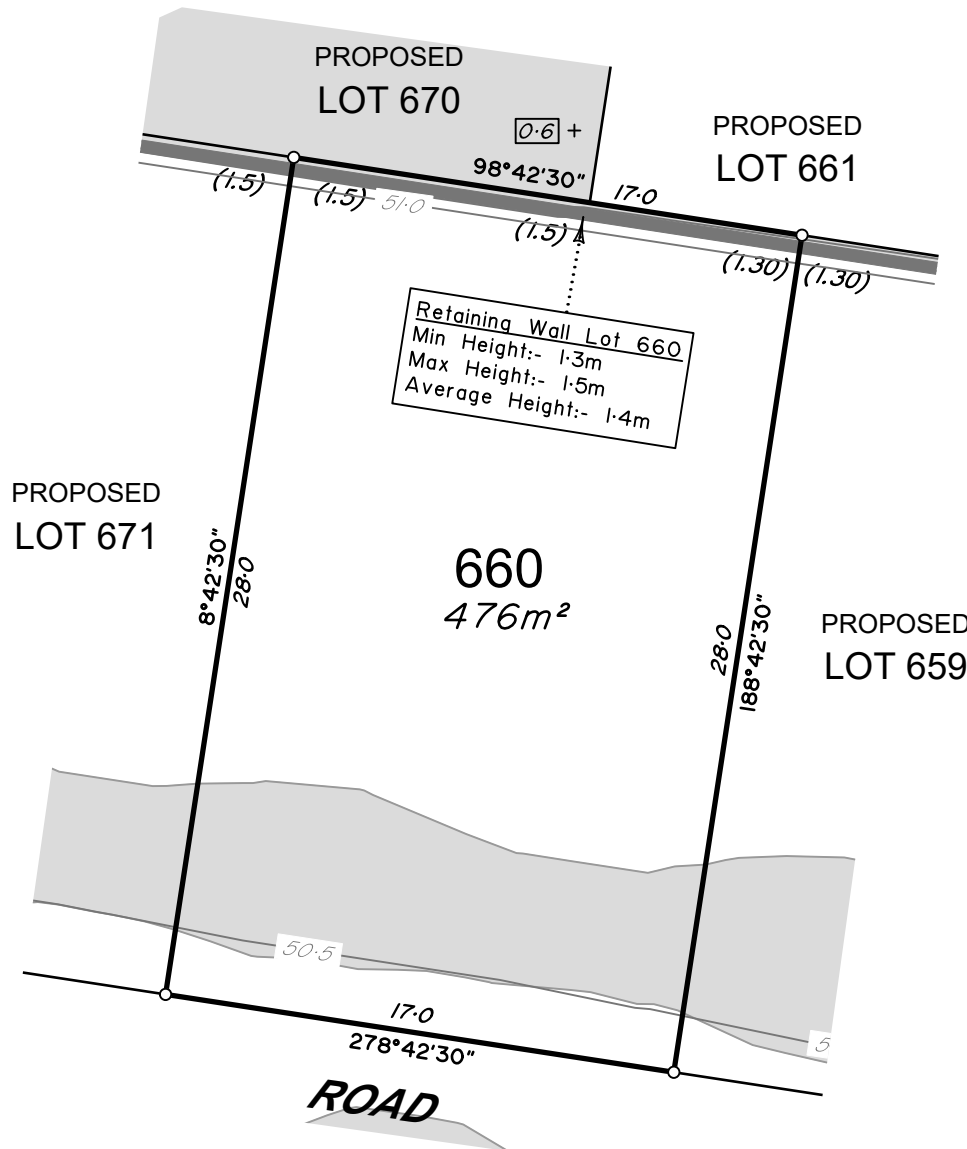

LEGEND

Final surface contours based on A.H.D. datum at an interval of 0.25m, shown as:  15.5

Where applicable, areas to be filled are shown as: 

Depth of fill, in metres, shown as:-  1.1

Retaining wall and retaining wall height, shown on the lower side of the wall, have been taken from plans supplied by Calibre Group and shown as:  (1.2)

ADDITIONAL NOTES:

The LOT dimensions and area shown hereon are subject to final field survey and also to the requirements of Council and any other authority which may have requirements under any relevant legislation

Final surface contours shown hereon have been supplied by Calibre Group.

Compaction of any fill material placed on this site shall be completed to level one inspection and testing services in accordance with AS3798-2007.

Copyright ©Veris Australia Pty Ltd 16/12/2022.

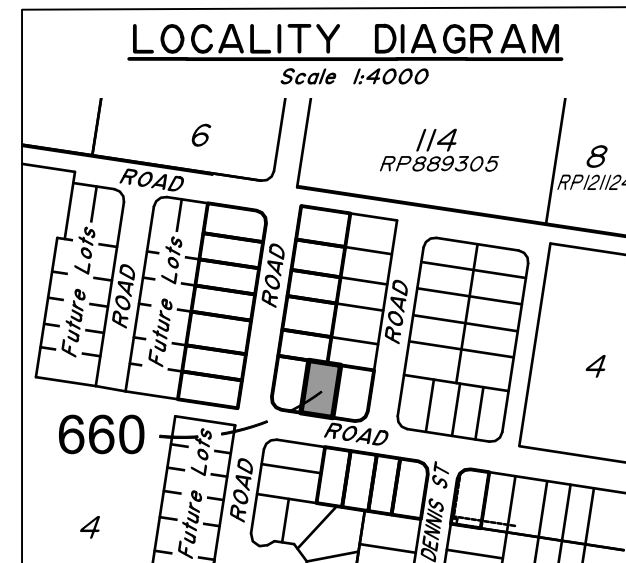

dawn.
WALLOON

WATERLEA STAGE 6B2
For

Waterlea Nominees Co.

IMPORTANT NOTES:

(These notes are an integral part of this plan)
This plan has been prepared for Waterlea Nominees Co. and ID Land for the purposes of A Disclosure Plan Under the Land Sales Act 1984 (as amended).
It is not to be used by any other person or corporation or for any other purposes and is subject to the following limitations:

Please refer to the approved Development Application for conditions relating to the LOT and to approved Operational Works drawings for services location and possible easements.

THESE DESIGNS AND DRAWINGS ARE COPYRIGHT AND ARE NOT TO BE USED OR REPRODUCED WITHOUT THE WRITTEN PERMISSION OF VERIS

Data Sources

Cadastral Boundaries
401364-L01-11.dwg
Engineering Design
21-000113.02-2230 Stage Retaining Wall Setout.dwg
Final Surface Contours
20221201 Waterlea Stage 6B2 6B3 Design Conts.dwg
Depth of Fill
20221201 Waterlea Stage 6B2 6B3 Depth Conts.dwg

Issue	Revisions	Date	Drawn
C	Engineering updated	16.12.2022	BK
B	Add Lots 626-630, Amd Eng Name Widen Lot 678	21.03.2022	GJF
A	Original	10.03.2022	GJF

Locality: WALLOON
Local Authority: Ipswich City Council
Horizontal Meridian: MGA Zone 56
Vertical Level Datum: AHD
Scale: 1:250 @ A4
Designed: **
Drawn: GJF 10/03/2022
Checked: KJJ 15/03/2022
Plot Date: 01 Feb, 2023
Comp File Ref: 401364-Stage 6B2-DP01(C).dwg

DISCLOSURE PLAN
of Proposed LOT 660
currently being part of
Lot 1 on SP331771.



veris

BRISBANE WHITSUNDAYS
(07) 3686 4700 (07) 4945 6600

MACKAY CAIRNS
(07) 4957 9700 (07) 4252 9400

veris.com.au
ACN 615 735 727
Veris Australia Pty Ltd

Drawing No Issue
401364-06-DP-660 C





LEGEND

Final surface contours based on A.H.D. datum at an interval of 0.25m, shown as: — 15.5 —

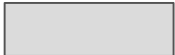
Where applicable, areas to be filled are shown as: 

Depth of fill, in metres, shown as:- +[1.1]

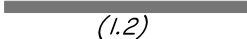
Retaining wall and retaining wall height, shown on the lower side of the wall, have been taken from plans supplied by Calibre Group and shown as: 

ADDITIONAL NOTES:

The LOT dimensions and area shown hereon are subject to final field survey and also to the requirements of Council and any other authority which may have requirements under any relevant legislation

Final surface contours shown hereon have been supplied by Calibre Group.

Compaction of any fill material placed on this site shall be completed to level one inspection and testing services in accordance with AS3798-2007.

Copyright ©Veris Australia Pty Ltd 16/12/2022.

LOCALITY DIAGRAM

Scale 1:4000

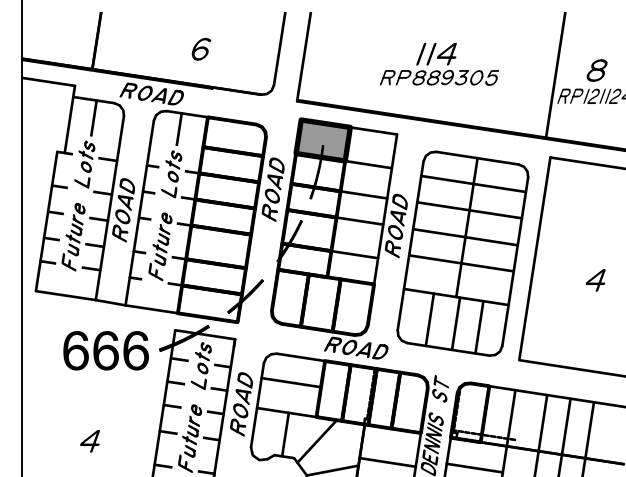

dawn.
WALLOON

WATERLEA STAGE 6B2
For

Waterlea Nominees Co.

IMPORTANT NOTES:

(These notes are an integral part of this plan)
This plan has been prepared for Waterlea Nominees Co. and ID Land for the purposes of A Disclosure Plan Under the Land Sales Act 1984 (as amended).
It is not to be used by any other person or corporation or for any other purposes and is subject to the following limitations:

Please refer to the approved Development Application for conditions relating to the LOT and to approved Operational Works drawings for services location and possible easements.

THESE DESIGNS AND DRAWINGS ARE COPYRIGHT AND ARE NOT TO BE USED OR REPRODUCED WITHOUT THE WRITTEN PERMISSION OF VERIS

Data Sources

Cadastral Boundaries
401364-L001(1) dwg
Engineering Design
21-000113.02-2230 Stage Retaining Wall Setout.dwg
Final Surface Contours
20221201 Waterlea Stage 6B2 6B3 Design Conts.dwg
Depth of Fill
20221201 Waterlea Stage 6B2 6B3 Depth Conts.dwg

D	Bearing change Lot 666	31.07.2023	DMC
C	Engineering updated	16.12.2022	BK
B	Add Lots 626-630, Amd Eng Name Widen Lot 678	21.03.2022	GJF
A	Original	10.03.2022	GJF
Issue	Revisions	Date	Drawn

Locality: WALLOON
Local Authority: Ipswich City Council
Horizontal Meridian: MGA Zone 56
Vertical Level Datum: AHD
Scale: 1:250 @ A4
Designed: **
Drawn: GJF 10/03/2022
Checked: KJJ 15/03/2022
Plot Date: 31 Jul, 2023
Comp File Ref: 401364-Stg6-B2-DP01(D).dwg

DISCLOSURE PLAN
of Proposed LOT 666
currently being part of
Lot 1 on SP331771.



veris

BRISBANE WHITSUNDAYS
(07) 3686 4700 (07) 4945 6600

MACKAY CAIRNS
(07) 4957 9700 (07) 4252 9400

veris.com.au
ACN 615 735 727
Veris Australia Pty Ltd

Drawing No Issue
401364-06-DP-666 D

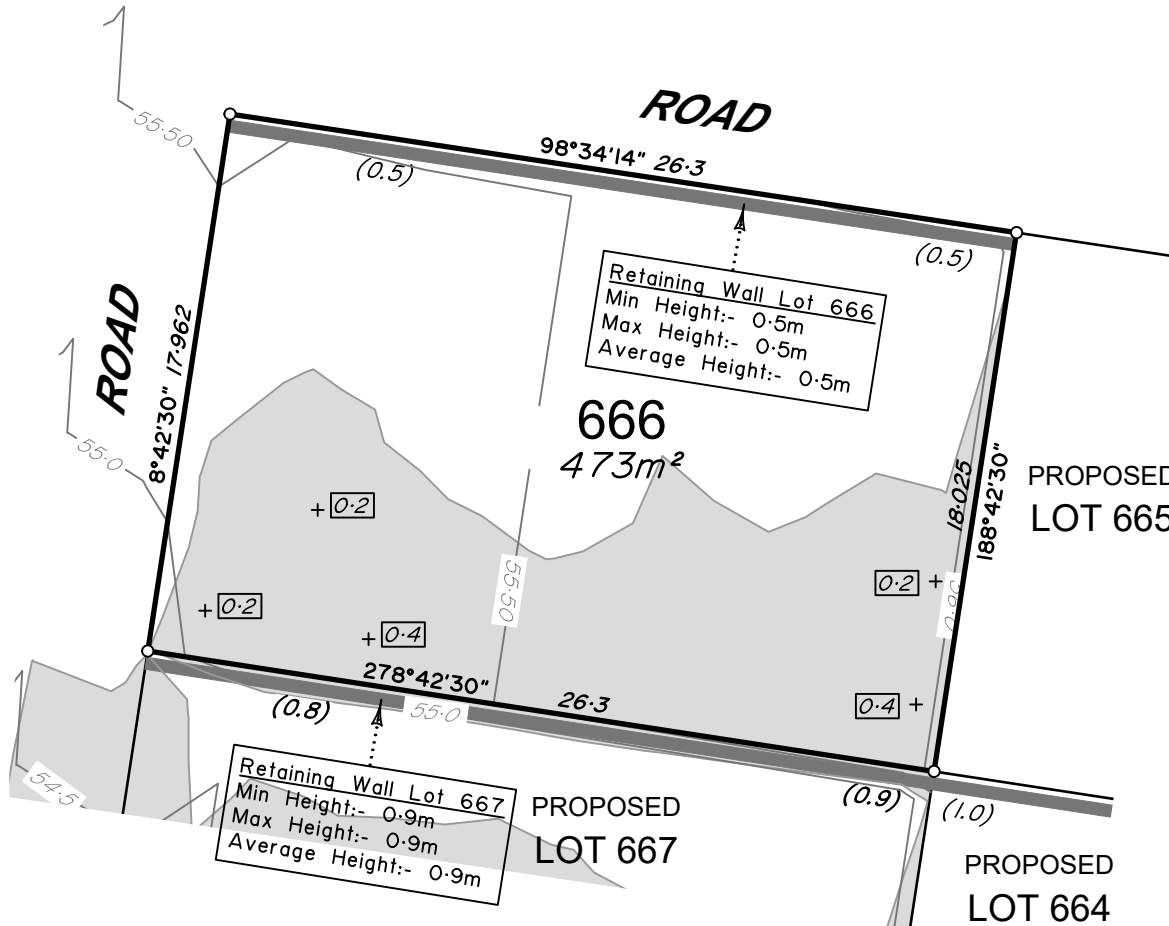

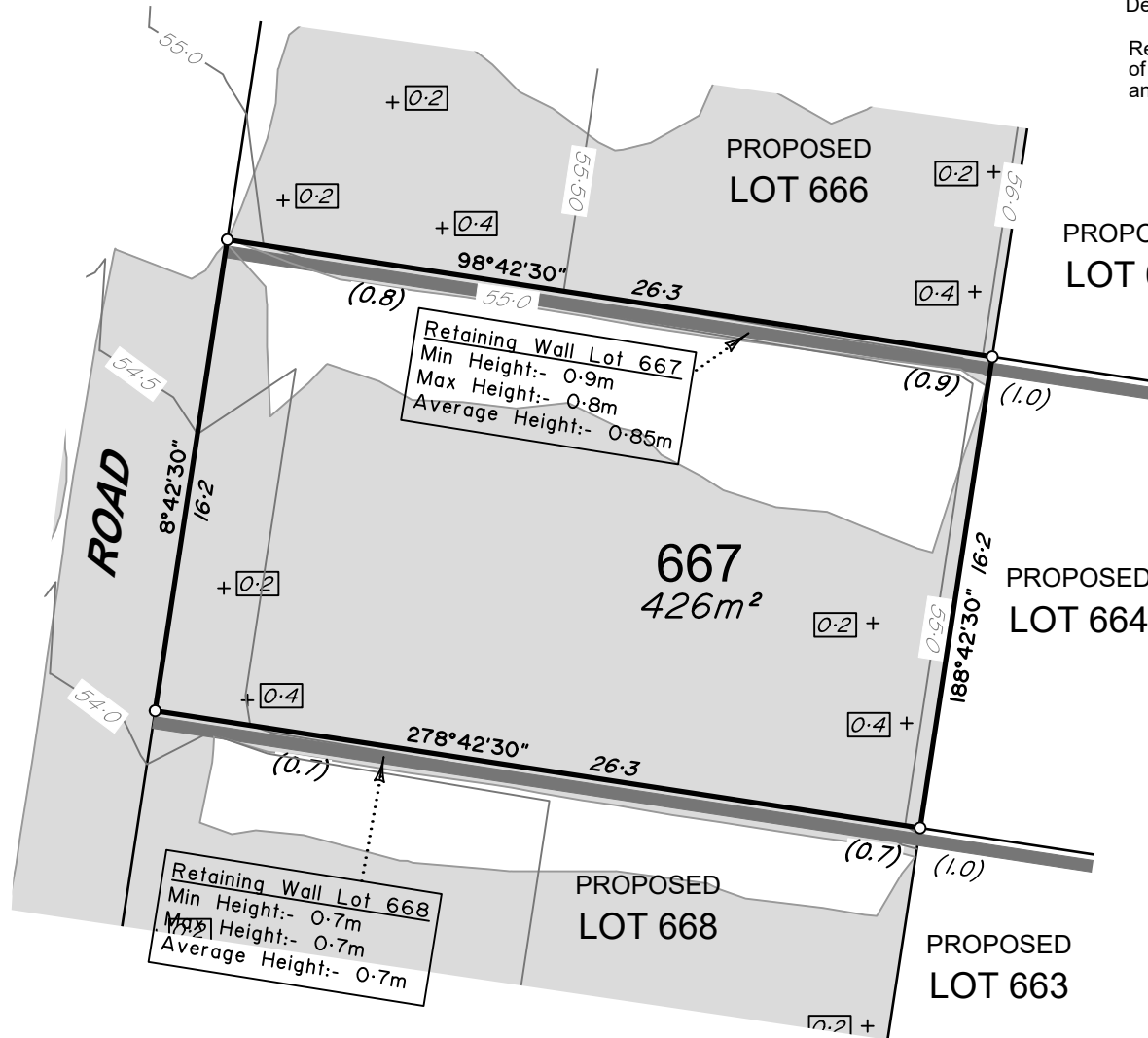

LEGEND

Final surface contours based on A.H.D. datum at an interval of 0.25m, shown as: — 15.5 —

Where applicable, areas to be filled are shown as: [shaded area]

Depth of fill, in metres, shown as:- +[1.1]

Retaining wall and retaining wall height, shown on the lower side of the wall, have been taken from plans supplied by Calibre Group and shown as: [shaded area] (1.2)

ADDITIONAL NOTES:

The LOT dimensions and area shown hereon are subject to final field survey and also to the requirements of Council and any other authority which may have requirements under any relevant legislation

Final surface contours shown hereon have been supplied by Calibre Group.

Compaction of any fill material placed on this site shall be completed to level one inspection and testing services in accordance with AS3798-2007.

Copyright ©Veris Australia Pty Ltd 16/12/2022.

LOCALITY DIAGRAM

Scale 1:4000

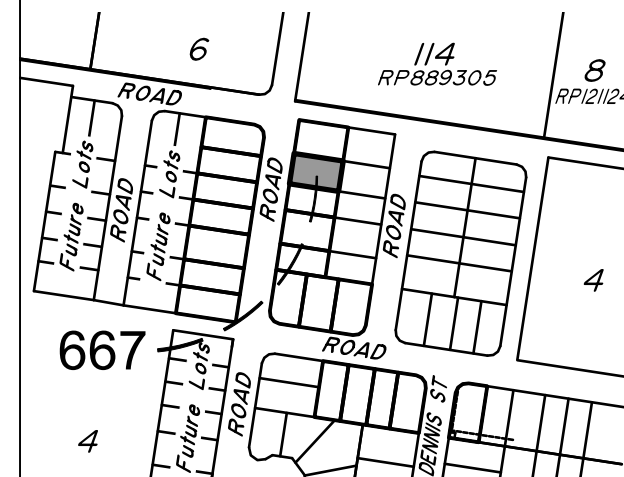

dawn.
WALLOON

WATERLEA STAGE 6B2
For

Waterlea Nominees Co.

IMPORTANT NOTES:

(These notes are an integral part of this plan)

This plan has been prepared for Waterlea Nominees Co. and ID Land for the purposes of A Disclosure Plan Under the Land Sales Act 1984 (as amended).

It is not to be used by any other person or corporation or for any other purposes and is subject to the following limitations:

Please refer to the approved Development Application for conditions relating to the LOT and to approved Operational Works drawings for services location and possible easements.

THESE DESIGNS AND DRAWINGS ARE COPYRIGHT AND ARE NOT TO BE USED OR REPRODUCED WITHOUT THE WRITTEN PERMISSION OF VERIS

Data Sources

Cadastral Boundaries
401364-L001(1) dwg
Engineering Design
21-000113.02-230 Stage Retaining Wall
Setout.dwg
Final Surface Contours
20221201 Waterlea Stage 6B2 6B3 Design Conts.dwg
Depth of Fill
20221201 Waterlea Stage 6B2 6B3 Depth Conts.dwg

C	Engineering updated	16.12.2022	BK
B	Add Lots 626-630, Amd Eng Name Widen Lot 678	21.03.2022	GJF
A	Original	10.03.2022	GJF
Issue	Revisions	Date	Drawn

Locality: WALLOON
Local Authority: Ipswich City Council
Horizontal Meridian: MGA Zone 56
Vertical Level Datum: AHD
Scale: 1:250 @ A4
Designed: **
Drawn: GJF 10/03/2022
Checked: KJJ 15/03/2022
Plot Date: 01 Feb, 2023
Comp File Ref: 401364-Stg6-B2-DP01(C).dwg

DISCLOSURE PLAN
of Proposed LOT 667
currently being part of
Lot 1 on SP331771.



veris

BRISBANE WHITSUNDAYS
(07) 3686 4700 (07) 4945 6600

MACKAY CAIRNS
(07) 4957 9700 (07) 4252 9400

veris.com.au
ACN 615 735 727
Veris Australia Pty Ltd

Drawing No Issue
401364-06-DP-667 C

0 12.5m 50 mm 25m 100 mm 37.5m 150 mm SCALE BAR

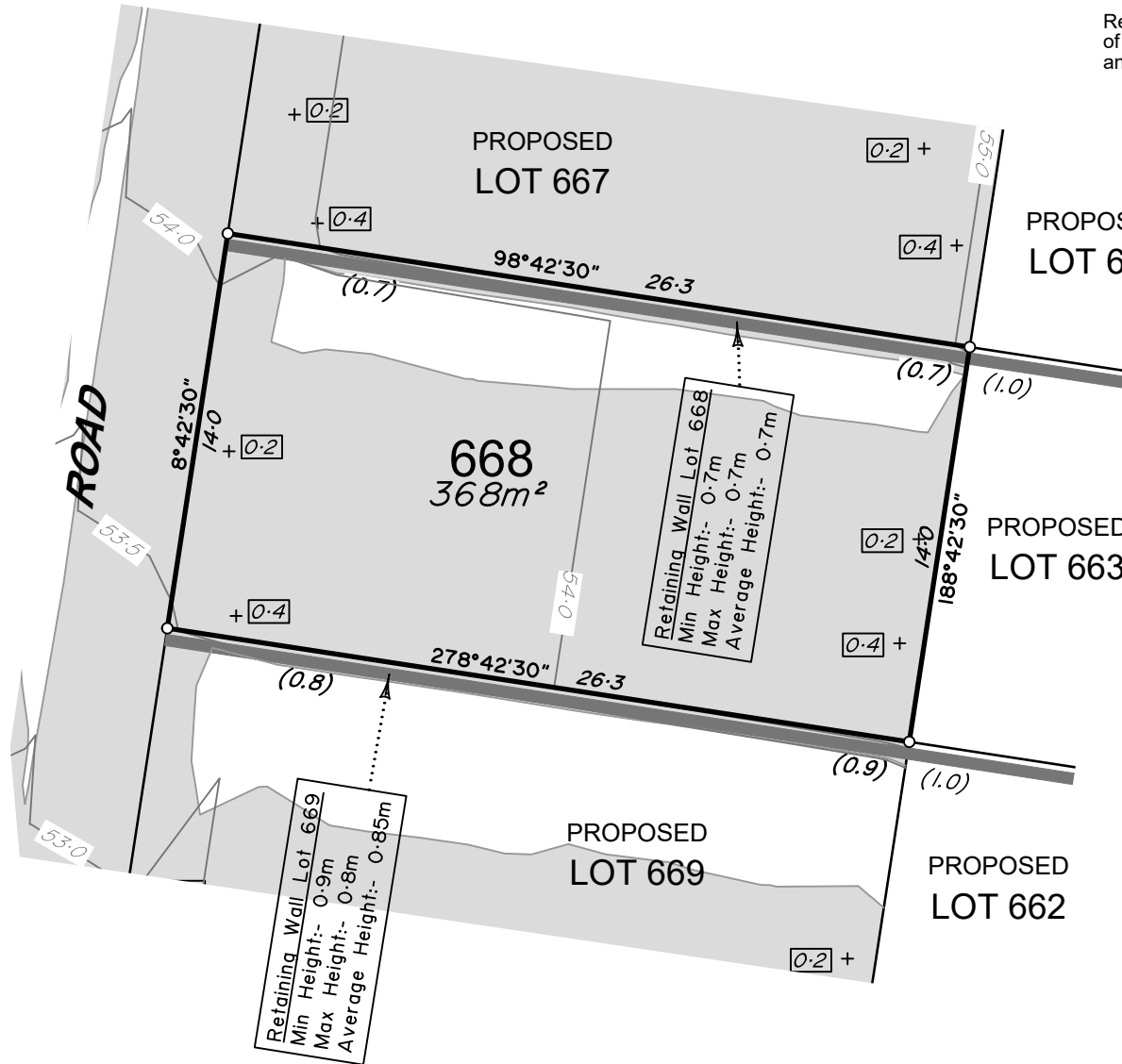

LEGEND

Final surface contours based on A.H.D. datum at an interval of 0.25m, shown as: 15.5

Where applicable, areas to be filled are shown as:

Depth of fill, in metres, shown as:- + 1.1

Retaining wall and retaining wall height, shown on the lower side of the wall, have been taken from plans supplied by Calibre Group and shown as: (1.2)

ADDITIONAL NOTES:

The LOT dimensions and area shown hereon are subject to final field survey and also to the requirements of Council and any other authority which may have requirements under any relevant legislation

Final surface contours shown hereon have been supplied by Calibre Group.

Compaction of any fill material placed on this site shall be completed to level one inspection and testing services in accordance with AS3798-2007.

Copyright ©Veris Australia Pty Ltd 16/12/2022.

LOCALITY DIAGRAM

Scale 1:4000

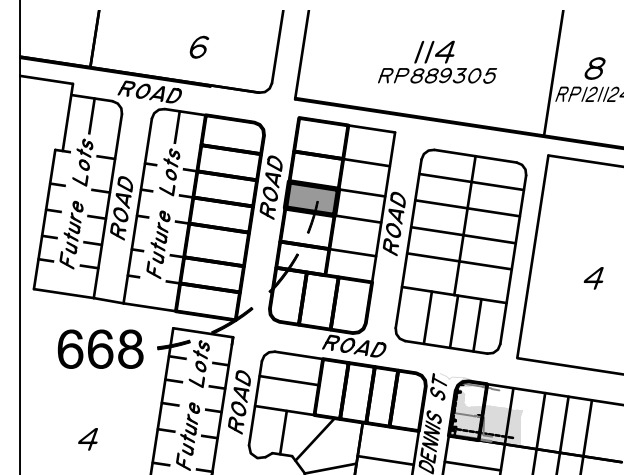

dawn.
WALLOON

WATERLEA STAGE 6B2
For

Waterlea Nominees Co.

IMPORTANT NOTES:

(These notes are an integral part of this plan)

This plan has been prepared for Waterlea Nominees Co. and ID Land for the purposes of A Disclosure Plan Under the Land Sales Act 1984 (as amended).

It is not to be used by any other person or corporation or for any other purposes and is subject to the following limitations:

Please refer to the approved Development Application for conditions relating to the LOT and to approved Operational Works drawings for services location and possible easements.

THESE DESIGNS AND DRAWINGS ARE COPYRIGHT AND ARE NOT TO BE USED OR REPRODUCED WITHOUT THE WRITTEN PERMISSION OF VERIS

Data Sources

Cadastral Boundaries
401364-LC01-T1.dwg
Engineering Design
21-000113.02-2230 Stage Retaining Wall
Setout.dwg
Final Surface Contours
20221201 Waterlea Stage 6B2 6B3 Design Conts.dwg
Depth of Fill
20221201 Waterlea Stage 6B2 6B3 Depth Conts.dwg

Issue	Revisions	Date	Drawn
C	Engineering updated	16.12.2022	BK
B	Add Lots 626-630, Amend Eng Name Widen Lot 678	21.03.2022	GJF
A	Original	10.03.2022	GJF

Locality:
Local Authority: Ipswich City Council
Horizontal Meridian: MGA Zone 56
Vertical Level Datum: AHD
Scale: 1:250 @ A4
Designed: **
Drawn: GJF 10/03/2022
Checked: KJJ 15/03/2022
Plot Date: 01 Feb, 2023
Comp File Ref: 401364-Stg6-B2-DP01(C).dwg

DISCLOSURE PLAN
of Proposed LOT 668
currently being part of
Lot 1 on SP331771.



veris

BRISBANE WHITSUNDAYS
(07) 3686 4700 (07) 4945 6600

MACKAY CAIRNS
(07) 4957 9700 (07) 4252 9400

veris.com.au
ACN 615 735 727
Veris Australia Pty Ltd

Drawing No Issue
401364-06-DP-668 C

0 12.5m 50 mm 25m 100 mm 37.5m 150 mm SCALE BAR

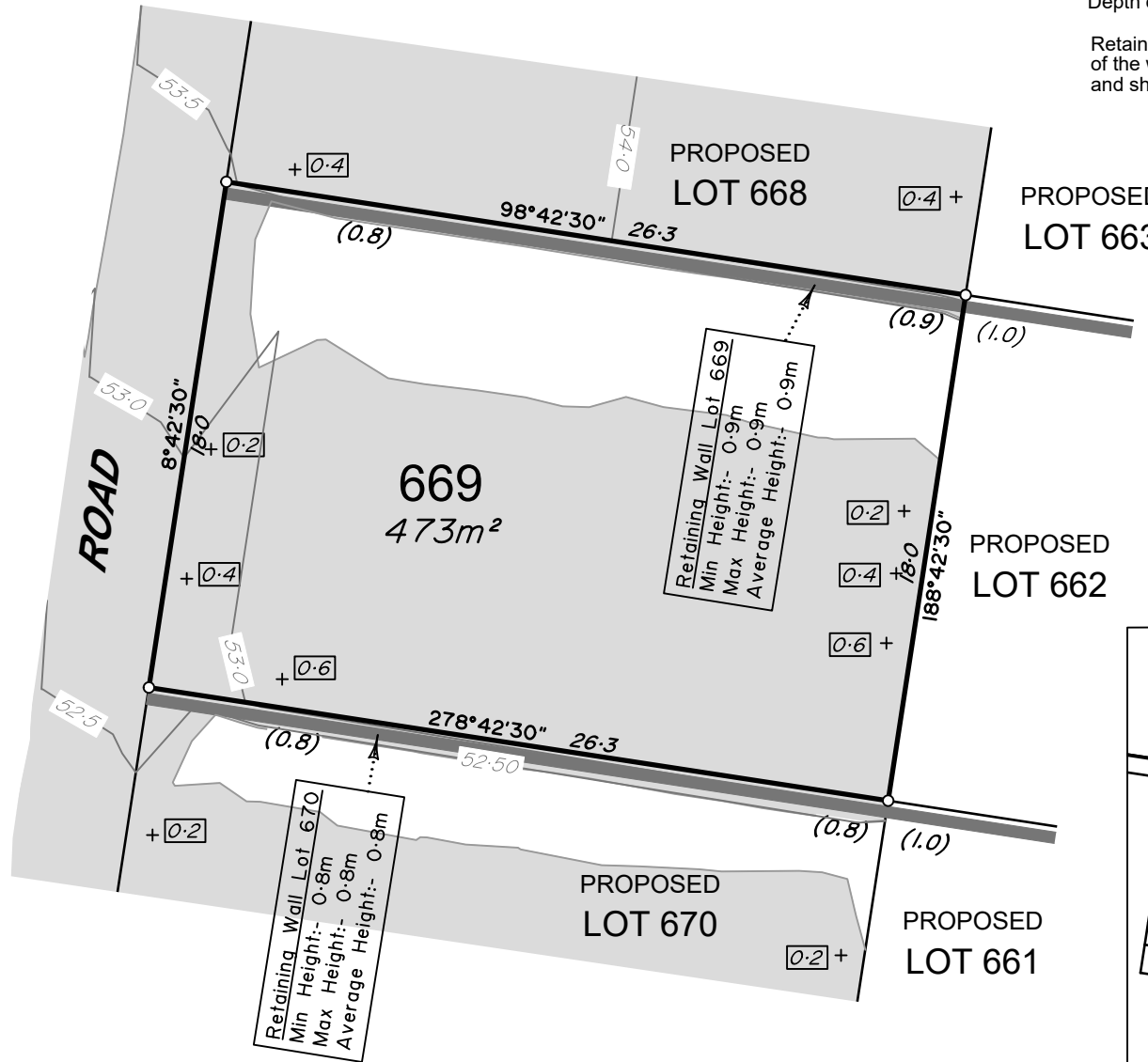

LEGEND

Final surface contours based on A.H.D. datum at an interval of 0.25m, shown as:  15.5

Where applicable, areas to be filled are shown as: 

Depth of fill, in metres, shown as:- + 1.1

Retaining wall and retaining wall height, shown on the lower side of the wall, have been taken from plans supplied by Calibre Group and shown as:  (1.2)

ADDITIONAL NOTES:

The LOT dimensions and area shown hereon are subject to final field survey and also to the requirements of Council and any other authority which may have requirements under any relevant legislation

Final surface contours shown hereon have been supplied by Calibre Group.

Compaction of any fill material placed on this site shall be completed to level one inspection and testing services in accordance with AS3798-2007.

Copyright ©Veris Australia Pty Ltd 16/12/2022.

LOCALITY DIAGRAM

Scale 1:4000

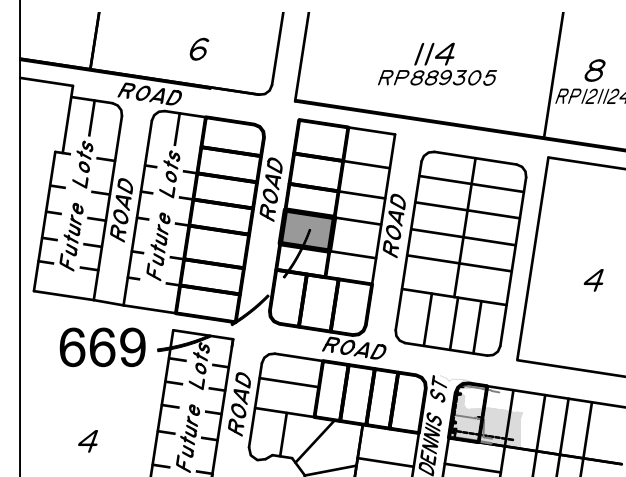

dawn.
WALLOON

WATERLEA STAGE 6B2
For

Waterlea Nominees Co.

IMPORTANT NOTES:

(These notes are an integral part of this plan)

This plan has been prepared for Waterlea Nominees Co. and ID Land for the purposes of a Disclosure Plan Under the Land Sales Act 1984 (as amended).

It is not to be used by any other person or corporation or for any other purposes and is subject to the following limitations:

Please refer to the approved Development Application for conditions relating to the LOT and to approved Operational Works drawings for services location and possible easements.

THESE DESIGNS AND DRAWINGS ARE COPYRIGHT AND ARE NOT TO BE USED OR REPRODUCED WITHOUT THE WRITTEN PERMISSION OF VERIS

Data Sources

Cadastral Boundaries
401364-L001(1).dwg
Engineering Design
21-000113.02-2230 Stage Retaining Wall
Setout.dwg
Final Surface Contours
20221201 Waterlea Stage 6B2 6B3 Design Conts.dwg
Depth of Fill
20221201 Waterlea Stage 6B2 6B3 Depth Conts.dwg

Issue	Revisions	Date	Drawn
C	Engineering updated	16.12.2022	BK
B	Add Lots 626-630, Amend Eng Name	21.03.2022	GJF
A	Original	10.03.2022	GJF

Locality:
Local Authority:
Horizontal Meridian:
Vertical Level Datum:
Scale:
Designed:
Drawn:
Checked:
Plot Date:
Comp File Ref:

WALLOON
Ipswich City Council
MGA Zone 56
AHD
1:250 @ A4
**
GJF 10/03/2022
KJJ 15/03/2022
01 Feb, 2023
401364-Stg6-B2-DP01(C).dwg

DISCLOSURE PLAN
of Proposed LOT 669
currently being part of
Lot 1 on SP331771.



veris

BRISBANE WHITSUNDAYS
(07) 3686 4700 (07) 4945 6600

MACKAY CAIRNS
(07) 4957 9700 (07) 4252 9400

veris.com.au
ACN 615 735 727
Veris Australia Pty Ltd

Drawing No Issue
401364-06-DP-669 C

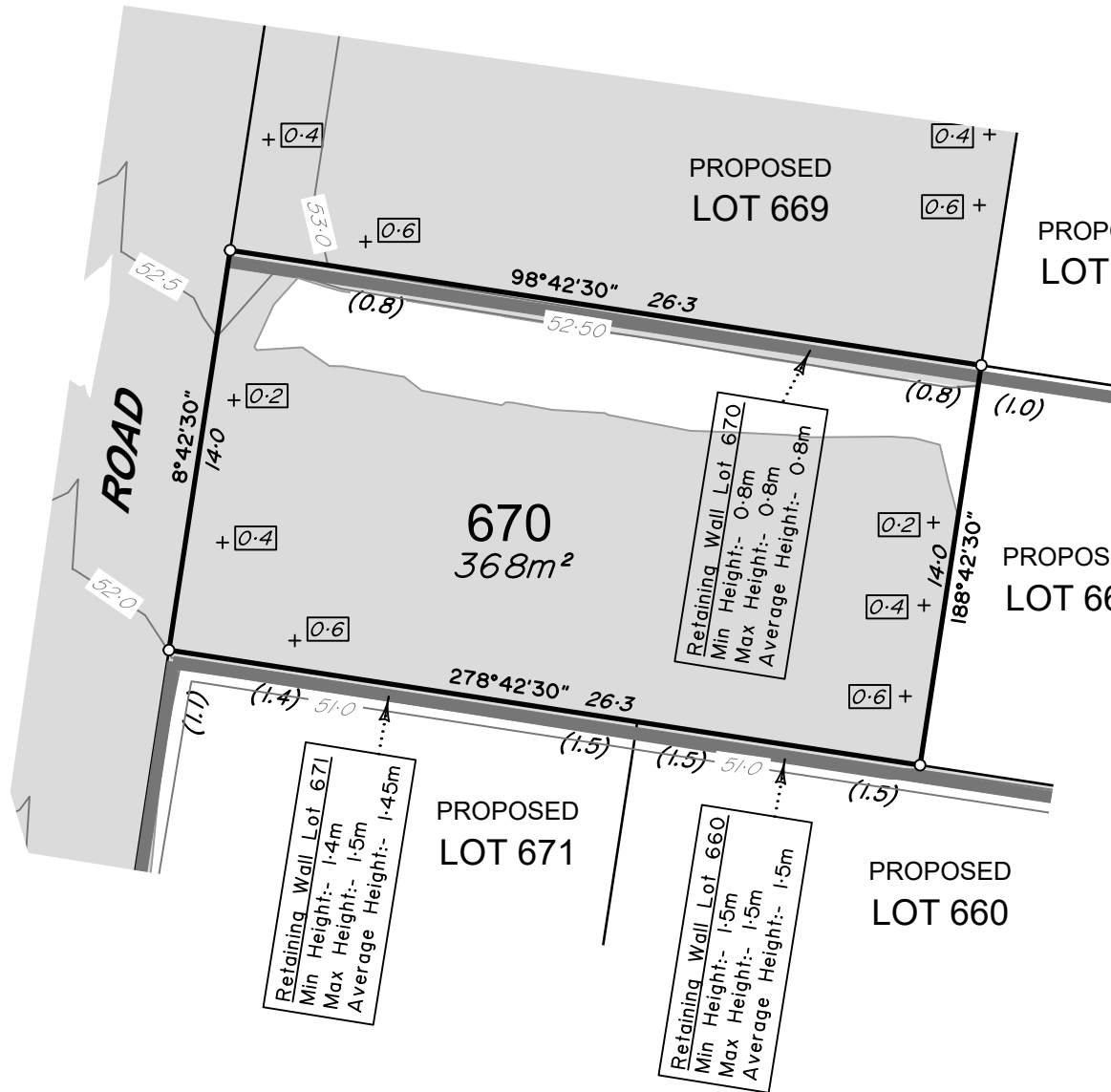

LEGEND

Final surface contours based on A.H.D. datum at an interval of 0.25m, shown as: 15.5

Where applicable, areas to be filled are shown as:

Depth of fill, in metres, shown as:- +1.1

Retaining wall and retaining wall height, shown on the lower side of the wall, have been taken from plans supplied by Calibre Group and shown as: (1.2)

ADDITIONAL NOTES:

The LOT dimensions and area shown hereon are subject to final field survey and also to the requirements of Council and any other authority which may have requirements under any relevant legislation

Final surface contours shown hereon have been supplied by Calibre Group.

Compaction of any fill material placed on this site shall be completed to level one inspection and testing services in accordance with AS3798-2007.

Copyright ©Veris Australia Pty Ltd 16/12/2022.

LOCALITY DIAGRAM

Scale 1:4000

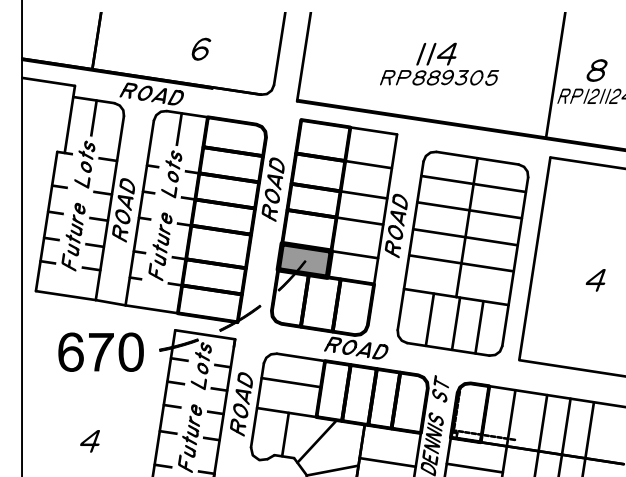

dawn.
WALLOON

WATERLEA STAGE 6B2
For

Waterlea Nominees Co.

IMPORTANT NOTES:

(These notes are an integral part of this plan)
This plan has been prepared for Waterlea Nominees Co. and ID Land for the purposes of A Disclosure Plan Under the Land Sales Act 1984 (as amended).
It is not to be used by any other person or corporation or for any other purposes and is subject to the following limitations:

Please refer to the approved Development Application for conditions relating to the LOT and to approved Operational Works drawings for services location and possible easements.

THESE DESIGNS AND DRAWINGS ARE COPYRIGHT AND ARE NOT TO BE USED OR REPRODUCED WITHOUT THE WRITTEN PERMISSION OF VERIS

Data Sources

Cadastral Boundaries
401364-L001(1).dwg
Engineering Design
21-000113.02-2230 Stage Retaining Wall
Setout.dwg
Final Surface Contours
20221201 Waterlea Stage 6B2 6B3 Design Conts.dwg
Depth of Fill
20221201 Waterlea Stage 6B2 6B3 Depth Conts.dwg

Issue	Revisions	Date	Drawn
C	Engineering updated	16.12.2022	BK
B	Add Lots 626-630, Amd Eng Name Widen Lot 678	21.03.2022	GJF
A	Original	10.03.2022	GJF

Locality: WALLOON
Local Authority: Ipswich City Council
Horizontal Meridian: MGA Zone 56
Vertical Level Datum: AHD
Scale: 1:250 @ A4
Designed: **
Drawn: GJF 10/03/2022
Checked: KJJ 15/03/2022
Plot Date: 01 Feb, 2023
Comp File Ref: 401364-Stg6-B2-DP01(C).dwg

DISCLOSURE PLAN
of Proposed LOT 670
currently being part of
Lot 1 on SP331771.



veris

BRISBANE (07) 3686 4700 WHITSUNDAYS (07) 4945 6600

MACKAY (07) 4957 9700 CAIRNS (07) 4252 9400

veris.com.au
ACN 615 735 727
Veris Australia Pty Ltd

Drawing No
401364-06-DP-670
Issue
C

0 12.5m 50 mm 25m 100 mm 37.5m 150 mm SCALE BAR

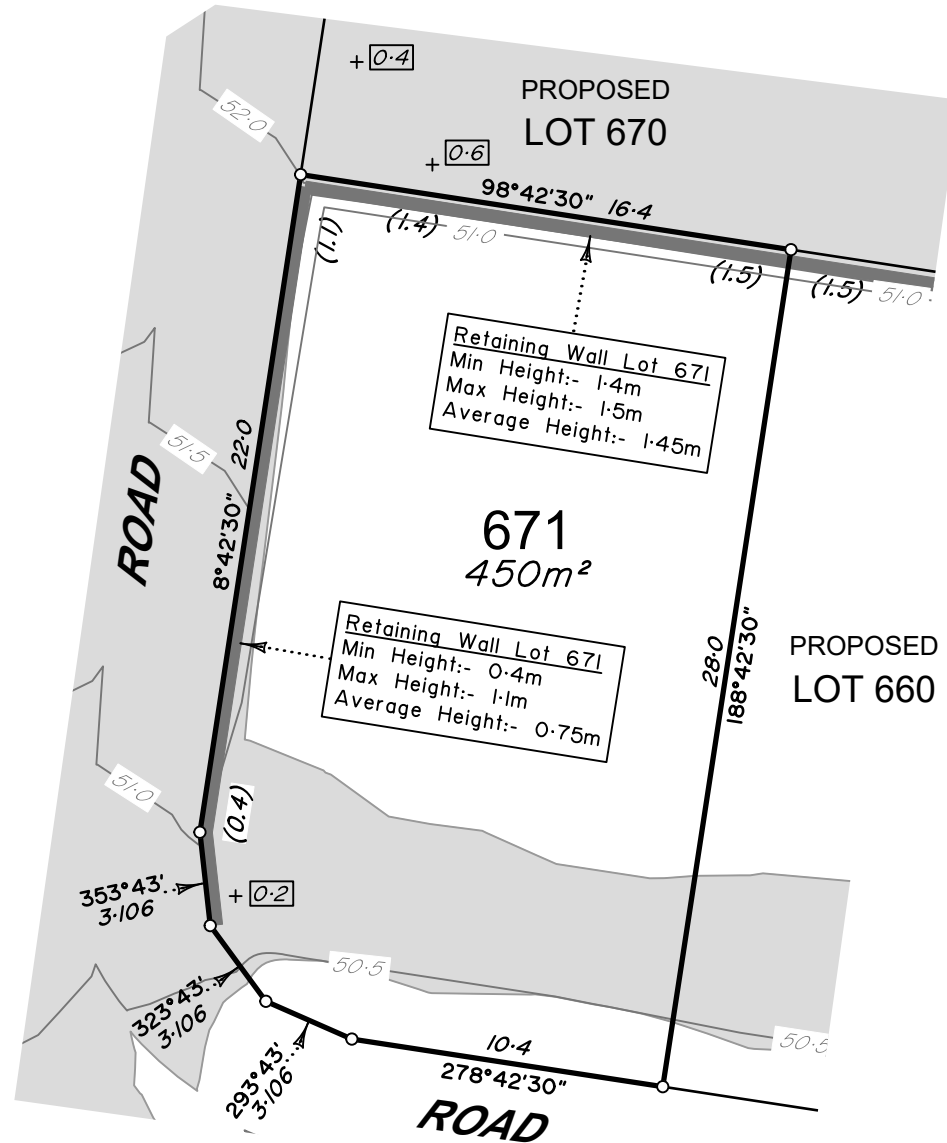

LEGEND

Final surface contours based on A.H.D. datum at an interval of 0.25m, shown as: $\text{---} 15.5 \text{---}$

Where applicable, areas to be filled are shown as:

Depth of fill, in metres, shown as: $\text{---} +1.1 \text{---}$

Retaining wall and retaining wall height, shown on the lower side of the wall, have been taken from plans supplied by Calibre Group and shown as: $\text{---} (1.2) \text{---}$

ADDITIONAL NOTES:

The LOT dimensions and area shown hereon are subject to final field survey and also to the requirements of Council and any other authority which may have requirements under any relevant legislation

Final surface contours shown hereon have been supplied by Calibre Group.

Compaction of any fill material placed on this site shall be completed to level one inspection and testing services in accordance with AS3798-2007.

Copyright ©Veris Australia Pty Ltd 16/12/2022.

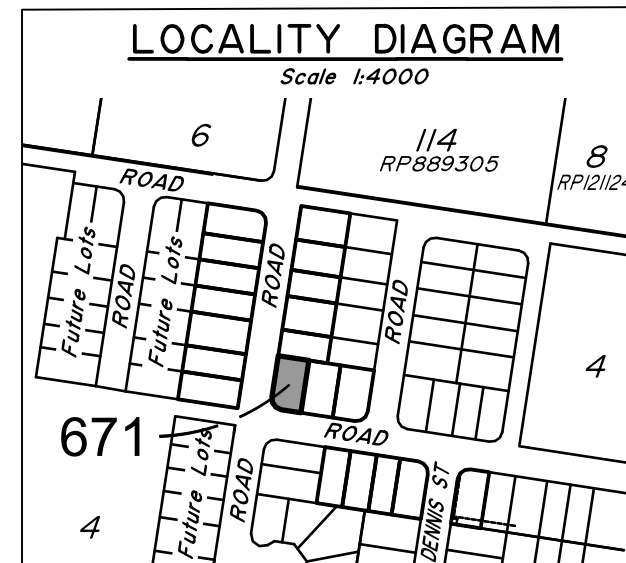

dawn.
WALLOON

WATERLEA STAGE 6B2
For

Waterlea Nominees Co.

IMPORTANT NOTES:
(These notes are an integral part of this plan)
This plan has been prepared for Waterlea Nominees Co. and ID Land for the purposes of A Disclosure Plan Under the Land Sales Act 1984 (as amended).
It is not to be used by any other person or corporation or for any other purposes and is subject to the following limitations:

Please refer to the approved Development Application for conditions relating to the LOT and to approved Operational Works drawings for services location and possible easements.

THESE DESIGNS AND DRAWINGS ARE COPYRIGHT AND ARE NOT TO BE USED OR REPRODUCED WITHOUT THE WRITTEN PERMISSION OF VERIS

Data Sources
Cadastral Boundaries
401364-L001(1) dwg
Engineering Design
21-000113.02-2230 Stage Retaining Wall Setout.dwg
Final Surface Contours
20221201 Waterlea Stage 6B2 6B3 Design Conts.dwg
Depth of Fill
20221201 Waterlea Stage 6B2 6B3 Depth Conts.dwg

Issue	Revisions	Date	Drawn
C	Engineering updated	16.12.2022	BK
B	Add Lots 626-630, Amend Eng Name Widen Lot 678	21.03.2022	GJF
A	Original	10.03.2022	GJF

Locality: WALLOON
Local Authority: Ipswich City Council
Horizontal Meridian: MGA Zone 56
Vertical Level Datum: AHD
Scale: 1:250 @ A4
Designed: **
Drawn: GJF 10/03/2022
Checked: KJJ 15/03/2022
Plot Date: 01 Feb, 2023
Comp File Ref: 401364-Stg6-B2-DP01(C).dwg

DISCLOSURE PLAN
of Proposed LOT 671
currently being part of
Lot 1 on SP331771.



veris

BRISBANE WHITSUNDAYS
(07) 3686 4700 (07) 4945 6600

MACKAY CAIRNS
(07) 4957 9700 (07) 4252 9400

veris.com.au
ACN 615 735 727
Veris Australia Pty Ltd

Drawing No Issue
401364-06-DP-671 C

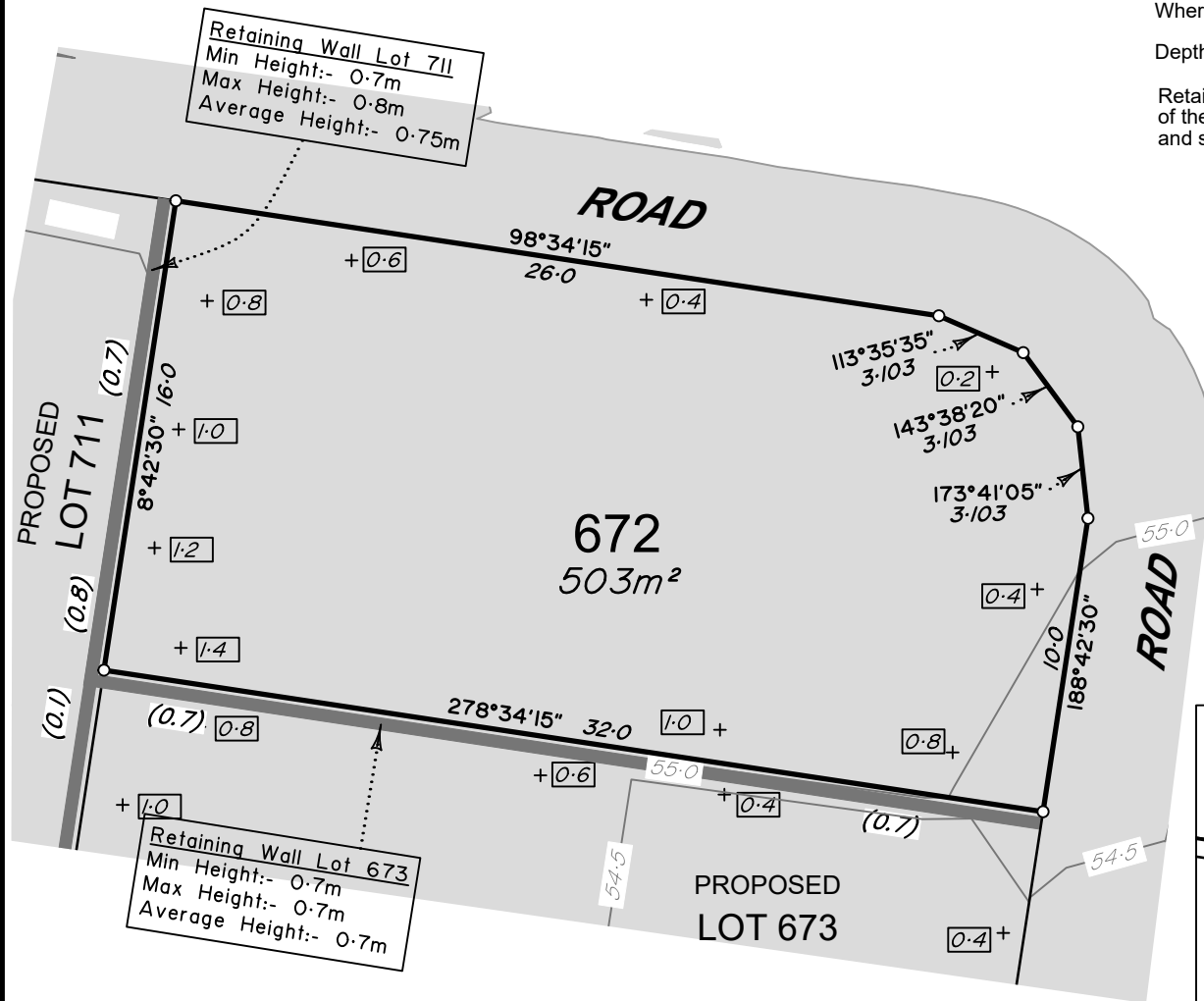

LEGEND

Final surface contours based on A.H.D. datum at an interval of 0.25m, shown as:  15.5

Where applicable, areas to be filled are shown as: 

Depth of fill, in metres, shown as:  +1.1

Retaining wall and retaining wall height, shown on the lower side of the wall, have been taken from plans supplied by Calibre Group and shown as:  (1.2)

ADDITIONAL NOTES:

The LOT dimensions and area shown hereon are subject to final field survey and also to the requirements of Council and any other authority which may have requirements under any relevant legislation

Final surface contours shown hereon have been supplied by Calibre Group.

Compaction of any fill material placed on this site shall be completed to level one inspection and testing services in accordance with AS3798-2007.

Copyright ©Veris Australia Pty Ltd 16/12/2022.

LOCALITY DIAGRAM

Scale 1:4000

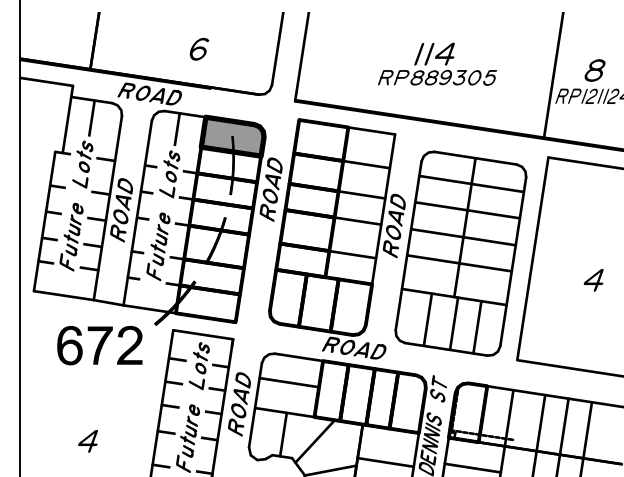

dawn.
WALLOON

WATERLEA STAGE 6B2
For

Waterlea Nominees Co.

IMPORTANT NOTES:

(These notes are an integral part of this plan)
This plan has been prepared for Waterlea Nominees Co. and ID Land for the purposes of A Disclosure Plan Under the Land Sales Act 1984 (as amended).
It is not to be used by any other person or corporation or for any other purposes and is subject to the following limitations:

Please refer to the approved Development Application for conditions relating to the LOT and to approved Operational Works drawings for services location and possible easements.

THESE DESIGNS AND DRAWINGS ARE COPYRIGHT AND ARE NOT TO BE USED OR REPRODUCED WITHOUT THE WRITTEN PERMISSION OF VERIS

Data Sources

Cadastral Boundaries
401364-LC01(1) dwg
Engineering Design
21-000113.02-2230 Stage Retaining Wall Setout.dwg
Final Surface Contours
20221201 Waterlea Stage 6B2 6B3 Design Conts.dwg
Depth of Fill
20221201 Waterlea Stage 6B2 6B3 Depth Conts.dwg

C	Engineering updated	16.12.2022	BK
B	Add Lots 626-630, Amd Eng Name Widen Lot 678	21.03.2022	GJF
A	Original	10.03.2022	GJF
Issue	Revisions	Date	Drawn

Locality: WALLOON
Local Authority: Ipswich City Council
Horizontal Meridian: MGA Zone 56
Vertical Level Datum: AHD
Scale: 1:250 @ A4
Designed: **
Drawn: GJF 10/03/2022
Checked: KJJ 15/03/2022
Plot Date: 01 Feb, 2023
Comp File Ref: 401364-Stg6-B2-DP01(C).dwg

DISCLOSURE PLAN
of Proposed LOT 672
currently being part of
Lot 1 on SP331771.



veris

BRISBANE WHITSUNDAYS
(07) 3686 4700 (07) 4945 6600

MACKAY CAIRNS
(07) 4957 9700 (07) 4252 9400

veris.com.au
ACN 615 735 727
Veris Australia Pty Ltd

Drawing No Issue
401364-06-DP-672 C

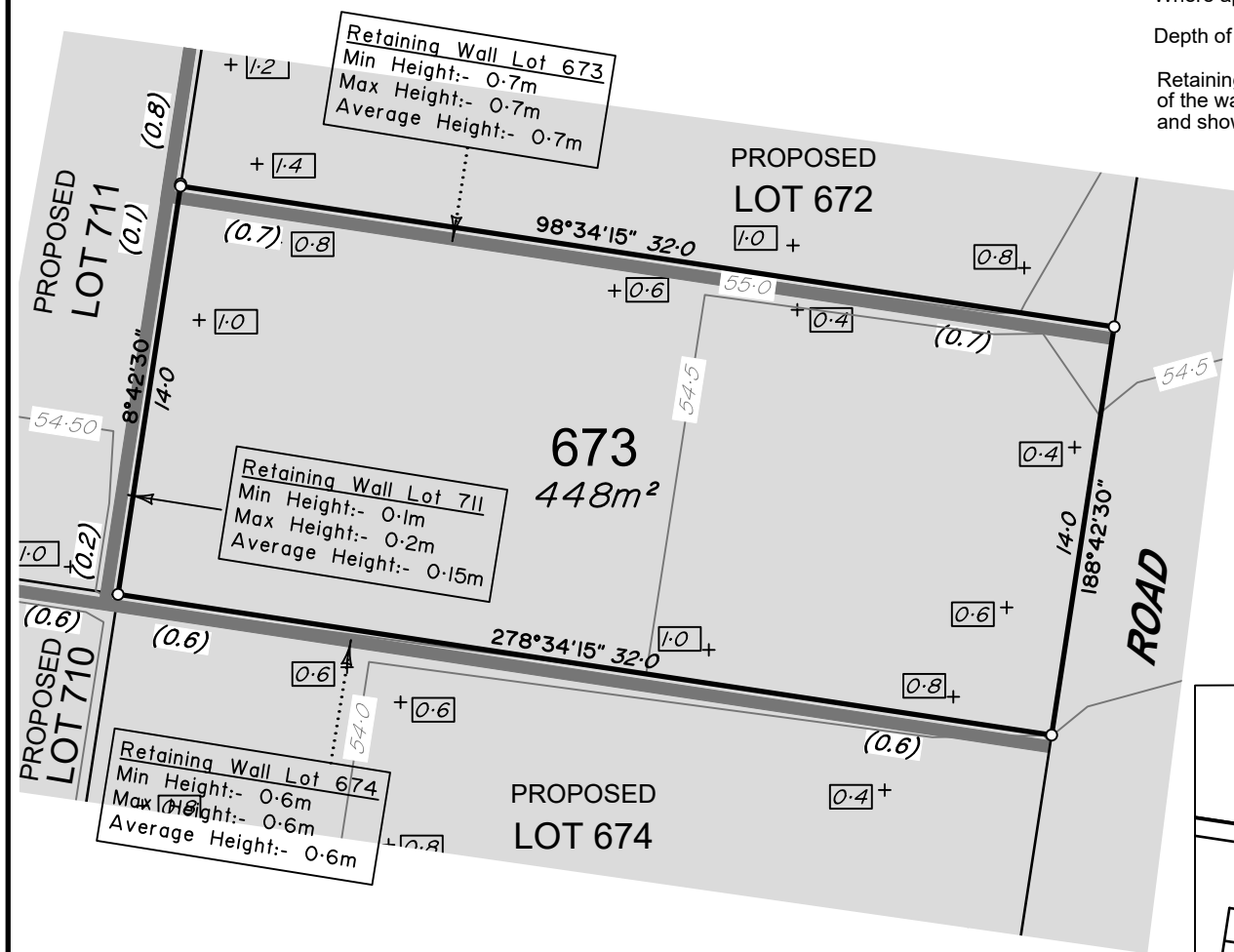

Final surface contours based on A.H.D. datum at an interval of 0.25m,
shown as: — 15.5 —

□

Retaining wall and retaining wall height, shown on the lower side of the wall, have been taken from plans supplied by Calibre Group and shown as:

(1.2)

The LOT dimensions and area shown hereon are subject to final field survey and also to the requirements of Council and any other authority which may have requirements under any relevant legislation

Compaction of any fill material placed on this site shall be completed to level one inspection and testing services in accordance with AS3798-2007.

Copyright © Veris Australia Pty Ltd 16/12/2022.

Scale 1:4000

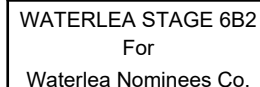
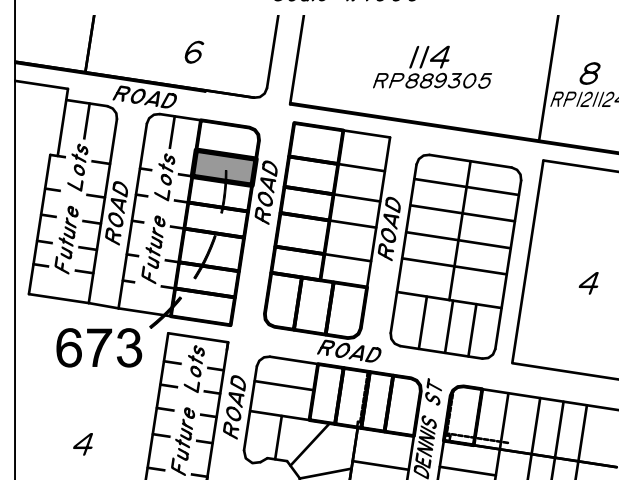

(These notes are an integral part of this plan)

This plan has been prepared for Waterlea Nominees Co. and ID Land for the purposes of A Disclosure Plan Under the Land Sales Act 1984 (as amended).
It is not to be used by any other person or corporation or for any other purposes and is subject to the following limitations:

Please refer to the approved Development Application for conditions relating to the LOT and to approved Operational Works drawings for services location and possible easements.

THESE DESIGNS AND DRAWINGS ARE COPYRIGHT
AND ARE NOT TO BE USED OR REPRODUCED
WITHOUT THE WRITTEN PERMISSION OF VERIS

Cadastral Boundaries
401364-LC01-(T).dwg
Engineering Design
21-000113.02-2230 Stage Retaining Wall
Setout.dwg
Final Surface Contours
20221201 Waterloo Stage 6B2 6B3 Design Conts.dwg
Depth of Fill
20221201 Waterloo Stage 6B2 6B3 Depth Conts.dwg

D	Wall added Lot 673	31.07.2023	DMC
C	Engineering updated	16.12.2022	BK
B	Add Lots 626-630, Amd Eng Name Widen Lot 678	21.03.2022	GJF
A	Original	10.03.2022	GJF
Issue	Revisions	Date	Draw

Locality: WALLOON
 Local Authority: Ipswich City Council
 Horizontal Meridian: MGA Zone 56
 Vertical Level Datum: AHD
 Scale: 1:250 @ A4
 Designed: **
 Drawn: GJF 10/03/2022
 Checked: KJJ 15/03/2022
 Plot Date: 31 Jul, 2023
 Comp File Ref: 401364-Stg6-B2-DP01(D).dwg

DISCLOSURE PLAN
of Proposed LOT 673
currently being part of
Lot 1 on SP331771.

**veris**

BRISBANE (07) 3666 4700
MACKAY (07) 4957 9700
WHITSUNDAYS (07) 4945 6600
CAIRNS (07) 4252 9400

veris.com.au
ACN 615 735 727
Veris Australia Pty Ltd

Drawing No	Issue
401364-06-DP-673	D

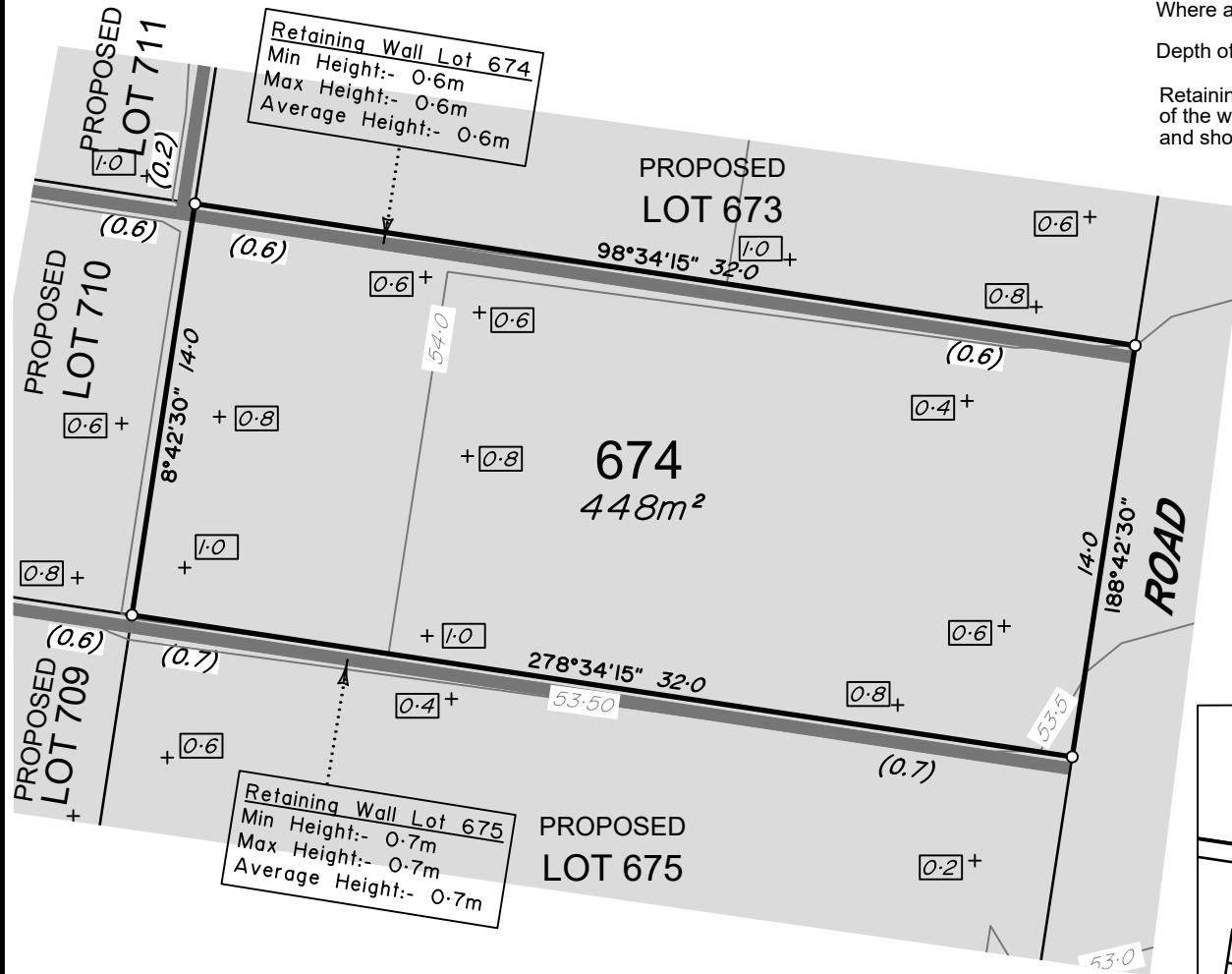

LEGEND

Final surface contours based on A.H.D. datum at an interval of 0.25m, shown as: $\text{---} 15.5 \text{---}$

Where applicable, areas to be filled are shown as:

Depth of fill, in metres, shown as: $+ 1.1$

Retaining wall and retaining wall height, shown on the lower side of the wall, have been taken from plans supplied by Calibre Group and shown as: $\text{---} (1.2) \text{---}$

ADDITIONAL NOTES:

The LOT dimensions and area shown hereon are subject to final field survey and also to the requirements of Council and any other authority which may have requirements under any relevant legislation

Final surface contours shown hereon have been supplied by Calibre Group.

Compaction of any fill material placed on this site shall be completed to level one inspection and testing services in accordance with AS3798-2007.

Copyright ©Veris Australia Pty Ltd 16/12/2022.

LOCALITY DIAGRAM

Scale 1:4000

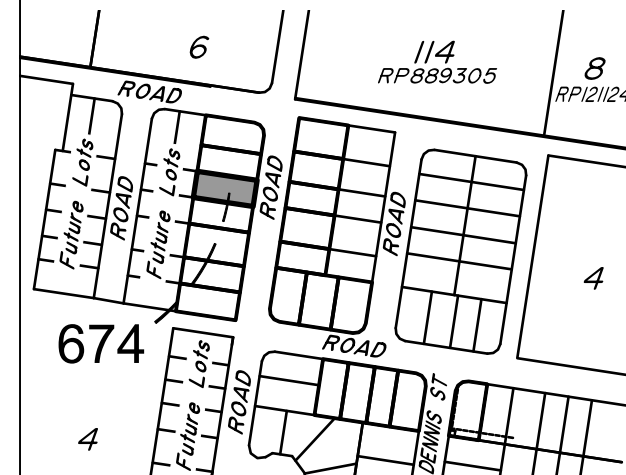

dawn.
WALLOON

WATERLEA STAGE 6B2

For

Waterlea Nominees Co.

IMPORTANT NOTES:

(These notes are an integral part of this plan)

This plan has been prepared for Waterlea Nominees Co. and ID Land for the purposes of a Disclosure Plan Under the Land Sales Act 1984 (as amended).

It is not to be used by any other person or corporation or for any other purposes and is subject to the following limitations:

Please refer to the approved Development Application for conditions relating to the LOT and to approved Operational Works drawings for services location and possible easements.

THESE DESIGNS AND DRAWINGS ARE COPYRIGHT AND ARE NOT TO BE USED OR REPRODUCED WITHOUT THE WRITTEN PERMISSION OF VERIS

Data Sources

Cadastral Boundaries
401364-L001(1).dwg
Engineering Design
21-000113.02-2230 Stage Retaining Wall
Setout.dwg
Final Surface Contours
20221201 Waterlea Stage 6B2 6B3 Design Conts.dwg
Depth of Fill
20221201 Waterlea Stage 6B2 6B3 Depth Conts.dwg

Issue	Revisions	Date	Drawn
C	Engineering updated	16.12.2022	BK
B	Add Lots 626-630, Amd Eng Name Widen Lot 678	21.03.2022	GJF
A	Original	10.03.2022	GJF

Locality:
Local Authority: Ipswich City Council
Horizontal Meridian: MGA Zone 56
Vertical Level Datum: AHD
Scale: 1:250 @ A4
Designed: **
Drawn: GJF 10/03/2022
Checked: KJJ 15/03/2022
Plot Date: 01 Feb, 2023
Comp File Ref: 401364-Stg6-B2-DP01(C).dwg

DISCLOSURE PLAN
of Proposed LOT 674
currently being part of
Lot 1 on SP331771.



veris

BRISBANE WHITSUNDAYS
(07) 3686 4700 (07) 4945 6600

MACKAY CAIRNS
(07) 4957 9700 (07) 4252 9400

veris.com.au
ACN 615 735 727
Veris Australia Pty Ltd

Drawing No Issue
401364-06-DP-674 C

0 12.5m 50 mm 25m 100 mm 37.5m 150 mm SCALE BAR

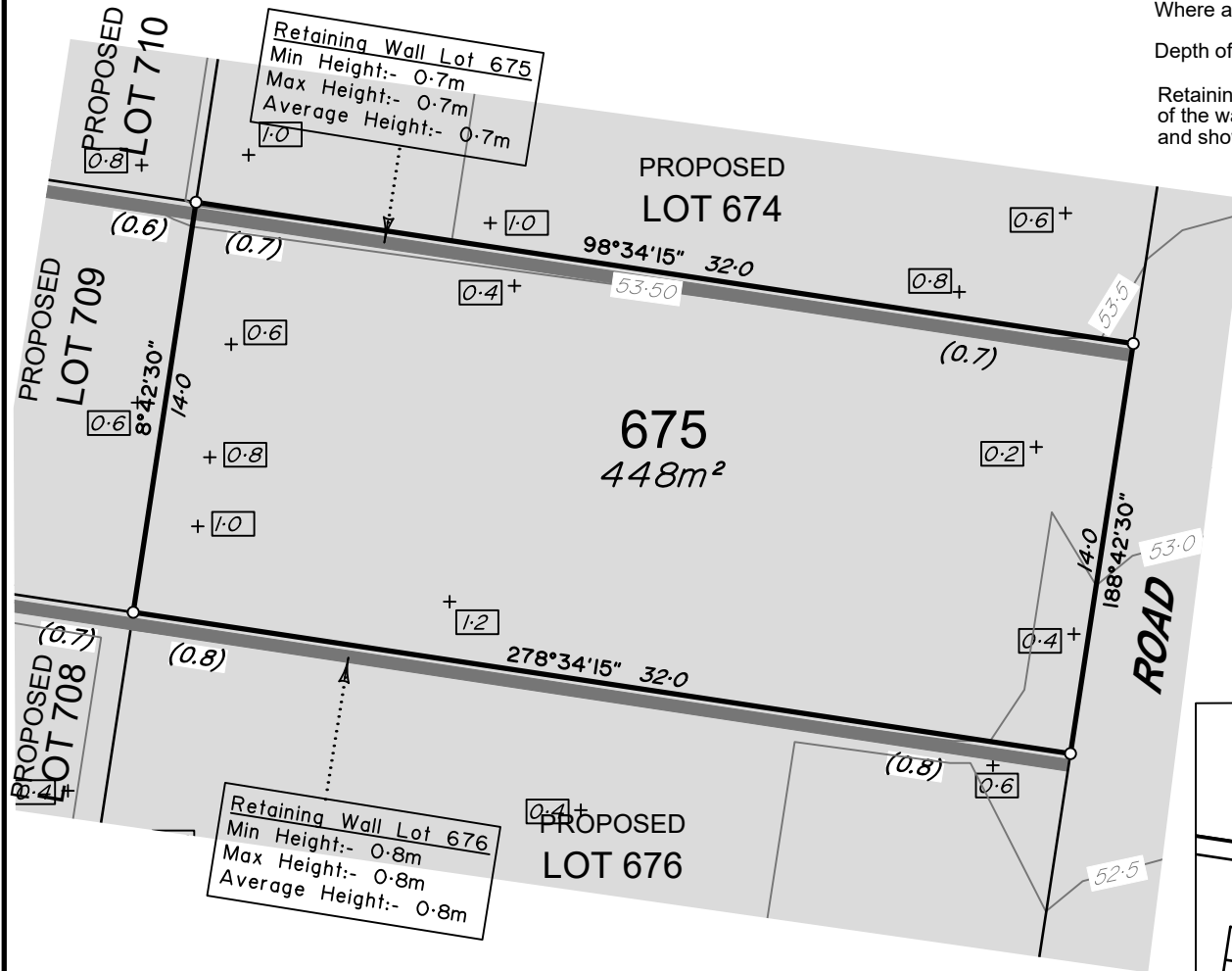

LEGEND

Final surface contours based on A.H.D. datum at an interval of 0.25m, shown as: — 15.5 —

Where applicable, areas to be filled are shown as:

Depth of fill, in metres, shown as: + 1.1

Retaining wall and retaining wall height, shown on the lower side of the wall, have been taken from plans supplied by Calibre Group and shown as:

ADDITIONAL NOTES:

The LOT dimensions and area shown hereon are subject to final field survey and also to the requirements of Council and any other authority which may have requirements under any relevant legislation

Final surface contours shown hereon have been supplied by Calibre Group.

Compaction of any fill material placed on this site shall be completed to level one inspection and testing services in accordance with AS3798-2007.

Copyright ©Veris Australia Pty Ltd 16/12/2022.

LOCALITY DIAGRAM

Scale 1:4000

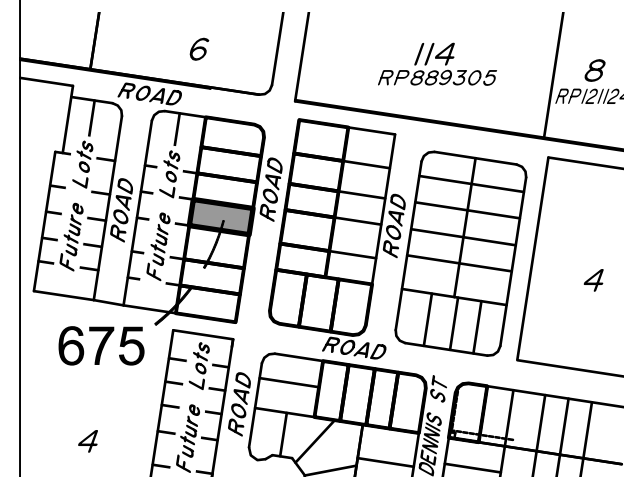

dawn.
WALLOON

WATERLEA STAGE 6B2
For

Waterlea Nominees Co.

IMPORTANT NOTES:

(These notes are an integral part of this plan)
This plan has been prepared for Waterlea Nominees Co. and ID Land for the purposes of a Disclosure Plan Under the Land Sales Act 1984 (as amended).
It is not to be used by any other person or corporation or for any other purposes and is subject to the following limitations:

Please refer to the approved Development Application for conditions relating to the LOT and to approved Operational Works drawings for services location and possible easements.

THESE DESIGNS AND DRAWINGS ARE COPYRIGHT AND ARE NOT TO BE USED OR REPRODUCED WITHOUT THE WRITTEN PERMISSION OF VERIS

Data Sources

Cadastral Boundaries
401364-LC01-11.dwg
Engineering Design
21-000113-02-2230 Stage Retaining Wall Setout.dwg
Final Surface Contours
20221201 Waterlea Stage 6B2 6B3 Design Conts.dwg
Depth of Fill
20221201 Waterlea Stage 6B2 6B3 Depth Conts.dwg

C	Engineering updated	16.12.2022	BK
B	Add Lots 626-630, Amd Eng Name Widen Lot 678	21.03.2022	GJF
A	Original	10.03.2022	GJF
Issue	Revisions	Date	Drawn

Locality:
Local Authority: Ipswich City Council
Horizontal Meridian: MGA Zone 56
Vertical Level Datum: AHD
Scale: 1:250 @ A4
Designed:
Drawn: GJF 10/03/2022
Checked: KJJ 15/03/2022
Plot Date: 01 Feb, 2023
Comp File Ref: 401364-Stg6-B2-DP01(C).dwg

DISCLOSURE PLAN
of Proposed LOT 675
currently being part of
Lot 1 on SP331771.



veris

BRISBANE WHITSUNDAYS
(07) 3686 4700 (07) 4945 6600

MACKAY CAIRNS
(07) 4957 9700 (07) 4252 9400

veris.com.au
ACN 615 735 727
Veris Australia Pty Ltd

Drawing No Issue
401364-06-DP-675 C

0 12.5m 50 mm 25m 100 mm 37.5m 150 mm SCALE BAR

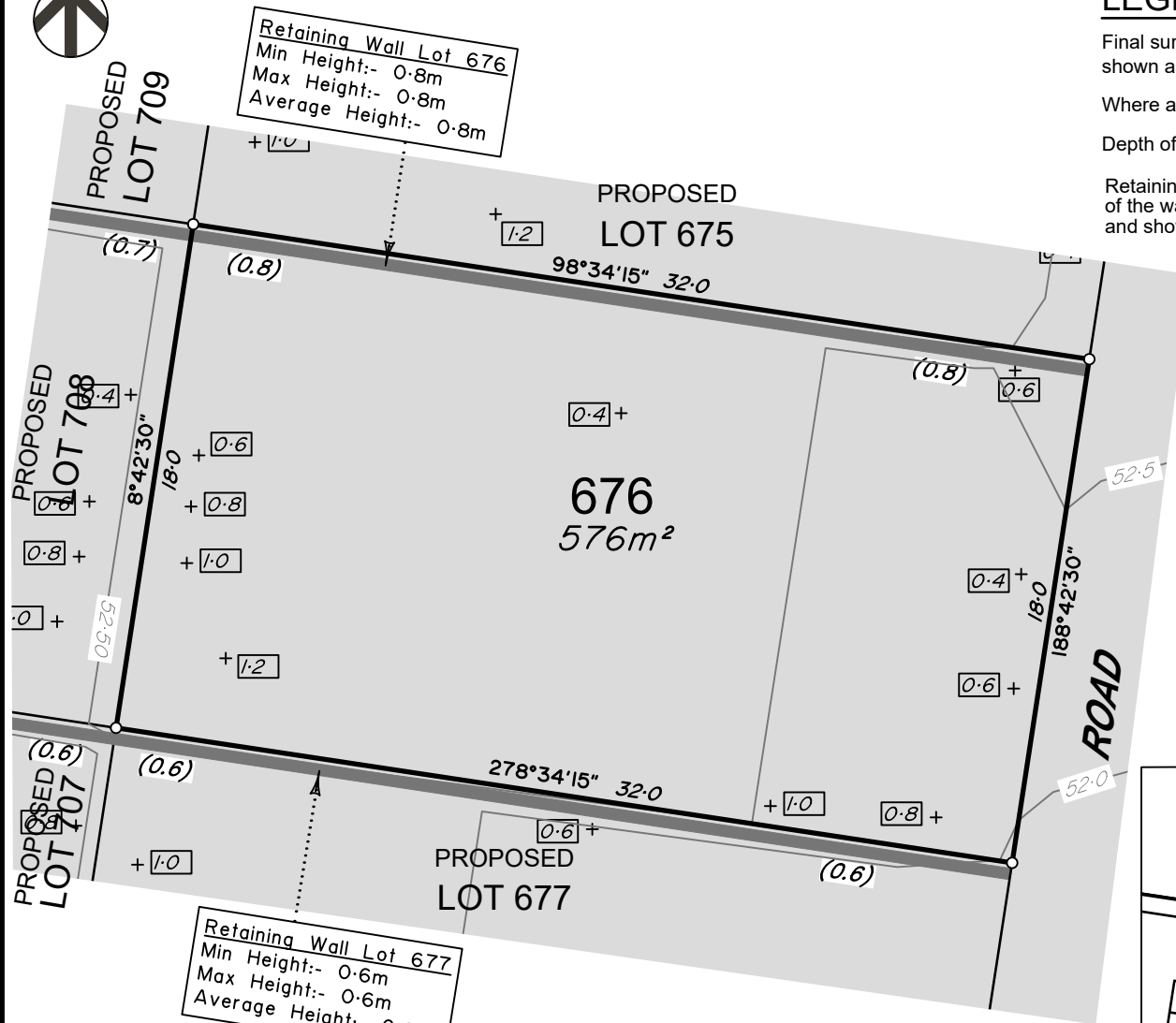

LEGEND

Final surface contours based on A.H.D. datum at an interval of 0.25m, shown as: — 15.5 —

Where applicable, areas to be filled are shown as: 

Depth of fill, in metres, shown as: + 1.1

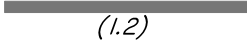
Retaining wall and retaining wall height, shown on the lower side of the wall, have been taken from plans supplied by Calibre Group and shown as: 

ADDITIONAL NOTES:

The LOT dimensions and area shown hereon are subject to final field survey and also to the requirements of Council and any other authority which may have requirements under any relevant legislation

Final surface contours shown hereon have been supplied by Calibre Group.

Compaction of any fill material placed on this site shall be completed to level one inspection and testing services in accordance with AS3798-2007.

Copyright ©Veris Australia Pty Ltd 16/12/2022.

LOCALITY DIAGRAM

Scale 1:4000

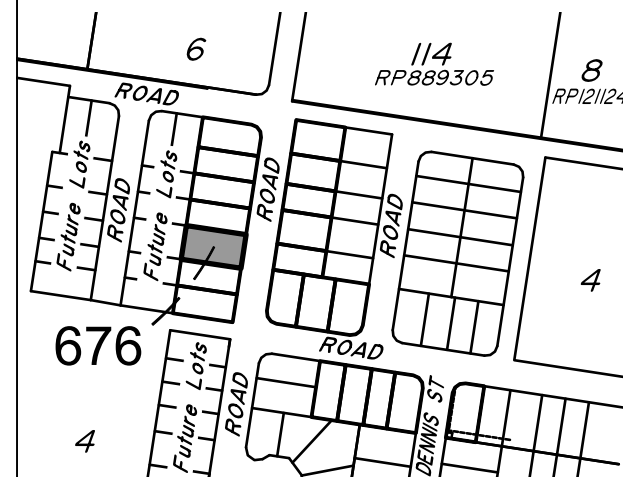

dawn.
WALLOON

WATERLEA STAGE 6B2

For

Waterlea Nominees Co.

IMPORTANT NOTES:

(These notes are an integral part of this plan)

This plan has been prepared for Waterlea Nominees Co. and ID Land for the purposes of A Disclosure Plan Under the Land Sales Act 1984 (as amended).

It is not to be used by any other person or corporation or for any other purposes and is subject to the following limitations:

Please refer to the approved Development Application for conditions relating to the LOT and to approved Operational Works drawings for services location and possible easements.

THESE DESIGNS AND DRAWINGS ARE COPYRIGHT AND ARE NOT TO BE USED OR REPRODUCED WITHOUT THE WRITTEN PERMISSION OF VERIS

Data Sources

Cadastral Boundaries
401364-LC01(T)1.dwg
Engineering Design
21-000113.02-2230 Stage Retaining Wall
Setout.dwg
Final Surface Contours
20221201 Waterlea Stage 6B2 6B3 Design Conts.dwg
Depth of Fill
20221201 Waterlea Stage 6B2 6B3 Depth Conts.dwg

Issue	Revisions	Date	Drawn
C	Engineering updated	16.12.2022	BK
B	Add Lots 626-630, Amd Eng Name Widen Lot 676	21.03.2022	GJF
A	Original	10.03.2022	GJF

Locality: WALLOON
Local Authority: Ipswich City Council
Horizontal Meridian: MGA Zone 56
Vertical Level Datum: AHD
Scale: 1:250 @ A4
Designed: **
Drawn: GJF 10/03/2022
Checked: KJJ 15/03/2022
Plot Date: 01 Feb, 2023
Comp File Ref: 401364-Stg6-B2-DP01(C).dwg

DISCLOSURE PLAN
of Proposed LOT 676
currently being part of
Lot 1 on SP331771.



veris

BRISBANE WHITSUNDAYS
(07) 3686 4700 (07) 4945 6600

MACKAY CAIRNS
(07) 4957 9700 (07) 4252 9400

veris.com.au
ACN 615 735 727
Veris Australia Pty Ltd

Drawing No Issue
401364-06-DP-676 C

0 12.5m 50 mm 25m 100 mm 37.5m 150 mm SCALE BAR

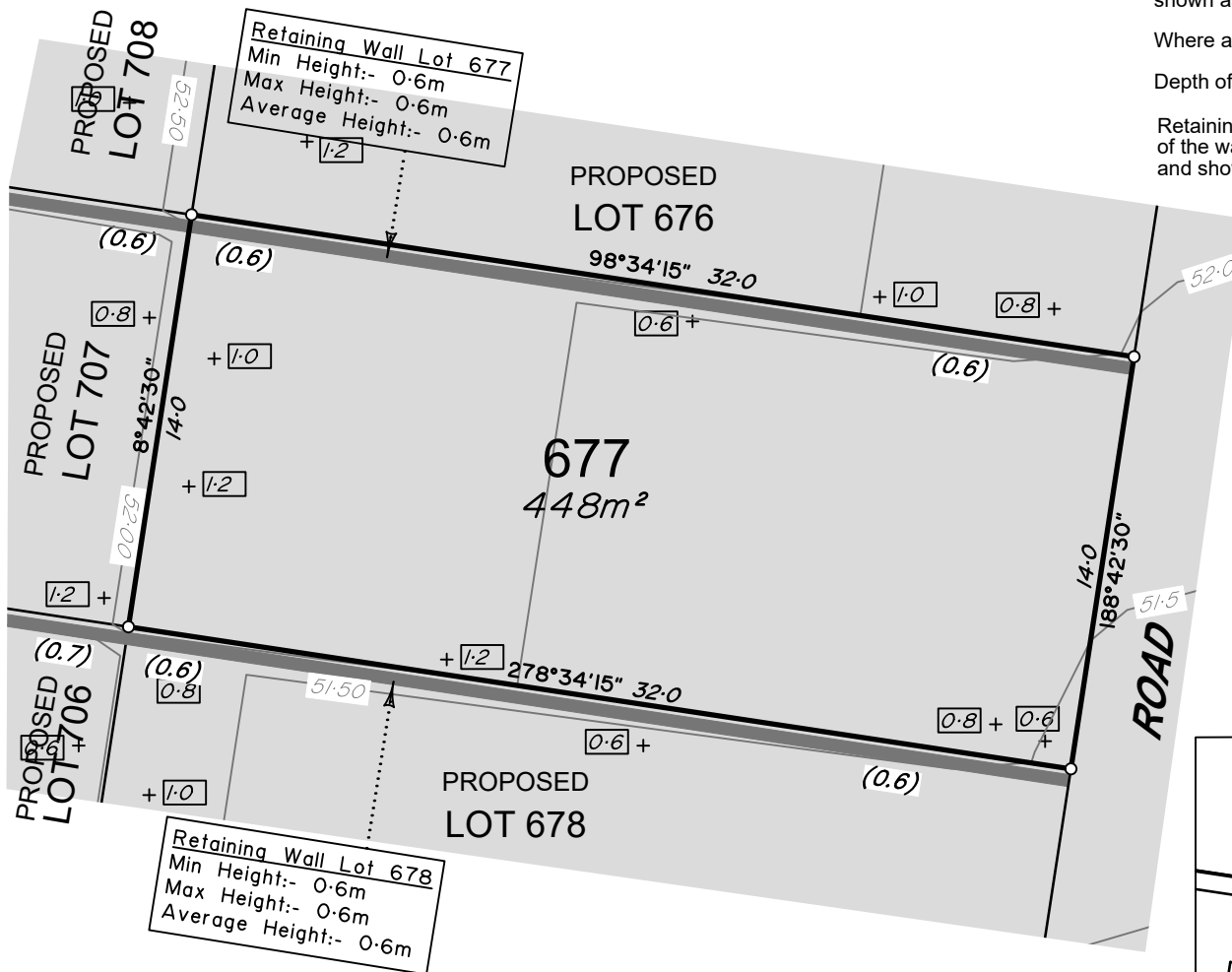

LEGEND

Final surface contours based on A.H.D. datum at an interval of 0.25m, shown as: — 15.5 —

Where applicable, areas to be filled are shown as:

Depth of fill, in metres, shown as: + 1.1

Retaining wall and retaining wall height, shown on the lower side of the wall, have been taken from plans supplied by Calibre Group and shown as: (1.2)

ADDITIONAL NOTES:

The LOT dimensions and area shown hereon are subject to final field survey and also to the requirements of Council and any other authority which may have requirements under any relevant legislation

Final surface contours shown hereon have been supplied by Calibre Group.

Compaction of any fill material placed on this site shall be completed to level one inspection and testing services in accordance with AS3798-2007.

Copyright ©Veris Australia Pty Ltd 16/12/2022.

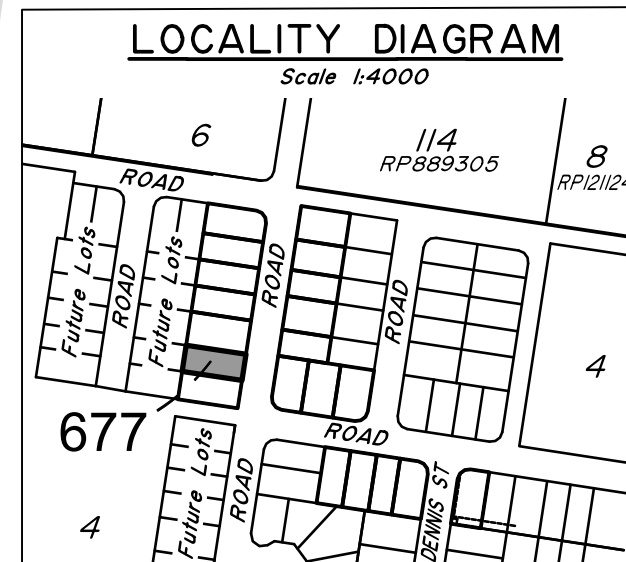

dawn.
WALLOON

WATERLEA STAGE 6B2

For

Waterlea Nominees Co.

IMPORTANT NOTES:

(These notes are an integral part of this plan)
This plan has been prepared for Waterlea Nominees Co. and ID Land for the purposes of a Disclosure Plan Under the Land Sales Act 1984 (as amended).
It is not to be used by any other person or corporation or for any other purposes and is subject to the following limitations:

Please refer to the approved Development Application for conditions relating to the LOT and to approved Operational Works drawings for services location and possible easements.

THESE DESIGNS AND DRAWINGS ARE COPYRIGHT AND ARE NOT TO BE USED OR REPRODUCED WITHOUT THE WRITTEN PERMISSION OF VERIS

Data Sources

Cadastral Boundaries
401364-LC01(T) dwg
Engineering Design
21-000113.02-2230 Stage Retaining Wall Setout.dwg
Final Surface Contours
20221201 Waterlea Stage 6B2 6B3 Design Conts.dwg
Depth of Fill
20221201 Waterlea Stage 6B2 6B3 Depth Conts.dwg

Issue	Revisions	Date	Drawn
C	Engineering updated	16.12.2022	BK
B	Add Lots 626-630, Amd Eng Name Widen Lot 678	21.03.2022	GJF
A	Original	10.03.2022	GJF

Locality: WALLOON
Local Authority: Ipswich City Council
Horizontal Meridian: MGA Zone 56
Vertical Level Datum: AHD
Scale: 1:250 @ A4
Designed: **
Drawn: GJF 10/03/2022
Checked: KJJ 15/03/2022
Plot Date: 01 Feb, 2023
Comp File Ref: 401364-Stg6-B2-DP01(C).dwg

DISCLOSURE PLAN
of Proposed LOT 677
currently being part of
Lot 1 on SP331771.



veris

BRISBANE WHITSUNDAYS
(07) 3686 4700 (07) 4945 6600

MACKAY CAIRNS
(07) 4957 9700 (07) 4252 9400

veris.com.au
ACN 615 735 727
Veris Australia Pty Ltd

Drawing No Issue
401364-06-DP-677 C

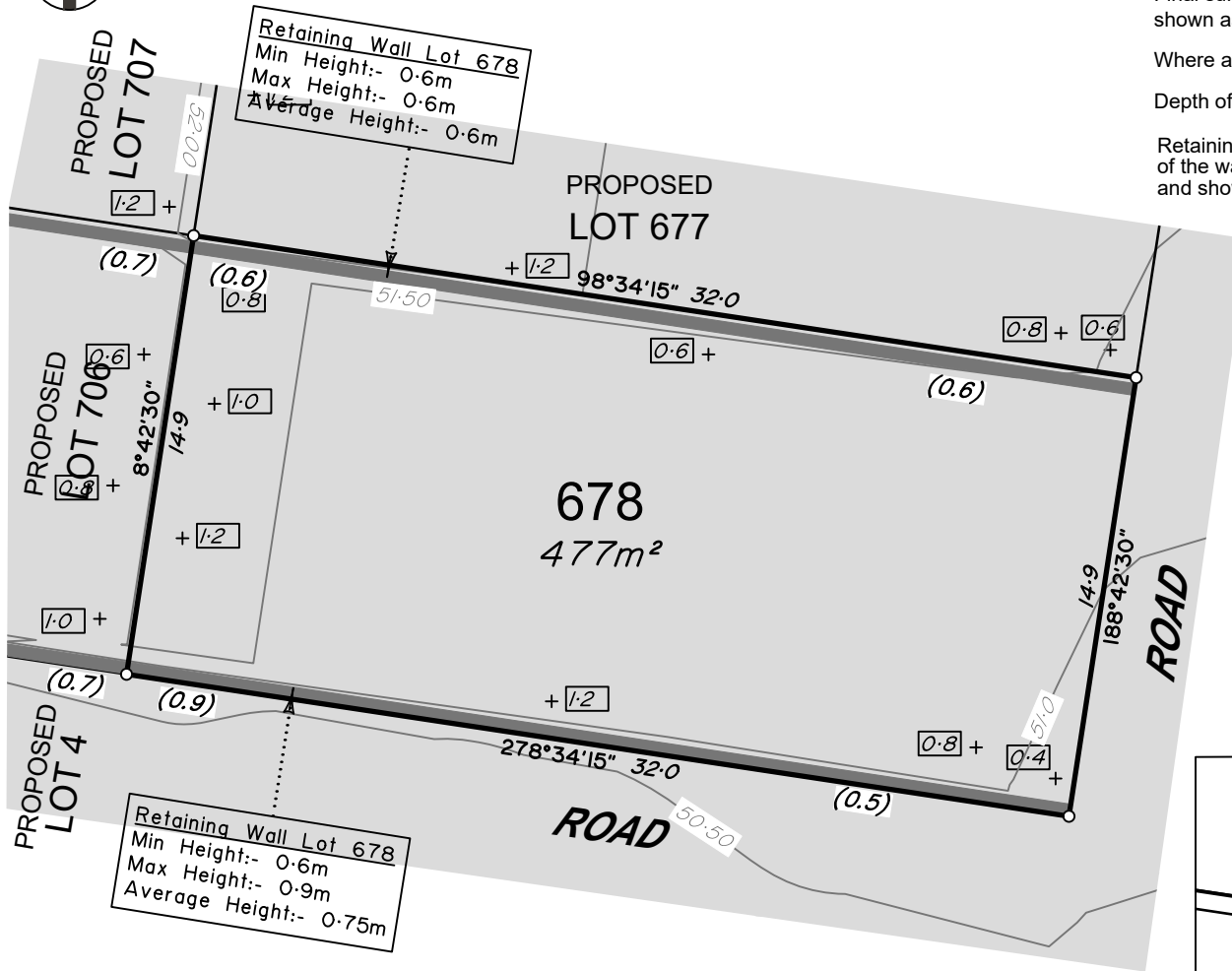

LEGEND

Final surface contours based on A.H.D. datum at an interval of 0.25m, shown as: — 15.5 —

Where applicable, areas to be filled are shown as:

Depth of fill, in metres, shown as: + 1.1

Retaining wall and retaining wall height, shown on the lower side of the wall, have been taken from plans supplied by Calibre Group and shown as: (1.2)

ADDITIONAL NOTES:

The LOT dimensions and area shown hereon are subject to final field survey and also to the requirements of Council and any other authority which may have requirements under any relevant legislation

Final surface contours shown hereon have been supplied by Calibre Group.

Compaction of any fill material placed on this site shall be completed to level one inspection and testing services in accordance with AS3798-2007.

Copyright ©Veris Australia Pty Ltd 16/12/2022.

LOCALITY DIAGRAM

Scale 1:4000

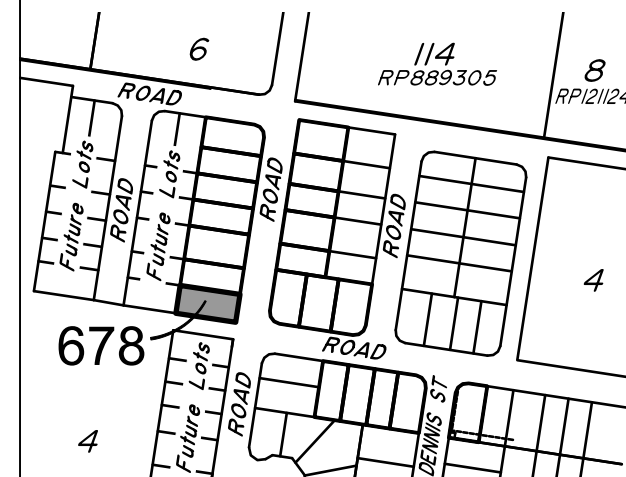

dawn.
WALLOON

WATERLEA STAGE 6B2

For

Waterlea Nominees Co.

IMPORTANT NOTES:

(These notes are an integral part of this plan)
This plan has been prepared for Waterlea Nominees Co. and ID Land for the purposes of a Disclosure Plan Under the Land Sales Act 1984 (as amended).
It is not to be used by any other person or corporation or for any other purposes and is subject to the following limitations:

Please refer to the approved Development Application for conditions relating to the LOT and to approved Operational Works drawings for services location and possible easements.

THESE DESIGNS AND DRAWINGS ARE COPYRIGHT AND ARE NOT TO BE USED OR REPRODUCED WITHOUT THE WRITTEN PERMISSION OF VERIS

Data Sources

Cadastral Boundaries
401364-L001(T) dwg
Engineering Design
21-000113.02-2230 Stage Retaining Wall
Setout.dwg
Final Surface Contours
20221201 Waterlea Stage 6B2 6B3 Design Conts.dwg
Depth of Fill
20221201 Waterlea Stage 6B2 6B3 Depth Conts.dwg

Issue	Revisions	Date	Drawn
C	Engineering updated	16.12.2022	BK
B	Add Lots 626-630, Amd Eng Name Widen Lot 678	21.03.2022	GJF
A	Original	10.03.2022	GJF

Locality: WALLOON
Local Authority: Ipswich City Council
Horizontal Meridian: MGA Zone 56
Vertical Level Datum: AHD
Scale: 1:250 @ A4
Designed: **
Drawn: GJF 10/03/2022
Checked: KJJ 15/03/2022
Plot Date: 01 Feb, 2023
Comp File Ref: 401364-Stg6-B2-DP01(C).dwg

DISCLOSURE PLAN
of Proposed LOT 678
currently being part of
Lot 1 on SP331771.



veris

BRISBANE WHITSUNDAYS
(07) 3686 4700 (07) 4945 6600

MACKAY CAIRNS
(07) 4957 9700 (07) 4252 9400

veris.com.au
ACN 615 735 727
Veris Australia Pty Ltd

Drawing No Issue
401364-06-DP-678 C

0 12.5m 50 mm 25m 100 mm 37.5m 150 mm SCALE BAR