

LEGEND

Final surface contours based on A.H.D. datum at an interval of 0.25m, shown as: 15.5

Where applicable, areas to be filled are shown as:

Depth of fill, in metres, shown as:- +[L1]

Retaining wall and retaining wall height, shown on the lower side of the wall, have been taken from plans supplied by Calibre Group and shown as: (1.2)

ADDITIONAL NOTES:

The LOT dimensions and area shown hereon are subject to final field survey and also to the requirements of Council and any other authority which may have requirements under any relevant legislation

Final surface contours shown hereon have been supplied by Calibre Group.

Compaction of any fill material placed on this site shall be completed to level one inspection and testing services in accordance with AS3798-2007.

Copyright © Veris Australia Pty Ltd 15/03/2022.

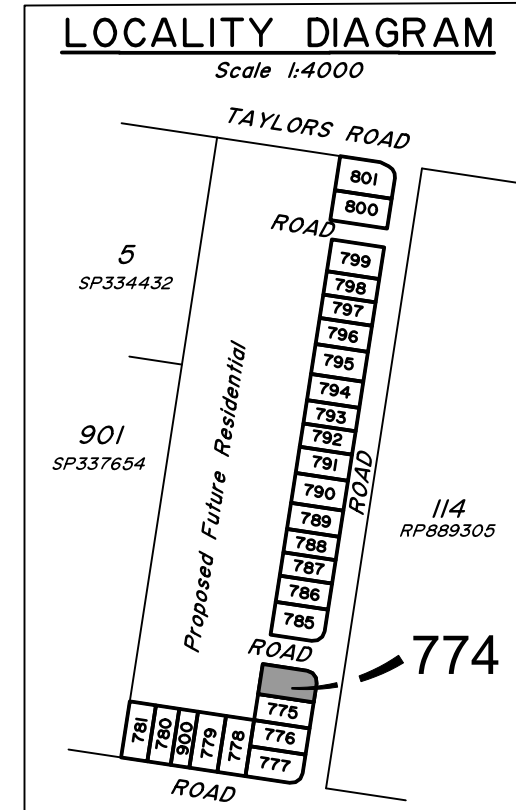

dawn.
 WALLOON

Gibbs STAGE 1
 For
 ID_Land

IMPORTANT NOTES:
 (These notes are an integral part of this plan)
 This plan has been prepared for ID_Land for the purposes of A Disclosure Plan Under the Land Sales Act 1984 (as amended). It is not to be used by any other person or corporation or for any other purposes and is subject to the following limitations:

Please refer to the approved Development Application for conditions relating to the LOT and to approved Operational Works drawings for services location and possible easements.

THESE DESIGNS AND DRAWINGS ARE COPYRIGHT AND ARE NOT TO BE USED OR REPRODUCED WITHOUT THE WRITTEN PERMISSION OF VERIS

Data Sources
 Cadastral Boundaries 401905-LC01-W.dwg
 Retaining Walls Gibbs Stg-1 RT WALLS.dwg
 Final Surface Contours Gibbs Stg-1 DESN SURFACE.dwg
 Depth of Fill Gibbs Stg-1 FILL DEPTH CONT.dwg
 Gibbs Stg-1 CUT FILL.dwg

Issue	Revisions	Date	Drawn
B	Amend adjpiners	05.05.2023	DMC
A	Original	24.03.2023	GJF

Locality: WALLOON
 Local Authority: Ipswich City Council
 Horizontal Meridian: MGA Zone 56
 Vertical Level Datum: AHD
 Scale: 1:250 @ A4
 Designed: *
 Drawn: GJF 24/03/2023
 Checked: DMC
 Plot Date: 09 May, 2023
 Comp File Ref: 401905-01-DP01(B).dwg

DISCLOSURE PLAN
 of Proposed LOT 774
 currently being part of
 Lot 6 on RP121124



veris

BRISBANE (07) 3686 4700 WHITSUNDAYS (07) 4945 6600

MACKAY (07) 4957 9700 CAIRNS (07) 4252 9400

veris.com.au
 ACN 615 735 727
 Veris Australia Pty Ltd

Drawing No Issue
 401905-01-DP-774 B



LEGEND

Final surface contours based on A.H.D. datum at an interval of 0.25m, shown as: $\text{---} / 5.5 \text{---}$

Where applicable, areas to be filled are shown as:

Depth of fill, in metres, shown as:- $\text{+} [L]$

Retaining wall and retaining wall height, shown on the lower side of the wall, have been taken from plans supplied by Calibre Group and shown as:

$\text{---} (1.2) \text{---}$

ADDITIONAL NOTES:

The LOT dimensions and area shown hereon are subject to final field survey and also to the requirements of Council and any other authority which may have requirements under any relevant legislation

Final surface contours shown hereon have been supplied by Calibre Group.

Compaction of any fill material placed on this site shall be completed to level one inspection and testing services in accordance with AS3798-2007.

Copyright © Veris Australia Pty Ltd 15/03/2022.

LOCALITY DIAGRAM

Scale 1:4000

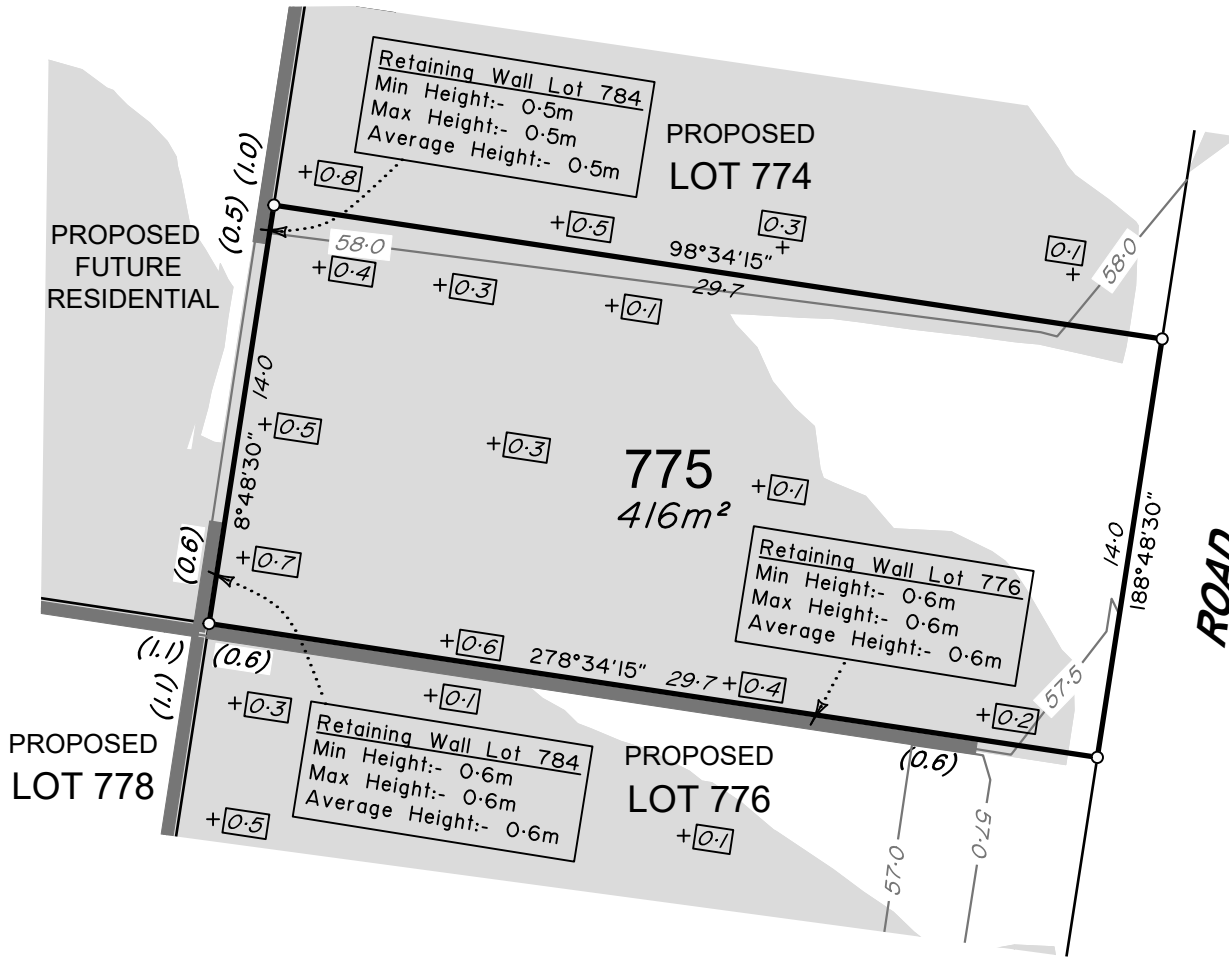
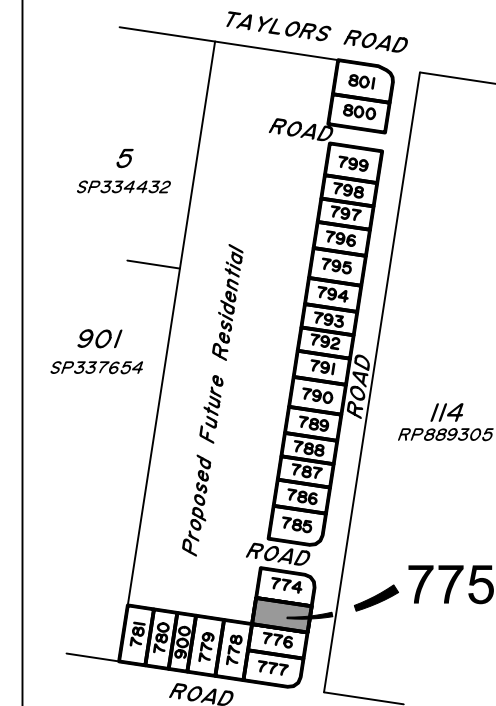

Gibbs STAGE 1
For
ID_Land

IMPORTANT NOTES:
(These notes are an integral part of this plan)
This plan has been prepared for ID_Land for the purposes of A Disclosure Plan Under the Land Sales Act 1984 (as amended). It is not to be used by any other person or corporation or for any other purposes and is subject to the following limitations:

Please refer to the approved Development Application for conditions relating to the LOT and to approved Operational Works drawings for services location and possible easements.

THESE DESIGNS AND DRAWINGS ARE COPYRIGHT AND ARE NOT TO BE USED OR REPRODUCED WITHOUT THE WRITTEN PERMISSION OF VERIS

Data Sources

Cadastral Boundaries
401905-LC01-W.dwg
Retaining Walls
Gibbs Stg-1 RT WALLS.dwg
Final Surface Contours
Gibbs Stg-1 DESN SURFACE.dwg
Depth of Fill
Gibbs Stg-1 FILL DEPTH CONT.dwg
Gibbs Stg-1 CUT FILL.dwg

Issue	Revisions	Date	Drawn
B	Amend adjpiners	05.05.2023	DMC
A	Original	24.03.2023	GJF

Locality: WALLOON
Local Authority: Ipswich City Council
Horizontal Meridian: MGA Zone 56
Vertical Level Datum: AHD
Scale: 1:250 @ A4
Designed: *
Drawn: GJF 24/03/2023
Checked: DMC
Plot Date: 09 May, 2023
Comp File Ref: 401905-01-DP01(B).dwg

DISCLOSURE PLAN
of Proposed LOT 775
currently being part of
Lot 6 on RP121124



BRISBANE (07) 3686 4700 WHITSUNDAYS (07) 4945 6600
MACKAY (07) 4957 9700 CAIRNS (07) 4252 9400
veris.com.au
ACN 615 735 727
Veris Australia Pty Ltd

Drawing No 401905-01-DP-775 Issue B





LEGEND

Final surface contours based on A.H.D. datum at an interval of 0.25m, shown as: $\text{---} / 5.5 \text{---}$

Where applicable, areas to be filled are shown as:

Depth of fill, in metres, shown as:- $+ [L]$

Retaining wall and retaining wall height, shown on the lower side of the wall, have been taken from plans supplied by Calibre Group and shown as: $\text{---} / (1.2) \text{---}$

ADDITIONAL NOTES:

The LOT dimensions and area shown hereon are subject to final field survey and also to the requirements of Council and any other authority which may have requirements under any relevant legislation

Final surface contours shown hereon have been supplied by Calibre Group.

Compaction of any fill material placed on this site shall be completed to level one inspection and testing services in accordance with AS3798-2007.

Copyright © Veris Australia Pty Ltd 15/03/2022.

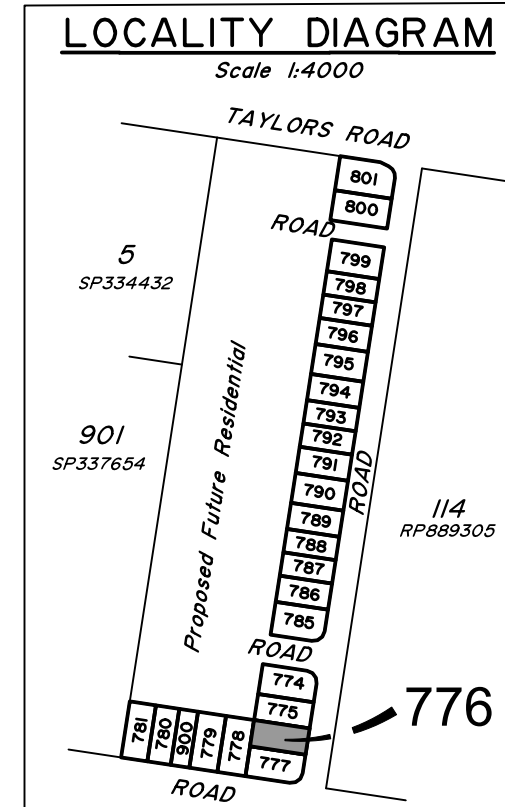
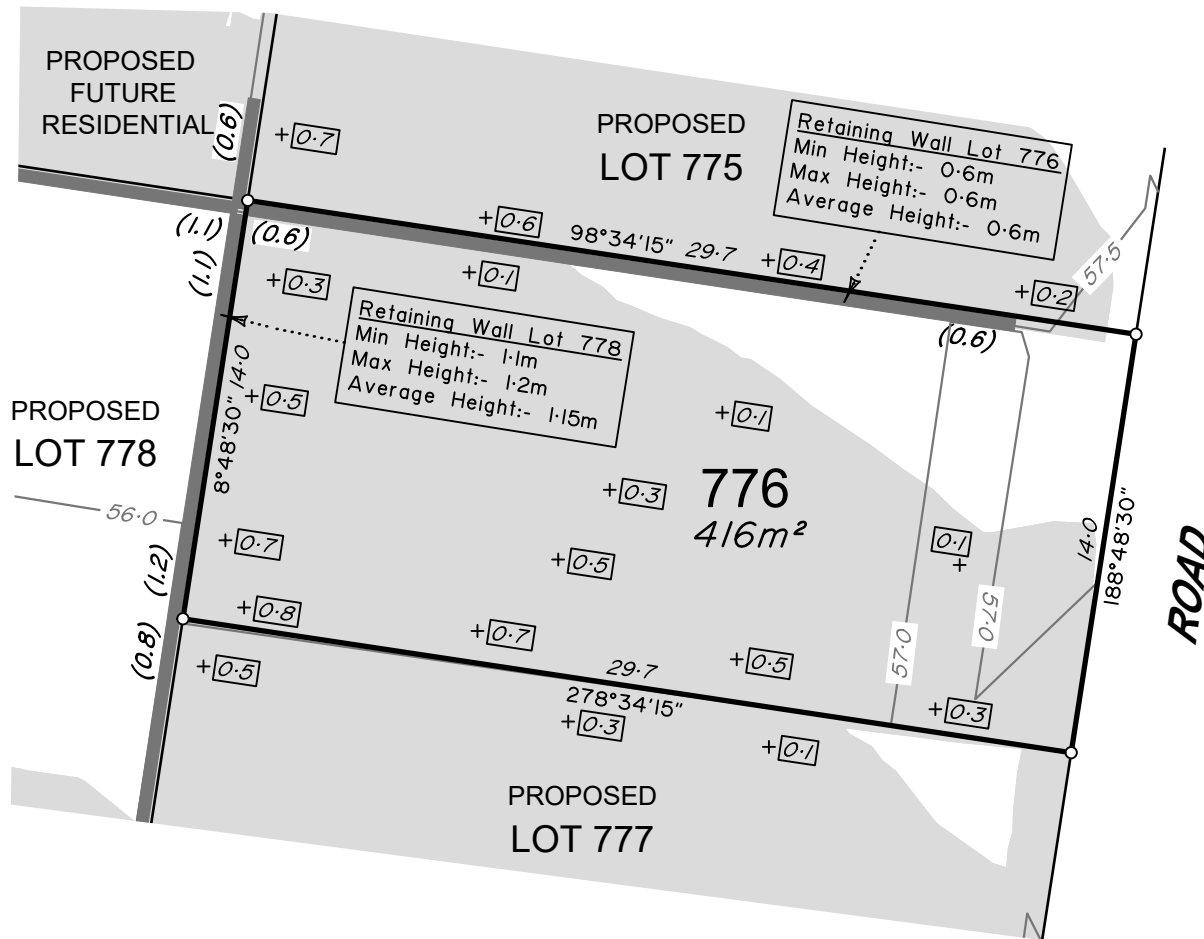

dawn.
WALLOON

Gibbs STAGE 1
For
ID_Land

IMPORTANT NOTES:
(These notes are an integral part of this plan)
This plan has been prepared for ID_Land for the purposes of A Disclosure Plan Under the Land Sales Act 1984 (as amended). It is not to be used by any other person or corporation or for any other purposes and is subject to the following limitations:

Please refer to the approved Development Application for conditions relating to the LOT and to approved Operational Works drawings for services location and possible easements.

THESE DESIGNS AND DRAWINGS ARE COPYRIGHT AND ARE NOT TO BE USED OR REPRODUCED WITHOUT THE WRITTEN PERMISSION OF VERIS

Data Sources
Cadastral Boundaries
401905-LC01-WJ.dwg
Retaining Walls
Gibbs Stg-1 RT WALLS.dwg
Final Surface Contours
Gibbs Stg-1 DESN SURFACE.dwg
Depth of Fill
Gibbs Stg-1 FILL DEPTH CONT.dwg
Gibbs Stg-1 CUT FILL.dwg

Issue	Revisions	Date	Drawn
B	Amend adjpiners	8.05.2023	DMC
A	Original	24.03.2023	GJF

Locality: WALLOON
Local Authority: Ipswich City Council
Horizontal Meridian: MGA Zone 56
Vertical Level Datum: AHD
Scale: 1:250 @ A4
Designed: *
Drawn: GJF 24/03/2023
Checked: DMC
Plot Date: 09 May, 2023
Comp File Ref: 401905-01-DP01(B).dwg

DISCLOSURE PLAN
of Proposed LOT 776
currently being part of
Lot 6 on RP121124



veris

BRISBANE (07) 3686 4700 WHITSUNDAYS (07) 4945 6600
MACKAY (07) 4957 9700 CAIRNS (07) 4252 9400
veris.com.au
ACN 615 735 727
Veris Australia Pty Ltd

Drawing No 401905-01-DP-776 Issue B

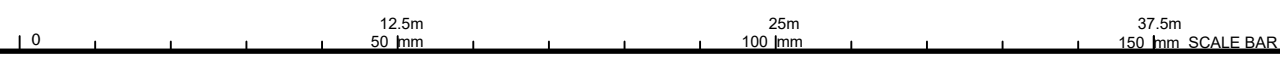



LEGEND

Final surface contours based on A.H.D. datum at an interval of 0.25m, shown as: $\text{---} 15.5 \text{---}$

Where applicable, areas to be filled are shown as:

Depth of fill, in metres, shown as:- $\text{+}[L1]$

Retaining wall and retaining wall height, shown on the lower side of the wall, have been taken from plans supplied by Calibre Group and shown as: $\text{---}(1.2)\text{---}$

ADDITIONAL NOTES:

The LOT dimensions and area shown hereon are subject to final field survey and also to the requirements of Council and any other authority which may have requirements under any relevant legislation

Final surface contours shown hereon have been supplied by Calibre Group.

Compaction of any fill material placed on this site shall be completed to level one inspection and testing services in accordance with AS3798-2007.

Copyright © Veris Australia Pty Ltd 15/03/2022.

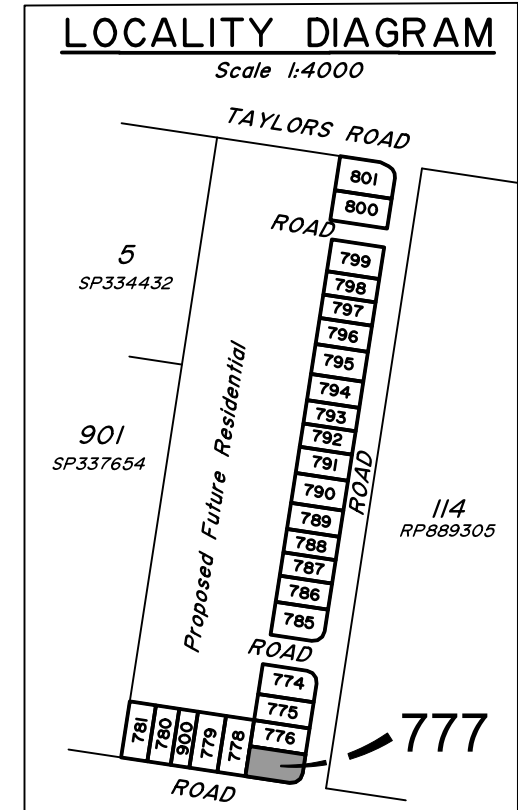
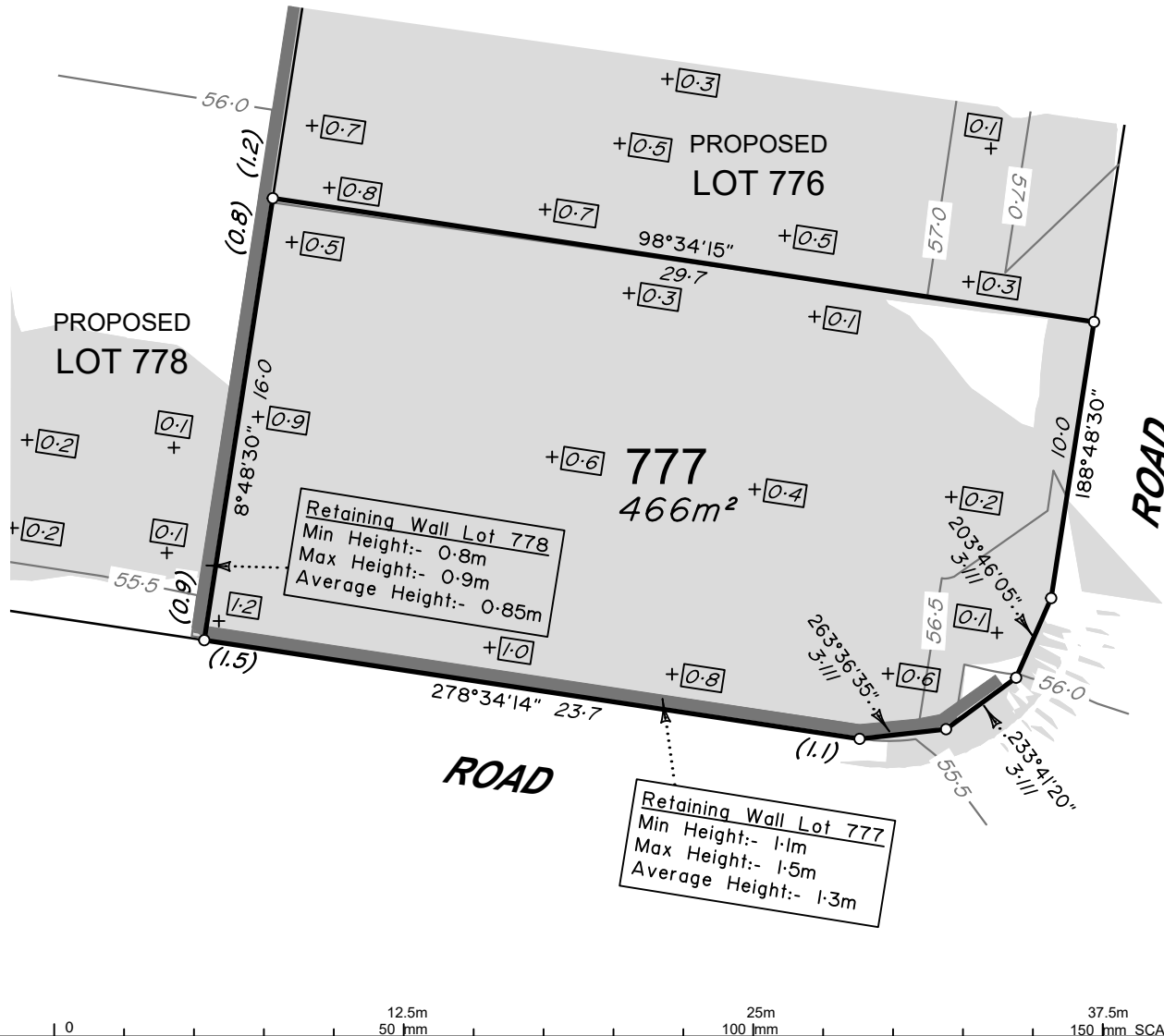

Gibbs STAGE 1
For
ID_Land

IMPORTANT NOTES:
(These notes are an integral part of this plan)
This plan has been prepared for ID_Land for the purposes of A Disclosure Plan Under the Land Sales Act 1984 (as amended). It is not to be used by any other person or corporation or for any other purposes and is subject to the following limitations:

Please refer to the approved Development Application for conditions relating to the LOT and to approved Operational Works drawings for services location and possible easements.

THESE DESIGNS AND DRAWINGS ARE COPYRIGHT AND ARE NOT TO BE USED OR REPRODUCED WITHOUT THE WRITTEN PERMISSION OF VERIS

Data Sources
Cadastral Boundaries 401905-LC01-W.dwg
Retaining Walls Gibbs Stg-1 RT WALLS.dwg
Final Surface Contours Gibbs Stg-1 DESN SURFACE.dwg
Depth of Fill Gibbs Stg-1 FILL DEPTH CONT.dwg
Gibbs Stg-1 CUT FILL.dwg

Issue	Revisions	Date	Drawn
B	Amend adjpiners	8.05.2023	DMC
A	Original	24.03.2023	GJF

Locality:
Local Authority: Ipswich City Council
Horizontal Meridian: MGA Zone 56
Vertical Level Datum: AHD
Scale: 1:250 @ A4
Designed: *
Drawn: GJF 24/03/2023
Checked: DMC
Plot Date: 09 May, 2023
Comp File Ref: 401905-01-DP01(B).dwg

DISCLOSURE PLAN
of Proposed LOT 777
currently being part of
Lot 6 on RP121124



BRISBANE (07) 3686 4700 WHITSUNDAYS (07) 4945 6600
MACKAY (07) 4957 9700 CAIRNS (07) 4252 9400
veris.com.au
ACN 615 735 727
Veris Australia Pty Ltd

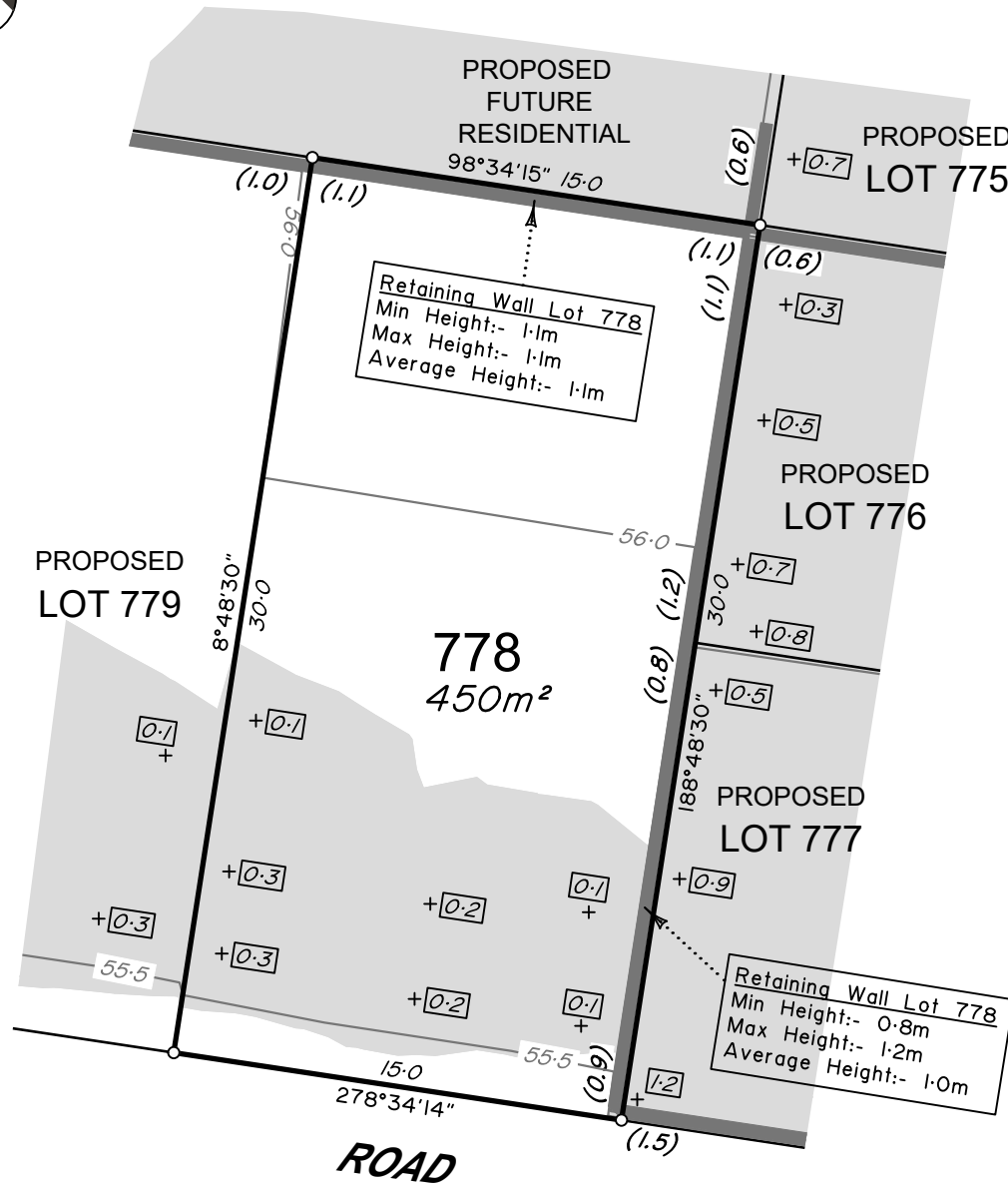

LEGEND

Final surface contours based on A.H.D. datum at an interval of 0.25m, shown as: $\text{---} 15.5 \text{---}$

Where applicable, areas to be filled are shown as:

Depth of fill, in metres, shown as:- $\text{+} [L1]$

Retaining wall and retaining wall height, shown on the lower side of the wall, have been taken from plans supplied by Calibre Group and shown as: $\text{---} (1.2) \text{---}$

ADDITIONAL NOTES:

The LOT dimensions and area shown hereon are subject to final field survey and also to the requirements of Council and any other authority which may have requirements under any relevant legislation

Final surface contours shown hereon have been supplied by Calibre Group.

Compaction of any fill material placed on this site shall be completed to level one inspection and testing services in accordance with AS3798-2007.

Copyright © Veris Australia Pty Ltd 15/03/2022.

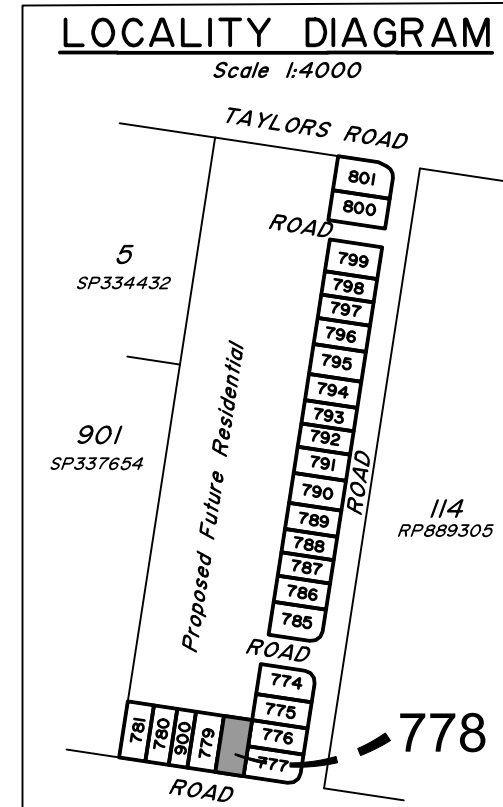

dawn.
WALLOON

Gibbs STAGE 1
For
ID_Land

IMPORTANT NOTES:
(These notes are an integral part of this plan)
This plan has been prepared for ID_Land for the purposes of A Disclosure Plan Under the Land Sales Act 1984 (as amended). It is not to be used by any other person or corporation or for any other purposes and is subject to the following limitations:

Please refer to the approved Development Application for conditions relating to the LOT and to approved Operational Works drawings for services location and possible easements.

THESE DESIGNS AND DRAWINGS ARE COPYRIGHT AND ARE NOT TO BE USED OR REPRODUCED WITHOUT THE WRITTEN PERMISSION OF VERIS

Data Sources

Cadastral Boundaries
401905-1-C01-1-W.dwg
Retaining Walls
Gibbs Stg-1 RT WALLS.dwg
Final Surface Contours
Gibbs Stg-1 DESN SURFACE.dwg
Depth of Fill
Gibbs Stg-1 FILL DEPTH CONT.dwg
Gibbs Stg-1 CUT FILL.dwg

Issue	Revisions	Date	Drawn
B	Amend adjoiners	05.05.2023	DMC
A	Original	24.03.2023	GJF

Locality: WALLOON
Local Authority: Ipswich City Council
Horizontal Meridian: MGA Zone 56
Vertical Level Datum: AHD
Scale: 1:250 @ A4
Designed: *
Drawn: GJF 24/03/2023
Checked: DMC
Plot Date: 09 May, 2023
Comp File Ref: 401905-01-DP01(B).dwg

DISCLOSURE PLAN
of Proposed LOT 778
currently being part of
Lot 6 on RP121124



veris

BRISBANE (07) 3686 4700 WHITSUNDAYS (07) 4945 6600

MACKAY (07) 4957 9700 CAIRNS (07) 4252 9400

veris.com.au
ACN 615 735 727
Veris Australia Pty Ltd

Drawing No Issue
401905-01-DP-778 B



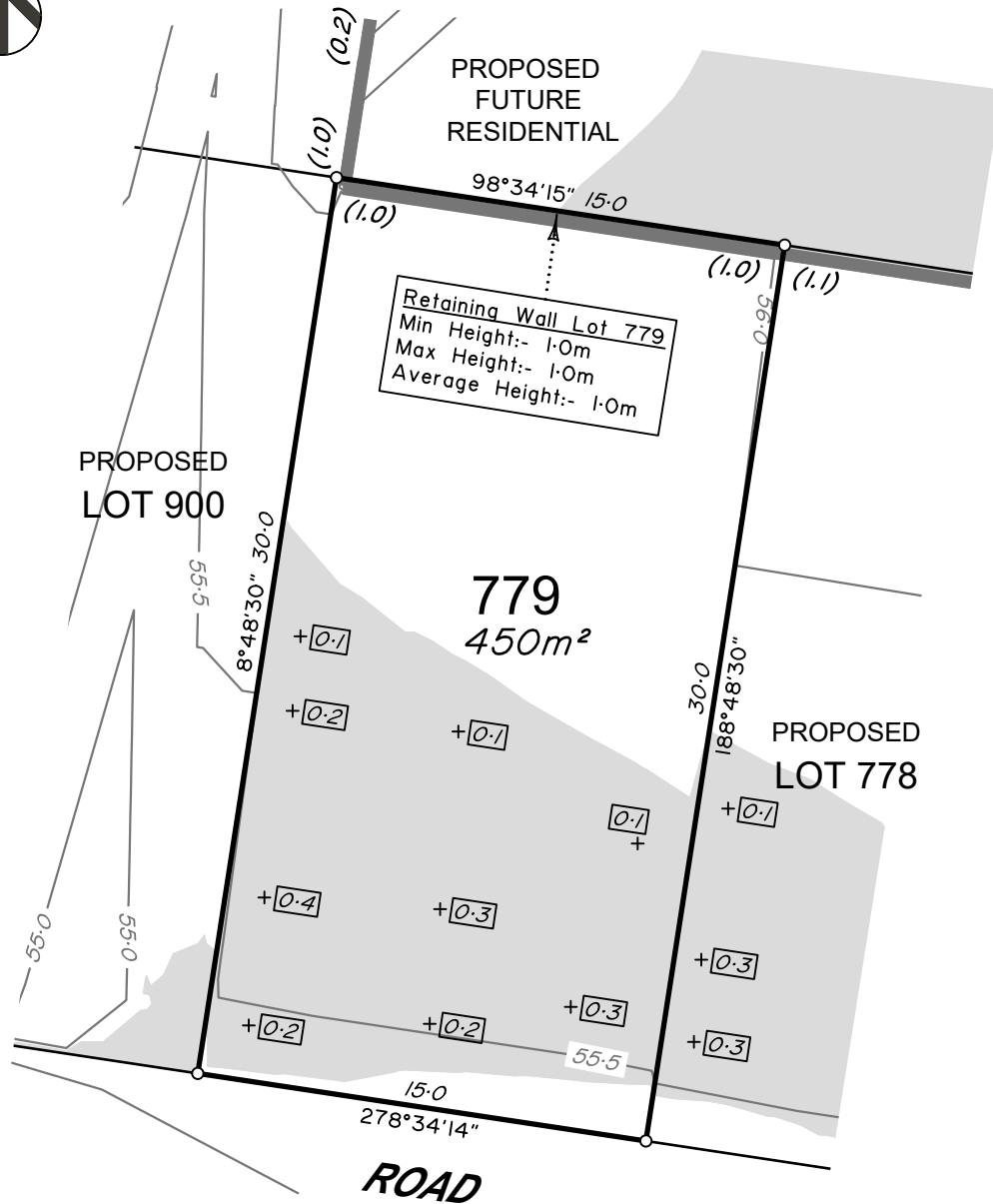

LEGEND

Final surface contours based on A.H.D. datum at an interval of 0.25m, shown as: $\text{---} 15.5 \text{---}$

Where applicable, areas to be filled are shown as:

Depth of fill, in metres, shown as:- $+ [L]$

Retaining wall and retaining wall height, shown on the lower side of the wall, have been taken from plans supplied by Calibre Group and shown as: $\text{---} (1.2) \text{---}$

ADDITIONAL NOTES:

The LOT dimensions and area shown hereon are subject to final field survey and also to the requirements of Council and any other authority which may have requirements under any relevant legislation

Final surface contours shown hereon have been supplied by Calibre Group.

Compaction of any fill material placed on this site shall be completed to level one inspection and testing services in accordance with AS3798-2007.

Copyright © Veris Australia Pty Ltd 15/03/2022.

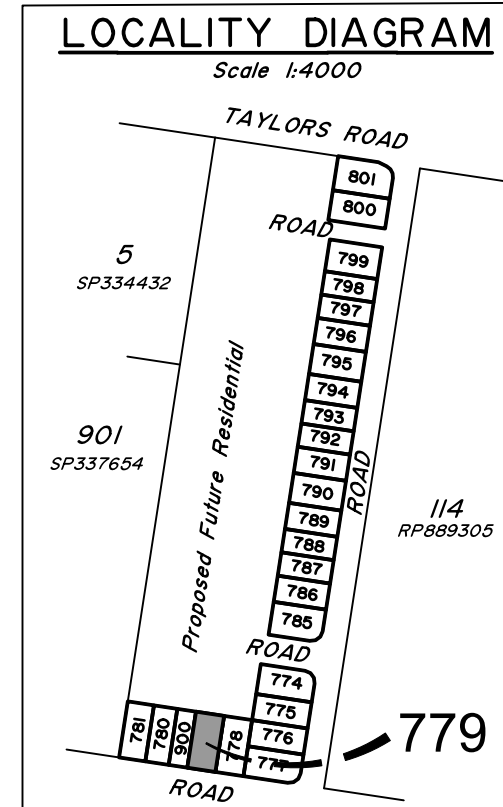

dawn.
WALLOON

Gibbs STAGE 1
For
ID_Land

IMPORTANT NOTES:
(These notes are an integral part of this plan)
This plan has been prepared for ID_Land for the purposes of A Disclosure Plan Under the Land Sales Act 1984 (as amended). It is not to be used by any other person or corporation or for any other purposes and is subject to the following limitations:

Please refer to the approved Development Application for conditions relating to the LOT and to approved Operational Works drawings for services location and possible easements.

THESE DESIGNS AND DRAWINGS ARE COPYRIGHT AND ARE NOT TO BE USED OR REPRODUCED WITHOUT THE WRITTEN PERMISSION OF VERIS

Data Sources

Cadastral Boundaries
401905-1-CD01-WJ.dwg
Retaining Walls
Gibbs Stg-1 RT WALLS.dwg
Final Surface Contours
Gibbs Stg-1 DESN SURFACE.dwg
Depth of Fill
Gibbs Stg-1 FILL DEPTH CONT.dwg
Gibbs Stg-1 CUT FILL.dwg

Issue	Revisions	Date	Drawn
B	Amend adjpiners	8.05.2023	DMC
A	Original	24.03.2023	GJF

Locality: WALLOON
Local Authority: Ipswich City Council
Horizontal Meridian: MGA Zone 56
Vertical Level Datum: AHD
Scale: 1:250 @ A4
Designed: *
Drawn: GJF 24/03/2023
Checked: DMC
Plot Date: 09 May, 2023
Comp File Ref: 401905-01-DP01(B).dwg

DISCLOSURE PLAN
of Proposed LOT 779
currently being part of
Lot 6 on RP121124



veris

BRISBANE (07) 3686 4700 WHITSUNDAYS (07) 4945 6600

MACKAY (07) 4957 9700 CAIRNS (07) 4252 9400

veris.com.au
ACN 615 735 727
Veris Australia Pty Ltd

Drawing No Issue
401905-01-DP-779 B



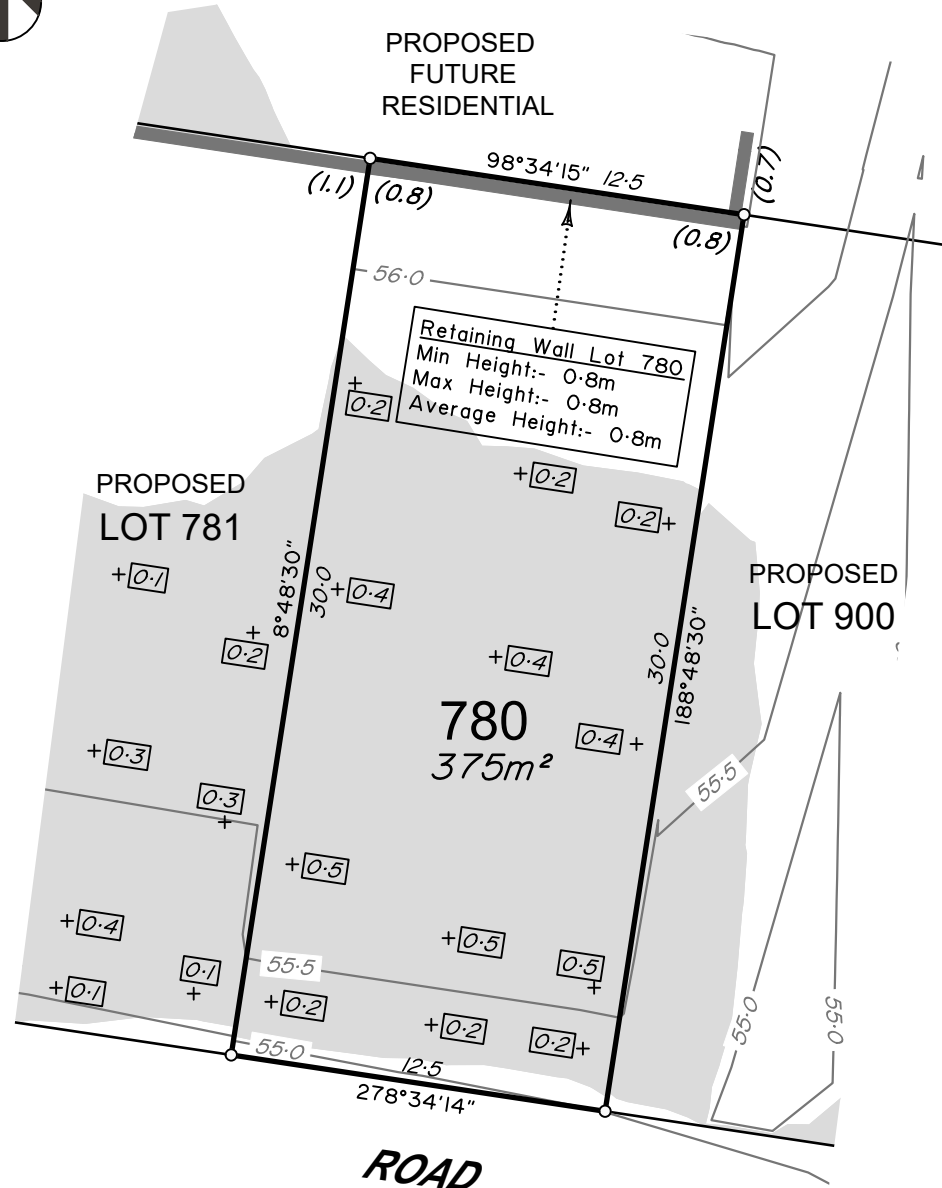

LEGEND

Final surface contours based on A.H.D. datum at an interval of 0.25m, shown as: $\text{---} / 5.5 \text{---}$

Where applicable, areas to be filled are shown as:

Depth of fill, in metres, shown as:- $\text{+}[L]$

Retaining wall and retaining wall height, shown on the lower side of the wall, have been taken from plans supplied by Calibre Group and shown as: $\text{---} (1.2) \text{---}$

ADDITIONAL NOTES:

The LOT dimensions and area shown hereon are subject to final field survey and also to the requirements of Council and any other authority which may have requirements under any relevant legislation

Final surface contours shown hereon have been supplied by Calibre Group.

Compaction of any fill material placed on this site shall be completed to level one inspection and testing services in accordance with AS3798-2007.

Copyright © Veris Australia Pty Ltd 15/03/2022.

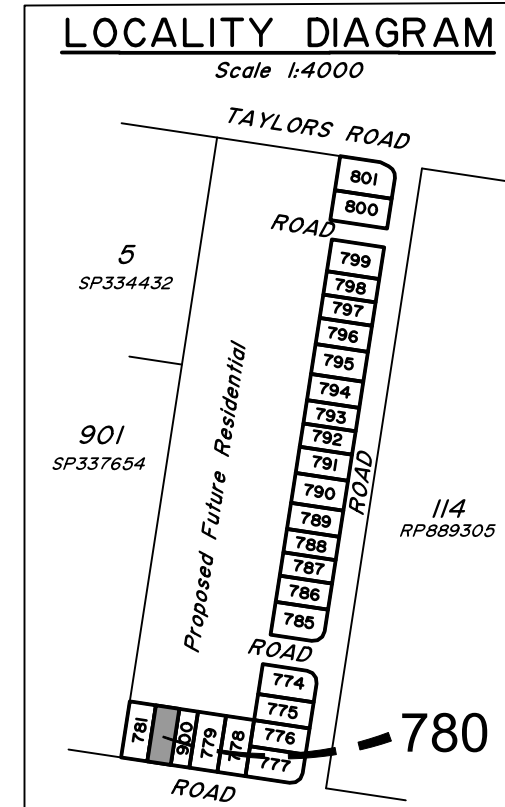

dawn.
WALLOON

Gibbs STAGE 1
For
ID_Land

IMPORTANT NOTES:
(These notes are an integral part of this plan)
This plan has been prepared for ID_Land for the purposes of A Disclosure Plan Under the Land Sales Act 1984 (as amended). It is not to be used by any other person or corporation or for any other purposes and is subject to the following limitations:

Please refer to the approved Development Application for conditions relating to the LOT and to approved Operational Works drawings for services location and possible easements.

THESE DESIGNS AND DRAWINGS ARE COPYRIGHT AND ARE NOT TO BE USED OR REPRODUCED WITHOUT THE WRITTEN PERMISSION OF VERIS

Data Sources

Cadastral Boundaries
401905-LC01-WJ.dwg
Retaining Walls
Gibbs Stg-1 RT WALLS.dwg
Final Surface Contours
Gibbs Stg-1 DESN SURFACE.dwg
Depth of Fill
Gibbs Stg-1 FILL DEPTH CONT.dwg
Gibbs Stg-1 CUT FILL.dwg

Issue	Revisions	Date	Drawn
B	Amend adjoiners	05.05.2023	DMC
A	Original	24.03.2023	GJF

Locality: WALLOON
Local Authority: Ipswich City Council
Horizontal Meridian: MGA Zone 56
Vertical Level Datum: AHD
Scale: 1:250 @ A4
Designed: *
Drawn: GJF 24/03/2023
Checked: DMC
Plot Date: 09 May, 2023
Comp File Ref: 401905-01-DP01(B).dwg

DISCLOSURE PLAN
of Proposed LOT 780
currently being part of
Lot 6 on RP121124



veris

BRISBANE (07) 3686 4700 WHITSUNDAYS (07) 4945 6600

MACKAY (07) 4957 9700 CAIRNS (07) 4252 9400

veris.com.au
ACN 615 735 727
Veris Australia Pty Ltd

Drawing No 401905-01-DP-780 Issue B

0 12.5m 50 mm 25m 100 mm 37.5m 150 mm SCALE BAR

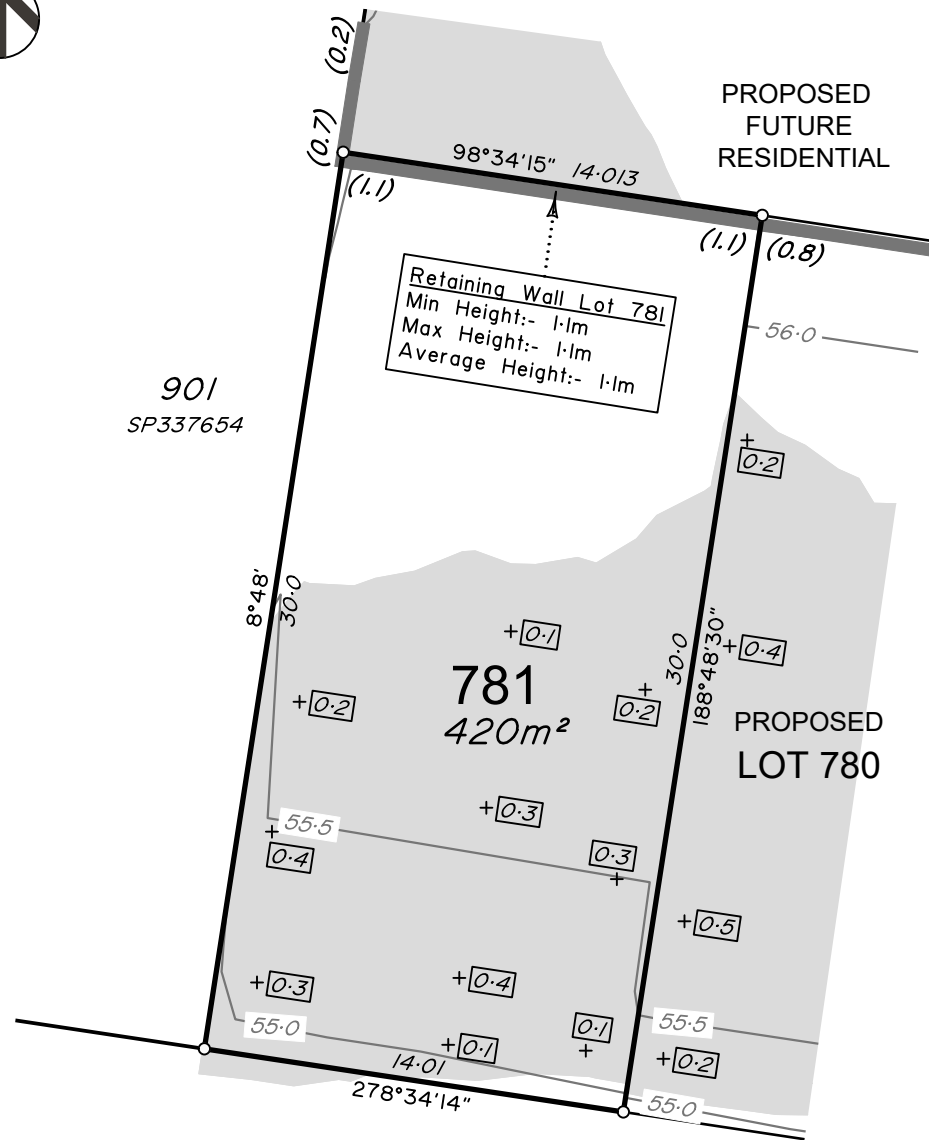

901
SP337654

Retaining Wall Lot 781
Min Height:- 1.1m
Max Height:- 1.1m
Average Height:- 1.1m

PROPOSED
FUTURE
RESIDENTIAL

PROPOSED
LOT 780

ROAD

LEGEND

Final surface contours based on A.H.D. datum at an interval of 0.25m, shown as: $\text{---} / 5.5 \text{---}$

Where applicable, areas to be filled are shown as:

Depth of fill, in metres, shown as:- $\text{+} [L1]$

Retaining wall and retaining wall height, shown on the lower side of the wall, have been taken from plans supplied by Calibre Group and shown as: $\text{---} (1.2) \text{---}$

ADDITIONAL NOTES:

The LOT dimensions and area shown hereon are subject to final field survey and also to the requirements of Council and any other authority which may have requirements under any relevant legislation

Final surface contours shown hereon have been supplied by Calibre Group.

Compaction of any fill material placed on this site shall be completed to level one inspection and testing services in accordance with AS3798-2007.

Copyright © Veris Australia Pty Ltd 15/03/2022.

LOCALITY DIAGRAM

Scale 1:4000

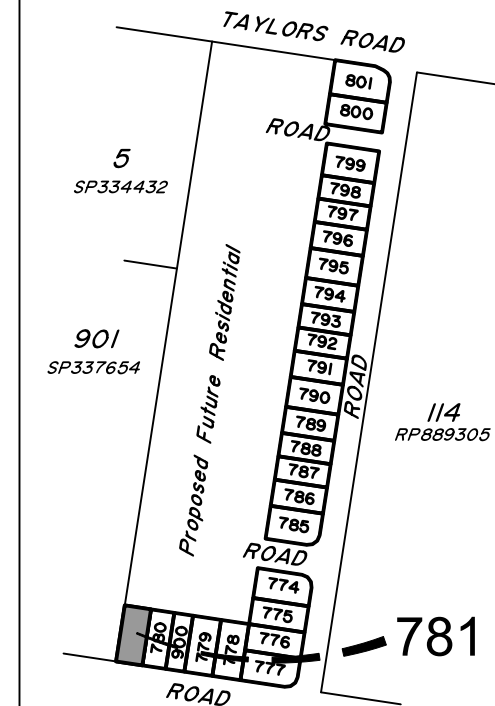

dawn.
WALLOON

Gibbs STAGE 1
For
ID_Land

IMPORTANT NOTES:
(These notes are an integral part of this plan)
This plan has been prepared for ID_Land for the purposes of A Disclosure Plan Under the Land Sales Act 1984 (as amended). It is not to be used by any other person or corporation or for any other purposes and is subject to the following limitations:

Please refer to the approved Development Application for conditions relating to the LOT and to approved Operational Works drawings for services location and possible easements.

THESE DESIGNS AND DRAWINGS ARE COPYRIGHT AND ARE NOT TO BE USED OR REPRODUCED WITHOUT THE WRITTEN PERMISSION OF VERIS

Data Sources

Cadastral Boundaries
401905-LC01-W.dwg
Retaining Walls
Gibbs Stg-1 RT WALLS.dwg
Final Surface Contours
Gibbs Stg-1 DESN SURFACE.dwg
Depth of Fill
Gibbs Stg-1 FILL DEPTH CONT.dwg
Gibbs Stg-1 CUT FILL.dwg

Issue	Revisions	Date	Drawn
B	Amend adjoiners	05.05.2023	DMC
A	Original	24.03.2023	GJF

Locality: WALLOON
Local Authority: Ipswich City Council
Horizontal Meridian: MGA Zone 56
Vertical Level Datum: AHD
Scale: 1:250 @ A4
Designed: *
Drawn: GJF 24/03/2023
Checked: DMC
Plot Date: 09 May, 2023
Comp File Ref: 401905-01-DP01(B).dwg

DISCLOSURE PLAN
of Proposed LOT 781
currently being part of
Lot 6 on RP121124



veris

BRISBANE (07) 3686 4700 WHITSUNDAYS (07) 4945 6600

MACKAY (07) 4957 9700 CAIRNS (07) 4252 9400

veris.com.au
ACN 615 735 727
Veris Australia Pty Ltd

Drawing No Issue
401905-01-DP-781 B





LEGEND

Final surface contours based on A.H.D. datum at an interval of 0.25m, shown as: — 15.5 —

Where applicable, areas to be filled are shown as:

Depth of fill, in metres, shown as: + [L1]

Retaining wall and retaining wall height, shown on the lower side of the wall, have been taken from plans supplied by Calibre Group and shown as:

(1.2)

ADDITIONAL NOTES:

The LOT dimensions and area shown hereon are subject to final field survey and also to the requirements of Council and any other authority which may have requirements under any relevant legislation

Final surface contours shown hereon have been supplied by Calibre Group.

Compaction of any fill material placed on this site shall be completed to level one inspection and testing services in accordance with AS3798-2007.

Copyright © Veris Australia Pty Ltd 15/03/2022.

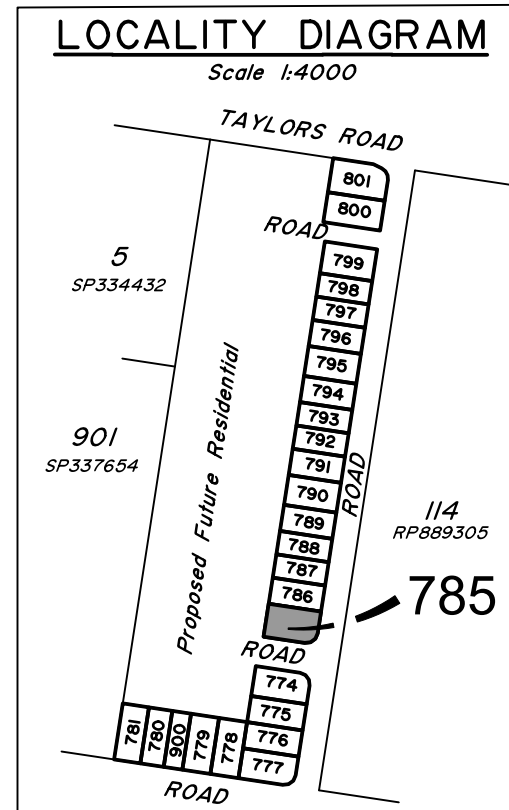
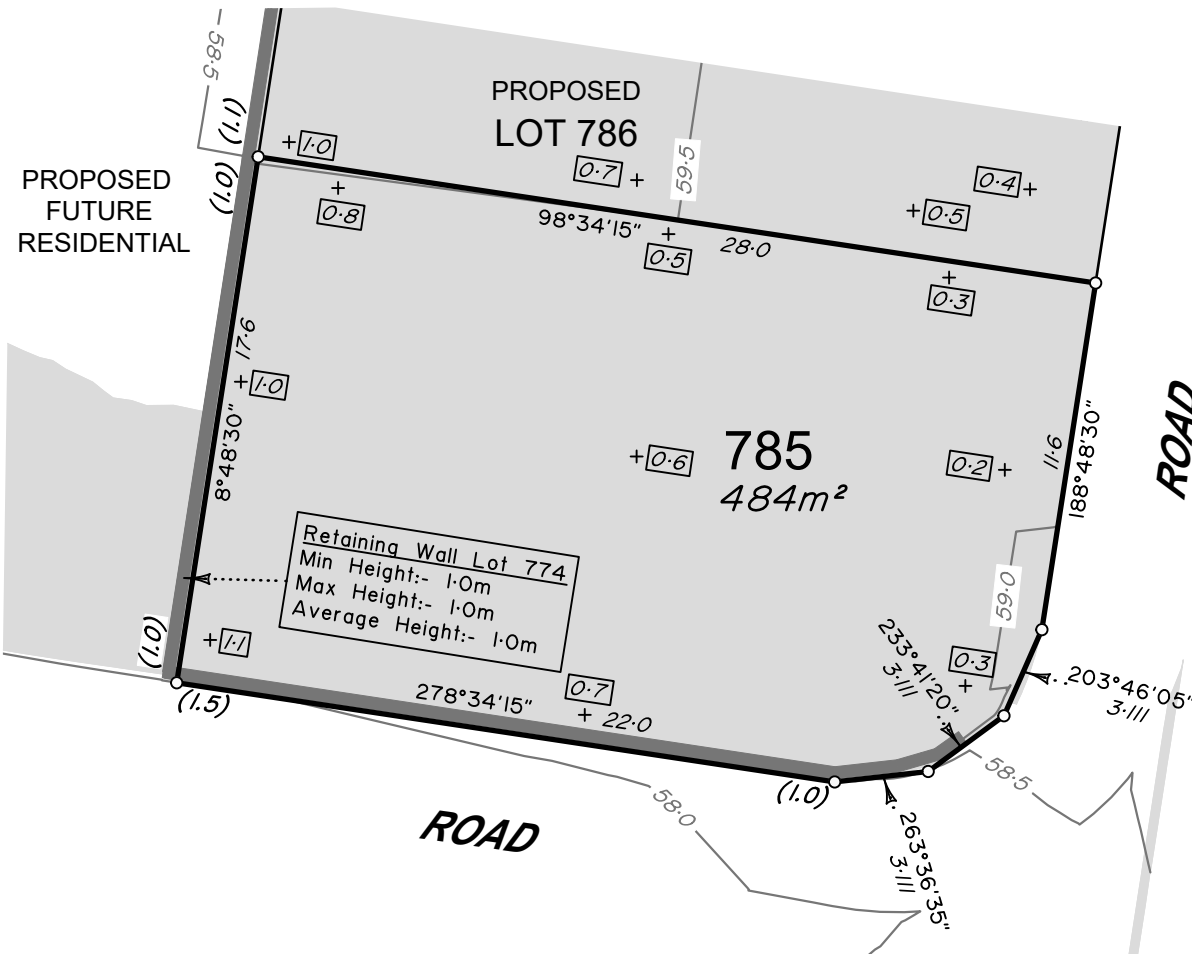

Gibbs STAGE 1
For
ID_Land

IMPORTANT NOTES:
(These notes are an integral part of this plan)
This plan has been prepared for ID_Land for the purposes of A Disclosure Plan Under the Land Sales Act 1984 (as amended). It is not to be used by any other person or corporation or for any other purposes and is subject to the following limitations:

Please refer to the approved Development Application for conditions relating to the LOT and to approved Operational Works drawings for services location and possible easements.

THESE DESIGNS AND DRAWINGS ARE COPYRIGHT AND ARE NOT TO BE USED OR REPRODUCED WITHOUT THE WRITTEN PERMISSION OF VERIS

Data Sources
Cadastral Boundaries 401905-LC01-W.dwg
Retaining Walls Gibbs Stg-1 RT WALLS.dwg
Final Surface Contours Gibbs Stg-1 DESN SURFACE.dwg
Depth of Fill Gibbs Stg-1 FILL DEPTH CONT.dwg
Gibbs Stg-1 CUT FILL.dwg

Issue	Revisions	Date	Drawn
B	Amend adjpiners	8.05.2023	DMC
A	Original	24.03.2023	GJF

Locality: WALLOON
 Local Authority: Ipswich City Council
 Horizontal Meridian: MGA Zone 56
 Vertical Level Datum: AHD
 Scale: 1:250 @ A4
 Designed: *
 Drawn: GJF 24/03/2023
 Checked: DMC
 Plot Date: 09 May, 2023
 Comp File Ref: 401905-01-DP01(B).dwg

DISCLOSURE PLAN
of Proposed LOT 785
currently being part of
Lot 6 on RP121124



BRISBANE (07) 3686 4700 WHITSUNDAYS (07) 4945 6600

MACKAY (07) 4957 9700 CAIRNS (07) 4252 9400

veris.com.au
ACN 615 735 727
Veris Australia Pty Ltd

Drawing No 401905-01-DP-785 Issue B



LEGEND

Final surface contours based on A.H.D. datum at an interval of 0.25m, shown as: $\text{---} / 5.5 \text{---}$

Where applicable, areas to be filled are shown as:

Depth of fill, in metres, shown as: $\text{+} [L]$

Retaining wall and retaining wall height, shown on the lower side of the wall, have been taken from plans supplied by Calibre Group and shown as: $\text{---} (L.2) \text{---}$

ADDITIONAL NOTES:

The LOT dimensions and area shown hereon are subject to final field survey and also to the requirements of Council and any other authority which may have requirements under any relevant legislation

Final surface contours shown hereon have been supplied by Calibre Group.

Compaction of any fill material placed on this site shall be completed to level one inspection and testing services in accordance with AS3798-2007.

Copyright © Veris Australia Pty Ltd 15/03/2022.

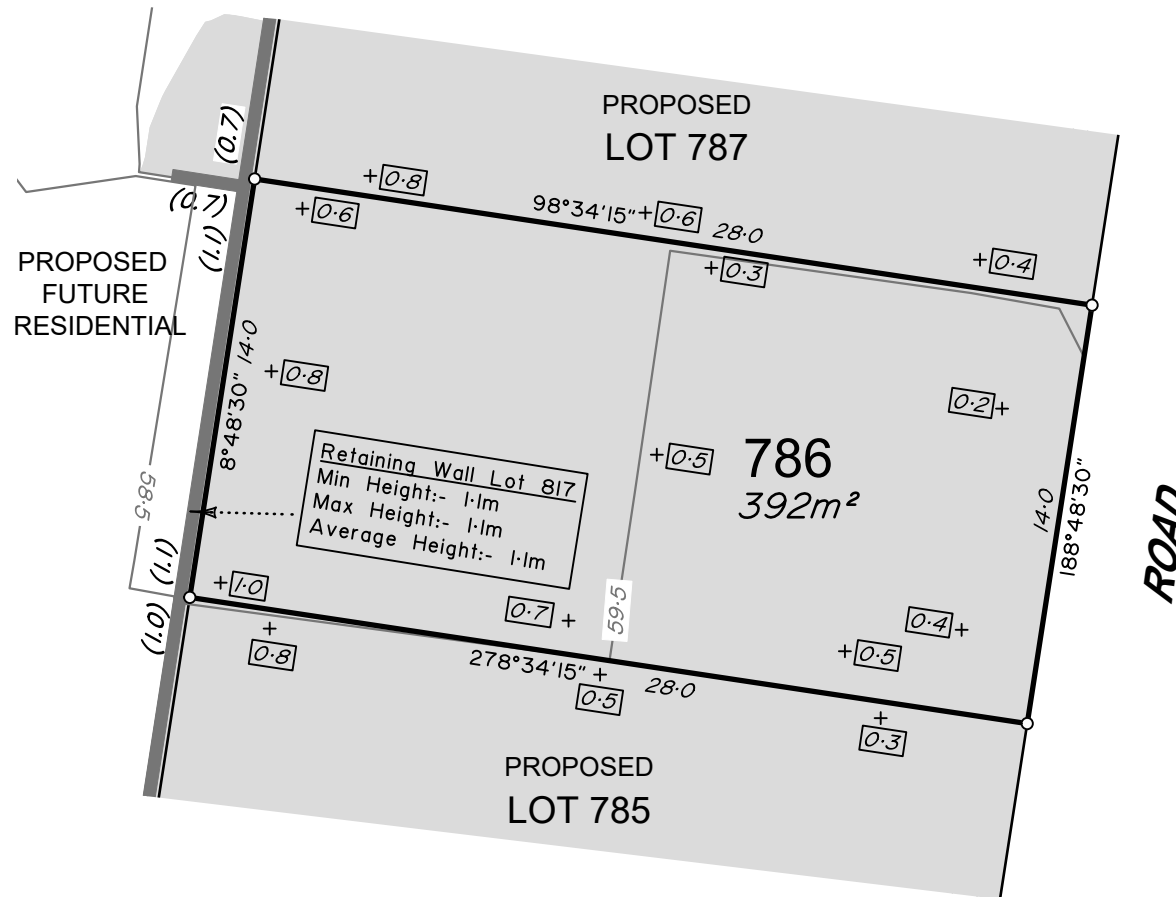
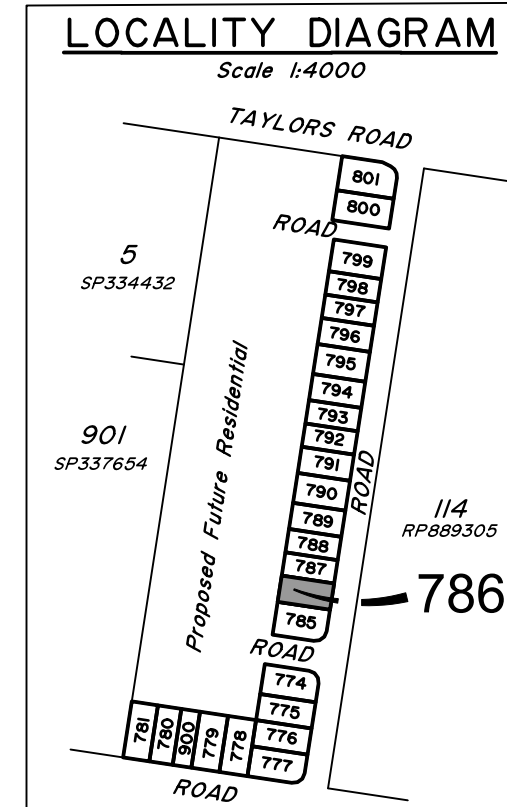

Gibbs STAGE 1
For
ID_Land

IMPORTANT NOTES:
(These notes are an integral part of this plan)
This plan has been prepared for ID_Land for the purposes of A Disclosure Plan Under the Land Sales Act 1984 (as amended). It is not to be used by any other person or corporation or for any other purposes and is subject to the following limitations:

Please refer to the approved Development Application for conditions relating to the LOT and to approved Operational Works drawings for services location and possible easements.

THESE DESIGNS AND DRAWINGS ARE COPYRIGHT AND ARE NOT TO BE USED OR REPRODUCED WITHOUT THE WRITTEN PERMISSION OF VERIS

Data Sources

Cadastral Boundaries
401905-L001-W1.dwg
Retaining Walls
Gibbs Stg-1 RT WALLS.dwg
Final Surface Contours
Gibbs Stg-1 DESN SURFACE.dwg
Depth of Fill
Gibbs Stg-1 FILL DEPTH CONT.dwg
Gibbs Stg-1 CUT FILL.dwg

Issue	Revisions	Date	Drawn
B	Amend adjoiners	05.05.2023	DMC
A	Original	24.03.2023	GJF

Locality: WALLOON
Local Authority: Ipswich City Council
Horizontal Meridian: MGA Zone 56
Vertical Level Datum: AHD
Scale: 1:250 @ A4
Designed: *
Drawn: GJF 24/03/2023
Checked: DMC
Plot Date: 09 May, 2023
Comp File Ref: 401905-01-DP01(B).dwg

DISCLOSURE PLAN
of Proposed LOT 785
currently being part of
Lot 6 on RP121124



BRISBANE (07) 3686 4700 WHITSUNDAYS (07) 4945 6600
MACKAY (07) 4957 9700 CAIRNS (07) 4252 9400
veris.com.au
ACN 615 735 727
Veris Australia Pty Ltd

Drawing No 401905-01-DP-786 Issue B





LEGEND

Final surface contours based on A.H.D. datum at an interval of 0.25m, shown as: $\text{---} / 5.5 \text{---}$

Where applicable, areas to be filled are shown as:

Depth of fill, in metres, shown as:- $\text{+}[L]$

Retaining wall and retaining wall height, shown on the lower side of the wall, have been taken from plans supplied by Calibre Group and shown as: $\text{---} (1.2) \text{---}$

ADDITIONAL NOTES:

The LOT dimensions and area shown hereon are subject to final field survey and also to the requirements of Council and any other authority which may have requirements under any relevant legislation

Final surface contours shown hereon have been supplied by Calibre Group.

Compaction of any fill material placed on this site shall be completed to level one inspection and testing services in accordance with AS3798-2007.

Copyright © Veris Australia Pty Ltd 15/03/2022.

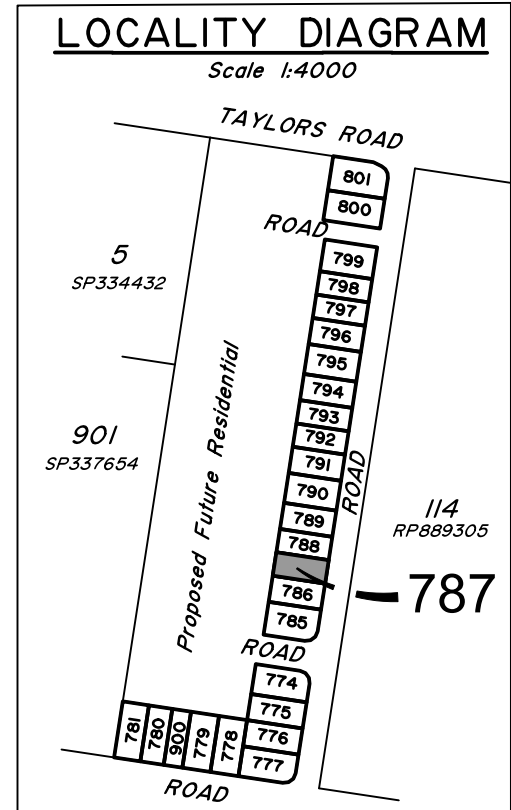
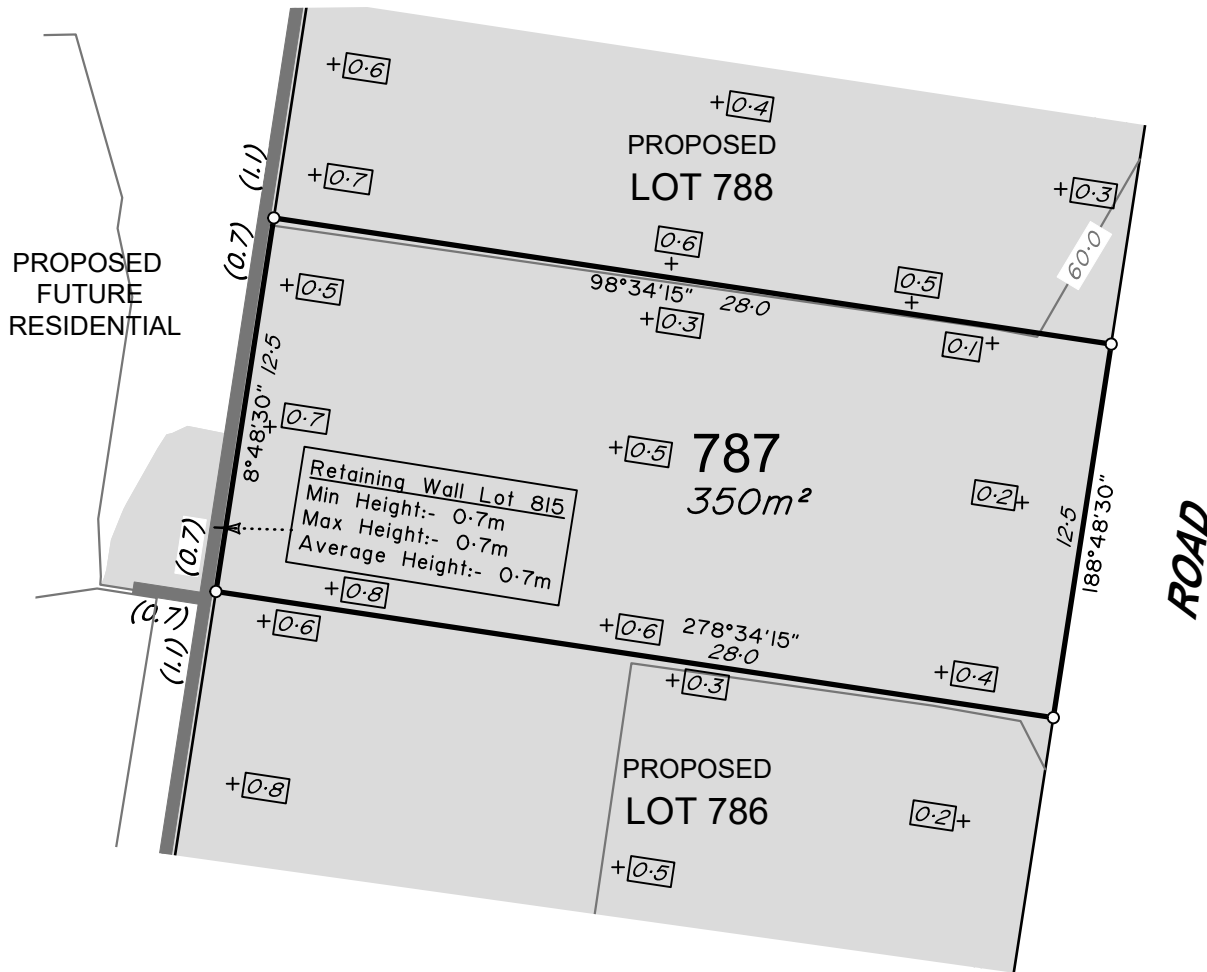

Gibbs STAGE 1
For
ID_Land

IMPORTANT NOTES:
(These notes are an integral part of this plan)
This plan has been prepared for ID_Land for the purposes of A Disclosure Plan Under the Land Sales Act 1984 (as amended). It is not to be used by any other person or corporation or for any other purposes and is subject to the following limitations:

Please refer to the approved Development Application for conditions relating to the LOT and to approved Operational Works drawings for services location and possible easements.

THESE DESIGNS AND DRAWINGS ARE COPYRIGHT AND ARE NOT TO BE USED OR REPRODUCED WITHOUT THE WRITTEN PERMISSION OF VERIS

Data Sources
Cadastral Boundaries 401905-LC01-WJ.dwg
Retaining Walls Gibbs Stg-1 RT WALLS.dwg
Final Surface Contours Gibbs Stg-1 DESN SURFACE.dwg
Depth of Fill Gibbs Stg-1 FILL DEPTH CONT.dwg
Gibbs Stg-1 CUT FILL.dwg

Issue	Revisions	Date	Drawn
B	Amend adjpiners	05.05.2023	DMC
A	Original	24.03.2023	GJF

Locality: WALLOON
Local Authority: Ipswich City Council
Horizontal Meridian: MGA Zone 56
Vertical Level Datum: AHD
Scale: 1:250 @ A4
Designed: *
Drawn: GJF 24/03/2023
Checked: DMC
Plot Date: 09 May, 2023
Comp File Ref: 401905-01-DP01(B).dwg

DISCLOSURE PLAN
of Proposed LOT 787
currently being part of
Lot 6 on RP121124



BRISBANE (07) 3686 4700 WHITSUNDAYS (07) 4945 6600
MACKAY (07) 4957 9700 CAIRNS (07) 4252 9400
veris.com.au
ACN 615 735 727
Veris Australia Pty Ltd





LEGEND

Final surface contours based on A.H.D. datum at an interval of 0.25m, shown as: $\text{---} / 5.5 \text{---}$

Where applicable, areas to be filled are shown as: 

Depth of fill, in metres, shown as:- $\text{+}[L]$

Retaining wall and retaining wall height, shown on the lower side of the wall, have been taken from plans supplied by Calibre Group and shown as: $\text{---} (1.2) \text{---}$

ADDITIONAL NOTES:

The LOT dimensions and area shown hereon are subject to final field survey and also to the requirements of Council and any other authority which may have requirements under any relevant legislation

Final surface contours shown hereon have been supplied by Calibre Group.

Compaction of any fill material placed on this site shall be completed to level one inspection and testing services in accordance with AS3798-2007.

Copyright © Veris Australia Pty Ltd 15/03/2022.

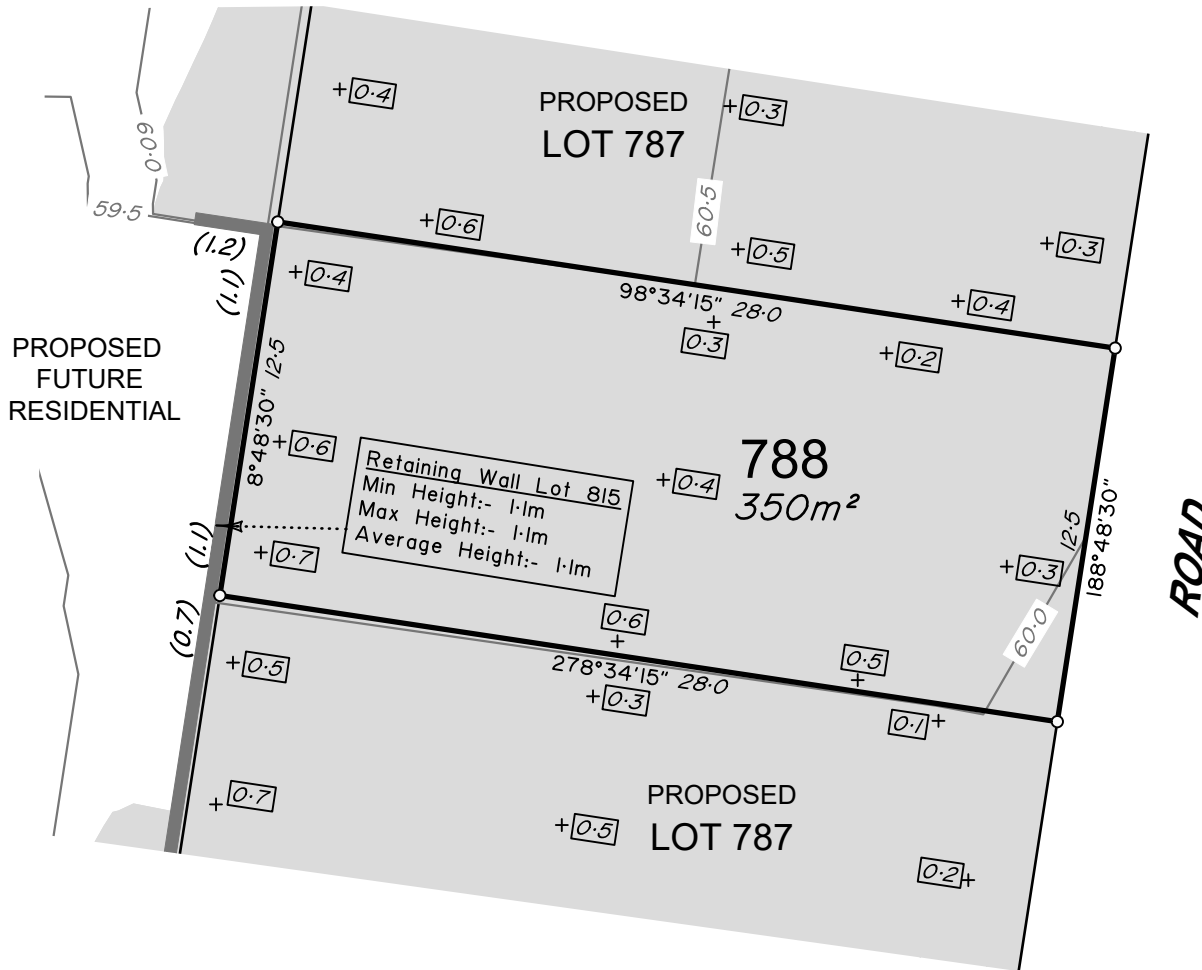
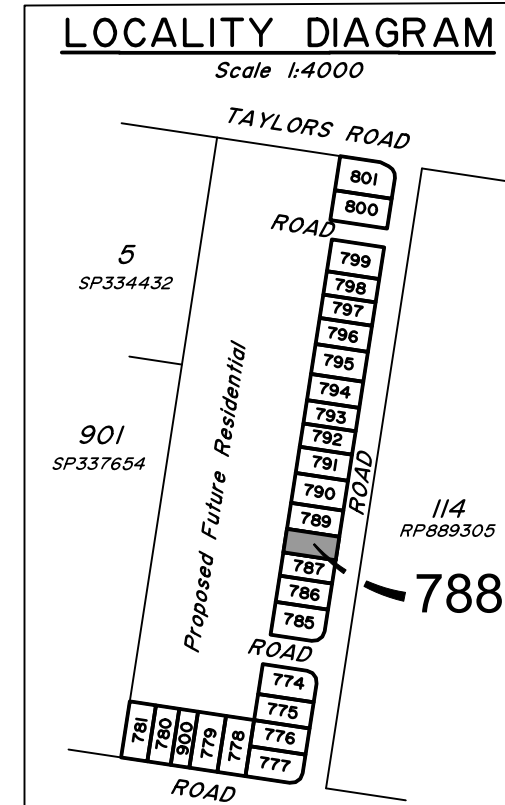

dawn.
WALLOON

Gibbs STAGE 1
For
ID_Land

IMPORTANT NOTES:
(These notes are an integral part of this plan)
This plan has been prepared for ID_Land for the purposes of A Disclosure Plan Under the Land Sales Act 1984 (as amended). It is not to be used by any other person or corporation or for any other purposes and is subject to the following limitations:

Please refer to the approved Development Application for conditions relating to the LOT and to approved Operational Works drawings for services location and possible easements.

THESE DESIGNS AND DRAWINGS ARE COPYRIGHT AND ARE NOT TO BE USED OR REPRODUCED WITHOUT THE WRITTEN PERMISSION OF VERIS

Data Sources

Cadastral Boundaries
401905-LC01-WJ.dwg
Retaining Walls
Gibbs Stg-1 RT WALLS.dwg
Final Surface Contours
Gibbs Stg-1 DESN SURFACE.dwg
Depth of Fill
Gibbs Stg-1 FILL DEPTH CONT.dwg
Gibbs Stg-1 CUT FILL.dwg

Issue	Revisions	Date	Drawn
B	Amend adjpiners	8.05.2023	DMC
A	Original	24.03.2023	GJF

Locality: WALLOON
Local Authority: Ipswich City Council
Horizontal Meridian: MGA Zone 56
Vertical Level Datum: AHD
Scale: 1:250 @ A4
Designed: *
Drawn: GJF 24/03/2023
Checked: DMC
Plot Date: 09 May, 2023
Comp File Ref: 401905-01-DP01(B).dwg

DISCLOSURE PLAN
of Proposed LOT 788
currently being part of
Lot 6 on RP121124



veris

BRISBANE (07) 3686 4700 WHITSUNDAYS (07) 4945 6600

MACKAY (07) 4957 9700 CAIRNS (07) 4252 9400

veris.com.au
ACN 615 735 727
Veris Australia Pty Ltd

Drawing No Issue
401905-01-DP-788 B

0 12.5m 50 mm 25m 100 mm 37.5m 150 mm SCALE BAR



LEGEND

Final surface contours based on A.H.D. datum at an interval of 0.25m, shown as: $\text{---} / 5.5 \text{---}$

Where applicable, areas to be filled are shown as:

Depth of fill, in metres, shown as:- $+ [L]$

Retaining wall and retaining wall height, shown on the lower side of the wall, have been taken from plans supplied by Calibre Group and shown as:

(1.2)

ADDITIONAL NOTES:

The LOT dimensions and area shown hereon are subject to final field survey and also to the requirements of Council and any other authority which may have requirements under any relevant legislation

Final surface contours shown hereon have been supplied by Calibre Group.

Compaction of any fill material placed on this site shall be completed to level one inspection and testing services in accordance with AS3798-2007.

Copyright © Veris Australia Pty Ltd 15/03/2022.

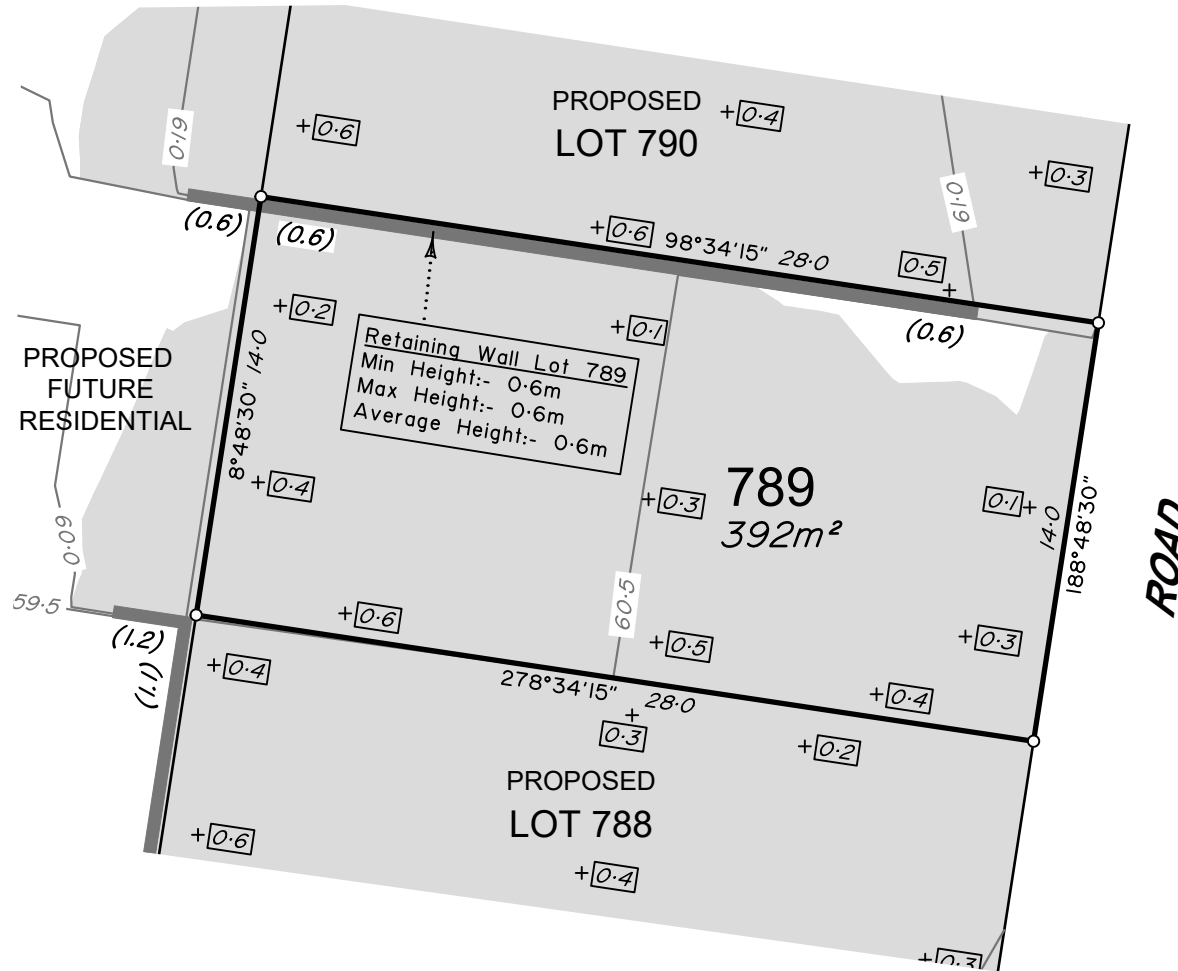
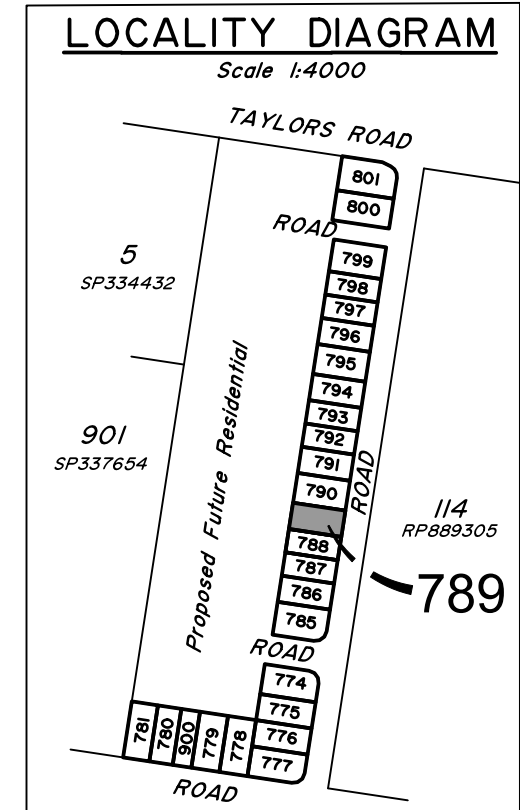

Gibbs STAGE 1
For
ID_Land

IMPORTANT NOTES:
(These notes are an integral part of this plan)
This plan has been prepared for ID_Land for the purposes of A Disclosure Plan Under the Land Sales Act 1984 (as amended). It is not to be used by any other person or corporation or for any other purposes and is subject to the following limitations:

Please refer to the approved Development Application for conditions relating to the LOT and to approved Operational Works drawings for services location and possible easements.

THESE DESIGNS AND DRAWINGS ARE COPYRIGHT AND ARE NOT TO BE USED OR REPRODUCED WITHOUT THE WRITTEN PERMISSION OF VERIS

Data Sources
Cadastral Boundaries 401905-LC01-W.dwg
Retaining Walls Gibbs Stg-1 RT WALLS.dwg
Final Surface Contours Gibbs Stg-1 DESN SURFACE.dwg
Depth of Fill Gibbs Stg-1 FILL DEPTH CONT.dwg
Gibbs Stg-1 CUT FILL.dwg

Issue	Revisions	Date	Drawn
B	Amend adjpiners	8.05.2023	DMC
A	Original	24.03.2023	GJF

Locality: WALLOON
Local Authority: Ipswich City Council
Horizontal Meridian: MGA Zone 56
Vertical Level Datum: AHD
Scale: 1:250 @ A4
Designed: *
Drawn: GJF 24/03/2023
Checked: DMC
Plot Date: 09 May, 2023
Comp File Ref: 401905-01-DP01(B).dwg

DISCLOSURE PLAN
of Proposed LOT 789
currently being part of
Lot 6 on RP121124



veris
BRISBANE (07) 3686 4700 WHITSUNDAYS (07) 4945 6600
MACKAY (07) 4957 9700 CAIRNS (07) 4252 9400
veris.com.au
ACN 615 735 727
Veris Australia Pty Ltd

Drawing No 401905-01-DP-789 Issue B



LEGEND

Final surface contours based on A.H.D. datum at an interval of 0.25m, shown as: $\text{---} / 5.5 \text{---}$

Where applicable, areas to be filled are shown as:

Depth of fill, in metres, shown as:- $+ [L]$

Retaining wall and retaining wall height, shown on the lower side of the wall, have been taken from plans supplied by Calibre Group and shown as: $\text{---} (1.2) \text{---}$

ADDITIONAL NOTES:

The LOT dimensions and area shown hereon are subject to final field survey and also to the requirements of Council and any other authority which may have requirements under any relevant legislation

Final surface contours shown hereon have been supplied by Calibre Group.

Compaction of any fill material placed on this site shall be completed to level one inspection and testing services in accordance with AS3798-2007.

Copyright © Veris Australia Pty Ltd 15/03/2022.

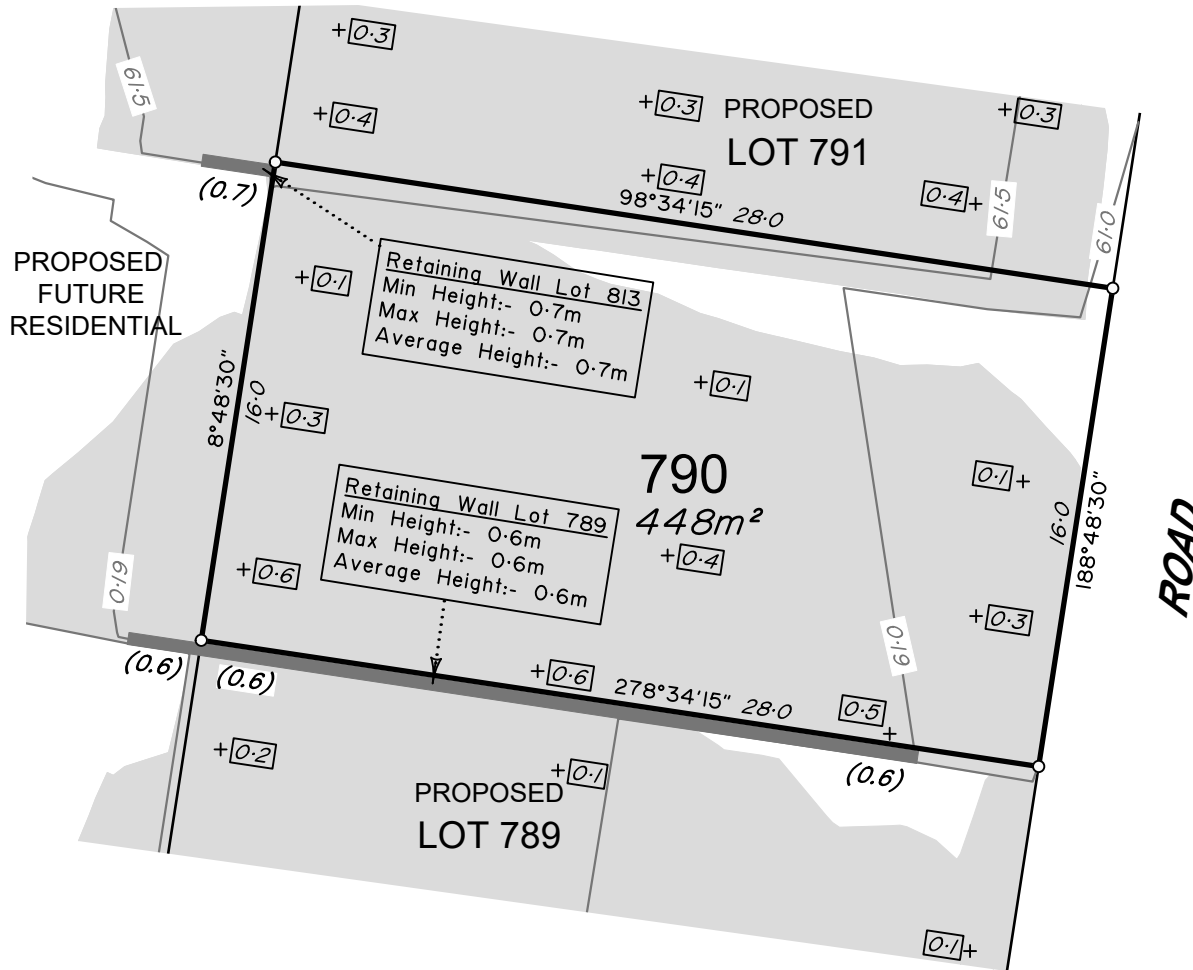

LOCALITY DIAGRAM

Scale 1:4000

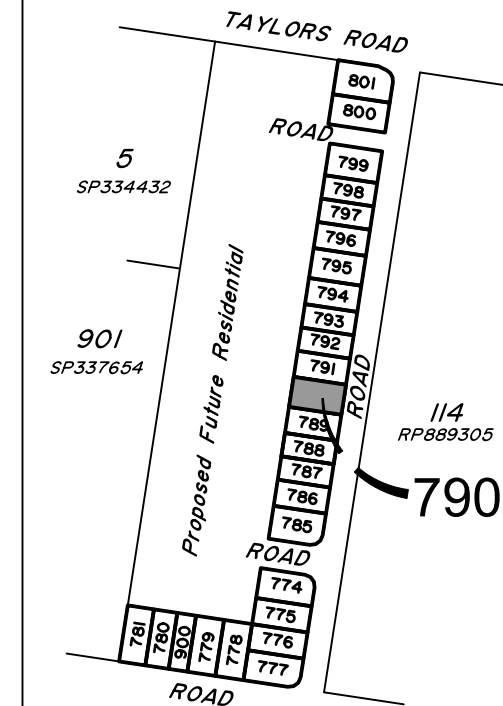

dawn.
WALLOON

Gibbs STAGE 1
For
ID_Land

IMPORTANT NOTES:
(These notes are an integral part of this plan)
This plan has been prepared for ID_Land for the purposes of A Disclosure Plan Under the Land Sales Act 1984 (as amended). It is not to be used by any other person or corporation or for any other purposes and is subject to the following limitations:

Please refer to the approved Development Application for conditions relating to the LOT and to approved Operational Works drawings for services location and possible easements.

THESE DESIGNS AND DRAWINGS ARE COPYRIGHT AND ARE NOT TO BE USED OR REPRODUCED WITHOUT THE WRITTEN PERMISSION OF VERIS

Data Sources
Cadastral Boundaries
401905-LC01-W.dwg
Retaining Walls
Gibbs Stg-1 RT WALLS.dwg
Final Surface Contours
Gibbs Stg-1 DESN SURFACE.dwg
Depth of Fill
Gibbs Stg-1 FILL DEPTH CONT.dwg
Gibbs Stg-1 CUT FILL.dwg

Issue	Revisions	Date	Drawn
B	Amend adjpiners	05.05.2023	DMC
A	Original	24.03.2023	GJF

Locality: WALLOON
Local Authority: Ipswich City Council
Horizontal Meridian: MGA Zone 56
Vertical Level Datum: AHD
Scale: 1:250 @ A4
Designed: *
Drawn: GJF 24/03/2023
Checked: DMC
Plot Date: 09 May, 2023
Comp File Ref: 401905-01-DP01(B).dwg

DISCLOSURE PLAN
of Proposed LOT 790
currently being part of
Lot 6 on RP121124



veris

BRISBANE (07) 3686 4700 WHITSUNDAYS (07) 4945 6600

MACKAY (07) 4957 9700 CAIRNS (07) 4252 9400

veris.com.au
ACN 615 735 727
Veris Australia Pty Ltd

Drawing No Issue
401905-01-DP-790 B





LEGEND

Final surface contours based on A.H.D. datum at an interval of 0.25m, shown as: $\text{---} 15.5 \text{---}$

Where applicable, areas to be filled are shown as:

Depth of fill, in metres, shown as:- $\text{+}[L]$

Retaining wall and retaining wall height, shown on the lower side of the wall, have been taken from plans supplied by Calibre Group and shown as: $\text{---}(1.2)\text{---}$

ADDITIONAL NOTES:

The LOT dimensions and area shown hereon are subject to final field survey and also to the requirements of Council and any other authority which may have requirements under any relevant legislation

Final surface contours shown hereon have been supplied by Calibre Group.

Compaction of any fill material placed on this site shall be completed to level one inspection and testing services in accordance with AS3798-2007.

Copyright © Veris Australia Pty Ltd 15/03/2022.

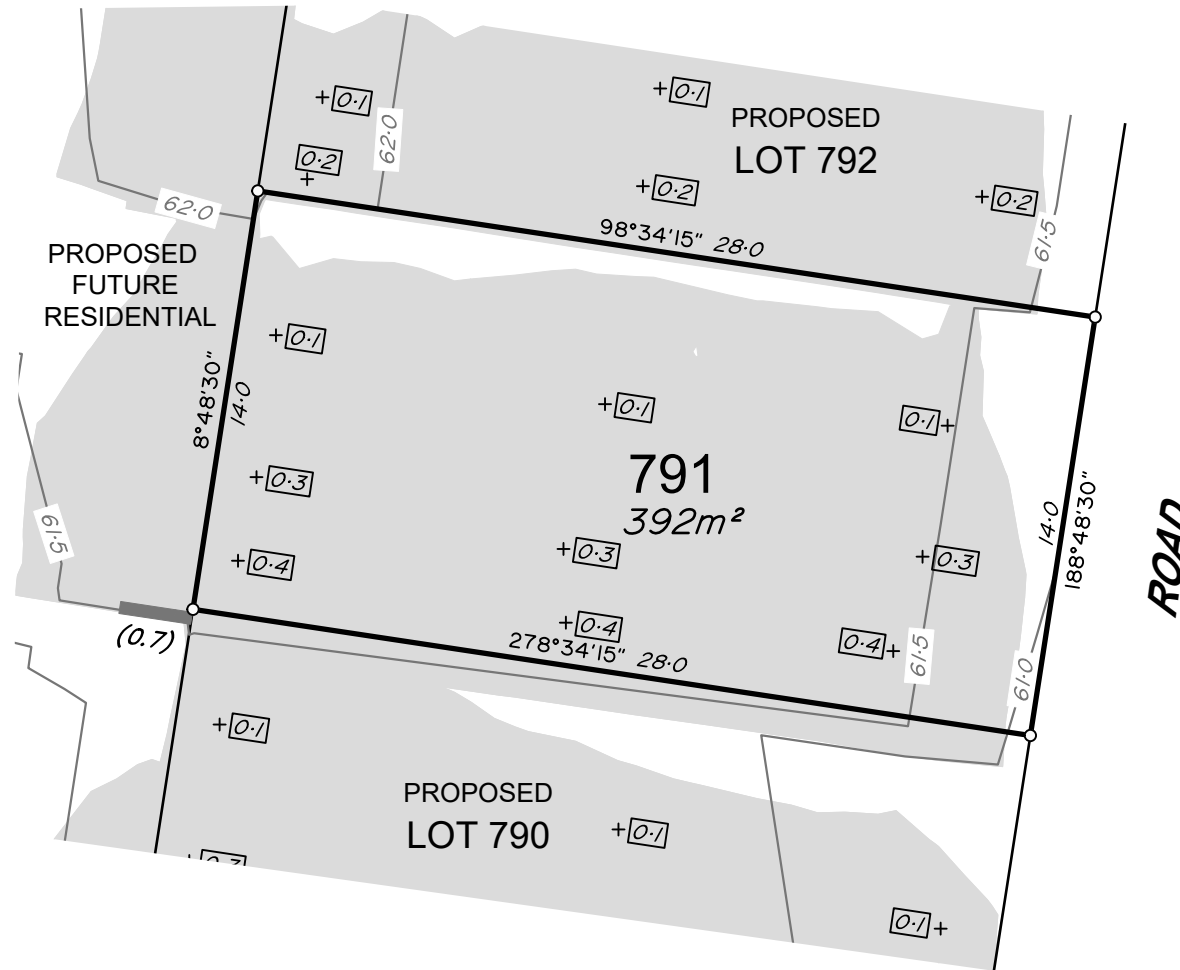
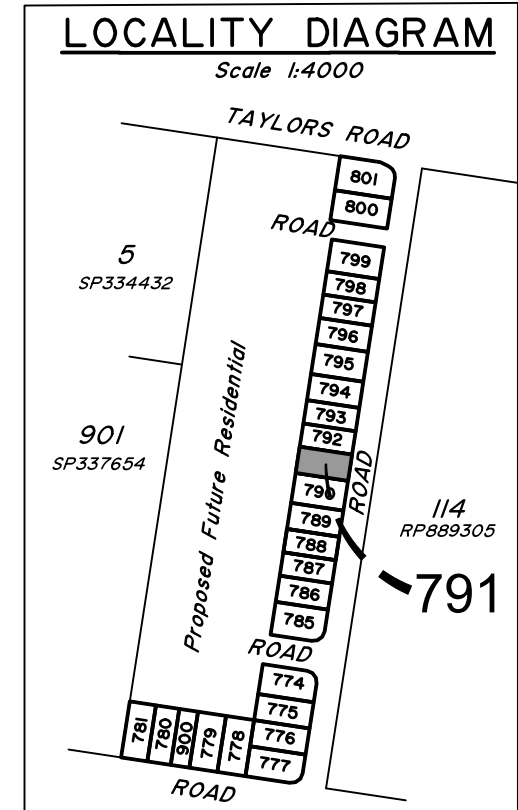

Gibbs STAGE 1
For
ID_Land

IMPORTANT NOTES:
(These notes are an integral part of this plan)
This plan has been prepared for ID_Land for the purposes of A Disclosure Plan Under the Land Sales Act 1984 (as amended). It is not to be used by any other person or corporation or for any other purposes and is subject to the following limitations:

Please refer to the approved Development Application for conditions relating to the LOT and to approved Operational Works drawings for services location and possible easements.

THESE DESIGNS AND DRAWINGS ARE COPYRIGHT AND ARE NOT TO BE USED OR REPRODUCED WITHOUT THE WRITTEN PERMISSION OF VERIS

Data Sources
Cadastral Boundaries 401905-LC01-WJ.dwg
Retaining Walls Gibbs Stg-1 RT WALLS.dwg
Final Surface Contours Gibbs Stg-1 DESN SURFACE.dwg
Depth of Fill Gibbs Stg-1 FILL DEPTH CONT.dwg
Gibbs Stg-1 CUT FILL.dwg

Issue	Revisions	Date	Drawn
B	Amend adjpiners	8.05.2023	DMC
A	Original	24.03.2023	GJF

Locality: WALLOON
 Local Authority: Ipswich City Council
 Horizontal Meridian: MGA Zone 56
 Vertical Level Datum: AHD
 Scale: 1:250 @ A4
 Designed: *
 Drawn: GJF 24/03/2023
 Checked: DMC
 Plot Date: 09 May, 2023
 Comp File Ref: 401905-01-DP01(B).dwg

DISCLOSURE PLAN
of Proposed LOT 791
currently being part of
Lot 6 on RP121124



veris

BRISBANE (07) 3686 4700 WHITSUNDAYS (07) 4945 6600
 MACKAY (07) 4957 9700 CAIRNS (07) 4252 9400

veris.com.au
 ACN 615 735 727
 Veris Australia Pty Ltd



LEGEND

Final surface contours based on A.H.D. datum at an interval of 0.25m, shown as: $\text{---} / 5.5 \text{---}$

Where applicable, areas to be filled are shown as:

Depth of fill, in metres, shown as:- $+ [L]$

Retaining wall and retaining wall height, shown on the lower side of the wall, have been taken from plans supplied by Calibre Group and shown as: $\text{---} (1.2) \text{---}$

ADDITIONAL NOTES:

The LOT dimensions and area shown hereon are subject to final field survey and also to the requirements of Council and any other authority which may have requirements under any relevant legislation

Final surface contours shown hereon have been supplied by Calibre Group.

Compaction of any fill material placed on this site shall be completed to level one inspection and testing services in accordance with AS3798-2007.

Copyright © Veris Australia Pty Ltd 15/03/2022.

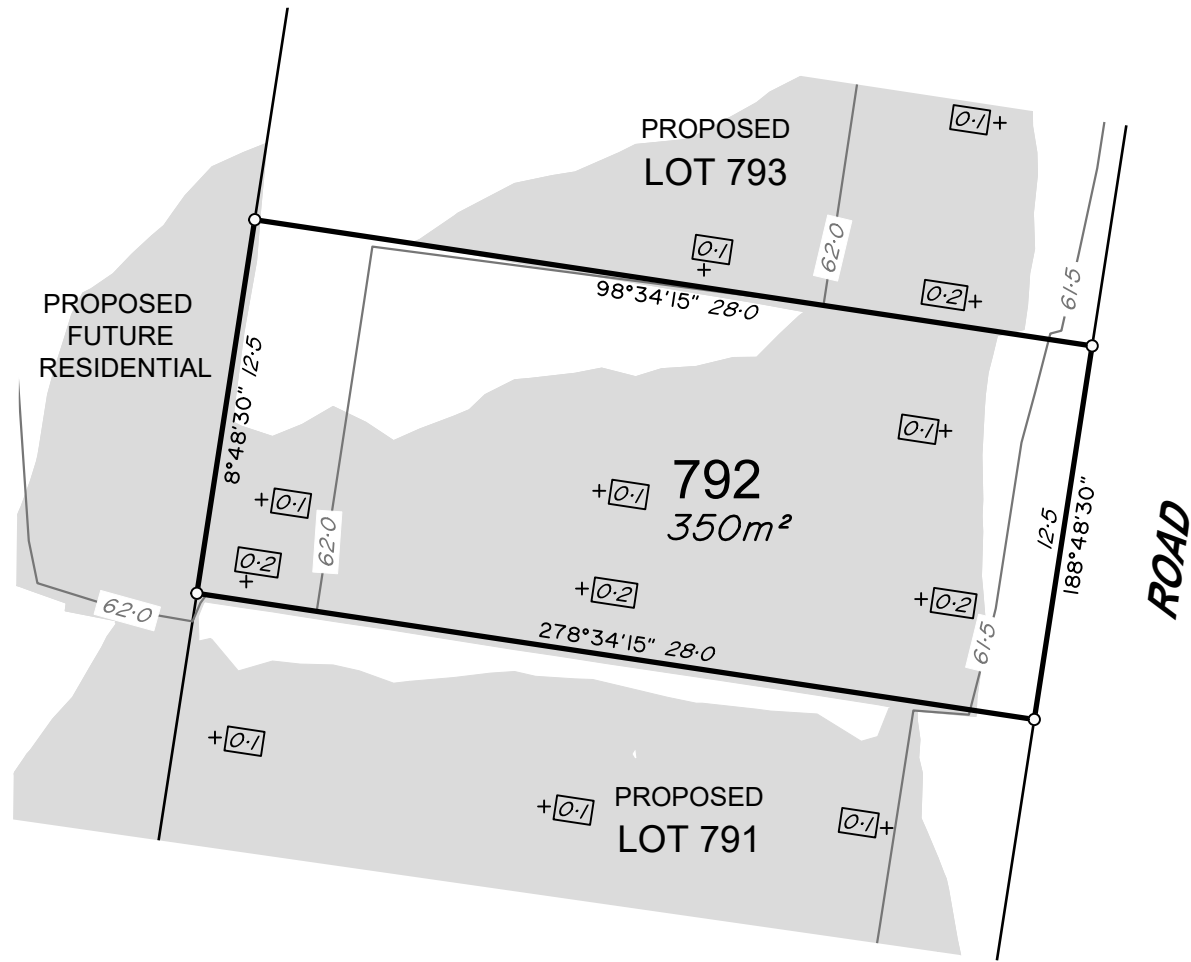
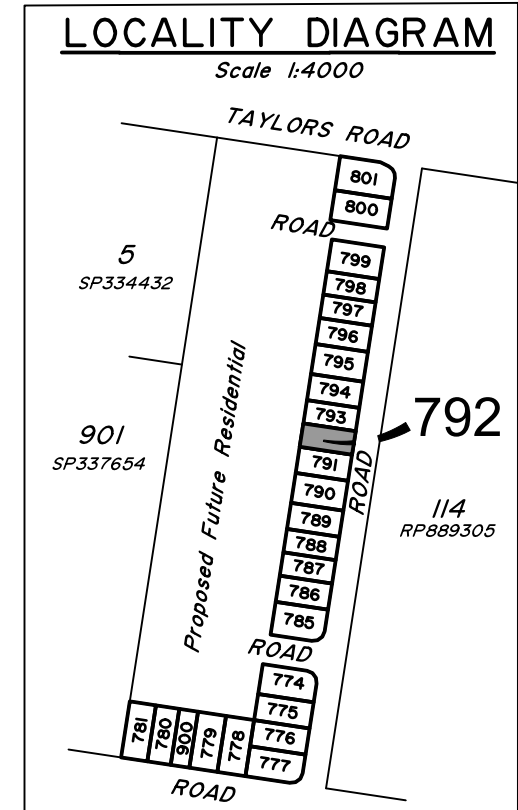

Gibbs STAGE 1
For
ID_Land

IMPORTANT NOTES:
(These notes are an integral part of this plan)
This plan has been prepared for ID_Land for the purposes of A Disclosure Plan Under the Land Sales Act 1984 (as amended). It is not to be used by any other person or corporation or for any other purposes and is subject to the following limitations:

Please refer to the approved Development Application for conditions relating to the LOT and to approved Operational Works drawings for services location and possible easements.

THESE DESIGNS AND DRAWINGS ARE COPYRIGHT AND ARE NOT TO BE USED OR REPRODUCED WITHOUT THE WRITTEN PERMISSION OF VERIS

Data Sources
Cadastral Boundaries 401905-LC01-WJ.dwg
Retaining Walls Gibbs Stg-1 RT WALLS.dwg
Final Surface Contours Gibbs Stg-1 DESN SURFACE.dwg
Depth of Fill Gibbs Stg-1 FILL DEPTH CONT.dwg
Gibbs Stg-1 CUT FILL.dwg

Issue	Revisions	Date	Drawn
B	Amend adjpiners	05.05.2023	DMC
A	Original	24.03.2023	GJF

Locality: WALLOON
 Local Authority: Ipswich City Council
 Horizontal Meridian: MGA Zone 56
 Vertical Level Datum: AHD
 Scale: 1:250 @ A4
 Designed: *
 Drawn: GJF 24/03/2023
 Checked: DMC
 Plot Date: 09 May, 2023
 Comp File Ref: 401905-01-DP01(B).dwg

DISCLOSURE PLAN
of Proposed LOT 792
currently being part of
Lot 6 on RP121124



BRISBANE (07) 3686 4700 WHITSUNDAYS (07) 4945 6600
 MACKAY (07) 4957 9700 CAIRNS (07) 4252 9400
 veris.com.au
 ACN 615 735 727
 Veris Australia Pty Ltd



LEGEND

Final surface contours based on A.H.D. datum at an interval of 0.25m, shown as: 15.5

Where applicable, areas to be filled are shown as:

Depth of fill, in metres, shown as:- +[L]

Retaining wall and retaining wall height, shown on the lower side of the wall, have been taken from plans supplied by Calibre Group and shown as: (1.2)

ADDITIONAL NOTES:

The LOT dimensions and area shown hereon are subject to final field survey and also to the requirements of Council and any other authority which may have requirements under any relevant legislation

Final surface contours shown hereon have been supplied by Calibre Group.

Compaction of any fill material placed on this site shall be completed to level one inspection and testing services in accordance with AS3798-2007.

Copyright © Veris Australia Pty Ltd 15/03/2022.

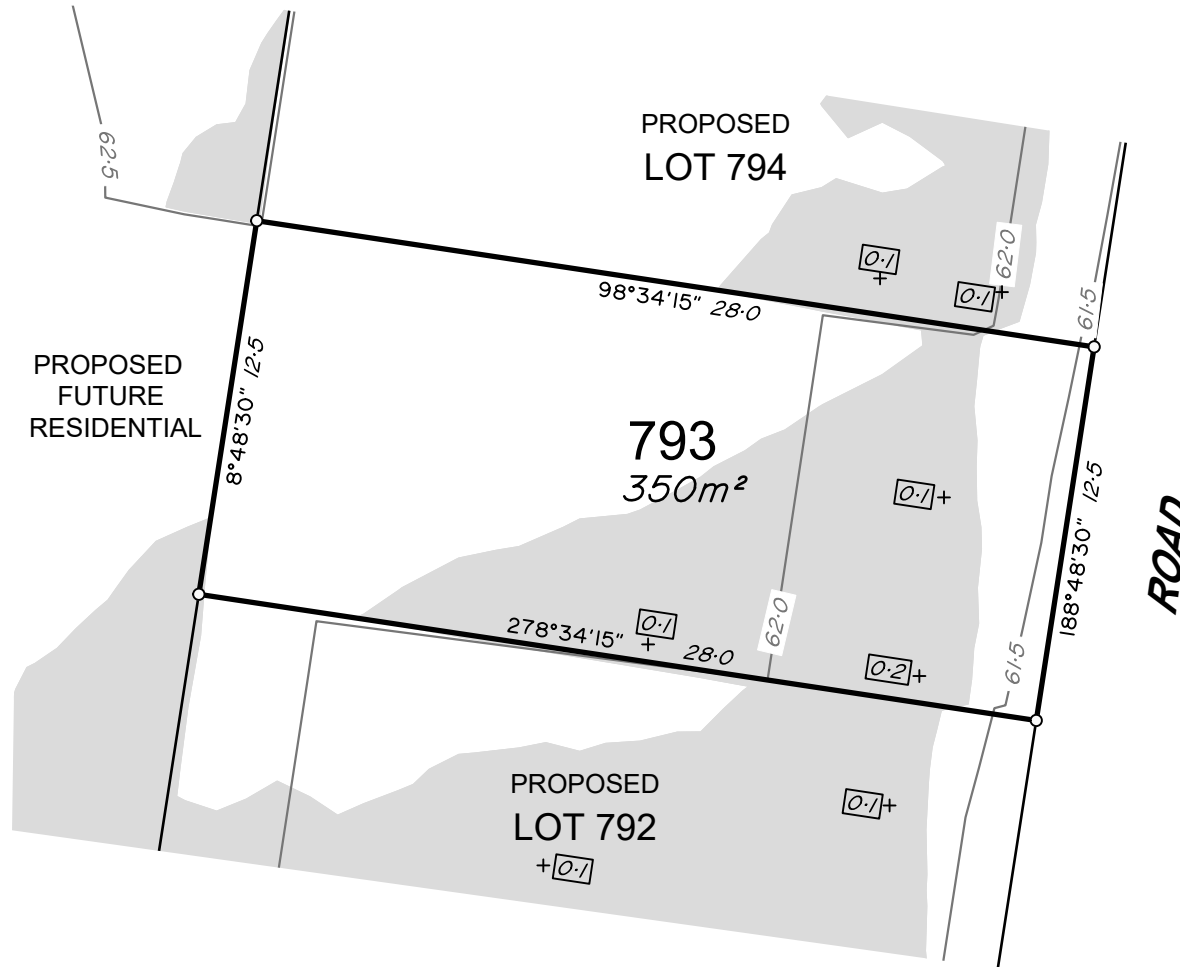
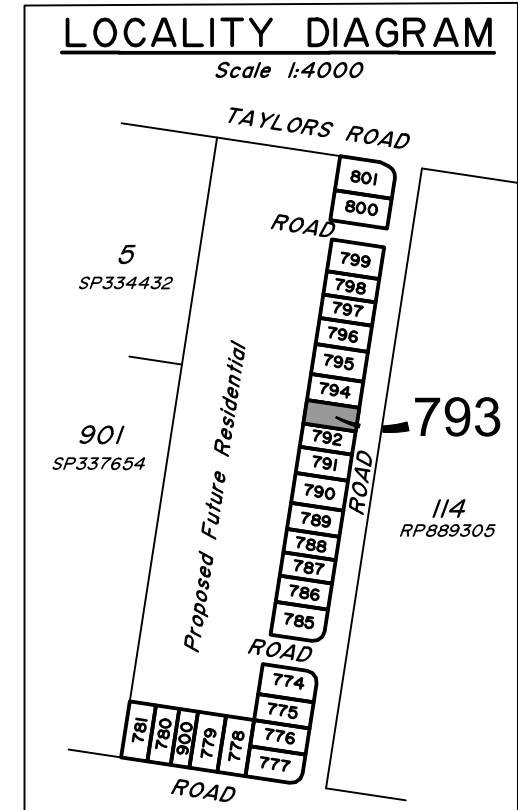

Gibbs STAGE 1
For
ID_Land

IMPORTANT NOTES:
(These notes are an integral part of this plan)
This plan has been prepared for ID_Land for the purposes of A Disclosure Plan Under the Land Sales Act 1984 (as amended). It is not to be used by any other person or corporation or for any other purposes and is subject to the following limitations:

Please refer to the approved Development Application for conditions relating to the LOT and to approved Operational Works drawings for services location and possible easements.

THESE DESIGNS AND DRAWINGS ARE COPYRIGHT AND ARE NOT TO BE USED OR REPRODUCED WITHOUT THE WRITTEN PERMISSION OF VERIS

Data Sources
Cadastral Boundaries 401905-LC01-W.dwg
Retaining Walls Gibbs Stg-1 RT WALLS.dwg
Final Surface Contours Gibbs Stg-1 DESN SURFACE.dwg
Depth of Fill Gibbs Stg-1 FILL DEPTH CONT.dwg
Gibbs Stg-1 CUT FILL.dwg

Issue	Revisions	Date	Drawn
B	Amend adjoiners	05.05.2023	DMC
A	Original	24.03.2023	GJF

Locality: WALLOON
 Local Authority: Ipswich City Council
 Horizontal Meridian: MGA Zone 56
 Horizontal Level Datum: AHD
 Scale: 1:250 @ A4
 Designed: *
 Drawn: GJF 24/03/2023
 Checked: DMC
 Plot Date: 09 May, 2023
 Comp File Ref: 401905-01-DP01(B).dwg

DISCLOSURE PLAN
of Proposed LOT 793
currently being part of
Lot 6 on RP121124



BRISBANE (07) 3686 4700 WHITSUNDAYS (07) 4945 6600
 MACKAY (07) 4957 9700 CAIRNS (07) 4252 9400
 veris.com.au
 ACN 615 735 727
 Veris Australia Pty Ltd



LEGEND

Final surface contours based on A.H.D. datum at an interval of 0.25m, shown as: 15.5

Where applicable, areas to be filled are shown as:

Depth of fill, in metres, shown as:- +[L]

Retaining wall and retaining wall height, shown on the lower side of the wall, have been taken from plans supplied by Calibre Group and shown as:

(1.2)

ADDITIONAL NOTES:

The LOT dimensions and area shown hereon are subject to final field survey and also to the requirements of Council and any other authority which may have requirements under any relevant legislation

Final surface contours shown hereon have been supplied by Calibre Group.

Compaction of any fill material placed on this site shall be completed to level one inspection and testing services in accordance with AS3798-2007.

Copyright © Veris Australia Pty Ltd 15/03/2022.

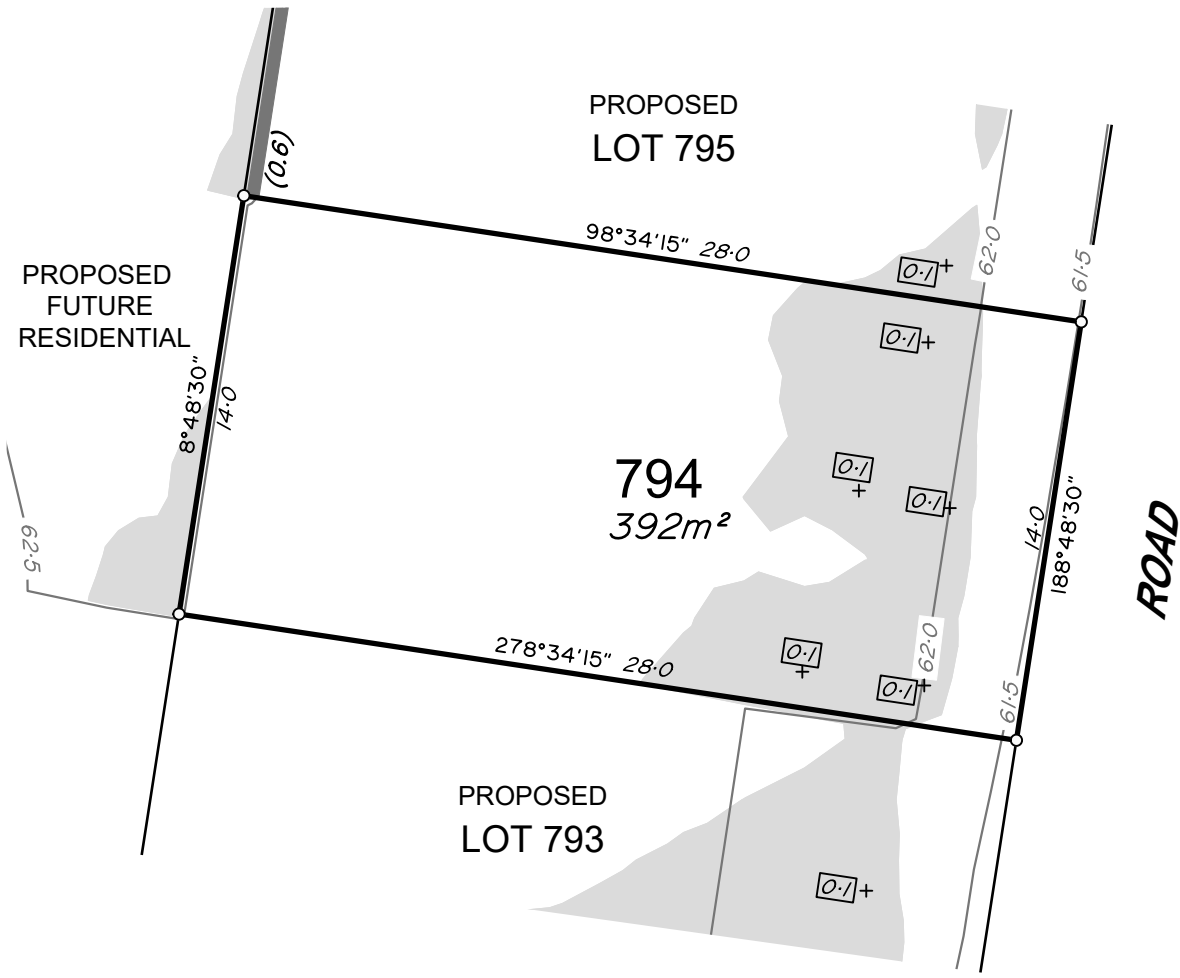
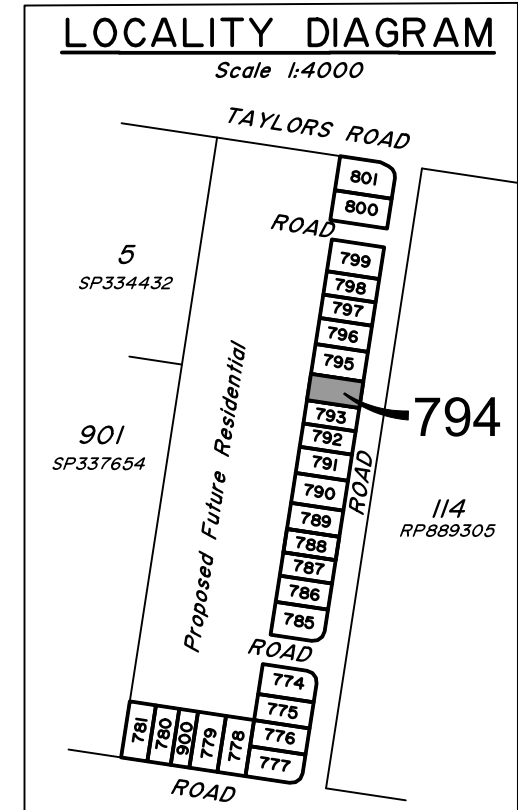

Gibbs STAGE 1
For
ID_Land

IMPORTANT NOTES:
(These notes are an integral part of this plan)
This plan has been prepared for ID_Land for the purposes of A Disclosure Plan Under the Land Sales Act 1984 (as amended). It is not to be used by any other person or corporation or for any other purposes and is subject to the following limitations:

Please refer to the approved Development Application for conditions relating to the LOT and to approved Operational Works drawings for services location and possible easements.

THESE DESIGNS AND DRAWINGS ARE COPYRIGHT AND ARE NOT TO BE USED OR REPRODUCED WITHOUT THE WRITTEN PERMISSION OF VERIS

Data Sources
Cadastral Boundaries
401905-LC01-WJ.dwg
Retaining Walls
Gibbs Stg-1 RT WALLS.dwg
Final Surface Contours
Gibbs Stg-1 DESN SURFACE.dwg
Depth of Fill
Gibbs Stg-1 FILL DEPTH CONT.dwg
Gibbs Stg-1 CUT FILL.dwg

Issue	Revisions	Date	Drawn
B	Amend adjoiners	05.05.2023	DMC
A	Original	24.03.2023	GJF

Locality: WALLOON
Local Authority: Ipswich City Council
Horizontal Meridian: MGA Zone 56
Vertical Level Datum: AHD
Scale: 1:250 @ A4
Designed: *
Drawn: GJF 24/03/2023
Checked: DMC
Plot Date: 09 May, 2023
Comp File Ref: 401905-01-DP01(B).dwg

DISCLOSURE PLAN
of Proposed LOT 794
currently being part of
Lot 6 on RP121124



veris
BRISBANE (07) 3686 4700 WHITSUNDAYS (07) 4945 6600
MACKAY (07) 4957 9700 CAIRNS (07) 4252 9400
veris.com.au
ACN 615 735 727
Veris Australia Pty Ltd





LEGEND

Final surface contours based on A.H.D. datum at an interval of 0.25m, shown as: $\text{---} / 5.5 \text{---}$

Where applicable, areas to be filled are shown as:

Depth of fill, in metres, shown as: $\text{+} [L] \text{+}$

Retaining wall and retaining wall height, shown on the lower side of the wall, have been taken from plans supplied by Calibre Group and shown as: $\text{---} (1.2) \text{---}$

ADDITIONAL NOTES:

The LOT dimensions and area shown hereon are subject to final field survey and also to the requirements of Council and any other authority which may have requirements under any relevant legislation

Final surface contours shown hereon have been supplied by Calibre Group.

Compaction of any fill material placed on this site shall be completed to level one inspection and testing services in accordance with AS3798-2007.

Copyright © Veris Australia Pty Ltd 15/03/2022.

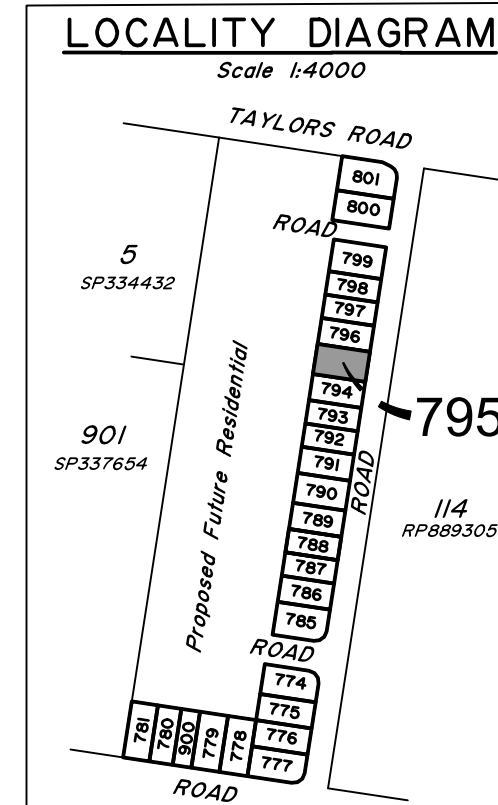
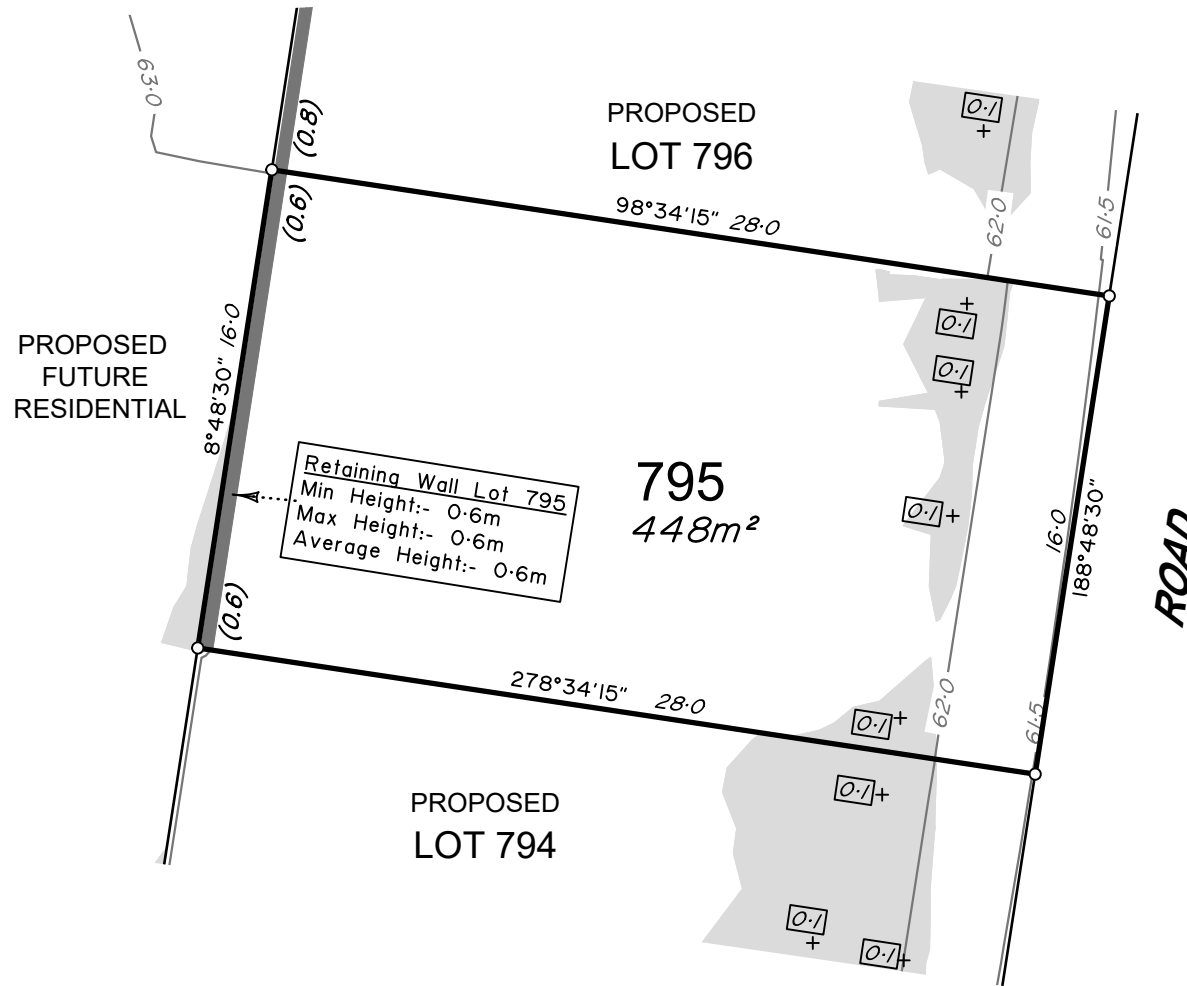

dawn.
WALLOON

Gibbs STAGE 1
For
ID_Land

IMPORTANT NOTES:
(These notes are an integral part of this plan)
This plan has been prepared for ID_Land for the purposes of A Disclosure Plan Under the Land Sales Act 1984 (as amended). It is not to be used by any other person or corporation or for any other purposes and is subject to the following limitations:

Please refer to the approved Development Application for conditions relating to the LOT and to approved Operational Works drawings for services location and possible easements.

THESE DESIGNS AND DRAWINGS ARE COPYRIGHT AND ARE NOT TO BE USED OR REPRODUCED WITHOUT THE WRITTEN PERMISSION OF VERIS

Data Sources
Cadastral Boundaries
401905-LC01-W.dwg
Retaining Walls
Gibbs Stg-1 RT WALLS.dwg
Final Surface Contours
Gibbs Stg-1 DESN SURFACE.dwg
Depth of Fill
Gibbs Stg-1 FILL DEPTH CONT.dwg
Gibbs Stg-1 CUT FILL.dwg

Issue	Revisions	Date	Drawn
B	Amend adjoining	05.05.2023	DMC
A	Original	24.03.2023	GJF

Locality: WALLOON
Local Authority: Ipswich City Council
Horizontal Meridian: MGA Zone 56
Vertical Level Datum: AHD
Scale: 1:250 @ A4
Designed: *
Drawn: GJF 24/03/2023
Checked: DMC
Plot Date: 09 May, 2023
Comp File Ref: 401905-01-DP01(B).dwg

DISCLOSURE PLAN
of Proposed LOT 795
currently being part of
Lot 6 on RP121124



veris

BRISBANE (07) 3686 4700 WHITSUNDAYS (07) 4945 6600

MACKAY (07) 4957 9700 CAIRNS (07) 4252 9400

veris.com.au
ACN 615 735 727
Veris Australia Pty Ltd

Drawing No
401905-01-DP-795
Issue
B



LEGEND

Final surface contours based on A.H.D. datum at an interval of 0.25m, shown as: $\text{---} / 5.5 \text{---}$

Where applicable, areas to be filled are shown as:

Depth of fill, in metres, shown as:- $+ [L]$

Retaining wall and retaining wall height, shown on the lower side of the wall, have been taken from plans supplied by Calibre Group and shown as:

(1.2)

ADDITIONAL NOTES:

The LOT dimensions and area shown hereon are subject to final field survey and also to the requirements of Council and any other authority which may have requirements under any relevant legislation

Final surface contours shown hereon have been supplied by Calibre Group.

Compaction of any fill material placed on this site shall be completed to level one inspection and testing services in accordance with AS3798-2007.

Copyright © Veris Australia Pty Ltd 15/03/2022.

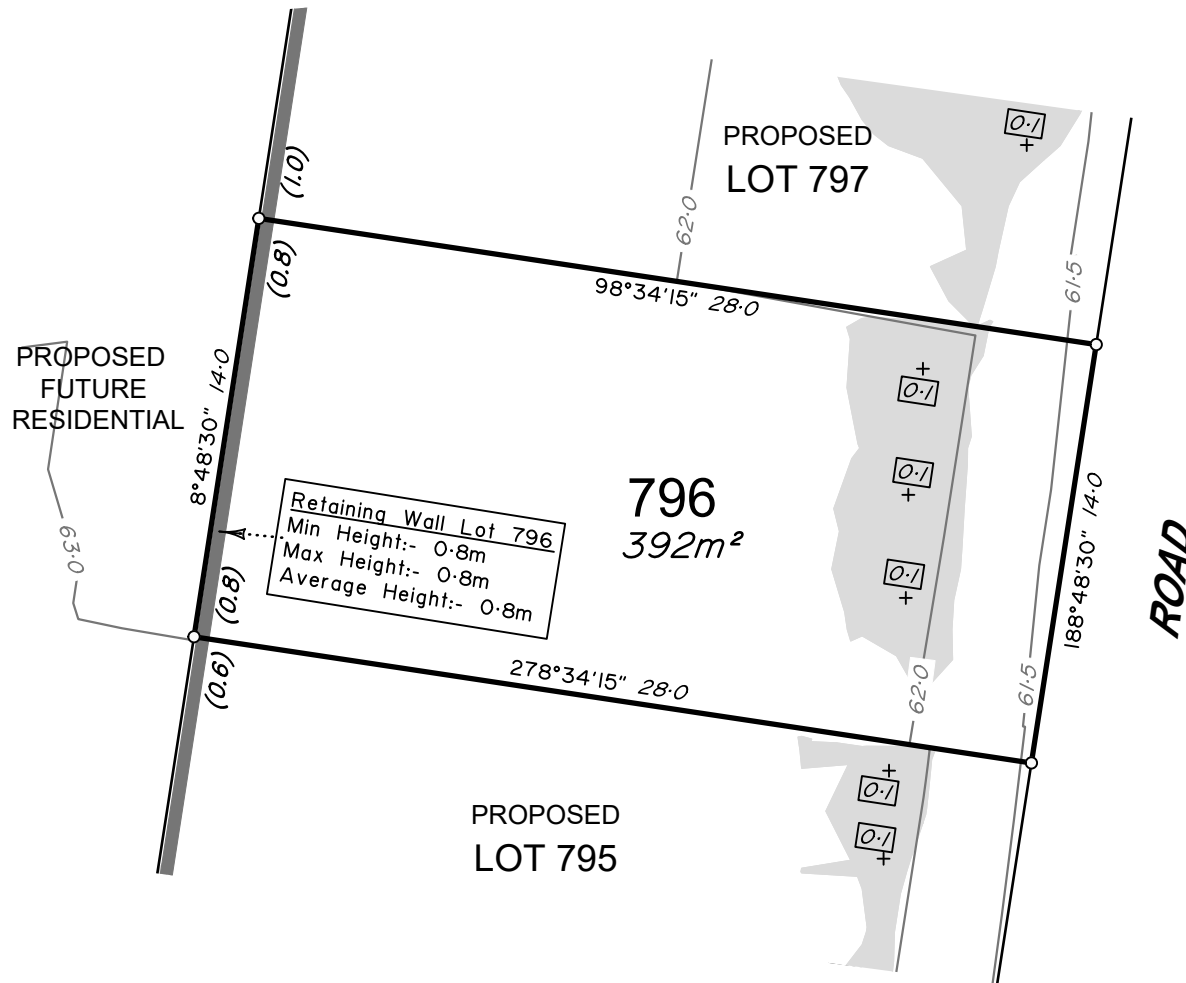
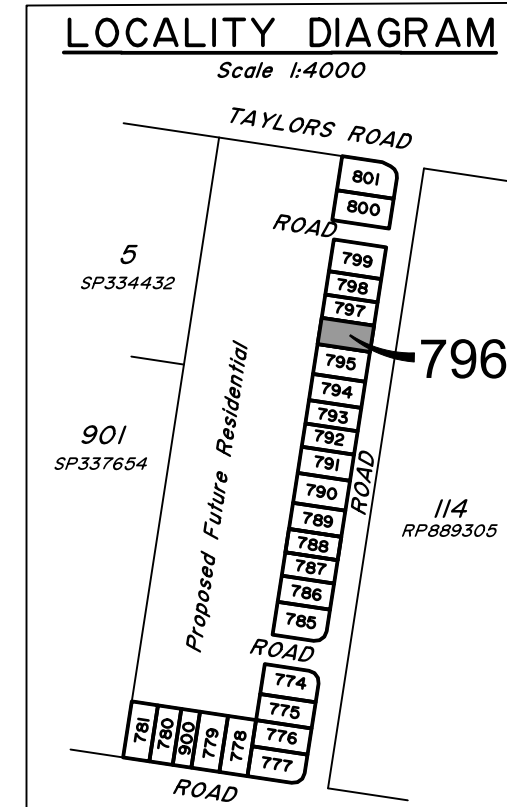

dawn.
WALLOON

Gibbs STAGE 1
For
ID_Land

IMPORTANT NOTES:
 (These notes are an integral part of this plan)
 This plan has been prepared for ID_Land for the purposes of A Disclosure Plan Under the Land Sales Act 1984 (as amended). It is not to be used by any other person or corporation or for any other purposes and is subject to the following limitations:

Please refer to the approved Development Application for conditions relating to the LOT and to approved Operational Works drawings for services location and possible easements.

THESE DESIGNS AND DRAWINGS ARE COPYRIGHT AND ARE NOT TO BE USED OR REPRODUCED WITHOUT THE WRITTEN PERMISSION OF VERIS

Data Sources

Cadastral Boundaries
 401905-LC01-1W.dwg
 Retaining Walls
 Gibbs Stg-1 RT WALLS.dwg
 Final Surface Contours
 Gibbs Stg-1 DESN SURFACE.dwg
 Depth of Fill
 Gibbs Stg-1 FILL DEPTH CONT.dwg
 Gibbs Stg-1 CUT FILL.dwg

Issue	Revisions	Date	Drawn
B	Amend adjoiners	8.05.2023	DMC
A	Original	24.03.2023	GJF

Locality: WALLOON
 Local Authority: Ipswich City Council
 Horizontal Meridian: MGA Zone 56
 Vertical Level Datum: AHD
 Scale: 1:250 @ A4
 Designed: *
 Drawn: GJF 24/03/2023
 Checked: DMC
 Plot Date: 09 May, 2023
 Comp File Ref: 401905-01-DP01(B).dwg

DISCLOSURE PLAN
 of Proposed LOT 796
 currently being part of
 Lot 6 on RP121124



veris

BRISBANE (07) 3686 4700 WHITSUNDAYS (07) 4945 6600

MACKAY (07) 4957 9700 CAIRNS (07) 4252 9400

veris.com.au
 ACN 615 735 727
 Veris Australia Pty Ltd

Drawing No 401905-01-DP-796 Issue B





LEGEND

Final surface contours based on A.H.D. datum at an interval of 0.25m, shown as: $\text{---} / 5.5 \text{---}$

Where applicable, areas to be filled are shown as:

Depth of fill, in metres, shown as:- $\text{+} [L/]$

Retaining wall and retaining wall height, shown on the lower side of the wall, have been taken from plans supplied by Calibre Group and shown as: $\text{---} (1.2) \text{---}$

ADDITIONAL NOTES:

The LOT dimensions and area shown hereon are subject to final field survey and also to the requirements of Council and any other authority which may have requirements under any relevant legislation

Final surface contours shown hereon have been supplied by Calibre Group.

Compaction of any fill material placed on this site shall be completed to level one inspection and testing services in accordance with AS3798-2007.

Copyright © Veris Australia Pty Ltd 15/03/2022.

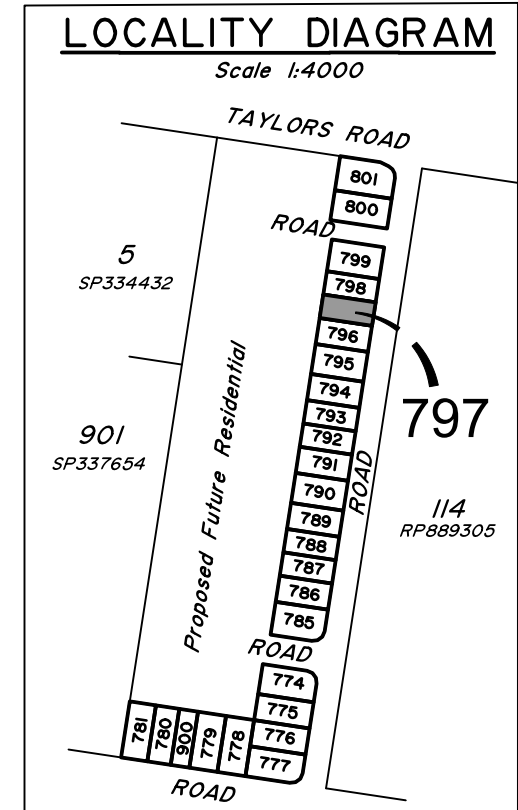
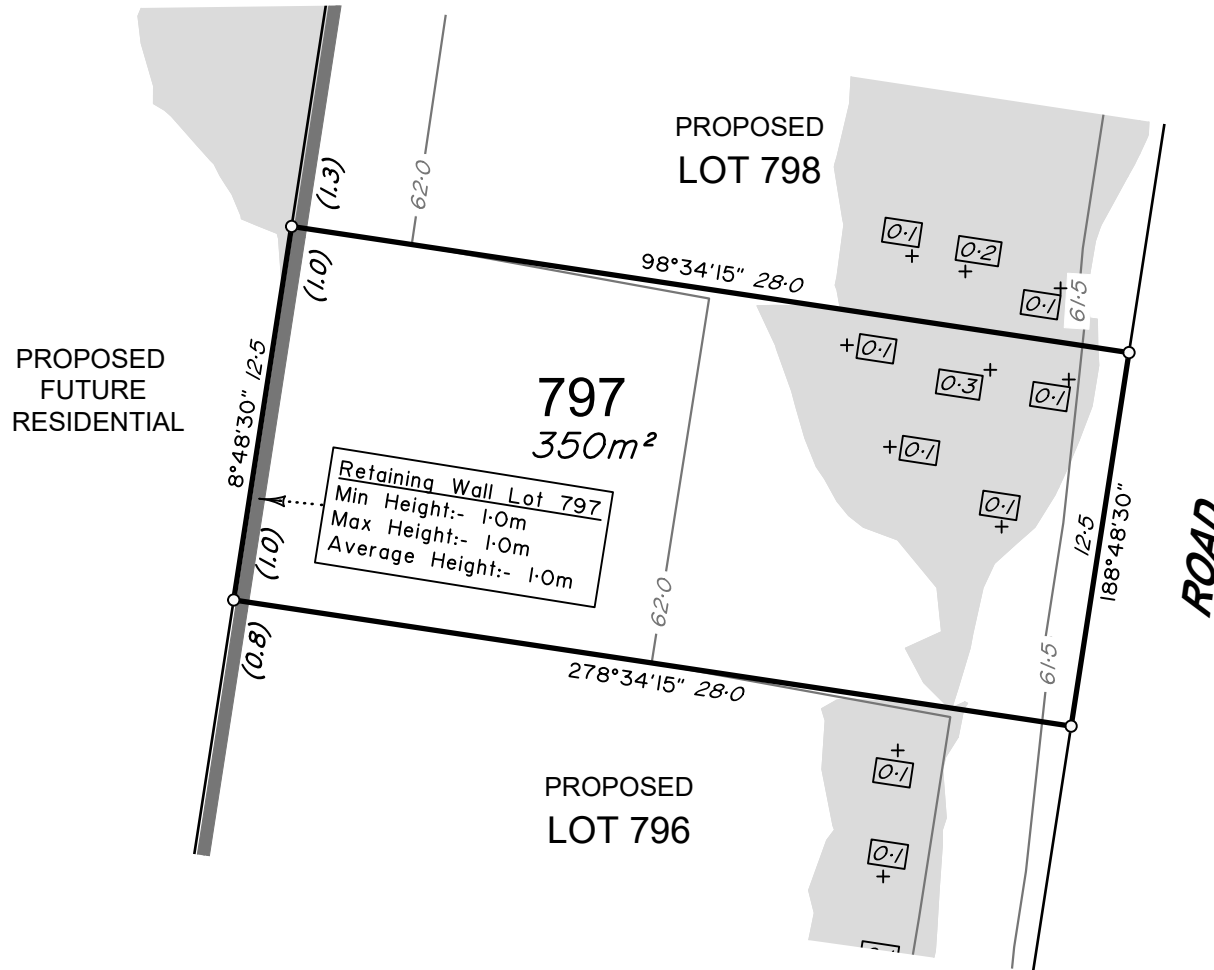

Gibbs STAGE 1
For
ID_Land

IMPORTANT NOTES:
(These notes are an integral part of this plan)
This plan has been prepared for ID_Land for the purposes of A Disclosure Plan Under the Land Sales Act 1984 (as amended). It is not to be used by any other person or corporation or for any other purposes and is subject to the following limitations:

Please refer to the approved Development Application for conditions relating to the LOT and to approved Operational Works drawings for services location and possible easements.

THESE DESIGNS AND DRAWINGS ARE COPYRIGHT AND ARE NOT TO BE USED OR REPRODUCED WITHOUT THE WRITTEN PERMISSION OF VERIS

Data Sources
Cadastral Boundaries
401905-LC01-WJ.dwg
Retaining Walls
Gibbs Stg-1 RT WALLS.dwg
Final Surface Contours
Gibbs Stg-1 DESN SURFACE.dwg
Depth of Fill
Gibbs Stg-1 FILL DEPTH CONT.dwg
Gibbs Stg-1 CUT FILL.dwg

Issue	Revisions	Date	Drawn
B	Amend adjpiners	8.05.2023	DMC
A	Original	24.03.2023	GJF

Locality:
WALLOON
Local Authority:
Ipswich City Council
Horizontal Meridian:
MGA Zone 56
Vertical Level Datum:
AHD
Scale:
1:250 @ A4
Designed:
*
Drawn:
GJF 24/03/2023
Checked:
DMC
Plot Date:
09 May, 2023
Comp File Ref:
401905-01-DP01(B).dwg

DISCLOSURE PLAN
of Proposed LOT 797
currently being part of
Lot 6 on RP121124



BRISBANE (07) 3686 4700 WHITSUNDAYS (07) 4945 6600
MACKAY (07) 4957 9700 CAIRNS (07) 4252 9400
veris.com.au
ACN 615 735 727
Veris Australia Pty Ltd



LEGEND

Final surface contours based on A.H.D. datum at an interval of 0.25m, shown as: $\text{---} / 5.5 \text{---}$

Where applicable, areas to be filled are shown as:

Depth of fill, in metres, shown as:- $\text{+} [L]$

Retaining wall and retaining wall height, shown on the lower side of the wall, have been taken from plans supplied by Calibre Group and shown as: $\text{---} (1.2) \text{---}$

ADDITIONAL NOTES:

The LOT dimensions and area shown hereon are subject to final field survey and also to the requirements of Council and any other authority which may have requirements under any relevant legislation

Final surface contours shown hereon have been supplied by Calibre Group.

Compaction of any fill material placed on this site shall be completed to level one inspection and testing services in accordance with AS3798-2007.

Copyright © Veris Australia Pty Ltd 15/03/2022.

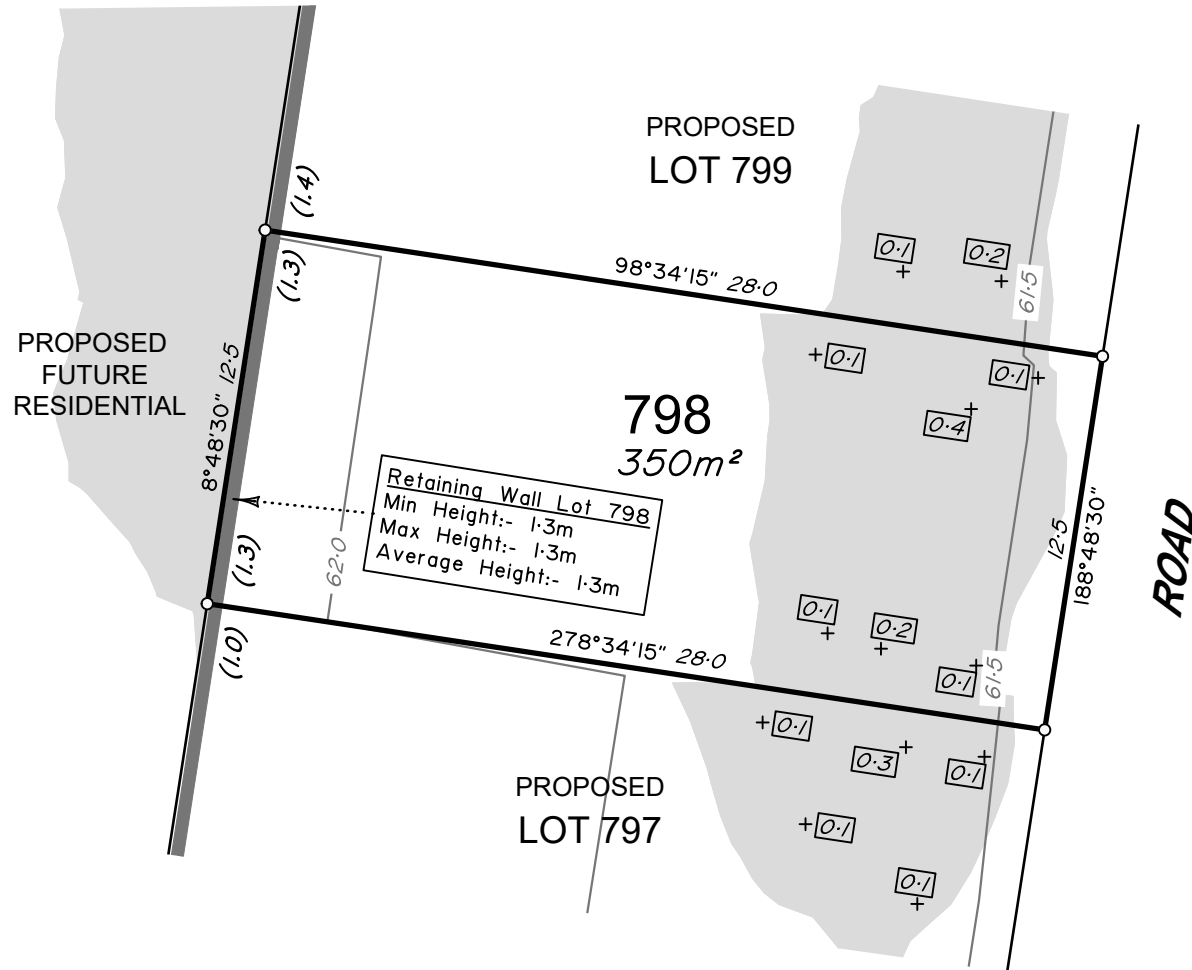
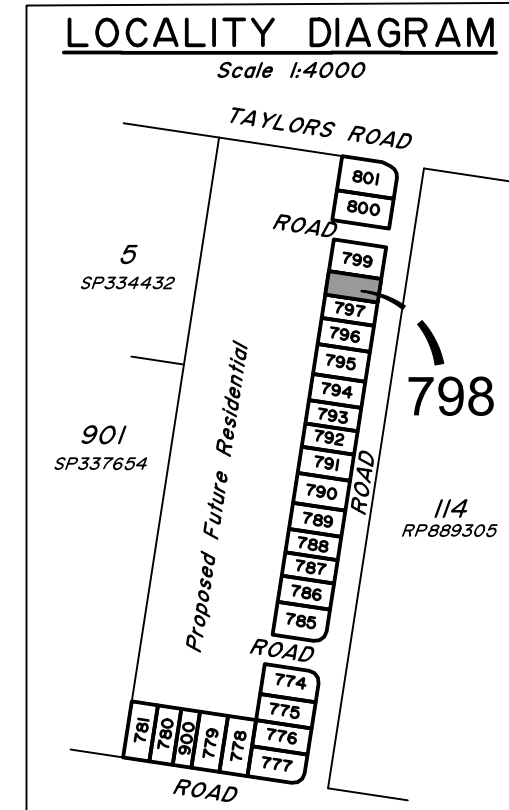

Gibbs STAGE 1
For
ID_Land

IMPORTANT NOTES:
(These notes are an integral part of this plan)
This plan has been prepared for ID_Land for the purposes of A Disclosure Plan Under the Land Sales Act 1984 (as amended). It is not to be used by any other person or corporation or for any other purposes and is subject to the following limitations:

Please refer to the approved Development Application for conditions relating to the LOT and to approved Operational Works drawings for services location and possible easements.

THESE DESIGNS AND DRAWINGS ARE COPYRIGHT AND ARE NOT TO BE USED OR REPRODUCED WITHOUT THE WRITTEN PERMISSION OF VERIS

Data Sources

- Cadastral Boundaries 401905-LC01-WJ.dwg
- Retaining Walls Gibbs Stg-1 RT WALLS.dwg
- Final Surface Contours Gibbs Stg-1 DESN SURFACE.dwg
- Depth of Fill Gibbs Stg-1 FILL DEPTH CONT.dwg
- Gibbs Stg-1 CUT FILL.dwg

Issue	Revisions	Date	Drawn
B	Amend adjoiners	05.05.2023	DMC
A	Original	24.03.2023	GJF

Locality: WALLOON
 Local Authority: Ipswich City Council
 Horizontal Meridian: MGA Zone 56
 Vertical Level Datum: AHD
 Scale: 1:250 @ A4
 Designed: *
 Drawn: GJF 24/03/2023
 Checked: DMC
 Plot Date: 09 May, 2023
 Comp File Ref: 401905-01-DP01(B).dwg

DISCLOSURE PLAN
of Proposed LOT 798
currently being part of
Lot 6 on RP121124



BRISBANE (07) 3686 4700 WHITSUNDAYS (07) 4945 6600
 MACKAY (07) 4957 9700 CAIRNS (07) 4252 9400
 veris.com.au
 ACN 615 735 727
 Veris Australia Pty Ltd





LEGEND

Final surface contours based on A.H.D. datum at an interval of 0.25m, shown as: $\text{---} / 5.5 \text{---}$

Where applicable, areas to be filled are shown as:

Depth of fill, in metres, shown as:- $\text{+}[L]$

Retaining wall and retaining wall height, shown on the lower side of the wall, have been taken from plans supplied by Calibre Group and shown as: $\text{---} (1.2) \text{---}$

ADDITIONAL NOTES:

The LOT dimensions and area shown hereon are subject to final field survey and also to the requirements of Council and any other authority which may have requirements under any relevant legislation

Final surface contours shown hereon have been supplied by Calibre Group.

Compaction of any fill material placed on this site shall be completed to level one inspection and testing services in accordance with AS3798-2007.

Copyright © Veris Australia Pty Ltd 15/03/2022.

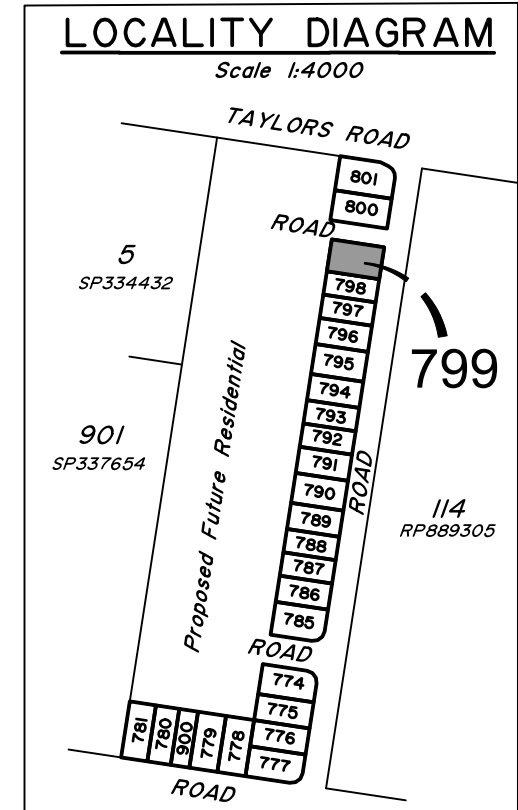
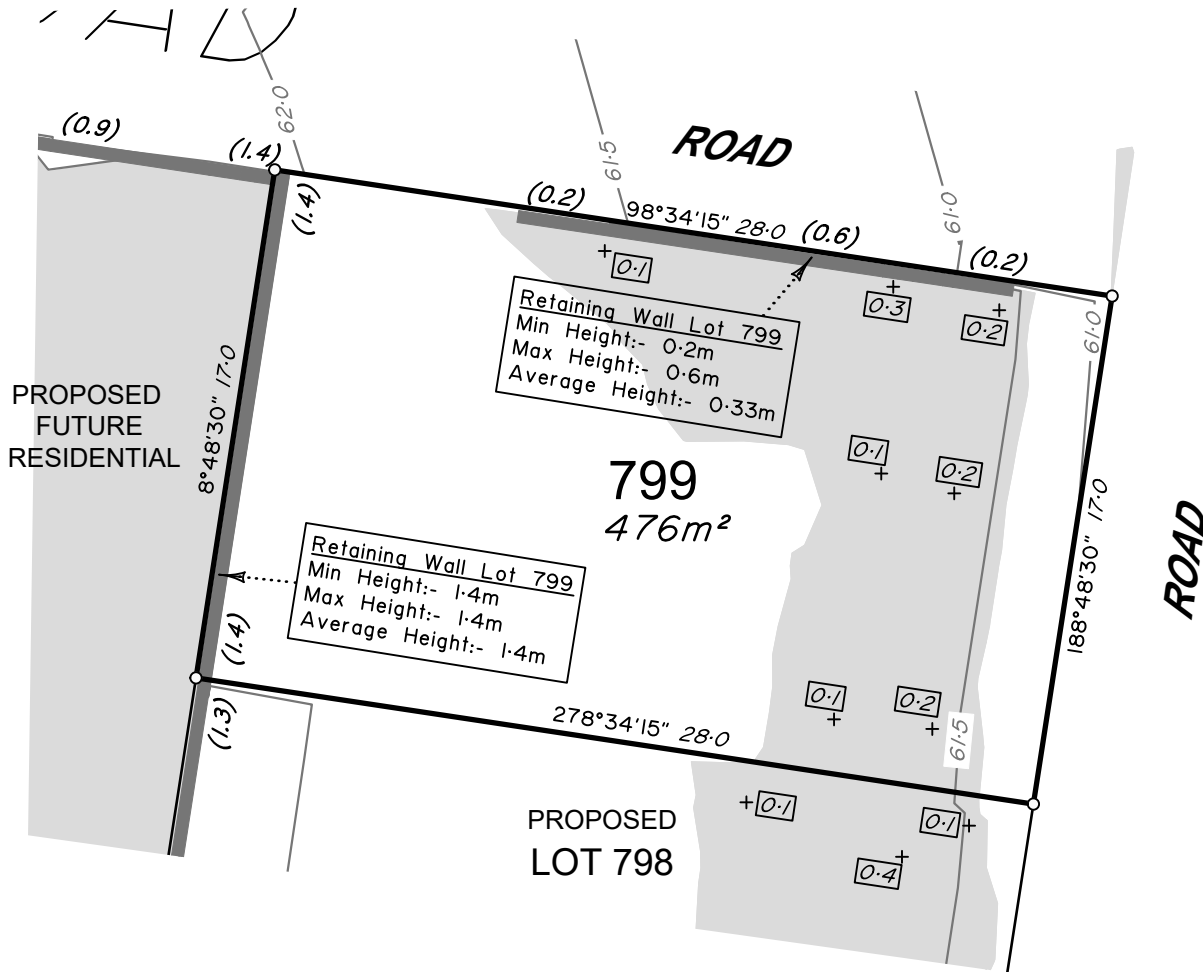

Gibbs STAGE 1
For
ID_Land

IMPORTANT NOTES:
(These notes are an integral part of this plan)
This plan has been prepared for ID_Land for the purposes of A Disclosure Plan Under the Land Sales Act 1984 (as amended). It is not to be used by any other person or corporation or for any other purposes and is subject to the following limitations:

Please refer to the approved Development Application for conditions relating to the LOT and to approved Operational Works drawings for services location and possible easements.

THESE DESIGNS AND DRAWINGS ARE COPYRIGHT AND ARE NOT TO BE USED OR REPRODUCED WITHOUT THE WRITTEN PERMISSION OF VERIS

Data Sources
Cadastral Boundaries
401905-1-C01-1(W).dwg
Retaining Walls
Gibbs Stg-1 RT WALLS.dwg
Final Surface Contours
Gibbs Stg-1 DESN SURFACE.dwg
Depth of Fill
Gibbs Stg-1 FILL DEPTH CONT.dwg
Gibbs Stg-1 CUT FILL.dwg

Issue	Revisions	Date	Drawn
B	Amend adjpiners	05.05.2023	DMC
A	Original	24.03.2023	GJF

Locality: WALLOON
 Local Authority: Ipswich City Council
 Horizontal Meridian: MGA Zone 56
 Vertical Level Datum: AHD
 Scale: 1:250 @ A4
 Designed: *
 Drawn: GJF 24/03/2023
 Checked: DMC
 Plot Date: 09 May, 2023
 Comp File Ref: 401905-01-DP01(B).dwg

DISCLOSURE PLAN
of Proposed LOT 799
currently being part of
Lot 6 on RP121124



veris

BRISBANE (07) 3686 4700 WHITSUNDAYS (07) 4945 6600
 MACKAY (07) 4957 9700 CAIRNS (07) 4252 9400

veris.com.au
 ACN 615 735 727
 Veris Australia Pty Ltd





LEGEND

Final surface contours based on A.H.D. datum at an interval of 0.25m, shown as: $\text{---} / 5.5 \text{---}$

Where applicable, areas to be filled are shown as:

Depth of fill, in metres, shown as:- $\text{+} [L] \text{---}$

Retaining wall and retaining wall height, shown on the lower side of the wall, have been taken from plans supplied by Calibre Group and shown as: $\text{---} (1.2) \text{---}$

ADDITIONAL NOTES:

The LOT dimensions and area shown hereon are subject to final field survey and also to the requirements of Council and any other authority which may have requirements under any relevant legislation

Final surface contours shown hereon have been supplied by Calibre Group.

Compaction of any fill material placed on this site shall be completed to level one inspection and testing services in accordance with AS3798-2007.

Copyright © Veris Australia Pty Ltd 15/03/2022.

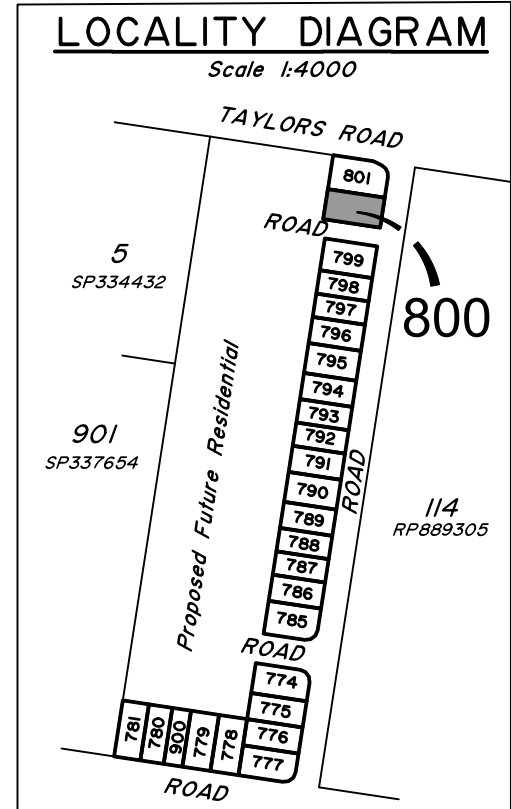
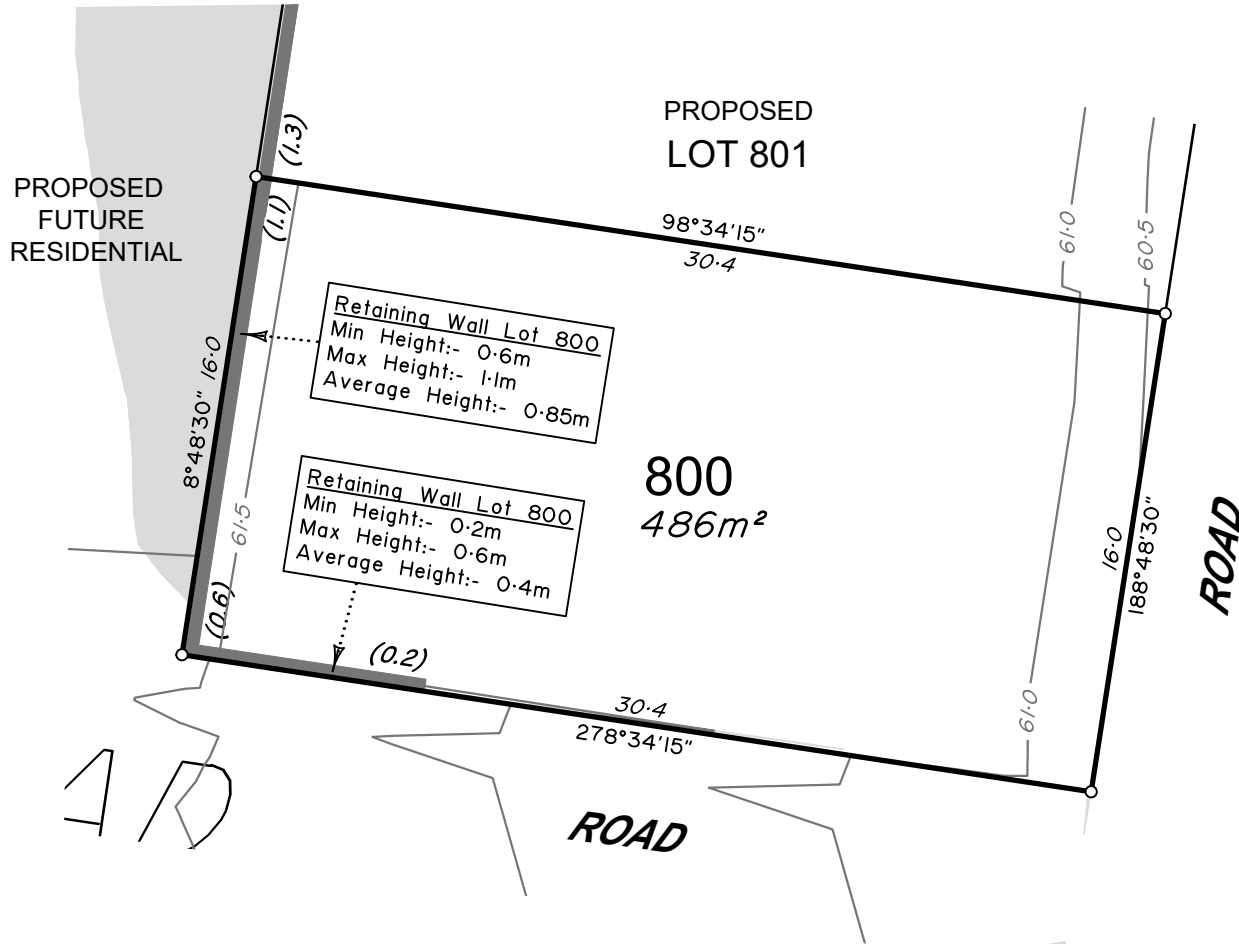

Gibbs STAGE 1
For
ID_Land

IMPORTANT NOTES:
(These notes are an integral part of this plan)
This plan has been prepared for ID_Land for the purposes of A Disclosure Plan Under the Land Sales Act 1984 (as amended). It is not to be used by any other person or corporation or for any other purposes and is subject to the following limitations:

Please refer to the approved Development Application for conditions relating to the LOT and to approved Operational Works drawings for services location and possible easements.

THESE DESIGNS AND DRAWINGS ARE COPYRIGHT AND ARE NOT TO BE USED OR REPRODUCED WITHOUT THE WRITTEN PERMISSION OF VERIS

Data Sources
Cadastral Boundaries
401905-LC01-WJ.dwg
Retaining Walls
Gibbs Stg-1 RT WALLS.dwg
Final Surface Contours
Gibbs Stg-1 DESN SURFACE.dwg
Depth of Fill
Gibbs Stg-1 FILL DEPTH CONT.dwg
Gibbs Stg-1 CUT FILL.dwg

Issue	Revisions	Date	Drawn
B	Amend adjoiners	05.05.2023	DMC
A	Original	24.03.2023	GJF

Locality: WALLOON
Local Authority: Ipswich City Council
Horizontal Meridian: MGA Zone 56
Vertical Level Datum: AHD
Scale: 1:250 @ A4
Designed: *
Drawn: GJF 24/03/2023
Checked: DMC
Plot Date: 09 May, 2023
Comp File Ref: 401905-01-DP01(B).dwg

DISCLOSURE PLAN
of Proposed LOT 800
currently being part of
Lot 6 on RP121124



BRISBANE (07) 3686 4700 WHITSUNDAYS (07) 4945 6600
MACKAY (07) 4957 9700 CAIRNS (07) 4252 9400
veris.com.au
ACN 615 735 727
Veris Australia Pty Ltd

Drawing No 401905-01-DP-800 Issue B





LEGEND

Final surface contours based on A.H.D. datum at an interval of 0.25m, shown as: $\text{---} / 5.5 \text{---}$

Where applicable, areas to be filled are shown as:

Depth of fill, in metres, shown as: $\text{+} [L/I]$

Retaining wall and retaining wall height, shown on the lower side of the wall, have been taken from plans supplied by Calibre Group and shown as: $\text{---} (1.2) \text{---}$

ADDITIONAL NOTES:

The LOT dimensions and area shown hereon are subject to final field survey and also to the requirements of Council and any other authority which may have requirements under any relevant legislation

Final surface contours shown hereon have been supplied by Calibre Group.

Compaction of any fill material placed on this site shall be completed to level one inspection and testing services in accordance with AS3798-2007.

Copyright © Veris Australia Pty Ltd 15/03/2022.

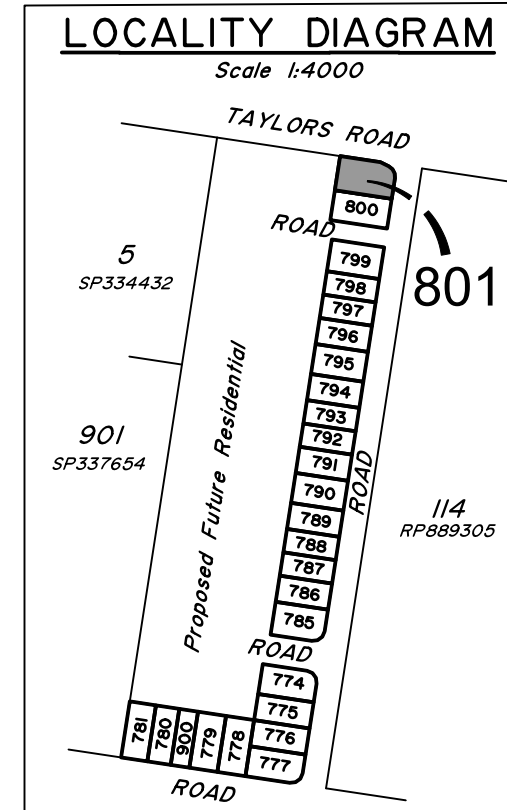
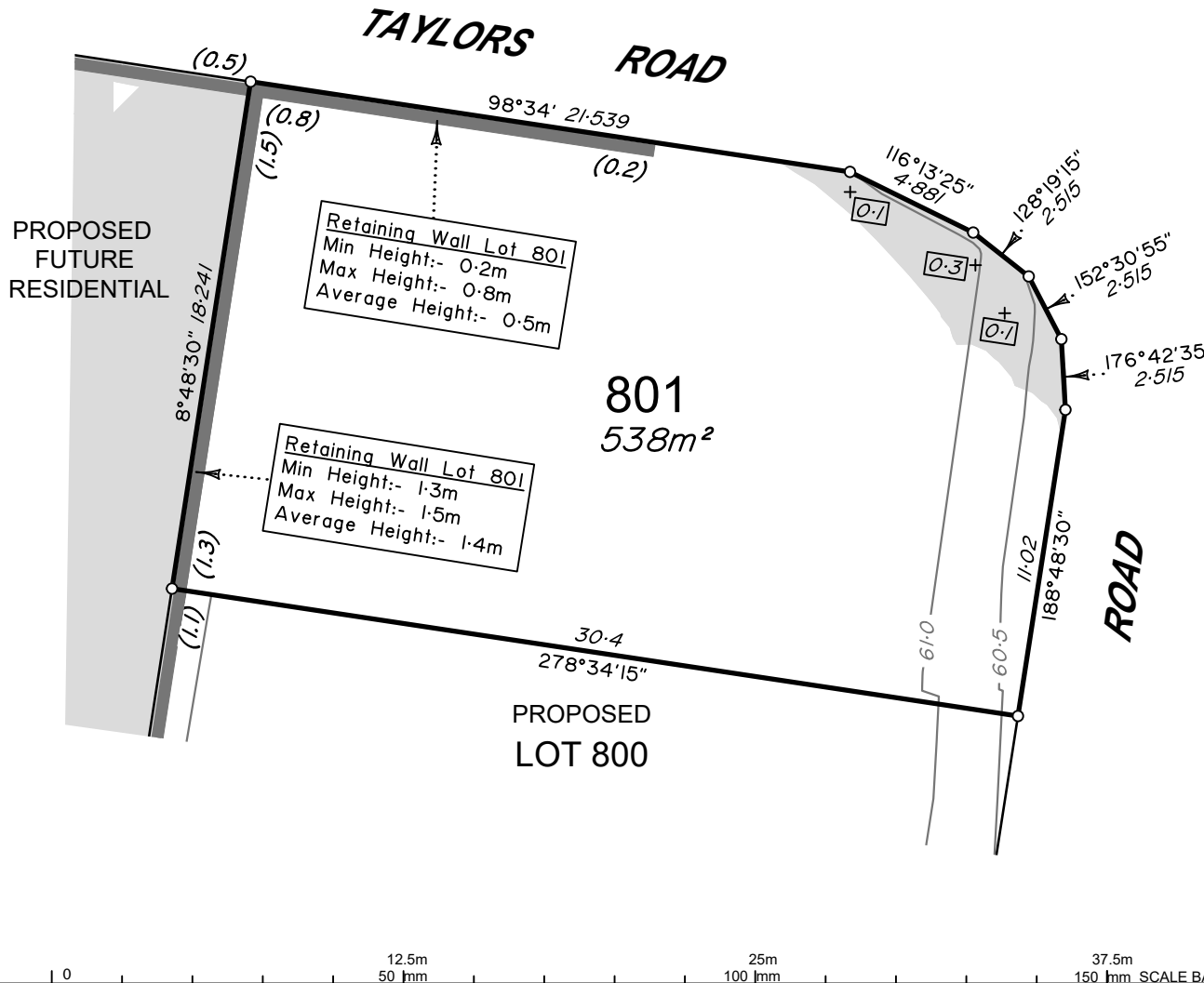

Gibbs STAGE 1
For
ID_Land

IMPORTANT NOTES:
(These notes are an integral part of this plan)
This plan has been prepared for ID_Land for the purposes of A Disclosure Plan Under the Land Sales Act 1984 (as amended). It is not to be used by any other person or corporation or for any other purposes and is subject to the following limitations:

Please refer to the approved Development Application for conditions relating to the LOT and to approved Operational Works drawings for services location and possible easements.

THESE DESIGNS AND DRAWINGS ARE COPYRIGHT AND ARE NOT TO BE USED OR REPRODUCED WITHOUT THE WRITTEN PERMISSION OF VERIS

Data Sources
Cadastral Boundaries
401905-1-001-W.dwg
Retaining Walls
Gibbs Stg-1 RT WALLS.dwg
Final Surface Contours
Gibbs Stg-1 DESN SURFACE.dwg
Depth of Fill
Gibbs Stg-1 FILL DEPTH CONT.dwg
Gibbs Stg-1 CUT FILL.dwg

Issue	Revisions	Date	Drawn
B	Amend adjoiners	8.05.2023	DMC
A	Original	24.03.2023	GJF

Locality: WALLOON
Local Authority: Ipswich City Council
Horizontal Meridian: MGA Zone 56
Vertical Level Datum: AHD
Scale: 1:250 @ A4
Designed: *
Drawn: GJF 24/03/2023
Checked: DMC
Plot Date: 09 May, 2023
Comp File Ref: 401905-01-DP01(B).dwg

DISCLOSURE PLAN
of Proposed LOT 801
currently being part of
Lot 6 on RP121124



veris

BRISBANE (07) 3686 4700 WHITSUNDAYS (07) 4945 6600
MACKAY (07) 4957 9700 CAIRNS (07) 4252 9400

veris.com.au
ACN 615 735 727
Veris Australia Pty Ltd

Drawing No
401905-01-DP-801

Issue
B