



SHEET 2

SHEET 3

SHEET 4

LEGEND

- ① Ø180 STOP VALVE
- ② Ø180 FIRE HYDRANT
- ③ Ø180 x Ø180 TEE
- ④ Ø180 DEAD END CAP
- ⑤ Ø180 45° BEND
- Conduit
- NEW WATER SERVICE CONDUIT (Ø100 PVC-O PN16)
- NEW WATER SERVICE (Ø25 PE PN16)
- NEW WATER METER
- NEW WATER HOUSE CONNECTION (TAPPING BAND)
- NEW WATER MAIN (Ø180 PE-100 PN16)
- WATER MARKER
- NEW HYDRANT
- NEW SLUICE VALVE
- NEW TEE
- NEW END CAP
- NEW TAPER
- NEW WATER SERVICE CONDUIT (Ø100 PVC-O PN16)
- NEW WATER SERVICE (Ø25 PE PN16)
- NEW WATER METER
- NEW WATER HOUSE CONNECTION (TAPPING BAND)
- NEW WATER MAIN (Ø180 PE-100 PN16)
- WATER MARKER



REGISTERED SURVEYOR'S CERTIFICATION

I, Veris Australia Pty Ltd, hereby certify that the vertical and horizontal locations and dimensions shown on this plan are a true and correct record and were located by survey.

P.G. Apple 6448 26/04/2023
 Registered Surveyor (sig.) Reg. Surveyor No. Date

ENGINEER'S CERTIFICATION

I, _____, hereby certify that:

- The information contained in this drawing / document is in compliance with approved drawings and design.
- The new water and sewerage works defined by this drawing have been designed and constructed in accordance with the SEQ Code.
- This represents an accurate record of as-constructed works.
- I accept responsibility for the information contained in this drawing / document.

 RPEQ (signature) RPEQ No. Date:

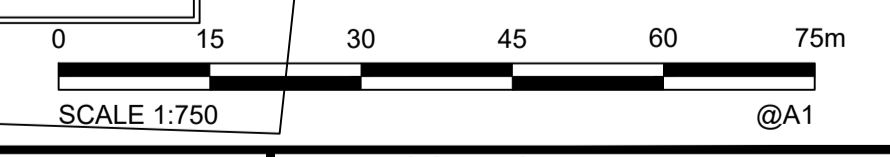

A1	C	12/04/2023	FINAL	JMc	DRAWN	JMc	13/12/2022
	B	27/02/2023	PROGRESS PLOT AS CON WATER	JMc	CHECKED		
	A	13/12/2022	PROGRESS PLOT AS CON WATER	JMc	APPROVED		
	REV NO	DATE	REVISION PURPOSE / DESCRIPTION	DRAWN	RPEQ	RPEQ No	INITIALS

veris

BRISBANE (07) 3666 4700 WHITSUNDAYS (07) 4945 6600
 MACKAY (07) 4957 9100 CAIRNS (07) 4052 9400
 veris.com.au
 ACN 615 735 727
 Veris Australia Pty Ltd



DAWN WALLOON
 Lawson Street Walloon

STAGE 6B1
 AS CONSTRUCTED WATER

DRAWING STATUS AS CONSTRUCTED	
SHEET 1 OF 4 SHEETS	
DRAWING NO. 401905-6B1-AW01	REV. C

ENGINEER'S CERTIFICATION

I,, hereby certify that:
 1. The information contained in this drawing / document is in compliance with approved drawings and design.
 2. The new water and sewerage works defined by this drawing have been designed and constructed in accordance with the SEQ Code.
 3. This represents an accurate record of as-constructed works.
 4. I accept responsibility for the information contained in this drawing / document.

RPEQ (signature) RPEQ No. Date:

REGISTERED SURVEYOR'S CERTIFICATION

I, **Veris Australia Pty Ltd**, hereby certify that the vertical and horizontal locations and dimensions shown on this plan are a true and correct record and were located by survey.

P.J. Smith 6448 26/04/2023
 Registered Surveyor (sig.) Reg. Surveyor No. Date

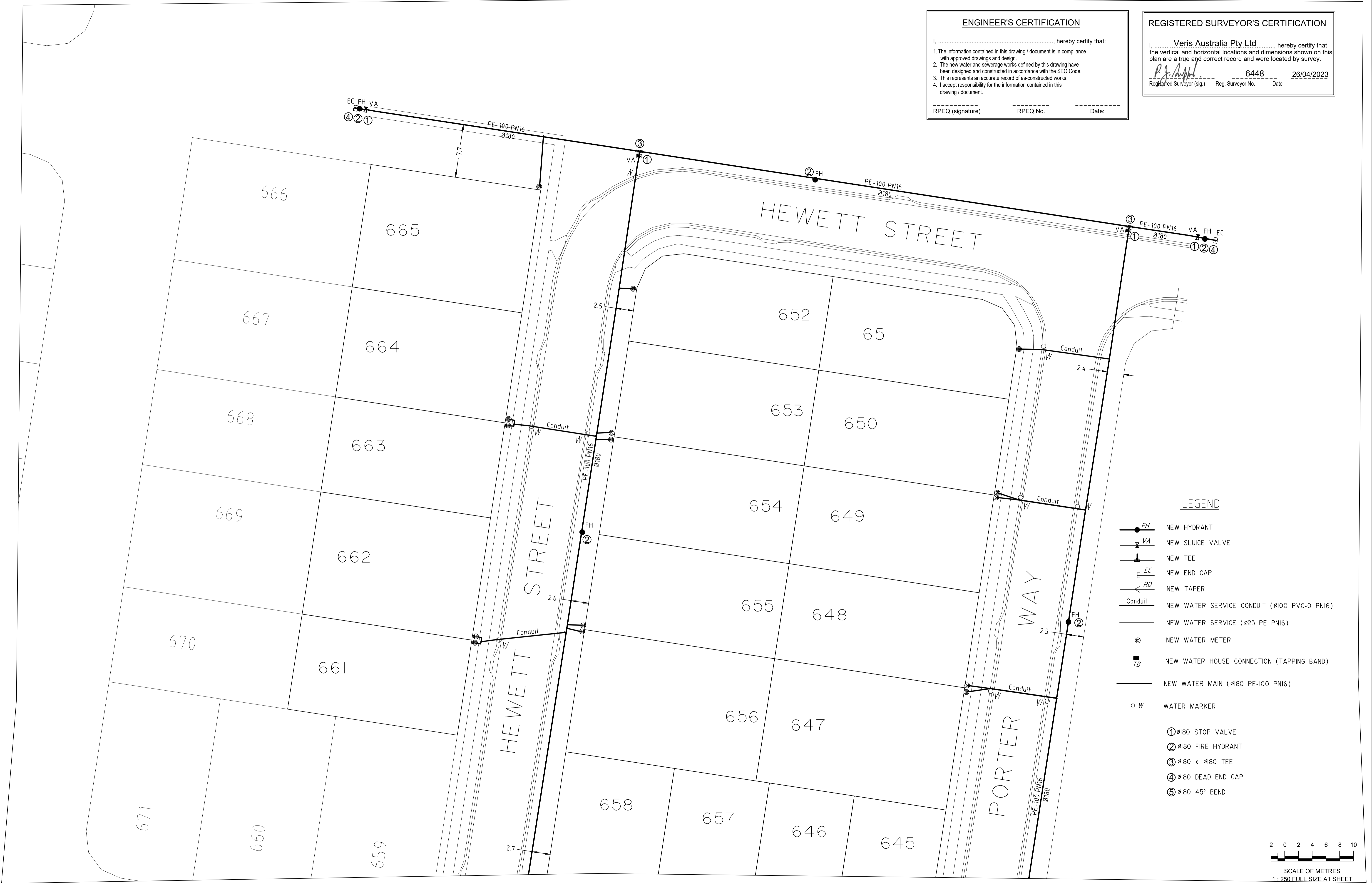

LEGEND

- NEW HYDRANT
 - NEW SLUICE VALVE
 - NEW TEE
 - NEW END CAP
 - NEW TAPER
 - NEW WATER SERVICE CONDUIT (Ø100 PVC-0 PN16)
 - NEW WATER SERVICE (Ø25 PE PN16)
 - NEW WATER METER
 - NEW WATER HOUSE CONNECTION (TAPPING BAND)
 - NEW WATER MAIN (Ø180 PE-100 PN16)
 - WATER MARKER
- ① Ø180 STOP VALVE
 ② Ø180 FIRE HYDRANT
 ③ Ø180 x Ø180 TEE
 ④ Ø180 DEAD END CAP
 ⑤ Ø180 45° BEND

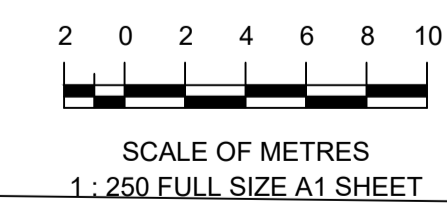

A1	C	12/04/2023	FINAL	JMc		DRAWN	JMc	13/12/2022
	B	27/02/2023	PROGRESS PLOT AS CON WATER	JMc		CHECKED		
	A	13/12/2022	PROGRESS PLOT AS CON WATER	JMc		APPROVED		
	REV NO	DATE	REVISION PURPOSE / DESCRIPTION	DRAWN	RPEQ	RPEQ No	INITIALS	DATE

veris
 BRISBANE (07) 3666 4700 WHITSUNDAYS (07) 4945 6600
 MACKAY (07) 4957 9100 CAIRNS (07) 4052 9400
 veris.com.au
 ACN 615 735 727
 Veris Australia Pty Ltd



DAWN WALLOON
 Lawson Street Walloon
STAGE 6B1
 AS CONSTRUCTED WATER

DRAWING STATUS	
AS CONSTRUCTED	
SHEET 2 OF 4 SHEETS	
DRAWING NO.	REV.
401905-6B1-AW01	C

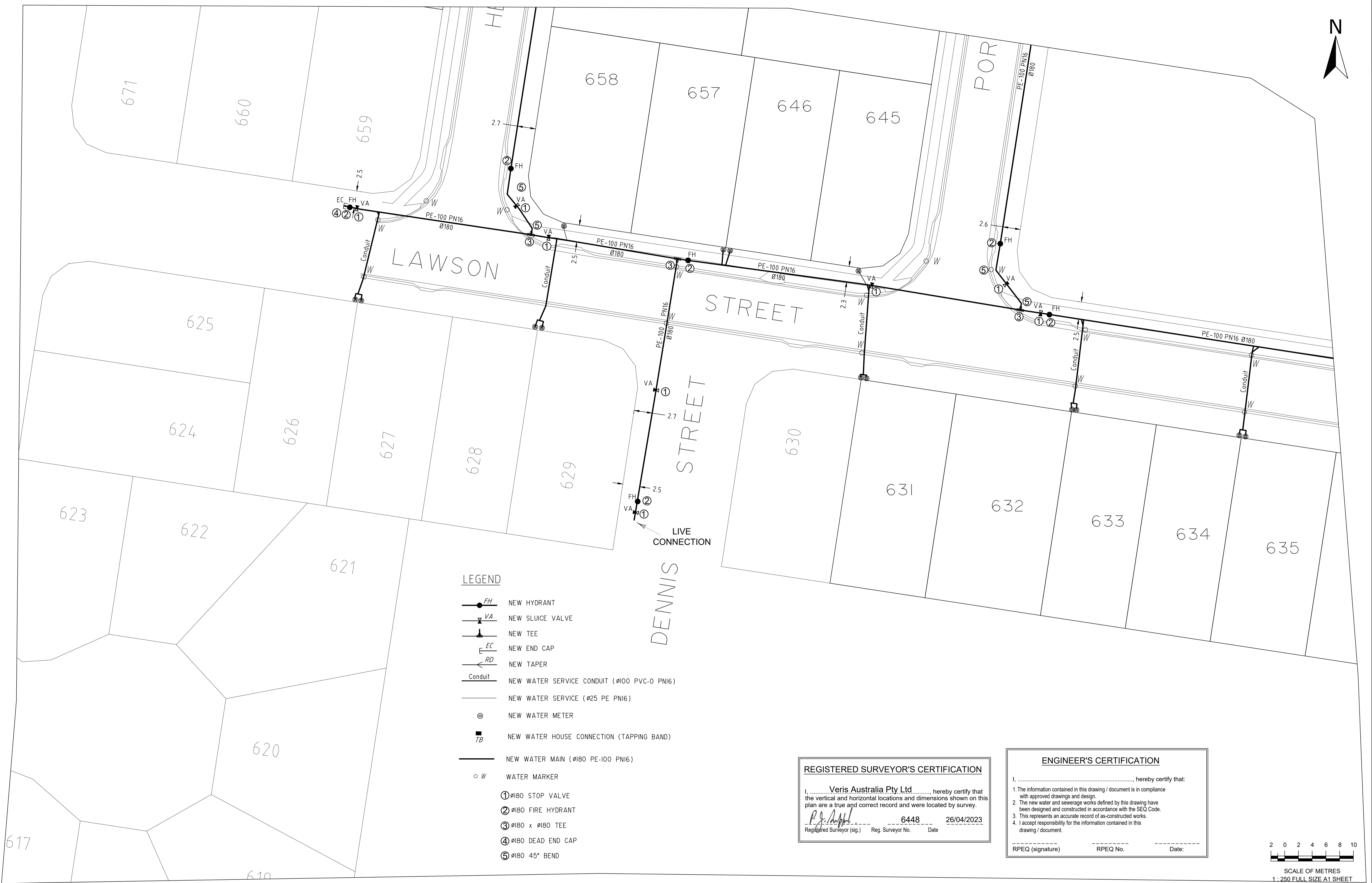

LEGEND

- NEW HYDRANT
- NEW SLUICE VALVE
- NEW TEE
- NEW END CAP
- NEW TAPER
- NEW WATER SERVICE CONDUIT (Ø100 PVC-0 PN16)
- NEW WATER SERVICE (Ø25 PE PN16)
- NEW WATER METER
- NEW WATER HOUSE CONNECTION (TAPPING BAND)
- NEW WATER MAIN (Ø180 PE-100 PN16)
- WATER MARKER
- ① Ø180 STOP VALVE
- ② Ø180 FIRE HYDRANT
- ③ Ø180 x Ø180 TEE
- ④ Ø180 DEAD END CAP
- ⑤ Ø180 45° BEND

REGISTERED SURVEYOR'S CERTIFICATION

I, Veris Australia Pty Ltd, hereby certify that the vertical and horizontal locations and dimensions shown on this plan are a true and correct record and were located by survey.

P. J. Mackay 6448 26/04/2023
 Registered Surveyor (sig.) Reg. Surveyor No. Date

ENGINEER'S CERTIFICATION

I, _____, hereby certify that:

- The information contained in this drawing / document is in compliance with approved drawings and design.
- The new water and sewerage works defined by this drawing have been designed and constructed in accordance with the SEQ Code.
- This represents an accurate record of as-constructed works.
- I accept responsibility for the information contained in this drawing / document.

 RPEQ (signature) RPEQ No. Date:

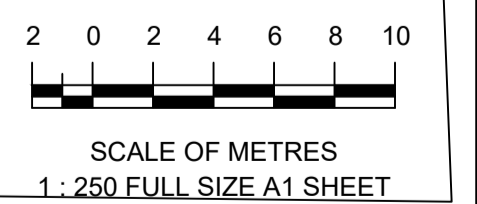

A1	REV NO	DATE	REVISION PURPOSE / DESCRIPTION	DRAWN	RPEQ	RPEQ No	INITIALS	DATE
	C	12/04/2023	FINAL	JMc				13/12/2022
	B	27/02/2023	PROGRESS PLOT AS CON WATER	JMc				
	A	13/12/2022	PROGRESS PLOT AS CON WATER	JMc				

veris

BRISBANE (07) 3666 4700 WHITSUNDAYS (07) 4945 6600
 MACKAY (07) 4957 9100 CAIRNS (07) 4052 9400

veris.com.au
 ACN 615 735 727
 Veris Australia Pty Ltd



DAWN WALLOON
 Lawson Street Walloon

STAGE 6B1
 AS CONSTRUCTED WATER

DRAWING STATUS AS CONSTRUCTED	
SHEET 3 OF 4 SHEETS	
DRAWING NO. 401905-6B1-AW01	REV. C

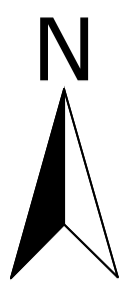

- LEGEND**
- NEW HYDRANT
 - NEW SLUICE VALVE
 - NEW TEE
 - NEW END CAP
 - NEW TAPER
 - NEW WATER SERVICE CONDUIT (Ø100 PVC-0 PN16)
 - NEW WATER SERVICE (Ø25 PE PN16)
 - NEW WATER METER
 - NEW WATER HOUSE CONNECTION (TAPPING BAND)
 - NEW WATER MAIN (Ø180 PE-100 PN16)
 - WATER MARKER
- ① Ø180 STOP VALVE
 - ② Ø180 FIRE HYDRANT
 - ③ Ø180 x Ø180 TEE
 - ④ Ø180 DEAD END CAP
 - ⑤ Ø180 45° BEND



REGISTERED SURVEYOR'S CERTIFICATION

I, Veris Australia Pty Ltd hereby certify that the vertical and horizontal locations and dimensions shown on this plan are a true and correct record and were located by survey.

P.J. Apple 6448 26/04/2023
 Registered Surveyor (sig.) Reg. Surveyor No. Date

ENGINEER'S CERTIFICATION

I, _____ hereby certify that:

- The information contained in this drawing / document is in compliance with approved drawings and design.
- The new water and sewerage works defined by this drawing have been designed and constructed in accordance with the SEQ Code.
- This represents an accurate record of as-constructed works.
- I accept responsibility for the information contained in this drawing / document.

 RPEQ (signature) RPEQ No. Date:

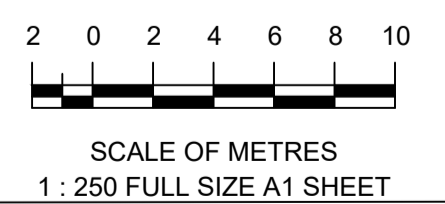

A1	C	21/04/2023	FINAL	JMc		DRAWN	JMc	13/12/2022
	B	27/02/2023	PROGRESS PLOT AS CON WATER	JMc		CHECKED		
	A	13/12/2022	PROGRESS PLOT AS CON WATER	JMc		APPROVED		
	REV NO	DATE	REVISION PURPOSE / DESCRIPTION	DRAWN	RPEQ	RPEQ No	INITIALS	DATE

veris

BRISBANE (07) 3666 4700 WHITSUNDAYS (07) 4945 6600
 MACKAY (07) 4957 9700 CAIRNS (07) 4052 9400
 veris.com.au
 ACN 615 735 727
 Veris Australia Pty Ltd



DAWN WALLOON
 Lawson Street Walloon

STAGE 6B1
 AS CONSTRUCTED WATER

DRAWING STATUS AS CONSTRUCTED	
SHEET 4 OF 4 SHEETS	
DRAWING NO. 401905-6B1-AW01	REV. C