

### LEGEND

Final surface contours based on A.H.D. datum at an interval of 0.5m, shown as: 15.5

Where applicable, areas to be filled are shown as:

Depth of fill, in metres, shown as:- +[L1]

Retaining wall and retaining wall height, shown on the lower side of the wall, have been taken from plans supplied by Calibre Group and shown as: (1.2)

Retaining Wall Lot 642  
Min Height:- 0.75m  
Max Height:- 1.0m  
Average Height:- 0.87m

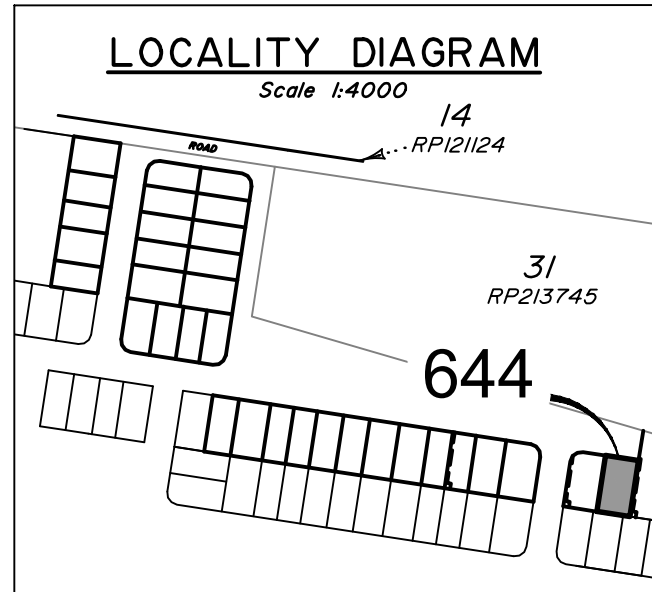

**WATERLEA STAGE 6B1**  
For  
Waterlea Nominees Co.

**IMPORTANT NOTES:**  
(These notes are an integral part of this plan)  
This plan has been prepared for Waterlea Nominees Co. and ID Land for the purposes of A Disclosure Plan Under the Land Sales Act 1984 (as amended).  
It is not to be used by any other person or corporation or for any other purposes and is subject to the following limitations:

Please refer to the approved Development Application for conditions relating to the LOT and to approved Operational Works drawings for services location and possible easements.

THESE DESIGNS AND DRAWINGS ARE COPYRIGHT AND ARE NOT TO BE USED OR REPRODUCED WITHOUT THE WRITTEN PERMISSION OF VERIS

**Data Sources**  
Cadastral Boundaries  
401364-LC01(C).dwg  
Engineering Design  
21-000113.02-1230 RETAINING WALL  
SETOUT-1230.pdf  
Final Surface Contours  
2021118 Waterlea Stage 6B1 Depth Conts.dwg  
Depth of Fill  
20211109 Waterlea Stage 6B1 Cut-Fill.dwg

Issue	Revisions	Date	Drawn
C	Easement Added	19.04.2022	BK
B	Update Eng's Name	21.03.2022	GJF
A	Original	25.11.2021	PS / BK

Locality: WALLOON  
Local Authority: Ipswich City Council  
Horizontal Meridian: MGA Zone 56  
Vertical Level Datum: AHD  
Scale: 1:250 @ A4  
Designed: \*\*  
Drawn: PS / BK 25/11/2021  
Checked: KJJ 25/11/2021  
Plot Date: 19 Apr, 2022  
Comp File Ref: 401364-Std6-B1-DP01(C).dwg

**DISCLOSURE PLAN**  
of Proposed LOT 644  
being part of Lot 816  
on SP327506



**veris**

BRISBANE (07) 3686 4700 WHITSUNDAYS (07) 4945 6600

MACKAY (07) 4957 9700 CAIRNS (07) 4252 9400

veris.com.au  
ACN 615 735 727  
Veris Australia Pty Ltd

**ADDITIONAL NOTES:**  
The LOT dimensions and area shown hereon are subject to final field survey and also to the requirements of Council and any other authority which may have requirements under any relevant legislation

Final surface contours shown hereon have been supplied by Calibre Group.

Compaction of any fill material placed on this site shall be completed to level one inspection and testing services in accordance with AS3798-2007.

Copyright ©Veris Australia Pty Ltd 23/11/2021.

Retaining Wall Lot 644  
Min Height:- 1.3m  
Max Height:- 1.5m  
Average Height:- 1.4m



Drawing No  
401364-06-DP-644  
Issue  
C