

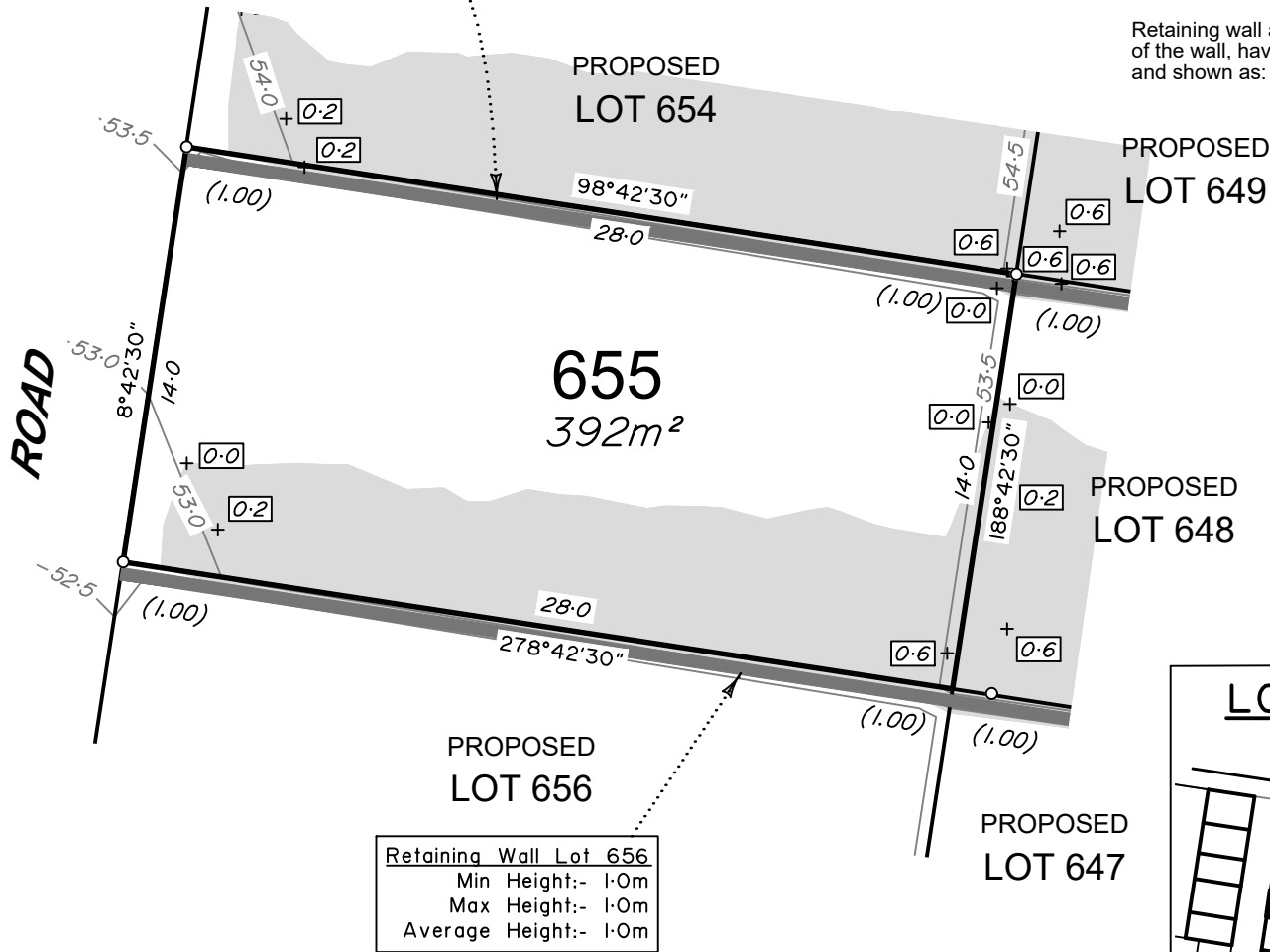

Retaining Wall Lot 655
 Min Height:- 1.0m
 Max Height:- 1.0m
 Average Height:- 1.0m



Retaining Wall Lot 656
 Min Height:- 1.0m
 Max Height:- 1.0m
 Average Height:- 1.0m

LEGEND

Final surface contours based on A.H.D. datum at an interval of 0.5m, shown as: $\text{---} 15.5 \text{---}$

Where applicable, areas to be filled are shown as:

Depth of fill, in metres, shown as:- $\text{+}[L]$

Retaining wall and retaining wall height, shown on the lower side of the wall, have been taken from plans supplied by Calibre Group and shown as: $\text{---}(1.2)\text{---}$

ADDITIONAL NOTES:

The LOT dimensions and area shown hereon are subject to final field survey and also to the requirements of Council and any other authority which may have requirements under any relevant legislation

Final surface contours shown hereon have been supplied by Calibre Group.

Compaction of any fill material placed on this site shall be completed to level one inspection and testing services in accordance with AS3798-2007.

Copyright ©Veris Australia Pty Ltd 23/11/2021.

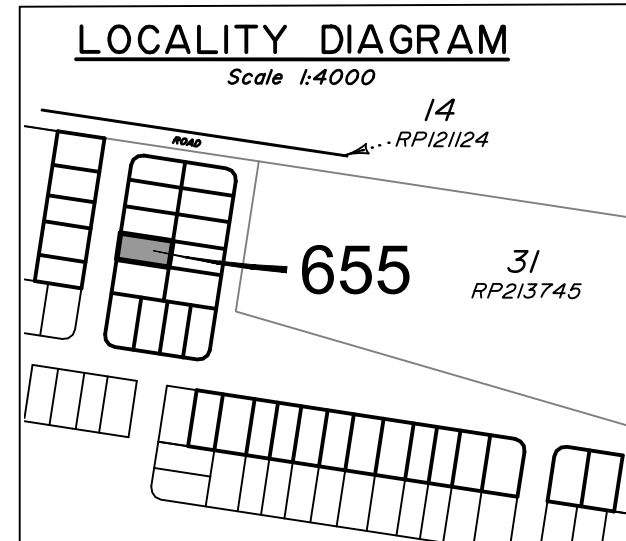

WATERLEA STAGE 6B1
 For
 Waterlea Nominees Co.

IMPORTANT NOTES:
 (These notes are an integral part of this plan)
 This plan has been prepared for Waterlea Nominees Co. and ID Land for the purposes of A Disclosure Plan Under the Land Sales Act 1984 (as amended).
 It is not to be used by any other person or corporation or for any other purposes and is subject to the following limitations:

Please refer to the approved Development Application for conditions relating to the LOT and to approved Operational Works drawings for services location and possible easements.

THESE DESIGNS AND DRAWINGS ARE COPYRIGHT AND ARE NOT TO BE USED OR REPRODUCED WITHOUT THE WRITTEN PERMISSION OF VERIS

Data Sources
 Cadastral Boundaries
 401364-L001-C1.dwg
 Engineering Design
 21-000113.02-1230 RETAINING WALL
 SETOUT-1230.pdf
 Final Surface Contours
 2021118 Waterlea Stage 6B1 Depth Conts.dwg
 Depth of Fill
 2021109 Waterlea Stage 6B1 Cut-Fill.dwg

B	Update Eng's Name	21.03.2022	GJF
A	Original	25.11.2021	PS / BK
Issue	Revisions	Date	Drawn

Locality: WALLOON
 Local Authority: Ipswich City Council
 Horizontal Meridian: MGA Zone 56
 Vertical Level Datum: AHD
 Scale: 1:250 @ A4
 Designed: **
 Drawn: PS / BK 25/11/2021
 Checked: KJJ 25/11/2021
 Plot Date: 21 Mar, 2022
 Comp File Ref: 401364-Stg6-B1-DP01(B).dwg

DISCLOSURE PLAN
 of Proposed LOT 655
 being part of Lot 816
 on SP327506



BRISBANE WHITSUNDAYS
 (07) 3668 4700 (07) 4945 6600
 MACKAY CAIRNS
 (07) 4957 9700 (07) 4252 9400
 veris.com.au
 ACN 615 735 727
 Veris Australia Pty Ltd

Drawing No Issue
401364-06-DP-655 B