



PROPOSED
LOT 654

Retaining Wall Lot 648
Min Height:- 1.0m
Max Height:- 1.0m
Average Height:- 1.0m

PROPOSED
LOT 649

PROPOSED
LOT 655

648
392m²

PROPOSED
LOT 656

Retaining Wall Lot 647
Min Height:- 1.0m
Max Height:- 1.0m
Average Height:- 1.0m

PROPOSED
LOT 647

LEGEND

Final surface contours based on A.H.D. datum at an interval of 0.5m, shown as: — 15.5 —

Where applicable, areas to be filled are shown as:

Depth of fill, in metres, shown as:- + [L]]

Retaining wall and retaining wall height, shown on the lower side of the wall, have been taken from plans supplied by Calibre Group and shown as:

ADDITIONAL NOTES:

The LOT dimensions and area shown hereon are subject to final field survey and also to the requirements of Council and any other authority which may have requirements under any relevant legislation

Final surface contours shown hereon have been supplied by Calibre Group.

Compaction of any fill material placed on this site shall be completed to level one inspection and testing services in accordance with AS3798-2007.

Copyright ©Veris Australia Pty Ltd 23/11/2021.

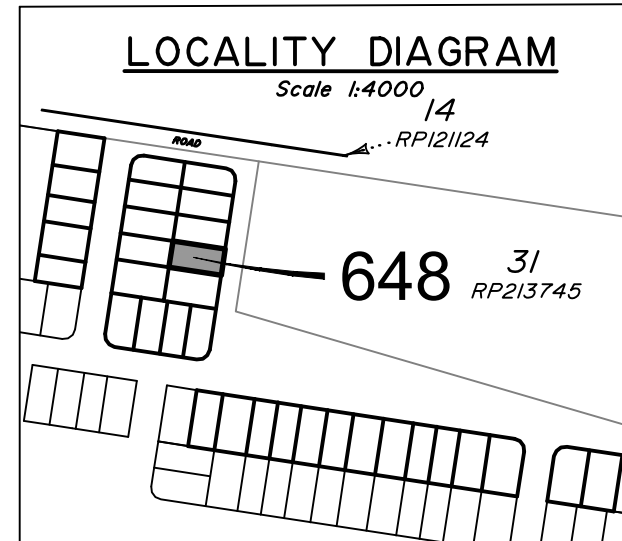

WATERLEA STAGE 6B1
For
Waterlea Nominees Co.

IMPORTANT NOTES:
(These notes are an integral part of this plan)
This plan has been prepared for Waterlea Nominees Co. and ID Land for the purposes of a Disclosure Plan Under the Land Sales Act 1984 (as amended).
It is not to be used by any other person or corporation or for any other purposes and is subject to the following limitations:

Please refer to the approved Development Application for conditions relating to the LOT and to approved Operational Works drawings for services location and possible easements.

THESE DESIGNS AND DRAWINGS ARE COPYRIGHT AND ARE NOT TO BE USED OR REPRODUCED WITHOUT THE WRITTEN PERMISSION OF VERIS

Data Sources
Cadastral Boundaries
401364-L001-C.dwg
Engineering Design
21-000113.02-1230 RETAINING WALL
SETOUT-1230.pdf
Final Surface Contours
2021118 Waterlea Stage 6B1 Depth Conts.dwg
Depth of Fill
20211109 Waterlea Stage 6B1 Cut-Fill.dwg

Issue	Revisions	Date	Drawn
B	Update Eng's Name	21.03.2022	GJF
A	Original	25.11.2021	PS / BK

Locality: WALLOON
Local Authority: Ipswich City Council
Horizontal Meridian: MGA Zone 56
Vertical Level Datum: AHD
Scale: 1:250 @ A4
Designed: **
Drawn: PS / BK 25/11/2021
Checked: KJJ 25/11/2021
Plot Date: 21 Mar, 2022
Comp File Ref: 401364-Stg6-B1-DP01(B).dwg

DISCLOSURE PLAN
of Proposed LOT 648
being part of Lot 816
on SP327506



veris

BRISBANE WHITSUNDAYS
(07) 3668 4700 (07) 4945 6600

MACKAY CAIRNS
(07) 4957 9700 (07) 4252 9400

veris.com.au
ACN 615 735 727
Veris Australia Pty Ltd

Drawing No Issue
401364-06-DP-648 B